

TYPICAL MARKINGS FOR TURN LANES

NOTES:

1. MARKINGS START AT THE BEGINNING OF SOLID LANE LINE.
2. THE "ONLY" WORD MARKINGS SHALL BE USED TO SUPPLEMENT LANE-USE ARROW MARKINGS AS SHOWN ON THE PLANS OR AS DIRECTED BY THE ENGINEER.
3. IF LANE LENGTH IS LESS THAN 50 FEET, ONLY ONE TURN ARROW PLACED AT THE BEGINNING OF THE SOLID LANE LINE IS REQUIRED.
4. THE LONGITUDINAL SPACE BETWEEN WORD OR SYMBOL MESSAGE MARKINGS SHOULD BE AT LEAST FOUR TIMES THE HEIGHT OF THE CHARACTERS USED FOR LOW SPEED ROADS, BUT NOT MORE THAN TEN TIMES THE HEIGHT OF THE CHARACTERS UNDER ANY CONDITIONS.
5. A SECOND "ONLY" IS OPTIONAL WHEN SPACE PERMITS AS SHOWN ON THE PLANS OR AS DIRECTED BY THE ENGINEER.
6. EXCLUSIVE TURN (LEFT OR RIGHT) LANE LINES SHALL BE SOLID AND EXTEND BACK FROM THE STOP LINE TO THE POINT OF FULL LANE WIDTH OF THE TURN LANE.

REVISION	DATE	DESCRIPTION	BY
1	02-09-16	"COLD PLANE DETAIL AT DRIVES" DETAIL WITH APPLICABLE NOTES	BWK

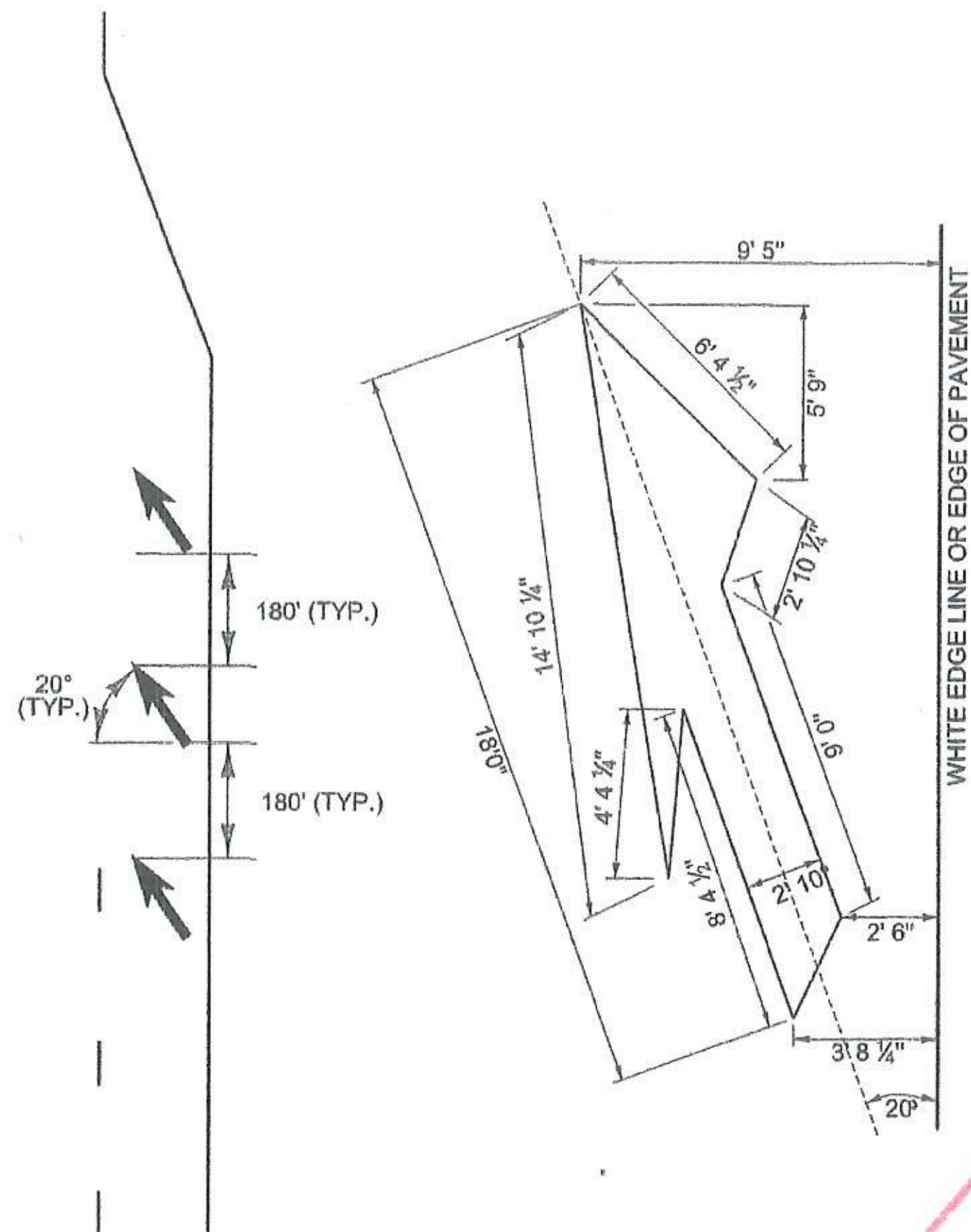

LANE REDUCTION TRANSITION MARKINGS

FIRST LANE REDUCTION ARROW SHALL BE PLACED OPPOSITE THE LAST DASH. TWO MORE ARROWS (TOTAL OF THREE ARROWS) SHALL BE PLACED 180' BETWEEN LAST DASH AND BEGINNING OF LANE TAPER. FOR LEFT LANE USE MIRROR IMAGE.

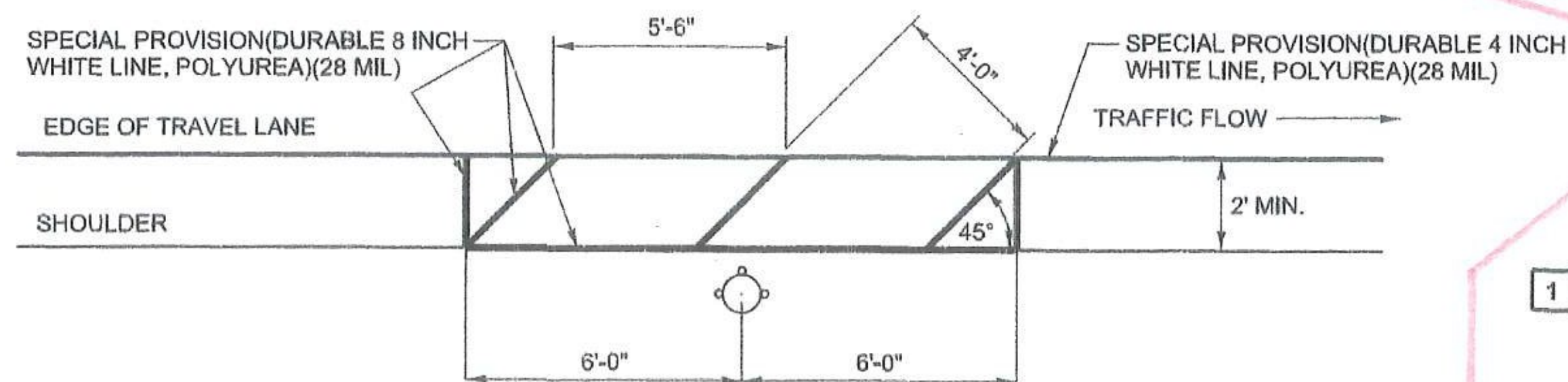

FIRE HYDRANT AND NO PARKING PAVEMENT MARKING DETAIL

US ROUTE 7 WALLINGFORD:
 STA W 278+50 RT (MM 5.275)
 STA W 290+00 LT (MM 5.492)
 STA W 293+53 LT (MM 5.559)
 STA W 300+50 LT (MM 5.691)

NOTE: THE CONTRACTOR SHALL ADJUST THE PLACEMENT OF THE FIRE HYDRANT PAVEMENT MARKINGS AND NO PARKING PAVEMENT MARKINGS TO MEET THE EXISTING SITE CONSTRAINTS AS DIRECTED BY THE ENGINEER.

NOT TO SCALE

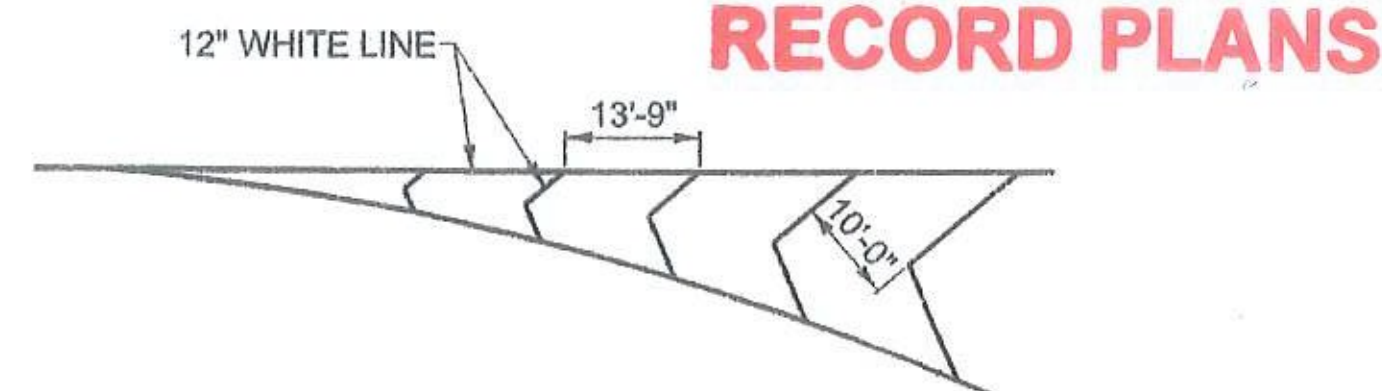

GORE MARKING DETAIL

MANCHESTER - RAMP D
 DORSET - RAMP H
 CLARENDON - MM 2.479 SB
 CLARENDON - MM 2.508 NB
 CLARENDON - MM 5.621 SB
 RUTLAND TOWN - MM 0.428 SB

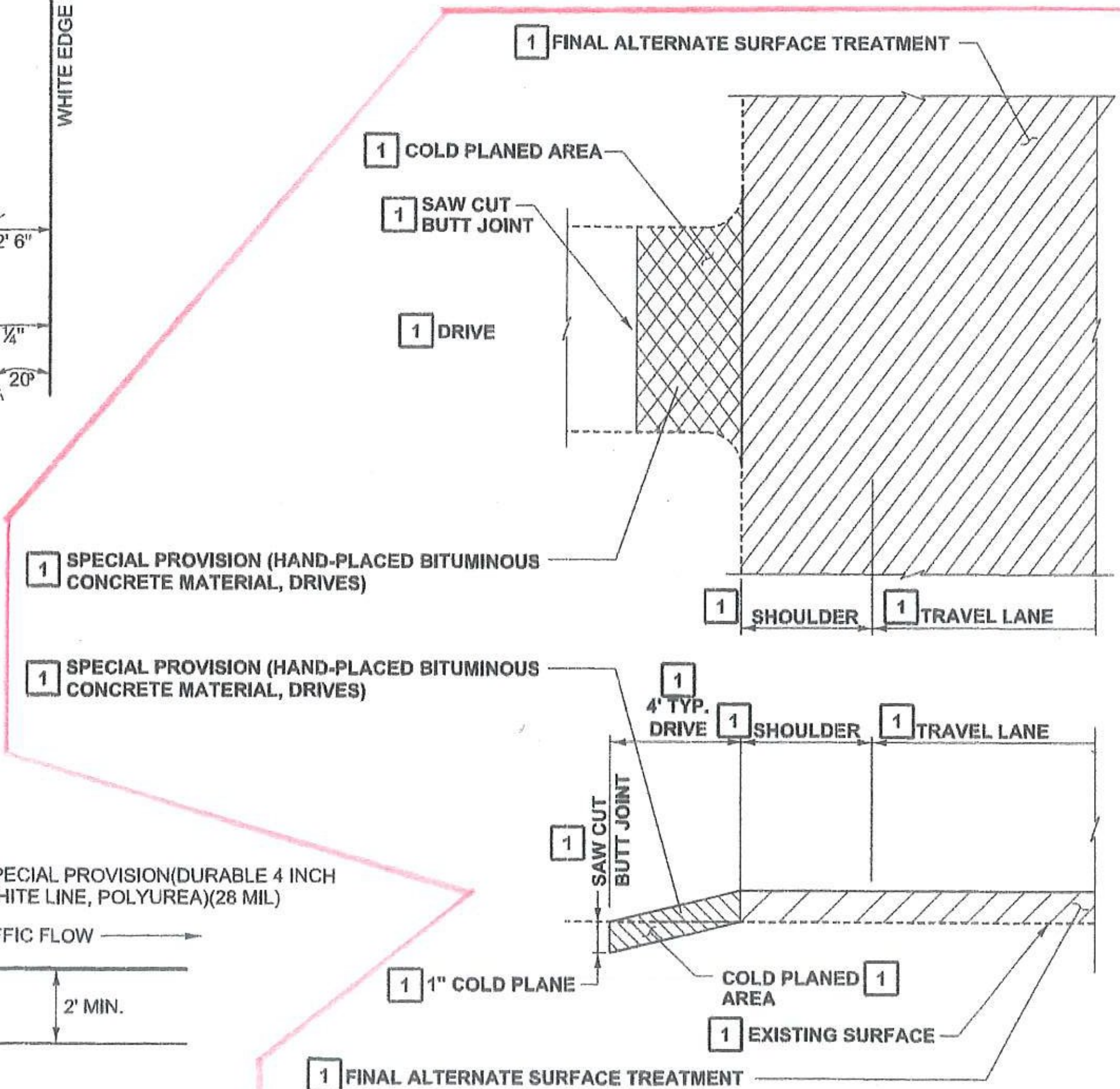

COLD PLANE DETAILS AT DRIVES

- NOTES:**
1. COLD PLANING FOR DRIVES SHALL MEET THE REQUIREMENTS OF SECTION 210 AS APPLICABLE.
 2. PAYMENT FOR COLD PLANED AREA REQUIRED FOR DRIVES SHALL BE CONSIDERED INCIDENTAL TO SPECIAL PROVISION (HAND-PLACED BITUMINOUS CONCRETE MATERIAL, DRIVES).

PROJECT NAME: MANCHESTER-RUTLAND TOWN
 PROJECT NUMBER: NH SURF(50)

FILE NAME: pi4v200.dgn
 PROJECT LEADER: M. FOWLER
 DESIGNED BY: B. KIPP
 DETAIL SHEET 2

PLOT DATE: 2/9/2016
 DRAWN BY: B. KIPP
 CHECKED BY: M. FOWLER
 SHEET 10 OF 105