

CONSTRUCTION APPROACH SIGNING

NOT TO SCALE
SEE STD T-10
FOR SIGN PLACEMENT

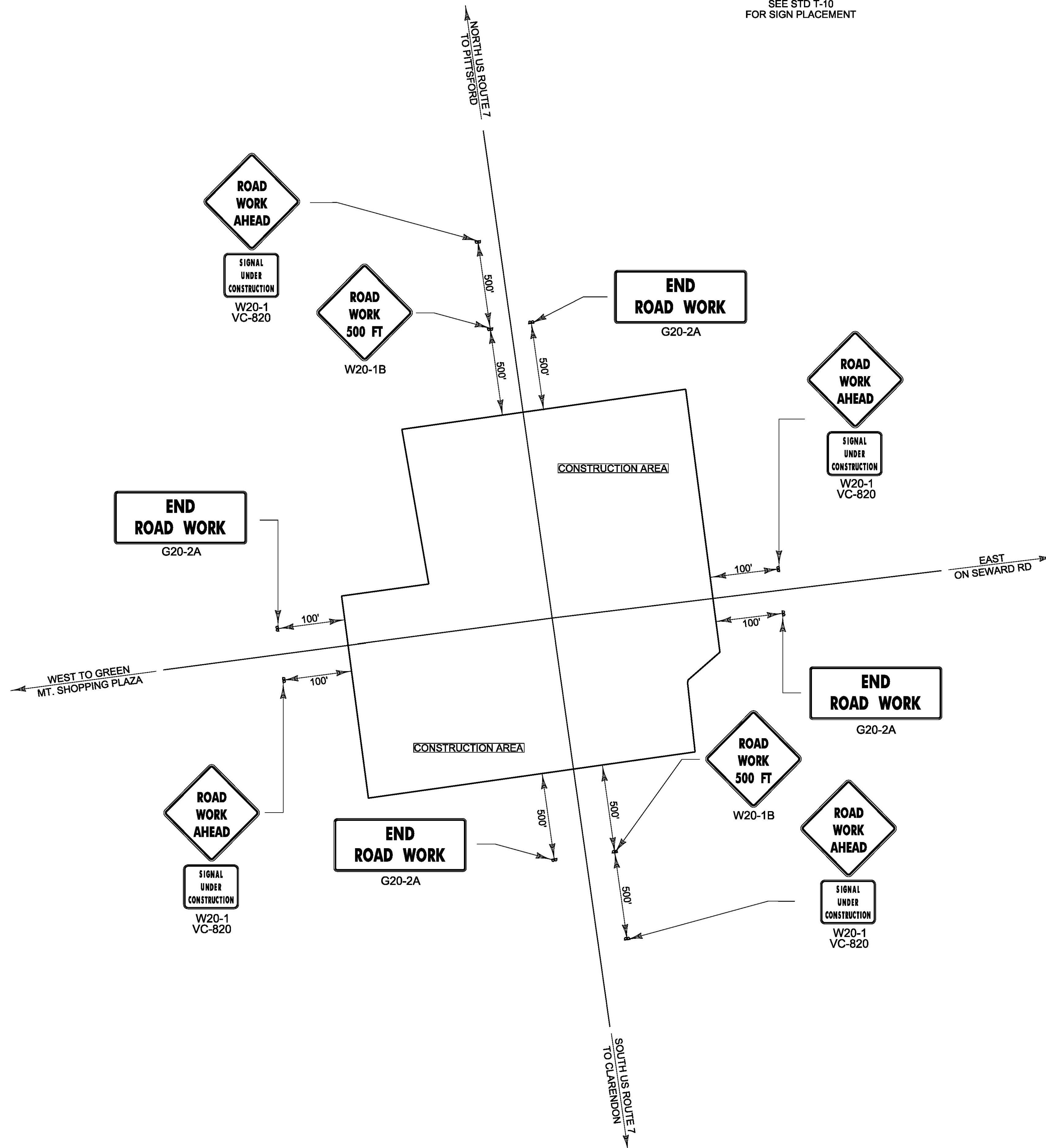

TRAFFIC CONTROL GENERAL NOTES

1. THE CONTRACTOR SHALL SUBMIT A SITE-SPECIFIC TRAFFIC CONTROL PLAN IN ACCORDANCE WITH THE REQUIREMENTS OF SECTION 105.03 OF THE VERMONT AGENCY OF TRANSPORTATION STANDARD SPECIFICATIONS FOR CONSTRUCTION, DATED 2011. THIS PLAN SHALL BE SUBMITTED TWO WEEKS IN ADVANCE OF THE START OF CONSTRUCTION AND THE WORK SHALL NOT COMMENCE UNTIL THE SITE-SPECIFIC TRAFFIC CONTROL PLAN HAS BEEN ACCEPTED BY THE PROJECT MANAGER.
2. REFER TO THE CURRENT VERMONT STATE CONSTRUCTION STANDARD DRAWINGS AND THE LATEST EDITION OF THE MANUAL FOR UNIFORM TRAFFIC CONTROL DEVICES (MUTCD) FOR DETAILED INFORMATION REGARDING CHANNELIZATION DEVICES, TAPER LENGTHS, BARRICADES, DETOURS, LONGITUDINAL DROP-OFFS AND MISCELLANEOUS TRAFFIC CONTROL DETAILS, IF APPLICABLE (T-1, T-10, T-17, T-28, T-30).
3. THE CONTRACTOR SHALL BE RESPONSIBLE FOR LOCATING CONSTRUCTION SIGNAGE SO AS NOT TO INTERFERE OR OBSTRUCT THE VIEW OF EXISTING TRAFFIC CONTROL DEVICES, STOPPING SIGHT DISTANCE AND CORNER SIGHT DISTANCE. EXISTING SIGNS SHALL BE COVERED OR REMOVED WHEN THEY CONFLICT WITH CONSTRUCTION TRAFFIC OPERATIONS.
4. THE CONTRACTOR SHALL MAINTAIN ACCESS TO ALL DRIVEWAYS AND BUSINESS ACCESSES DURING CONSTRUCTION 24 HOURS A DAY.
5. FURNISHING, INSTALLING, MAINTENANCE OF, RELOCATING AND REMOVING REFLECTORIZED DRUMS, CONSTRUCTION SIGNING FOR TRAFFIC SHIFTS AND PEDESTRIAN BARRICADES AND SIGNAGE WILL BE PAID FOR UNDER CONTRACT ITEM 900.645, SPECIAL PROVISION (TRAFFIC CONTROL, ALL INCLUSIVE).
6. SPECIAL CARE SHALL BE TAKEN TO PROVIDE ACCESS THROUGH THE WORK ZONES FOR EMERGENCY VEHICLES. THE CONTRACTOR SHALL COORDINATE WITH BOTH POLICE AND FIRE DEPARTMENTS FROM RUTLAND TO DETERMINE THEIR MINIMUM ACCESS REQUIREMENTS BEFORE PROCEEDING TO THE NEXT PHASE OF CONSTRUCTION. THE CONTRACTOR SHALL ENSURE THAT ACCESS IS AVAILABLE TO ALL PROPERTIES AT ALL TIMES FOR EMERGENCY VEHICLES.
7. THE CONTRACTOR SHALL PROVIDE TWO (2) PORTABLE CHANGEABLE MESSAGE SIGNS FOR THE DURATION OF THE PROJECT. THE LOCATION AND MESSAGE CONTENT SHALL BE APPROVED IN THE FIELD BY THE ENGINEER. PORTABLE CHANGEABLE MESSAGE SIGNS SHOULD NOT REPEAT MESSAGE ON STATIC SIGNS. PORTABLE CHANGEABLE MESSAGE SIGNS WILL BE PAID FOR UNDER CONTRACT ITEM 641.15, PORTABLE CHANGEABLE MESSAGE BOARDS.
8. PRIOR TO THE COMMENCEMENT OF ANY WORK OR THE PLACEMENT OF EQUIPMENT ON THE ROADWAY THE CONTRACTOR SHALL PROVIDE ADVANCED WARNING SIGNS IN ACCORDANCE WITH THE CONSTRUCTION SIGNING APPROACH PLANS AND THE LATEST EDITION OF THE MANUAL FOR UNIFORM TRAFFIC CONTROL DEVICES (MUTCD).
9. ACCESSIBLE PEDESTRIAN ACCOMMODATIONS SHALL BE PROVIDED AT ALL TIMES THROUGHOUT CONSTRUCTION IN COMPLIANCE WITH THE MUTCD. THE TRAFFIC CONTROL PLAN SHALL INDICATE PEDESTRIAN ACCOMMODATIONS.
10. LANE CLOSURES WILL BE LIMITED TO OFF PEAK TRAFFIC TIMES (9:00 AM TO 3:00 PM) TO REDUCE DELAY THROUGH THE PROJECT AREA.

PROJECT NAME: RUTLAND TOWN

PROJECT NUMBER: NHG 019-3(60)

FILE NAME: t14t190frm.dgn

PLOT DATE: 2/7/2017

PROJECT LEADER: P. COBURN

DRAWN BY: M. BOGACZYK

DESIGNED BY: M. BOGACZYK

CHECKED BY: P. COBURN

CONSTRUCTION APPROACH SIGNING

SHEET 17 OF 17