

GPS CONTROL POINTS

HVCTRL #1  
 DAYS INN RIM  
 NORTH = 395680.5430  
 EAST = 1516471.2950  
 ELEV. = 0.000

GENERAL LOCATION, RUTLAND, VT.  
 TO REACH FROM THE MOST SOUTHERN INTERSECTION OF US ROUTE 4 AND US ROUTE 7, GO NORTH ALONG US ROUTE 7 FOR 0.5 MI (0.8 KM) TO THE ENTRANCE DRIVES TO THE DAYS INN MOTEL AND DENNY'S RESTAURANT ON THE RIGHT. PULL INTO THE DENNY'S PARKING LOT. PARK VEHICLE AND WALK SOUTH ALONG THE SIDEWALK TO A SEWER MANHOLE COVER BETWEEN THE TWO ENTRANCE DRIVES AND BETWEEN US ROUTE 7 AND THE ASPHALT SIDEWALK.  
 THE MARK IS A X-CUT WITH CENTER PUNCH IN THE OUTER METAL RIM OF A 75 CM (30 INCH) DIAMETER SEWER MANHOLE COVER. IT IS 9.7 M (31.8 FT) NORTH OF AND ABOUT 0.5 M (1.6 FT) HIGHER THAN THE CENTERLINE OF THE ENTRANCE DRIVE TO THE DAYS INN MOTEL, 13.1 M (43.0 FT) SOUTH OF THE CENTERLINE OF THE ENTRANCE DRIVE TO THE DENNY'S RESTAURANT, 0.65 M (2.1 FT) EAST OF THE WEST FACE OF THE CONCRETE CURB, 1.0 M (3.3 FT) WEST OF THE WEST EDGE OF THE ASPHALT SIDEWALK AND 12.7 M (41.7 FT) WEST OF THE DAYS INN SIGN.

HVCTRL #2  
 METER PIT RUT 11  
 NORTH = 397716.0700  
 EAST = 1516150.9530  
 ELEV. = 568.9900

GENERAL LOCATION, RUTLAND CITY.  
 TO REACH FROM THE INTERSECTION OF U.S. ROUTE 7 AND U.S. ROUTE 4 EAST (WOODSTOCK AVENUE) IN RUTLAND GO SOUTH ALONG U.S. ROUTE 7 FOR 1.5 MI (2.4 KM) TO THE SMITH BUICK DEALERSHIP AND THE MARK ON THE RIGHT IN THE TOP OF A 3 M (9.8 FT) X 3 M (9.8 FT) CONCRETE METER PIT STRUCTURE, 62.8 M (206.0 FT) NORTH OF THE INTERSECTION OF U.S. ROUTE 7 AND COLD RIVER ROAD, 15.8 M (51.8 FT) NORTH OF THE CENTERLINE OF A PAVED DRIVE TO SMITH BUICK, 3.3 M (10.8 FT) WEST OF THE WEST CURB OF U.S. ROUTE 7, 1.9 M (6.2 FT) EAST OF THE NORTHWEST CORNER OF THE METER PIT STRUCTURE, AND 0.1 M (0.3 FT) SOUTH OF THE NORTH EDGE OF THE STRUCTURE.

TRAVERSE TIES

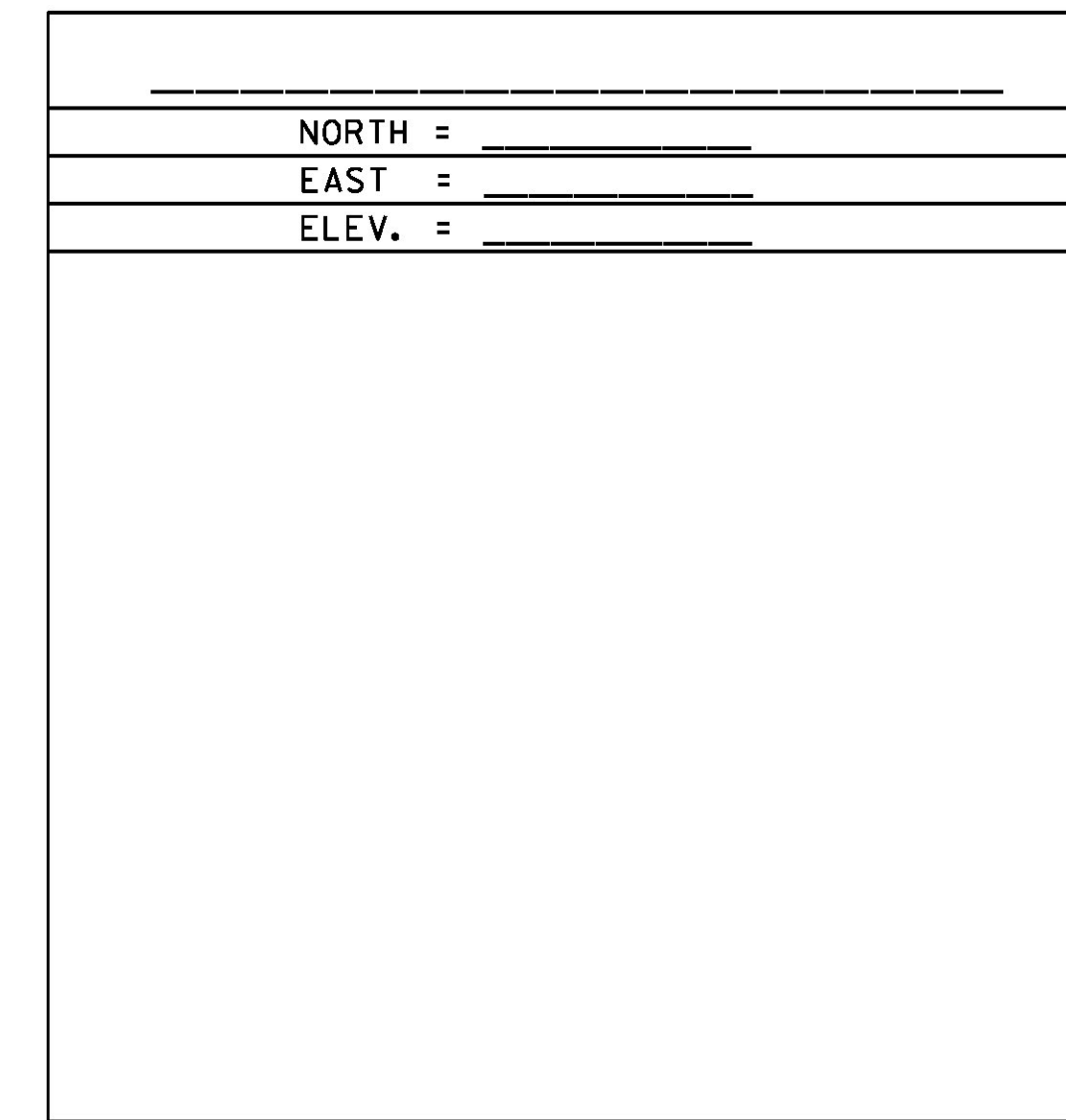
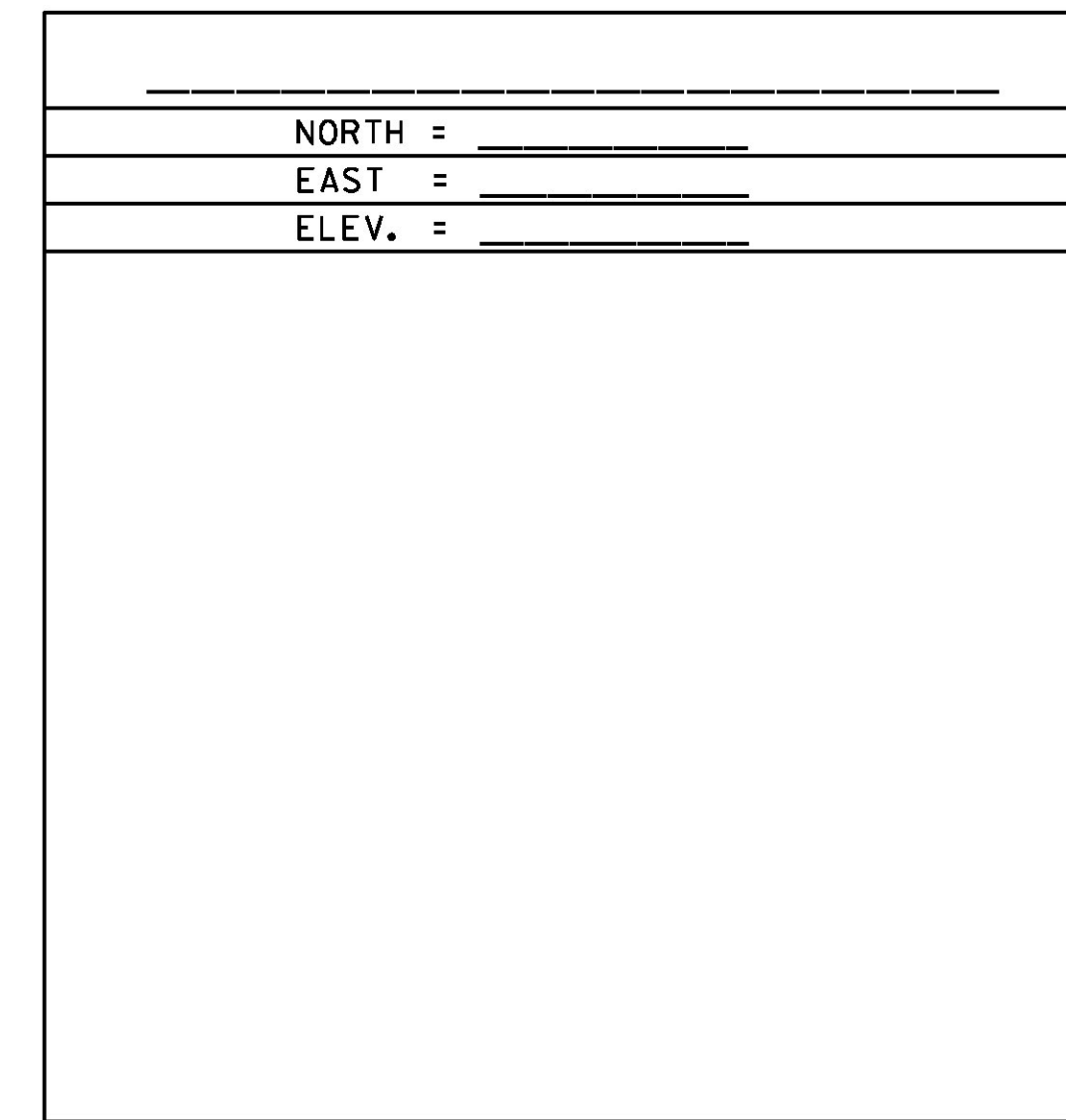
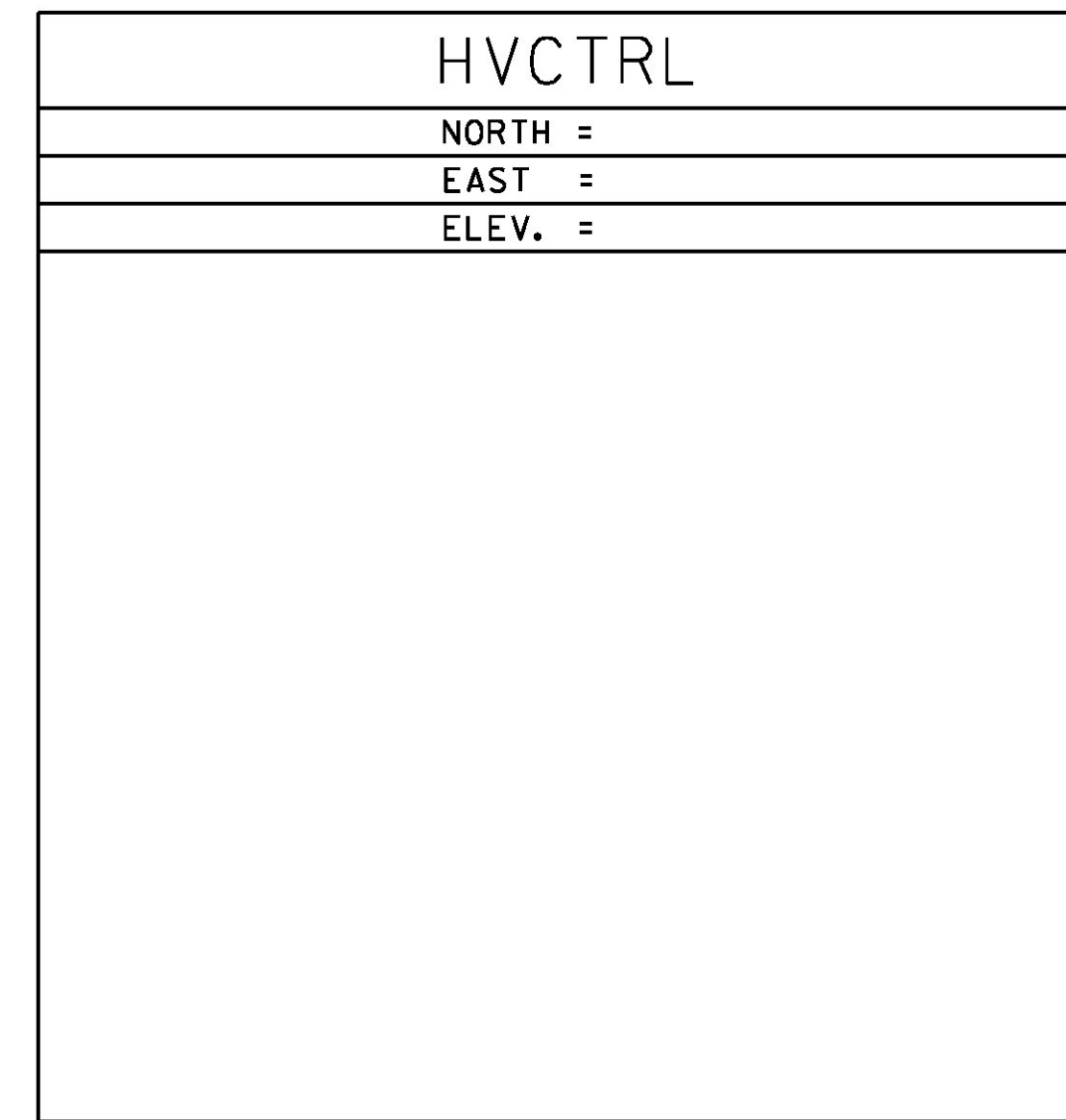
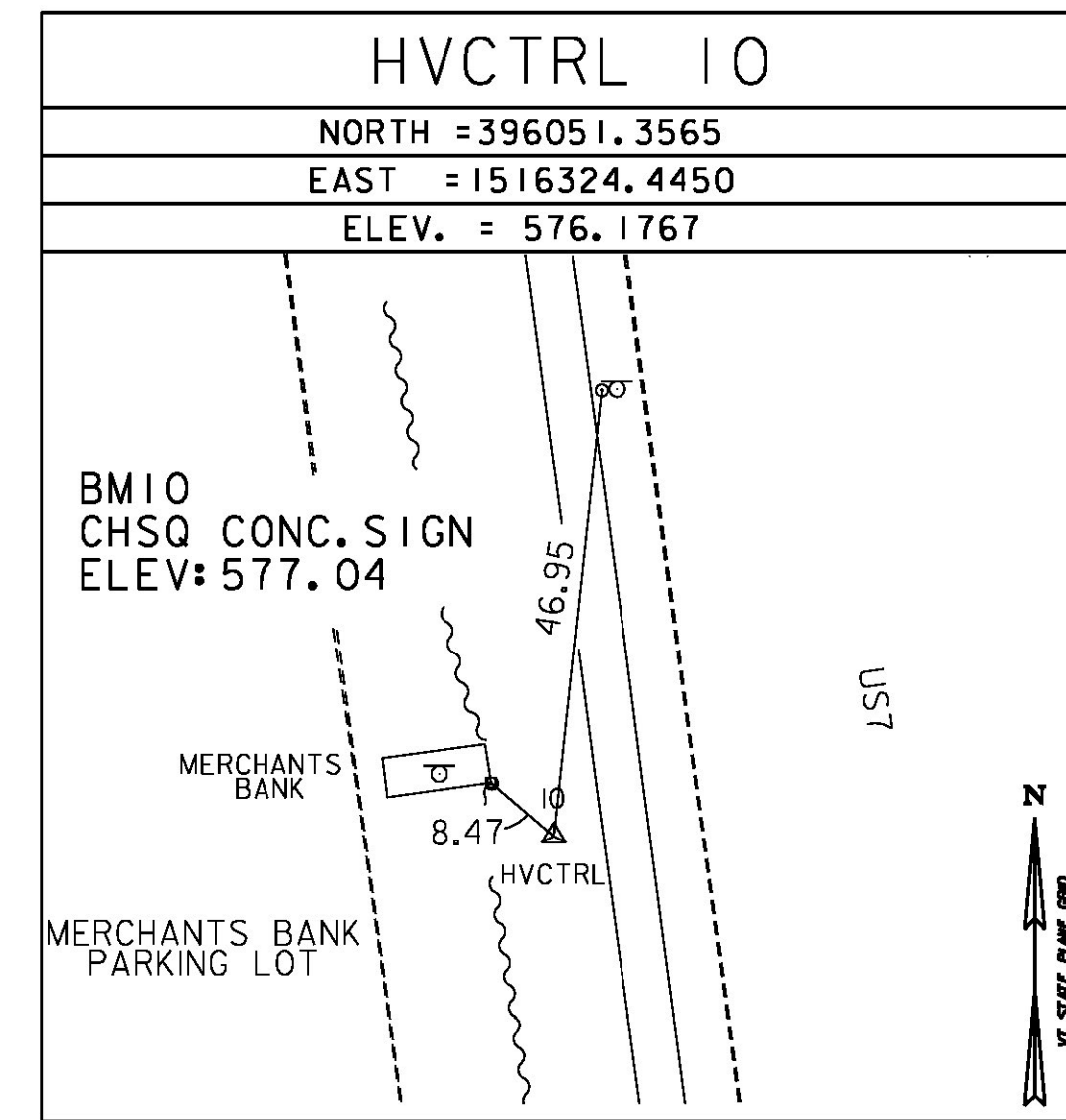
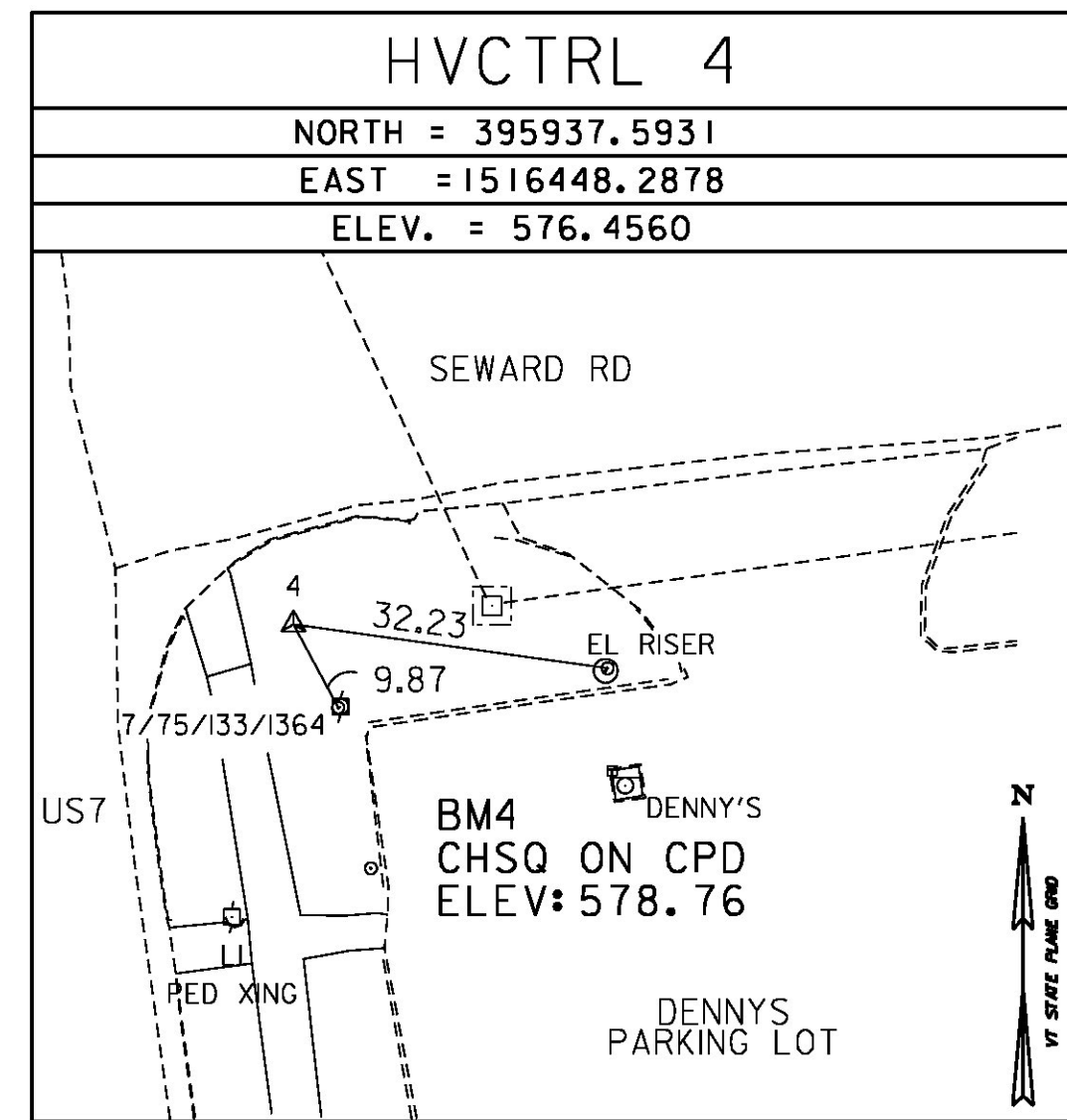

ALIGNMENT TIES

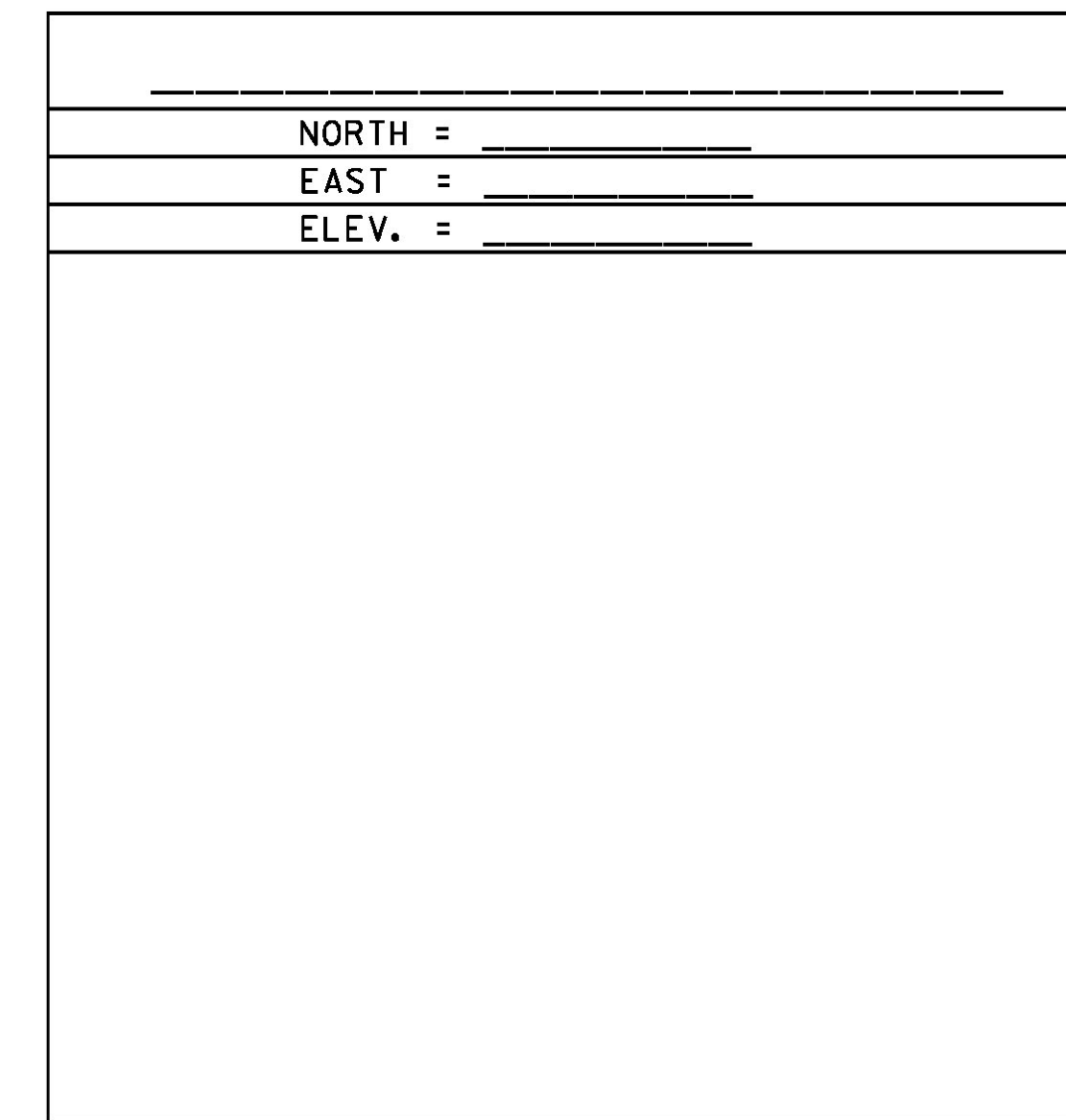
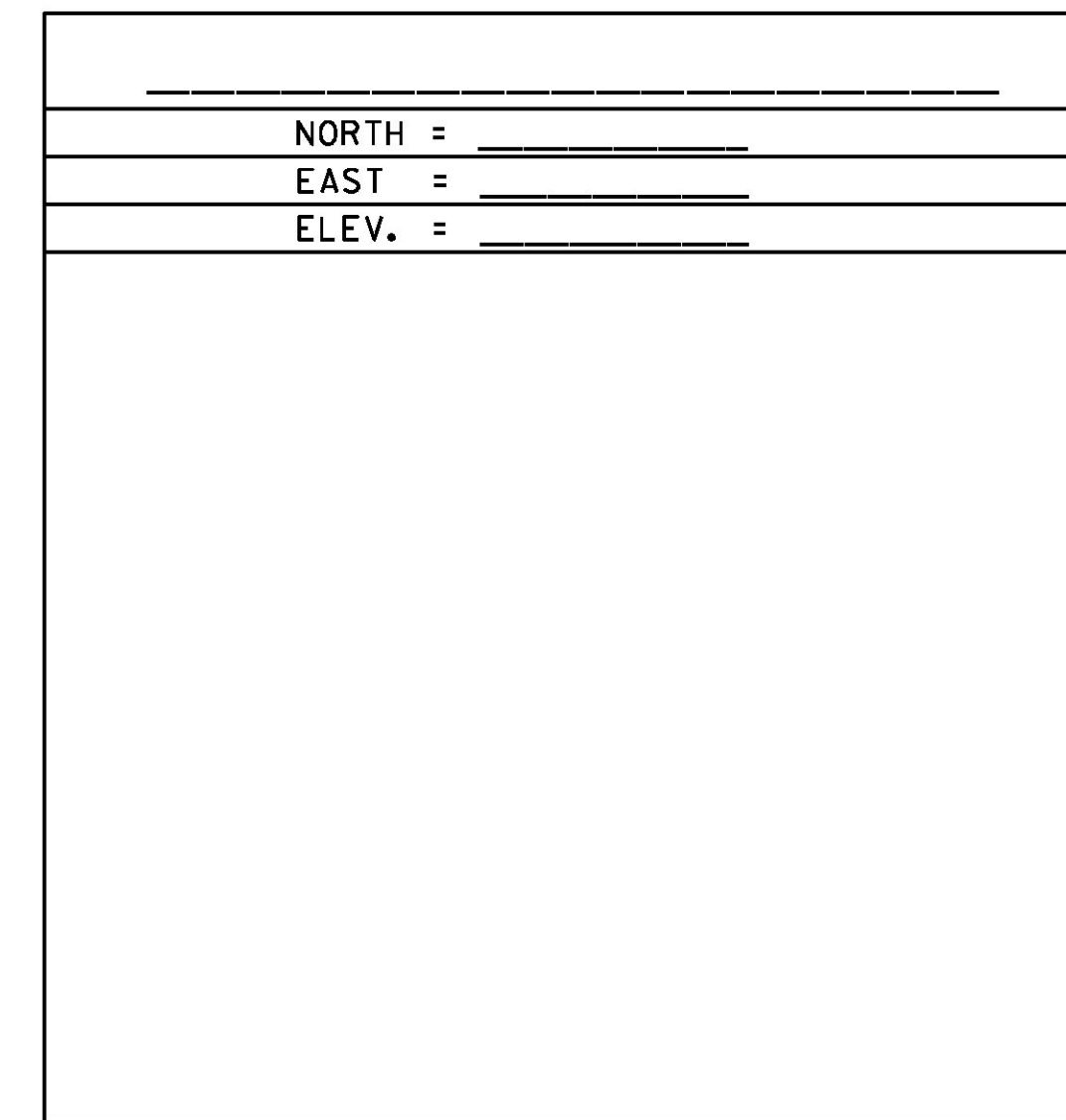
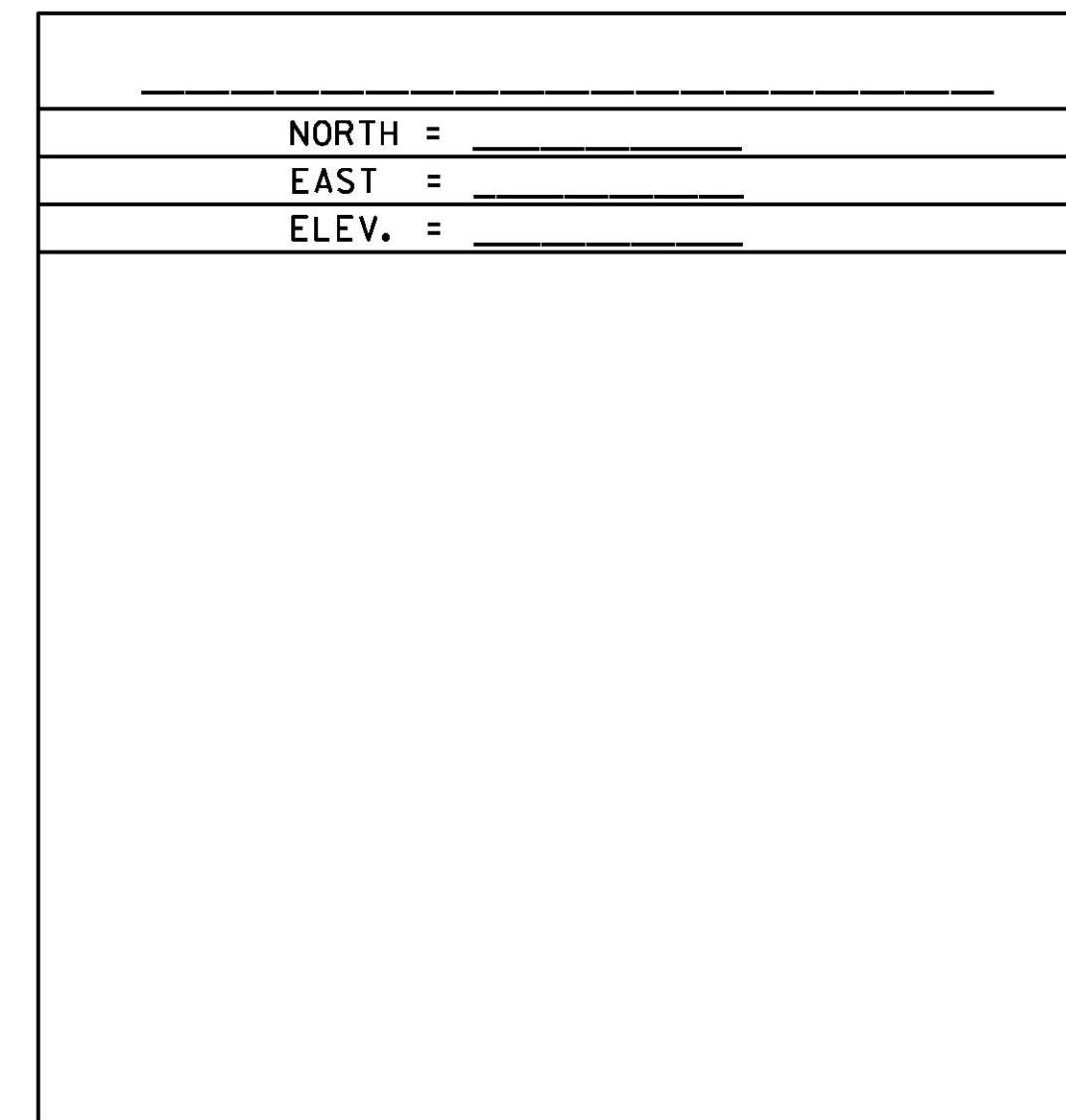
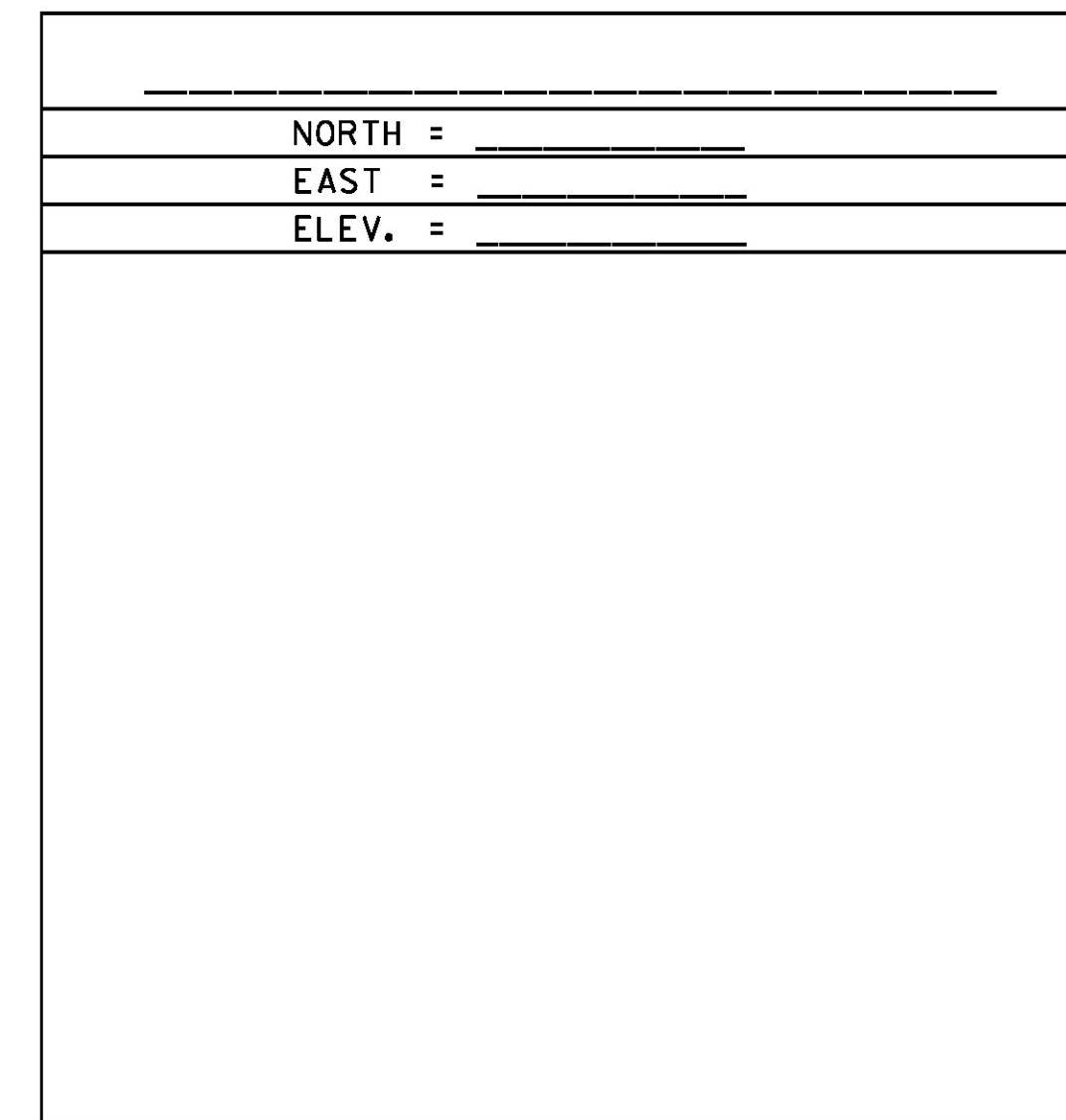
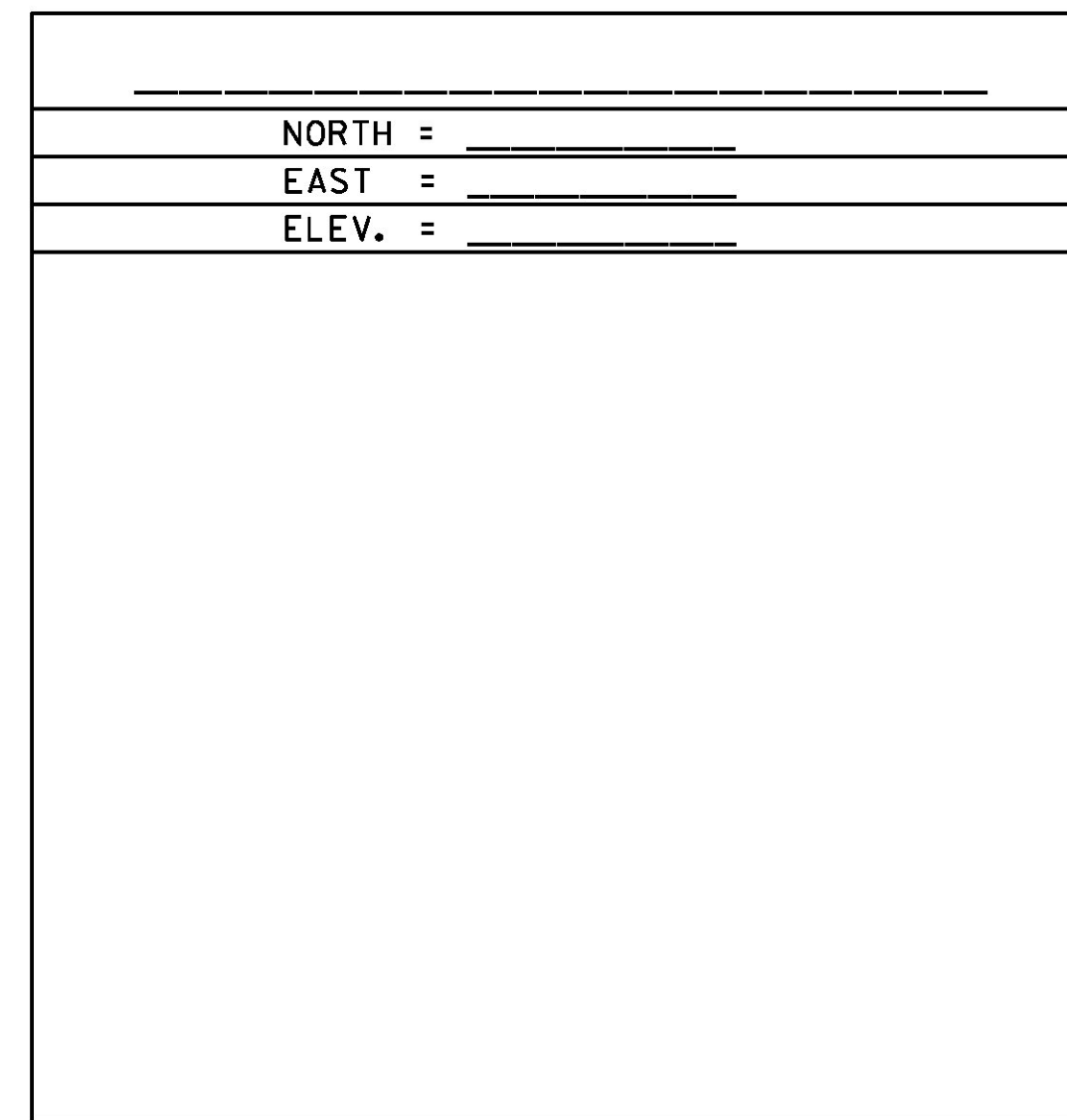

DATUM  
 VERTICAL NAVD 88  
 HORIZONTAL NAD 83 (2011)  
 ADJUSTMENT COMPASS

PROJECT NAME: RUTLAND TOWN  
 PROJECT NUMBER: NHG 019-3(60)  
 FILE NAME: X14T190T.DGN  
 PROJECT LEADER: M. BOGACZYK  
 DESIGNED BY: VTRANS  
 TIE SHEET 1  
 PLOT DATE: 2/7/2017  
 DRAWN BY: H. MCGOWAN  
 CHECKED BY: G. HITCHCOCK  
 SHEET 4 OF 17