

PROPOSED CONSTRUCTION ACTIVITIES ASSOCIATED WITH CONSTRUCTION SEQUENCING, PHASE 2

1. PRIOR TO THE COMMENCEMENT OF ANY WORK OR THE PLACEMENT OF EQUIPMENT ON THE ROADWAY THE CONTRACTOR SHALL PROVIDE ADVANCED WARNING SIGNS IN ACCORDANCE WITH THE CONSTRUCTION APPROACH SIGNING PLAN AND THE LATEST VERSION OF THE M.U.T.C.D. AND ITS REVISIONS.
2. INSTALL AND MAINTAIN ANY ADDITIONAL EROSION CONTROL MEASURES IN ACCORDANCE WITH THE EPSC PLANS AND DETAILS AND THE VERMONT D.E.C.'S "LOW RISK SITE HANDBOOK FOR EROSION PREVENTION AND SEDIMENT CONTROL."
3. INSTALL ALL WARNING SIGNS, REFLECTORIZED DRUMS, TRAFFIC BARRIER, AND ANY OTHER TRAFFIC CONTROL DEVICES PER ACCEPTED TRAFFIC CONTROL PLAN OR AS DIRECTED BY THE ENGINEER.
4. REMOVE AND RETAIN VT 15 EAST, WEST AND NORTH SPLITTER ISLAND CURBING. REMOVE ALL SPLITTER ISLAND CONCRETE AND BRING TO SURROUNDING ROADWAY GRADE.
5. REMOVE SOUTHERN HALF OF EXISTING TRUCK APRON.
6. THE CONTRACTOR SHALL HAVE THE OPTION OF CLOSING CHURCH STREET FOR THIS WORK. SEE NOTE 2 ON THE CONSTRUCTION SEQUENCING GENERAL NOTES.
7. TWO LANE, TWO WAY TRAFFIC SHALL BE MAINTAINED DURING NON-WORKING HOURS. A MINIMUM OF TWO WAY, ONE LANE TRAFFIC SHALL BE MAINTAINED AND OPEN DURING WORKING HOURS.

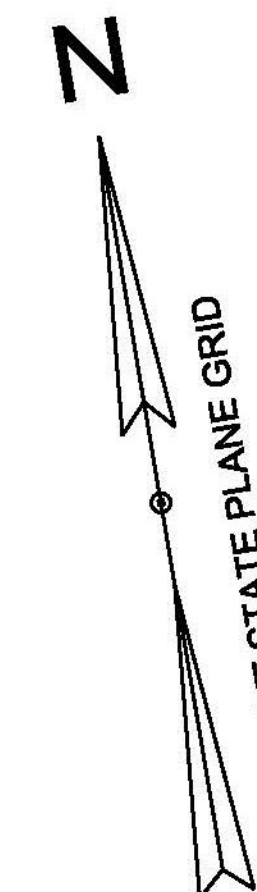

VT ROUTE 100 STA. 41+50.53  
END PROJECT  
HES 030-2(34)

CENTER OF ROUNDABOUT  
VT ROUTE 15 STA. 96+37.69 =  
VT ROUTE 100 STA. 40+00.00 (MM 0.00) =  
TH 5 STA. 63+59.48

VT ROUTE 15 STA. 97+80.66  
END PROJECT  
HES 030-2(34)

VT ROUTE 15 STA. 94+80.66  
BEGIN PROJECT  
HES 030-2(34)

T.H. 5 STA. 62+00.00  
BEGIN PROJECT  
HES 030-2(34)

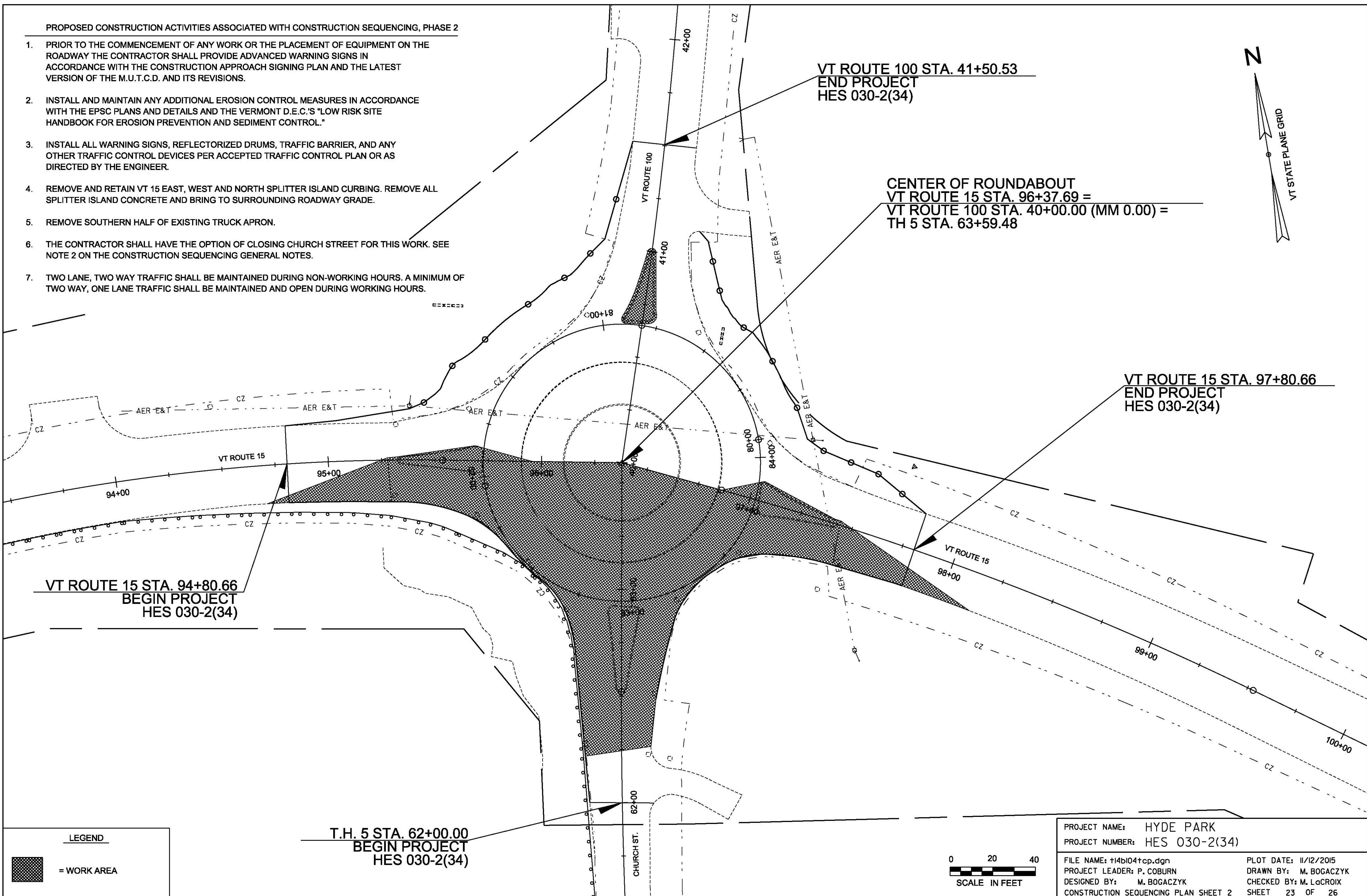

**LEGEND**

= WORK AREA

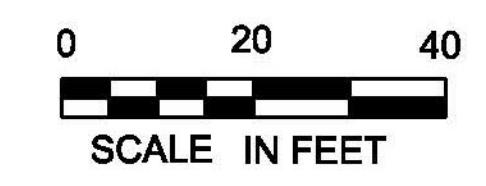

PROJECT NAME:	HYDE PARK	PLOT DATE:	11/12/2015
PROJECT NUMBER:	HES 030-2(34)	DRAWN BY:	M. BOGACZYK
FILE NAME:	t14b104+cp.dgn	CHECKED BY:	M. LaCROIX
PROJECT LEADER:	P. COBURN	CONSTRUCTION SEQUENCING PLAN SHEET 2	SHEET 23 OF 26
DESIGNED BY:	M. BOGACZYK		