

BACKGROUND: ORANGE
BORDER AND LEGEND: BLACK

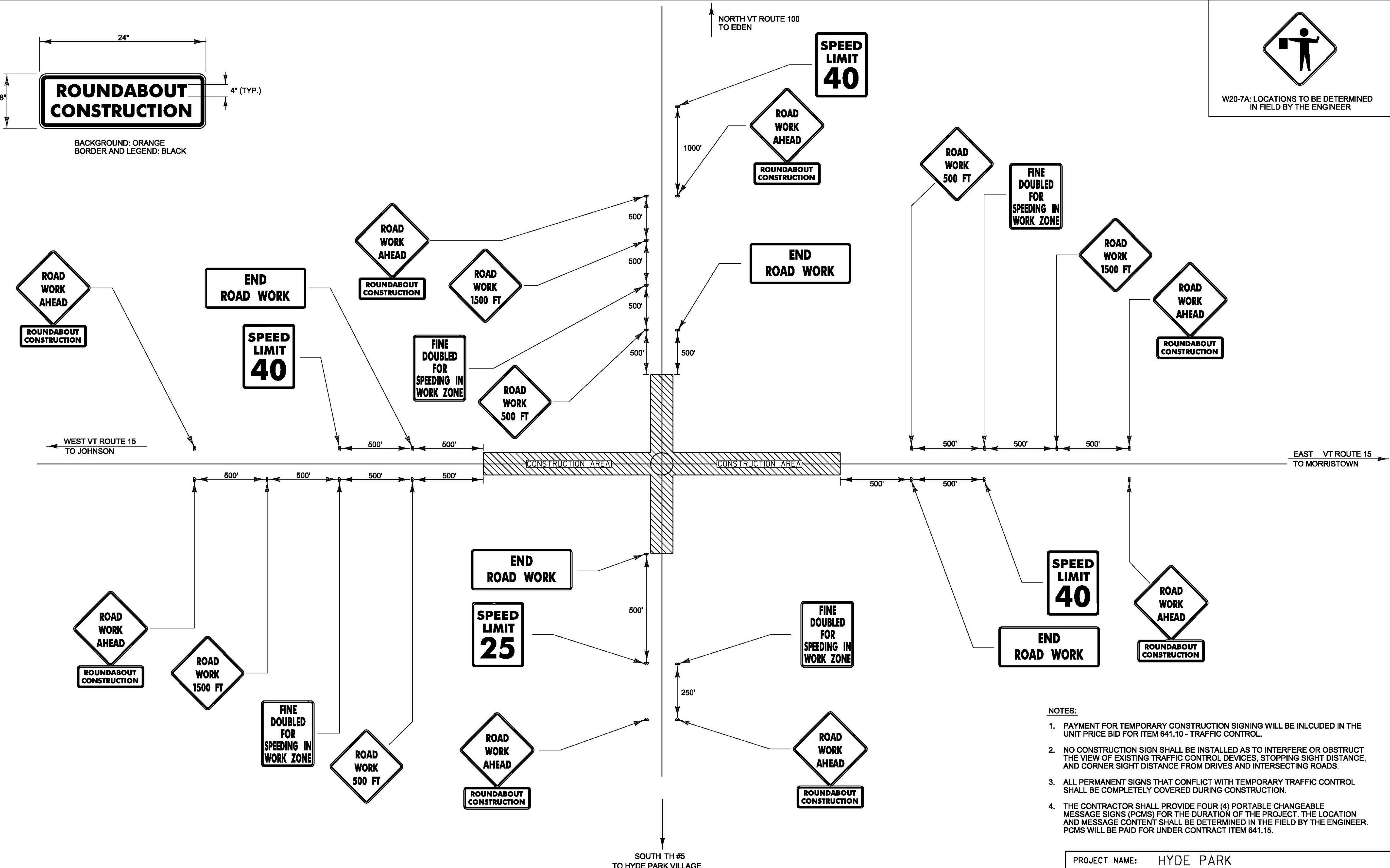

W20-7A: LOCATIONS TO BE DETERMINED
IN FIELD BY THE ENGINEER



- NOTES:**
1. PAYMENT FOR TEMPORARY CONSTRUCTION SIGNING WILL BE INCLUDED IN THE UNIT PRICE BID FOR ITEM 641.10 - TRAFFIC CONTROL.
 2. NO CONSTRUCTION SIGN SHALL BE INSTALLED AS TO INTERFERE OR OBSTRUCT THE VIEW OF EXISTING TRAFFIC CONTROL DEVICES, STOPPING SIGHT DISTANCE, AND CORNER SIGHT DISTANCE FROM DRIVES AND INTERSECTING ROADS.
 3. ALL PERMANENT SIGNS THAT CONFLICT WITH TEMPORARY TRAFFIC CONTROL SHALL BE COMPLETELY COVERED DURING CONSTRUCTION.
 4. THE CONTRACTOR SHALL PROVIDE FOUR (4) PORTABLE CHANGEABLE MESSAGE SIGNS (PCMS) FOR THE DURATION OF THE PROJECT. THE LOCATION AND MESSAGE CONTENT SHALL BE DETERMINED IN THE FIELD BY THE ENGINEER. PCMS WILL BE PAID FOR UNDER CONTRACT ITEM 641.15.

CONSTRUCTION APPROACH SIGNING

NOT TO SCALE
SEE STD T-1 AND T-10 FOR SIGN PLACEMENT

PROJECT NAME:	HYDE PARK	PLOT DATE:	11/12/2015
PROJECT NUMBER:	HES 030-2(34)	PROJECT LEADER:	P. COBURN
FILE NAME:	t14b104frm.dgn	DESIGNED BY:	M. BOGACZYK
		CHECKED BY:	M. LACROIX
		CONSTRUCTION APPROACH SIGNING PLAN	SHEET 20 OF 26