

TOP CHORD PLAN

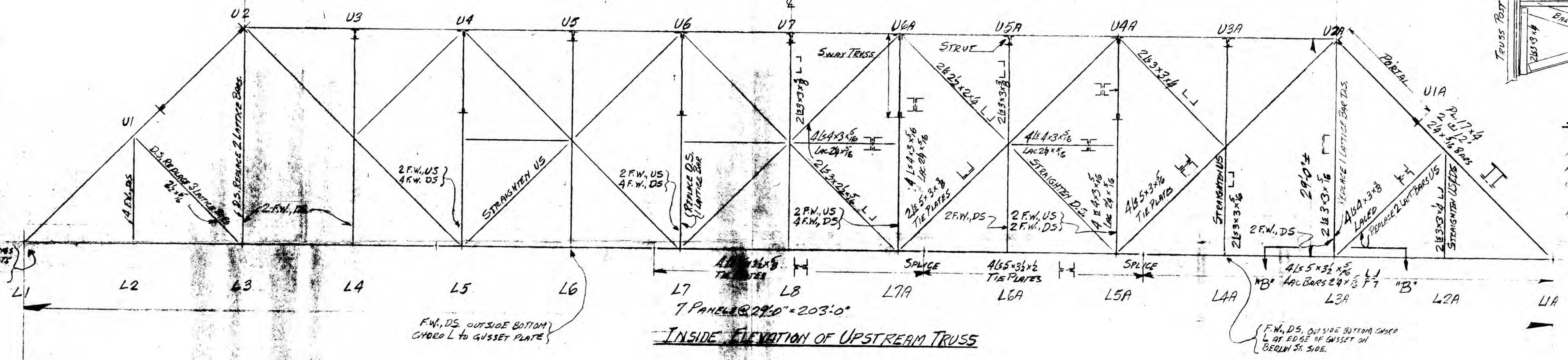

INSIDE ELEVATION OF UPSTREAM TRUSS

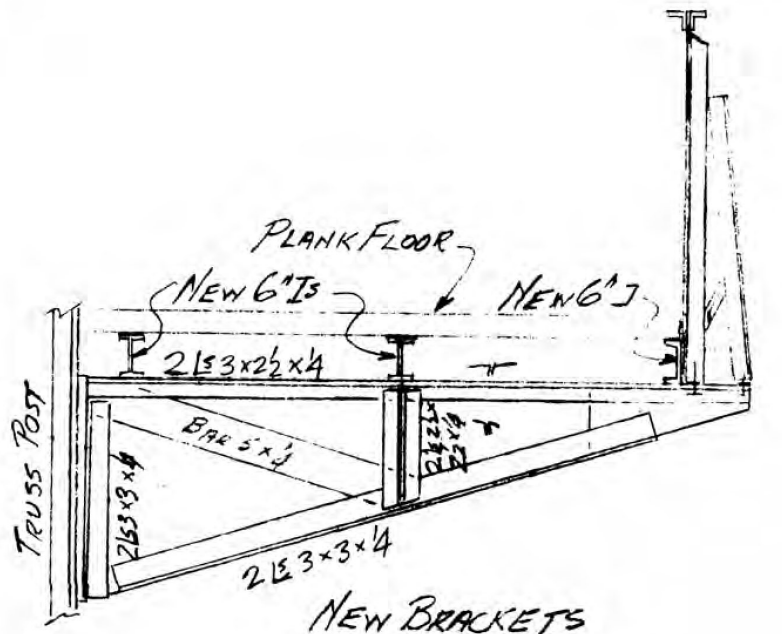

SECTION A-A

NOT ALL BRACKETS REQUIRE COMPLETE RENEWAL. SUCH BRACKETS MAY BE REPAIRS AT THE SITE BY REPLACEMENT IN KIND OF DEFECTIVE MEMBERS. RAILING AND RAILING POSTS TO BE REHABILITATED IN KIND.

TRANSITION ENDWORK (CONCRETE) WITH TRUSSES. NEW BRACKETS, ANCHOR BOLTS AND POSSIBLE MASONRY PLATES.

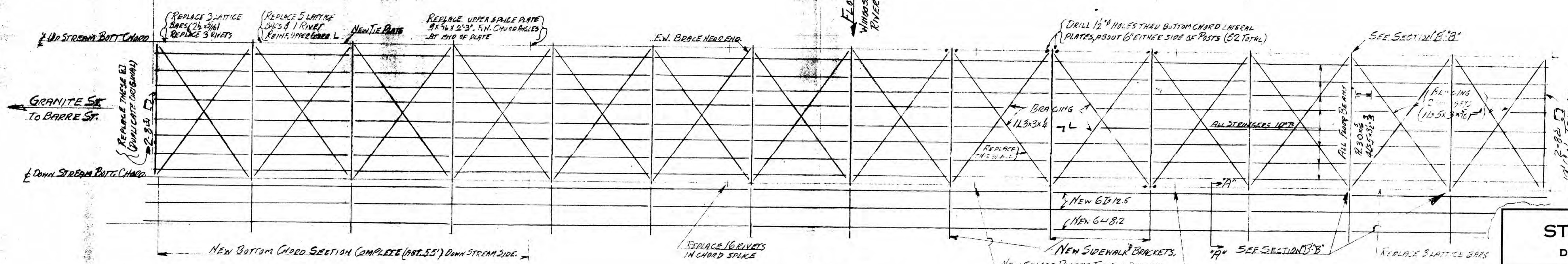

FLOOR PLAN

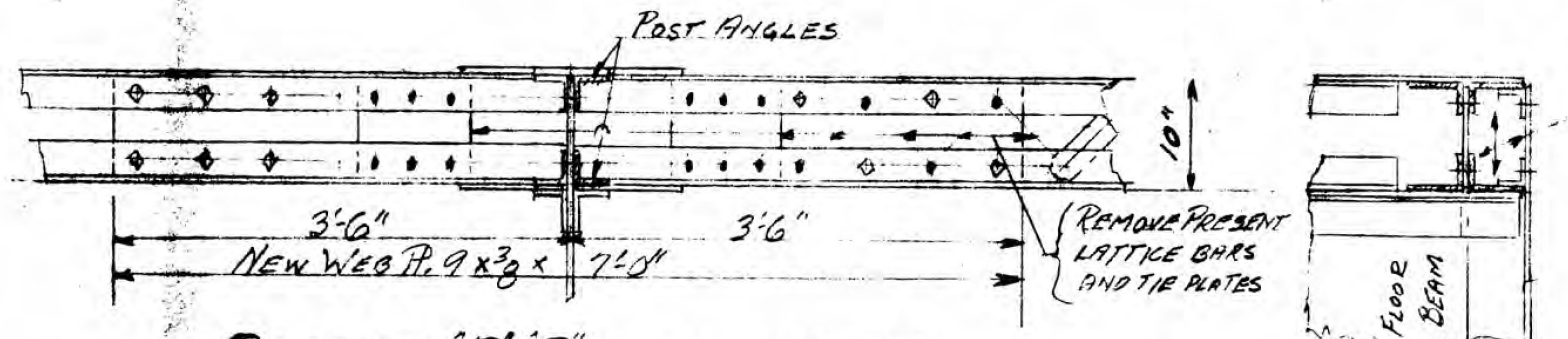

SECTION B-B Scale = 3/4" = 1'-0"
As shown for joint - L3A UPSTREAM OPPOSITE HAND FOR L2A DOWNSTREAM SIMILAR FOR L2A DOWNSTREAM

- INDICATES PRESENT RIVETS TO BE REMOVED AND NAILS RE-USED.
- INDICATES NEW HIGH TENSILE BOLTS IN FIELD DRILLED HOLES.

NOTES

THIS DRAWING SHOWS THE GENERAL LAYOUT OF THE EXISTING BRIDGE AND THE PROPOSED REPAIRS. IT IS NOT GUARANTEED TO BE CORRECT IN EVERY DETAIL, NOR TO COVER EVERY NECESSARY DETAIL.

F.W. = FILLER WELD, FITTING CALLED POINTS WHERE ORIGINAL SECTIONS ARE PARTIAL.

U.S. = UPSTREAM. D.S. = DOWNSTREAM.

WHERE NEW METAL COMES IN CONTACT WITH OLD, THE SURFACES OF THE OLD METAL SHOULD BE THOROUGHLY CLEANED. HIGH TENSILE BOLTS, WITH HARDENED WASHERS, THE SIZE OF REPLACED RIVETS AND FULLY TOUGHED NAILS BE USED.

BEARING REPLACEMENT WORK AT BARRE ST. END TO BE DONE AFTER OTHER STRUCTURAL REPAIRS ARE COMPLETED.

ALL NEW STEEL TO BE GALVANIZED OR PAINTED TO PREVENT CORROSION.

STATE OF VERMONT
DEPARTMENT OF HIGHWAYS

TOWN OF MONTPELIER
ROAD NO. GRANITE ST. BRIDGE NO.

GENERAL REPAIRS - 1955
SCALE 3/8" = 1'-0"

SURVEYED BY
DRAWN BY HES. CHECKED BY

PROJECT NO. T7-1954
SHEET 1 OF

TCH-20