

## P-51 Swift Lift Lifting Eye

The P-51 Swift Lift Lifting eye is a high quality, high strength steel casting. Its ball shaped lower end fits into the void formed in the concrete and engages the spherical head of the anchor. Attachment to the anchor head can only be made when the lifting eye is positioned with its front face toward the concrete. In the working position, release is impossible. Accidental disengagement is prevented by a gravity-action safety pin that must be raised before the Lifting Eye can be removed.

The P-51 Swift Lift Lifting Eye is available with safe working loads of 2, 4 and 8 tons. It is extremely versatile in use, being suitable for vertical pull or diagonal pull. The Lifting Eye rotates freely (360°) about the vertical axis of the anchor. Each unit is clearly marked with its MAXIMUM safe working load.

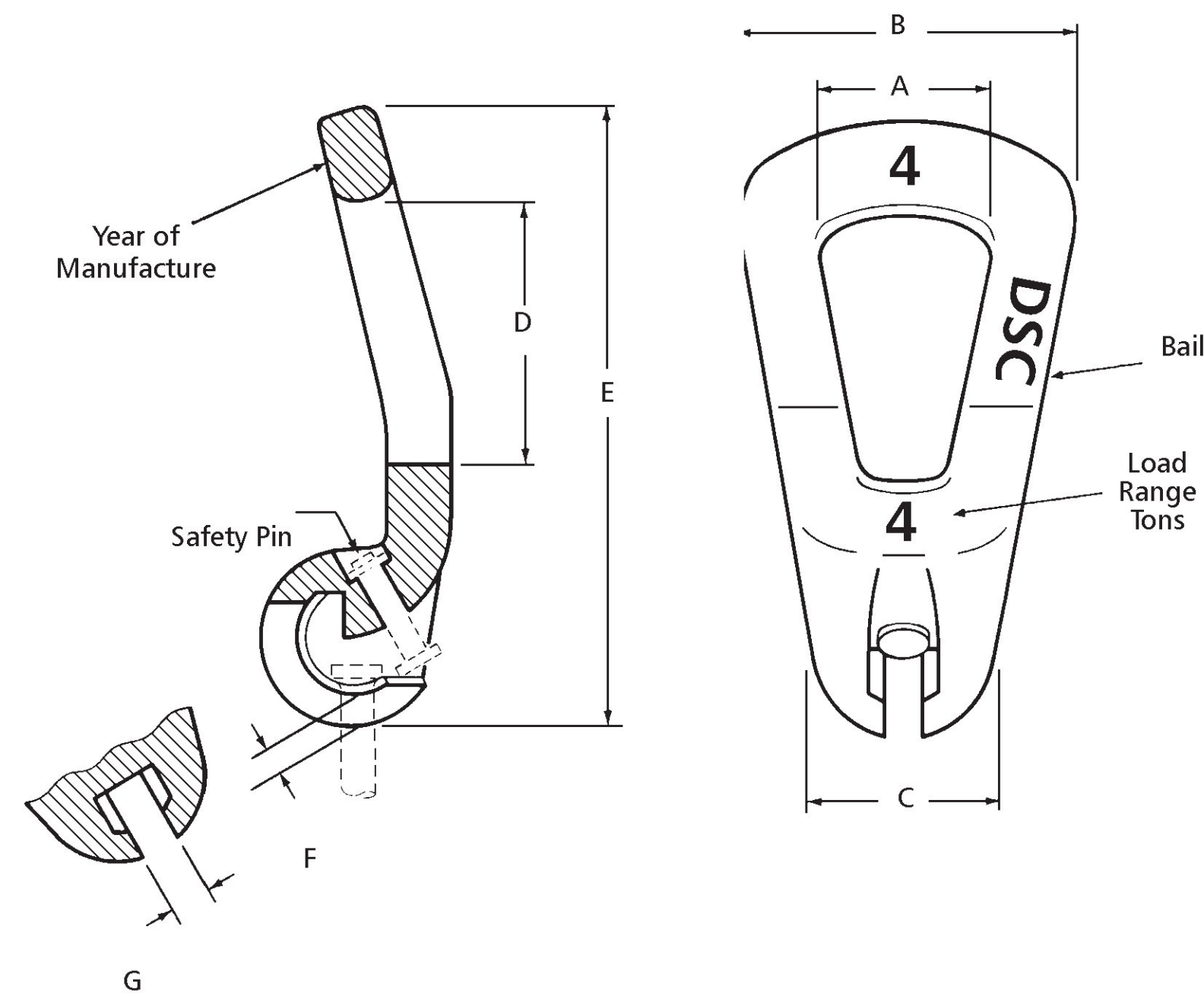

| P - 5 1 S w i f t L i f t L i f t i n g E y e S e l e c t i o n C h a r t |            |            |            |            |            |
|---|------------|------------|------------|------------|------------|
| Safe Working Loads (tons)   | A (Inches) | B (Inches) | C (Inches) | D (Inches) | E (Inches) |
| 2   | 2.64       | 4.52       | 2.36       | 3.74       | 8.43       |
| 4   | 3.00       | 5.06       | 2.83       | 4.96       | 10.35      |
| 8   | 3.54       | 5.98       | 3.70       | 5.60       | 12.87      |

Safe Working Load provides a factor of safety of approximately 5 to 1.

## Inspection and Maintenance

While appreciable wear does not normally occur, the P-51 Swift Lift Lifting Eye may be subjected to wear, misuse, overloading and other factors that may affect the lifting eye's rated load. Therefore, the user must inspect lifting eyes at least once a month to determine general condition, degree of wear and any evidence of heat application.

If evidence of heat application is found, the unit must be destroyed. In addition, check to make certain that the bail is not bent or twisted. Destroy all units that have a bent or twisted bail.

Check the safety pin; missing pins must be replaced. Make sure the safety pin is in good condition and moves freely at all times. At least once every three months, dimensions "G" and "F" on each unit should be checked. The upper limits are shown in the chart. If either of these limits is exceeded, the Swift Lift Lifting Eye must be removed from service and destroyed.

The proper method to use in destroying a lifting eye is to cut through the bail with a cutting torch. Other than replacing the safety pin, no repairs to the P-51 Swift Lift Lifting Eye are permitted. In particular, welding is not permitted.

| Limiting Dimensions on P-51 Swift Lift Lifting Eye |            |            |
|--|------------|------------|
| Safe Working Load (tons)                           | G (Inches) | F (Inches) |
| 2  | 0.709      | 0.236      |
| 4  | 0.984      | 0.315      |
| 8  | 1.260      | 0.472      |

Vermont Agency of Transportation  
**RECEIVED**  
 CK'D BY NVDB, JW, KM, TM OK'D BY JG  
 March 21, 2017  
 RESUBMIT No Approved  
 BY K. Higgins DATE 03/23/17

Swift Lift System