

4 INCH YELLOW LINE, LOW VOC CHLORINATED RUBBER PAINT AND TEMPORARY 4 INCH YELLOW LINE, PAINT
 (ALL LINES WILL INCLUDE C/L LINE BREAKS FOR TOWN HIGHWAYS)
 S = SOLID, D = DASHED
 ESSEX JUNCTION:
 STA MA 12+00.00 - STA MA 17+00.00
 LT C RT
 S - S

6 INCH WHITE LINE, LOW VOC CHLORINATED RUBBER PAINT AND TEMPORARY 6 INCH WHITE LINE, PAINT
 (ALL LINES WILL INCLUDE EDGE LINE BREAKS FOR TOWN HIGHWAYS)
 ESSEX JUNCTION:
 STA MA 12+00.00 - STA MA 14+10.00 BIKE LANE EDGE LINE LT
 STA MA 12+00.00 - STA MA 17+00.00 BIKE LANE EDGE LINE RT
 STA MA 14+50.00 - STA MA 17+00.00 BIKE LANE EDGE LINE LT

CROSSWALK MARKING, LOW VOC CHLORINATED RUBBER PAINT AND TEMPORARY CROSSWALK MARKING, PAINT
 ESSEX JUNCTION:
 STA MA 14+30.88 LT, OAK STREET

TEMPORARY LETTER OR SYMBOL, PAINT
 ESSEX JUNCTION:
 STA MA 12+92.00 RT, BIKE LANE SYMBOL (2 EA)
 STA MA 13+75.00 LT, BIKE LANE SYMBOL (2 EA)

LETTER OR SYMBOL, LOW VOC CHLORINATED RUBBER PAINT
 ESSEX JUNCTION:
 STA MA 12+92.00 RT, BIKE LANE SYMBOL (1 EA)
 STA MA 13+75.00 LT, BIKE LANE SYMBOL (1 EA)

24 INCH STOP BAR, LOW VOC CHLORINATED RUBBER PAINT AND TEMPORARY 24 INCH STOP BAR, PAINT
 STA MA 14+30.88 LT, OAK STREET

4 INCH WHITE LINE, LOW VOC CHLORINATED RUBBER PAINT AND TEMPORARY 4 INCH WHITE LINE, PAINT
 (ALL LINES WILL INCLUDE EDGE LINE BREAKS AND RADIUS FOR TOWN HIGHWAYS)
 ESSEX JUNCTION:
 STA MA 12+00.00 - STA MA 14+10.00 BIKE LANE LINE LT
 STA MA 12+00.00 - STA MA 14+10.00 HATCH BUFFER LT
 STA MA 12+00.00 - STA MA 17+00.00 BIKE LANE LINE RT
 STA MA 12+00.00 - STA MA 17+00.00 HATCH BUFFER RT
 STA MA 14+10.00 - STA MA 14+50.00 DOTTED BIKE LANE LINE LT
 STA MA 14+50.00 - STA MA 17+00.00 BIKE LANE LINE LT
 STA MA 14+50.00 - STA MA 17+00.00 HATCH BUFFER LT

REMOVING SIGNS AS SHOWN - 12
 ERECTING SALVAGED SIGNS AS SHOWN - 1

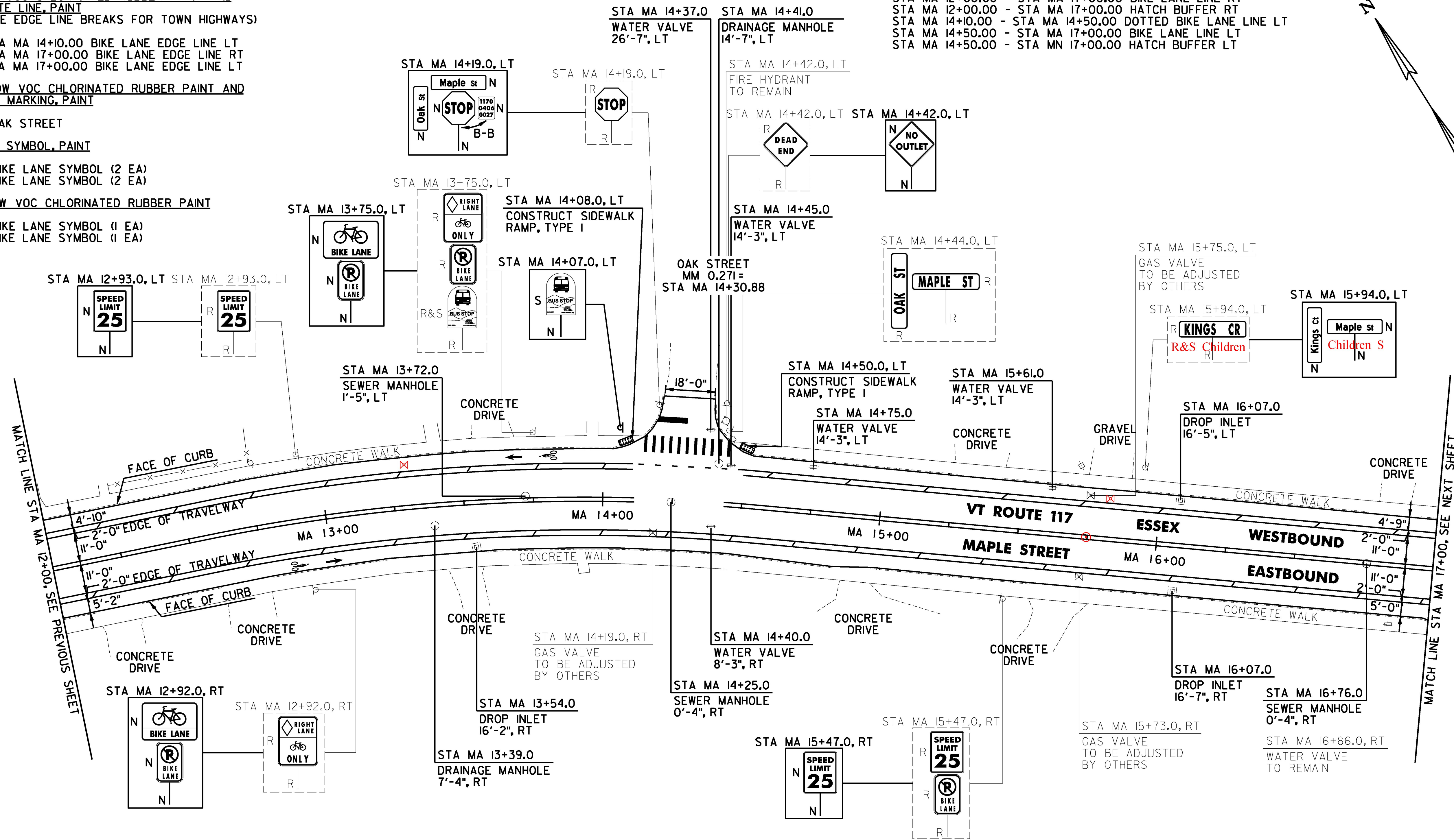

REHAB. DROP INLETS, CATCH BASINS, OR MANHOLES, CLASS I, II OR III
 ESSEX JUNCTION:
 STA MA 13+39.0 RT MA 13+72 LT
 STA MA 13+54.0 RT MA 14+25 RT
 STA MA 14+41.0 LT MA 15+73 RT
 STA MA 16+07.0 RT MA 16+76 LT
 STA MA 16+07.0 LT

ADJUST ELEVATION OF VALVE BOX
 ESSEX JUNCTION:
 STA MA 14+37.0 LT MA 13+30 LT
 STA MA 14+40.0 RT MA 15+80 LT
 STA MA 14+45.0 LT
 STA MA 14+75.0 LT
 STA MA 15+61.0 LT

CHANGING ELEVATION OF SEWER MANHOLES
 ESSEX JUNCTION:
 STA MA 13+72.0 LT MA 13+54 RT
 STA MA 14+25.0 RT MA 14+41 LT
 STA MA 16+76.0 LT

DETECTABLE WARNING SURFACE
 ESSEX JUNCTION:
 STA MA 14+08.0 LT
 STA MA 14+50.0 LT
 PORTLAND CEMENT CONCRETE SIDEWALK, 5 INCH
 ESSEX JUNCTION:
 STA MA 14+08.0 LT
 STA MA 14+50.0 LT

REMOVAL OF EXISTING CURB
 ESSEX JUNCTION:
 STA MA 14+08.0 LT
 STA MA 14+50.0 LT
 CAST-IN-PLACE CONCRETE CURB, TYPE B
 ESSEX JUNCTION:
 STA MA 14+08.0 LT
 STA MA 14+50.0 LT

SIGN LEGEND
 R = REMOVE
 S = SALVAGE
 N = NEW
 RET = RETAIN
 B-B = BACK TO BACK
 EXISTING = ---
 NEW = ---
 R = RETURN TO VILLAGE OF ESSEX JUNCTION

NOT TO SCALE
CHA

PROJECT NAME: ESSEX JUNCTION
 PROJECT NUMBER: NH 2956(2)

FILE NAME: z15v026bdr.dgn
 PROJECT LEADER: D.GOZALKOWSKI
 DESIGNED BY: J. SCUDDER
 PLAN SHEET 26

PLOT DATE: 4/19/2016
 DRAWN BY: C. KAHLBAUGH
 CHECKED BY: J. SHIELDS
 SHEET 108 OF 171