

4 INCH WHITE LINE, LOW VOC CHLORINATED RUBBER PAINT AND TEMPORARY 4 INCH WHITE LINE, PAINT
 (ALL LINES WILL INCLUDE EDGE LINE BREAKS AND RADIUS FOR TOWN HIGHWAYS)
 ESSEX JUNCTION:
 STA MN 159+22.34 EDGE LINES LT, TAFT STREET
 STA MN 159+57.00 - STA MN 162+00.00 EDGE LINE RT

6 INCH WHITE LINE, LOW VOC CHLORINATED RUBBER PAINT AND TEMPORARY 6 INCH WHITE LINE, PAINT
 (ALL LINES WILL INCLUDE EDGE LINE BREAKS AND RADIUS FOR TOWN HIGHWAYS)
 ESSEX JUNCTION:
 STA MN 157+00.00 - STA MN 158+85.00 BIKE LANE LINE LT
 STA MN 157+00.00 - STA MN 159+49.00 BIKE LANE LINE RT
 STA MN 158+85.00 - STA MN 159+40.00 DOTTED LANE LINES LT
 STA MN 159+59.00 - STA MN 162+00.00 BIKE LANE LINE LT

4 INCH YELLOW LINE, LOW VOC CHLORINATED RUBBER PAINT AND TEMPORARY 4 INCH YELLOW LINE, PAINT
 (ALL LINES WILL INCLUDE C/L LINE BREAKS FOR TOWN HIGHWAYS)
 S = SOLID, D = DASHED
 ESSEX JUNCTION:
 STA MN 159+42.00 - STA MN 161+61.00 LT & RT
 STA MN 157+00.00 - STA MN 159+02.00 DOUBLE SOLID LT & C/L
 STA MN 159+22.34 DOUBLE SOLID LT, TAFT STREET
 STA MN 161+61.00 - STA MN 162+00.00 DOUBLE SOLID MEDIAN C/L & LT

24 INCH STOP BAR, LOW VOC CHLORINATED RUBBER PAINT AND TEMPORARY 24 INCH STOP BAR, PAINT
 ESSEX JUNCTION:
 STA MN 159+22.34 LT, TAFT STREET
 LETTER OR SYMBOL, LOW VOC CHLORINATED RUBBER PAINT
 ESSEX JUNCTION:
 STA MN 158+76.00 LT, BIKE LANE SYMBOL (1EA)
 STA MN 159+68.00 LT, BIKE LANE SYMBOL (1EA)
 TEMPORARY LETTER OR SYMBOL, PAINT
 ESSEX JUNCTION:
 STA MN 158+76.00 LT, BIKE LANE SYMBOL (1EA)
 STA MN 159+68.00 LT, BIKE LANE SYMBOL (1EA)

8 INCH YELLOW LINE, LOW VOC CHLORINATED RUBBER PAINT
 ESSEX JUNCTION:
 STA MN 161+61.00 - STA MN 162+00.00 HATCHED MEDIAN LT & RT
 CROSSWALK MARKING, LOW VOC CHLORINATED RUBBER PAINT AND TEMPORARY CROSSWALK MARKING, PAINT
 ESSEX JUNCTION:
 STA MN 159+50.00 LT & RT
 REMOVING SIGNS
 AS SHOWN - 7

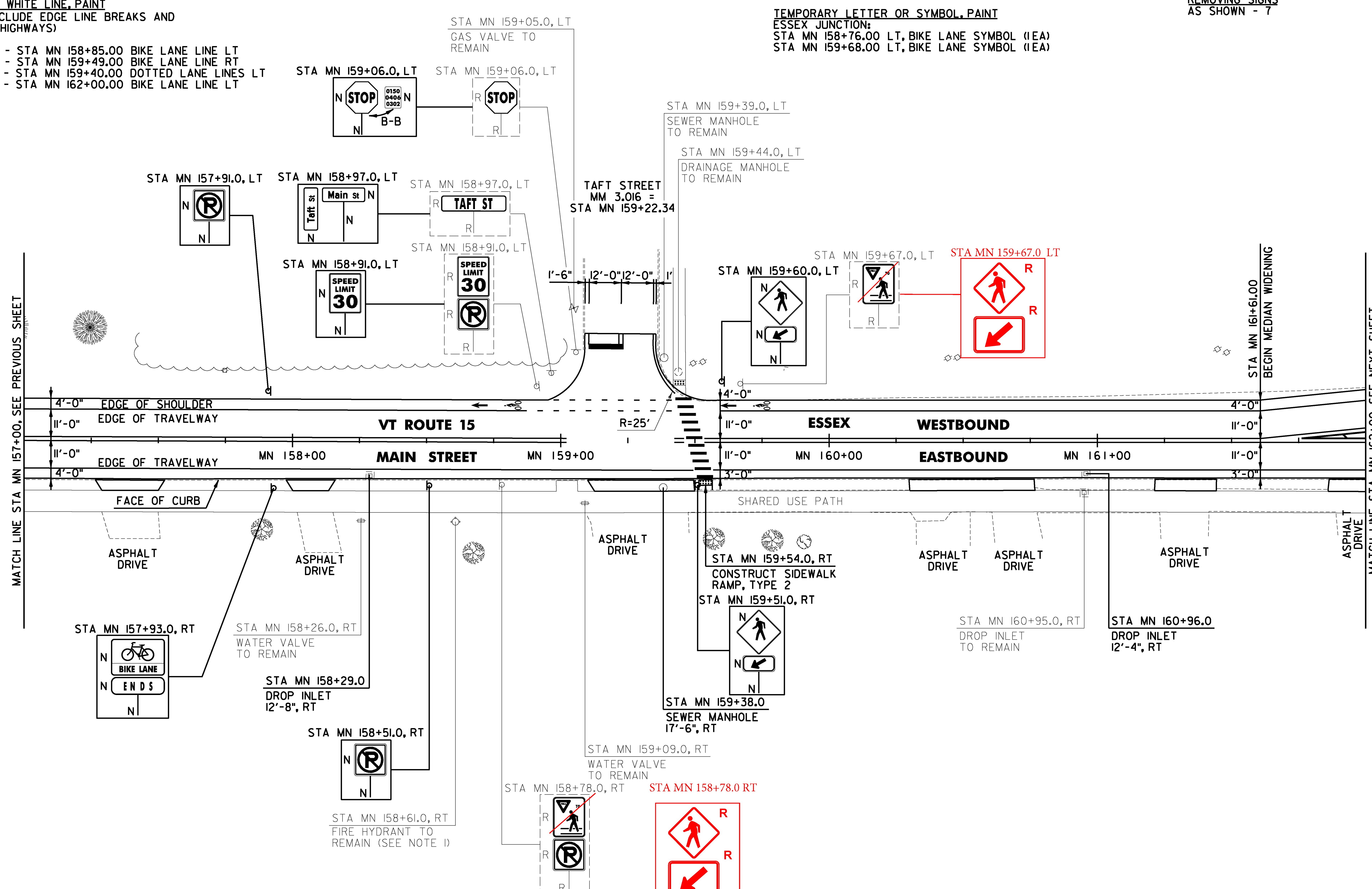
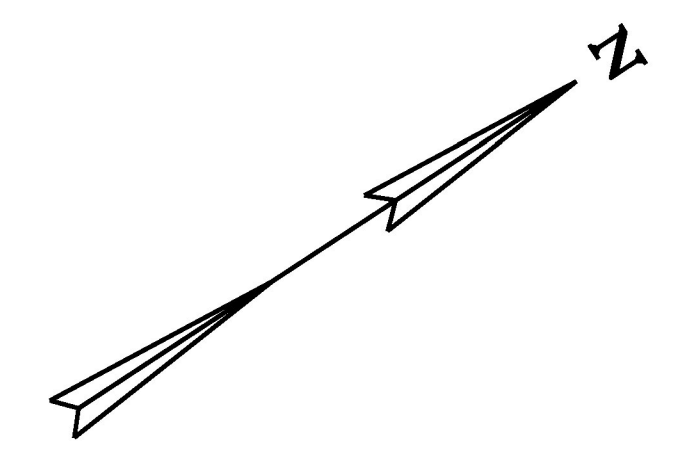

DETECTABLE WARNING SURFACE
 ESSEX JUNCTION:
 STA MN 159+54.0 RT
 PORTLAND CEMENT CONCRETE
 SIDEWALK, 5 INCH
 ESSEX JUNCTION:
 STA MN 159+54.0 RT

REMOVAL OF EXISTING CURB
 ESSEX JUNCTION:
 STA MN 159+54.0 RT
 MN 159+44 LT
 CAST-IN-PLACE CONCRETE
 CURB, TYPE B
 ESSEX JUNCTION:
 STA MN 159+54.0 RT

REHAB. DROP INLETS, CATCH BASINS,
 OR MANHOLES, CLASS I, II OR III
 ESSEX JUNCTION:
 STA MN 158+29.0 RT
 STA MN 160+96.0 RT

CHANGING ELEVATION OF
 SEWER MANHOLES
 ESSEX JUNCTION:
 STA MN 159+38.0 RT
 MN 158+29 RT
 MN 159+44 LT

SIGN LEGEND
 R = REMOVE
 S = SALVAGE
 N = NEW
 RET = RETAIN
 B-B = BACK TO BACK
 EXISTING =
 NEW =
 R = RETURN TO VILLAGE
 OF ESSEX JUNCTION

NOT TO SCALE

PROJECT NAME: ESSEX JUNCTION	PLOT DATE: 4/19/2016
PROJECT NUMBER: NH 2956(2)	DRAWN BY: C. KAHLBAUGH
FILE NAME: z15v026bdr.dgn	CHECKED BY: J. SHIELDS
DESIGNED BY: J. SCUDDER	SHEET 104 OF 171
PLAN SHEET 22	