

4 INCH YELLOW LINE, LOW VOC CHLORINATED RUBBER PAINT AND TEMPORARY 4 INCH YELLOW LINE, PAINT
 (ALL LINES WILL INCLUDE C/L LINE BREAKS FOR TOWN HIGHWAYS)
 S = SOLID, D = DASHED
 ESSEX JUNCTION:
 STA MN 137+00.00 - STA MN 137+83.00 LT & RT
 STA MN 137+83.00 - STA MN 139+77.00 DOUBLE SOLID MEDIAN LT & RT
 STA MN 140+07.84 DOUBLE SOLID RT, DENSMORE DRIVE
 STA MN 140+30.00 - STA MN 141+47.00 DOUBLE SOLID RT
 STA MN 141+47.00 - STA MN 142+00.00 DOUBLE SOLID MEDIAN RT

4 INCH WHITE LINE, LOW VOC CHLORINATED RUBBER PAINT AND TEMPORARY 4 INCH WHITE LINE, PAINT
 (ALL LINES WILL INCLUDE EDGE LINE BREAKS AND RADIUS FOR TOWN HIGHWAYS)
 ESSEX JUNCTION:
 STA MN 137+00.00 - STA MN 137+28.00 EDGE LINE LT
 STA MN 137+00.00 - STA MN 137+83.00 EDGE LINE RT
 STA MN 138+10.00 - STA MN 140+50.00 EDGE LINE RT
 STA MN 140+07.84 EDGE LINE RT, DENSMORE DRIVE
 STA MN 140+30.00 - STA MN 141+47.00 SOLID LANE LINE LT
 STA MN 141+47.00 - STA MN 142+00.00 DOTTED LANE LINE LT
 STA MN 141+67.00 - STA MN 142+00.00 EDGE LINE RT

6 INCH WHITE LINE, LOW VOC CHLORINATED RUBBER PAINT AND TEMPORARY 6 INCH WHITE LINE, PAINT
 (ALL LINES WILL INCLUDE EDGE LINE BREAKS AND RADIUS FOR TOWN HIGHWAYS)
 ESSEX JUNCTION:
 STA MN 137+83.00 - STA MN 138+83 DOTTED LANE LINES RT
 STA MN 137+28.00 - STA MN 142+00.00 BIKE LANE LINE LT
 STA MN 138+83.00 - STA MN 139+77.00 BIKE LANE LINES RT
 STA MN 139+77.00 - STA MN 140+50.00 DOTTED LANE LINES RT
 STA MN 140+50.00 - STA MN 141+47.00 BIKE LANE LINE RT
 STA MN 141+47.00 - STA MN 142+00.00 DOTTED LANE LINES RT

8 INCH YELLOW LINE, LOW VOC CHLORINATED RUBBER PAINT
 ESSEX JUNCTION:
 STA MN 137+83.00 - STA MN 139+77.00 HATCHED MEDIAN LT & RT
 STA MN 141+47.00 - STA MN 142+00.00 HATCHED MEDIAN RT

24 INCH STOP BAR, LOW VOC CHLORINATED RUBBER PAINT AND TEMPORARY 24 INCH STOP BAR, PAINT
 ESSEX JUNCTION:
 STA MN 140+07.84 RT, DENSMORE DRIVE

CROSSWALK MARKING, LOW VOC CHLORINATED RUBBER PAINT AND TEMPORARY CROSSWALK MARKING, PAINT
 ESSEX JUNCTION:
 STA MN 137+24.00 LT/RT
 STA MN 140+07.84 RT, DENSMORE DRIVE

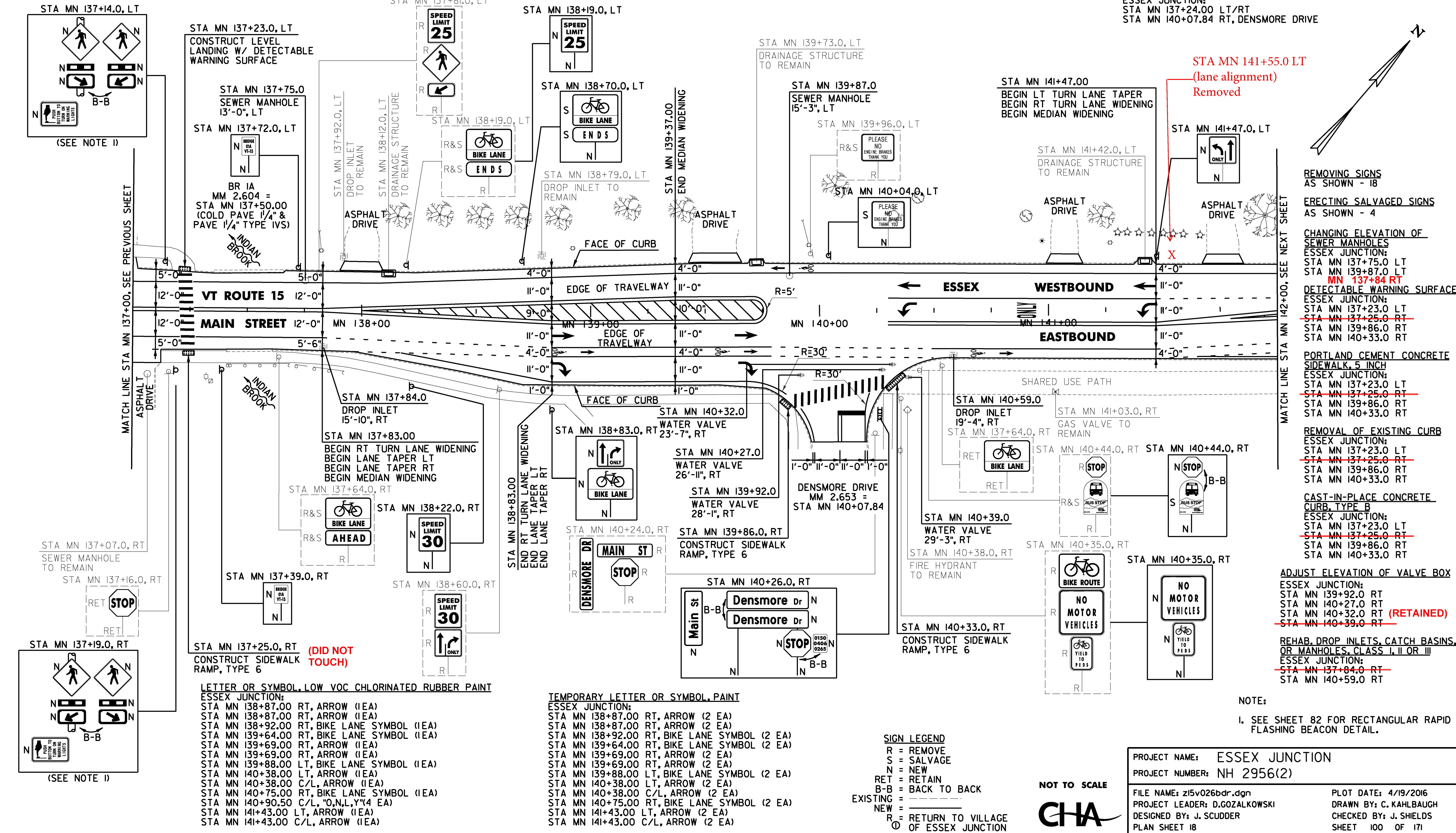

REMOVING SIGNS AS SHOWN - 18
 ERECTING SALVAGED SIGNS AS SHOWN - 4
 CHANGING ELEVATION OF SEWER MANHOLES
 ESSEX JUNCTION:
 STA MN 137+75.0 LT
 STA MN 139+87.0 LT
 MN 137+84 RT
 DETECTABLE WARNING SURFACE
 ESSEX JUNCTION:
 STA MN 137+23.0 LT
~~STA MN 137+25.0 RT~~
 STA MN 139+86.0 RT
 STA MN 140+33.0 RT

PORTLAND CEMENT CONCRETE SIDEWALK, 5 INCH
 ESSEX JUNCTION:
 STA MN 137+23.0 LT
~~STA MN 137+25.0 RT~~
 STA MN 139+86.0 RT
 STA MN 140+33.0 RT

REMOVAL OF EXISTING CURB
 ESSEX JUNCTION:
 STA MN 137+23.0 LT
~~STA MN 137+25.0 RT~~
 STA MN 139+86.0 RT
 STA MN 140+33.0 RT

CAST-IN-PLACE CONCRETE CURB, TYPE B
 ESSEX JUNCTION:
 STA MN 137+23.0 LT
~~STA MN 137+25.0 RT~~
 STA MN 139+86.0 RT
 STA MN 140+33.0 RT

ADJUST ELEVATION OF VALVE BOX
 ESSEX JUNCTION:
 STA MN 139+92.0 RT
 STA MN 140+27.0 RT
 STA MN 140+32.0 RT (RETAINED)
~~STA MN 140+39.0 RT~~

REHAB. DROP INLETS, CATCH BASINS, OR MANHOLES, CLASS I, II OR III
 ESSEX JUNCTION:
~~STA MN 137+84.0 RT~~
 STA MN 140+59.0 RT

NOTE:
 1. SEE SHEET 82 FOR RECTANGULAR RAPID FLASHING BEACON DETAIL.

PROJECT NAME: ESSEX JUNCTION
 PROJECT NUMBER: NH 2956(2)
 FILE NAME: z15v026bdr.dgn
 PLOT DATE: 4/19/2016
 PROJECT LEADER: D.GOZALKOWSKI
 DRAWN BY: C. KAHLBAUGH
 DESIGNED BY: J. SHIELDS
 CHECKED BY: J. SHIELDS
 PLAN SHEET 18
 SHEET 100 OF 171

SIGN LEGEND
 R = REMOVE
 S = SALVAGE
 N = NEW
 RET = RETAIN
 B-B = BACK TO BACK
 EXISTING =
 NEW =
 RETURN TO VILLAGE OF ESSEX JUNCTION
 NOT TO SCALE
 CHA

LETTER OR SYMBOL, LOW VOC CHLORINATED RUBBER PAINT
 ESSEX JUNCTION:
 STA MN 138+87.00 RT, ARROW (1 EA)
 STA MN 138+87.00 RT, ARROW (1 EA)
 STA MN 138+92.00 RT, BIKE LANE SYMBOL (1 EA)
 STA MN 139+64.00 RT, BIKE LANE SYMBOL (1 EA)
 STA MN 139+69.00 RT, ARROW (1 EA)
 STA MN 139+69.00 RT, ARROW (1 EA)
 STA MN 139+88.00 LT, BIKE LANE SYMBOL (1 EA)
 STA MN 140+38.00 LT, ARROW (1 EA)
 STA MN 140+38.00 C/L, ARROW (1 EA)
 STA MN 140+75.00 RT, BIKE LANE SYMBOL (1 EA)
 STA MN 140+90.50 C/L, "O,N,L,Y" (4 EA)
 STA MN 141+43.00 LT, ARROW (1 EA)
 STA MN 141+43.00 C/L, ARROW (1 EA)

TEMPORARY LETTER OR SYMBOL, PAINT
 ESSEX JUNCTION:
 STA MN 138+87.00 RT, ARROW (2 EA)
 STA MN 138+87.00 RT, ARROW (2 EA)
 STA MN 138+92.00 RT, BIKE LANE SYMBOL (2 EA)
 STA MN 139+64.00 RT, BIKE LANE SYMBOL (2 EA)
 STA MN 139+69.00 RT, ARROW (2 EA)
 STA MN 139+69.00 RT, ARROW (2 EA)
 STA MN 139+88.00 LT, BIKE LANE SYMBOL (2 EA)
 STA MN 140+38.00 LT, ARROW (2 EA)
 STA MN 140+38.00 C/L, ARROW (2 EA)
 STA MN 140+75.00 RT, BIKE LANE SYMBOL (2 EA)
 STA MN 141+43.00 LT, ARROW (2 EA)
 STA MN 141+43.00 C/L, ARROW (2 EA)

STA MN 137+25.0, RT (DID NOT TOUCH)
 CONSTRUCT SIDEWALK RAMP, TYPE 6

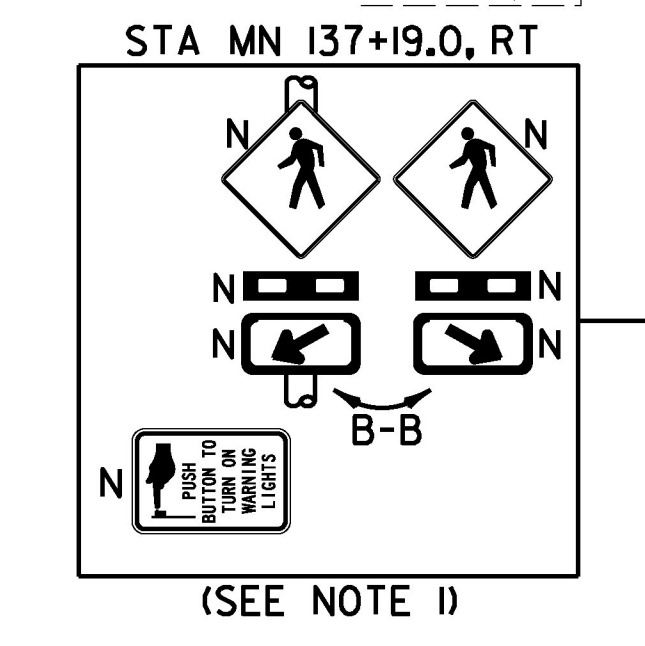
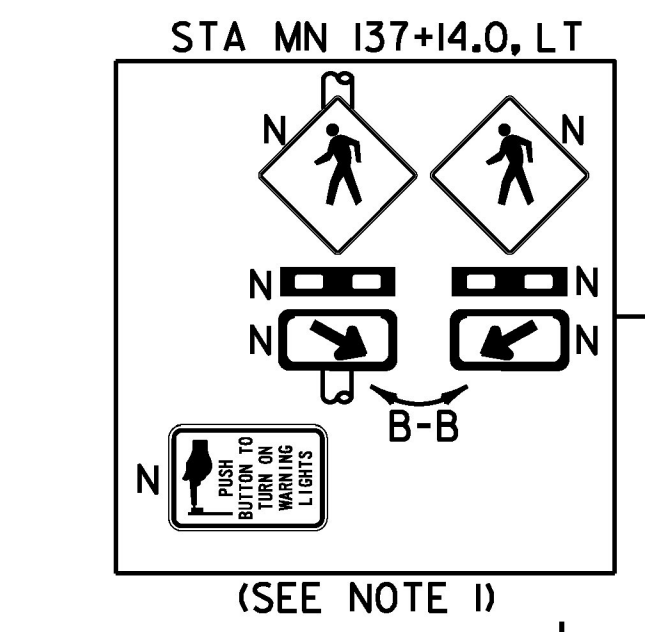

CONSTRUCT LEVEL LANDING W/ DETECTABLE WARNING SURFACE

BR 1A MM 2.604 = STA MN 137+50.00 (COLD PAVE 1/4" & PAVE 1/4" TYPE IVS)

STA MN 137+07.0, RT SEWER MANHOLE TO REMAIN
 STA MN 137+16.0, RT
 STA MN 137+39.0, RT
 STA MN 137+43.0, RT
 STA MN 137+43.0, RT
 STA MN 137+43.0, RT

