

STA L 47+52.0  
DROP INLET  
3'-4", LT  
STA L 47+51.0  
DRAINAGE MANHOLE  
1'-4", LT

4 INCH YELLOW LINE, LOW VOC CHLORINATED RUBBER PAINT AND  
TEMPORARY 4 INCH YELLOW LINE, PAINT  
(ALL LINES WILL INCLUDE C/L LINE BREAKS FOR TOWN HIGHWAYS)  
S = SOLID, D = DASHED  
ESSEX JUNCTION:  
STA L 47+50.00 - STA L 52+50.00

4 INCH WHITE LINE, LOW VOC CHLORINATED RUBBER PAINT AND  
TEMPORARY 4 INCH WHITE LINE, PAINT  
(ALL LINES WILL INCLUDE EDGE LINE BREAKS AND  
RADIUS FOR TOWN HIGHWAYS)  
ESSEX JUNCTION:  
STA L 47+50.00 - STA L 48+45.00 EDGE LINE LT  
STA L 47+50.00 - STA L 52+50.00 EDGE LINE RT  
STA L 47+62.56 LT SOLID LANE LINE, PROSPECT STREET  
STA L 47+62.56 EDGE LINES LT, PROSPECT STREET  
STA L 48+45.00 - STA L 49+65.00 LT PARKING SPACES  
STA L 49+80.00 - STA L 50+20.00 LT PARKING SPACES  
STA L 50+52.00 - STA L 50+77.00 LT NO PARKING EDGE LINE  
STA L 50+77.00 - STA L 51+56.00 LT PARKING SPACES  
STA L 51+86.00 - STA L 52+22.00 LT PARKING SPACES  
STA L 52+17.00 - STA L 52+50.00 EDGE LINE LT

24 INCH STOP BAR, LOW VOC CHLORINATED RUBBER PAINT AND  
TEMPORARY 24 INCH STOP BAR, PAINT  
ESSEX JUNCTION:  
STA L 47+62.56 LT, PROSPECT STREET

CROSSWALK MARKING, LOW VOC CHLORINATED RUBBER PAINT AND  
TEMPORARY CROSSWALK MARKING, PAINT  
ESSEX JUNCTION:  
STA L 47+62.56 LT, PROSPECT STREET  
STA L 47+80.00 LT/RT

LETTER OR SYMBOL, LOW VOC CHLORINATED RUBBER PAINT  
ESSEX JUNCTION:  
STA L 47+62.56 LT, PROSPECT STREET ARROW (1 EA)  
STA L 47+62.56 LT, PROSPECT STREET ARROW (1 EA)

TEMPORARY LETTER OR SYMBOL, PAINT  
ESSEX JUNCTION:  
STA L 47+62.56 LT, PROSPECT STREET ARROW (2 EA)  
STA L 47+62.56 LT, PROSPECT STREET ARROW (2 EA)

REMOVING SIGNS  
AS SHOWN - IO

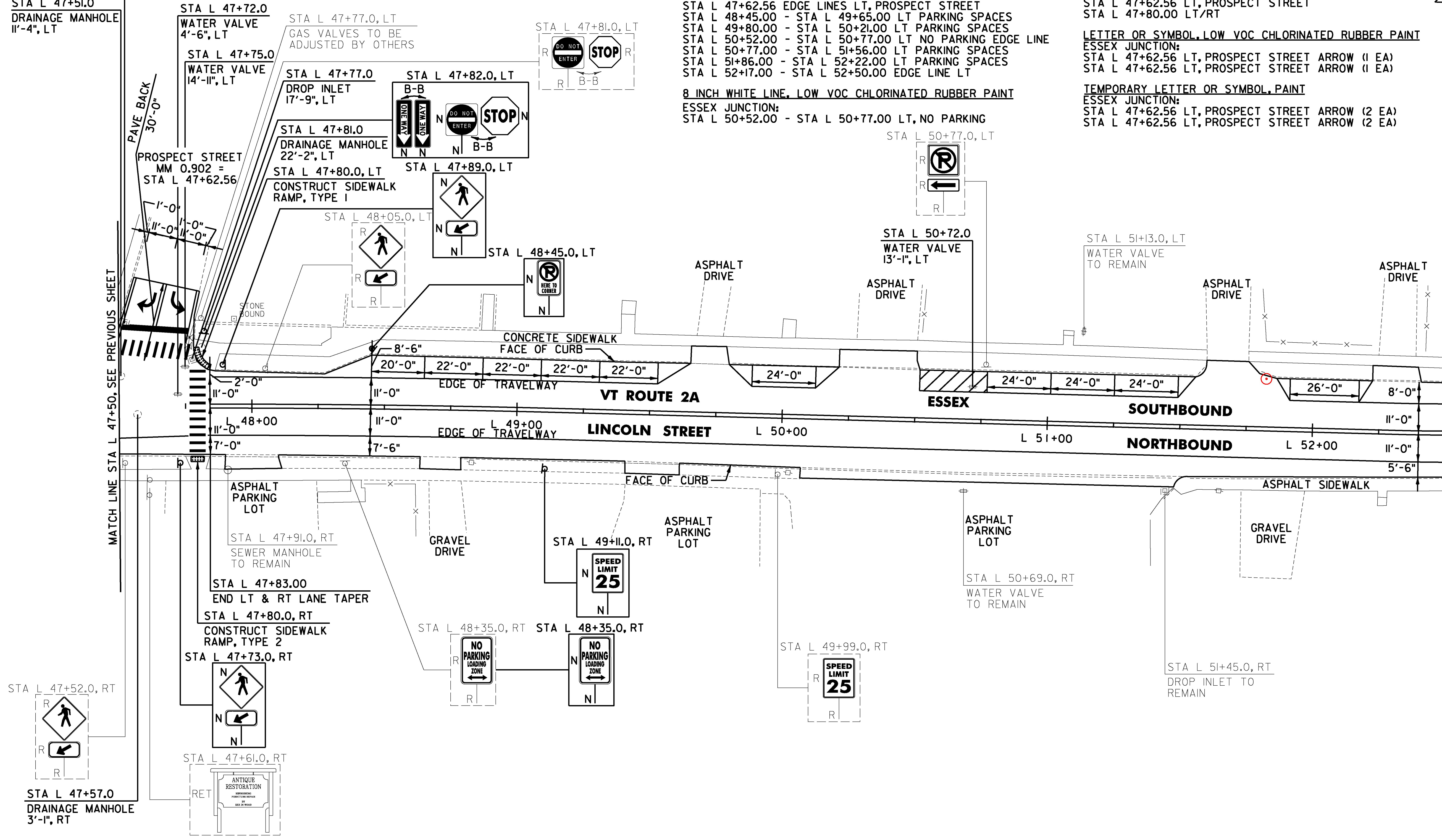
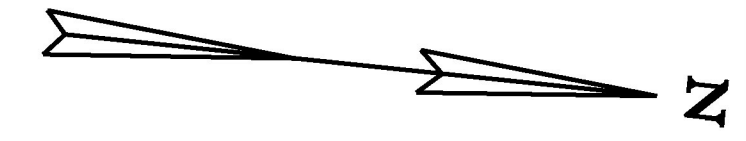

MATCH LINE STA L 47+50, SEE PREVIOUS SHEET

MATCH LINE STA L 52+50, SEE NEXT SHEET

REHAB, DROP INLETS, CATCH BASINS,  
OR MANHOLES, CLASS I, II OR III  
ESSEX JUNCTION:  
STA L 47+51.0 LT  
~~STA L 47+52.0 LT~~ L 51+85 LT  
STA L 47+57.0 RT  
STA L 47+77.0 LT  
~~STA L 47+81.0 LT~~

CHANGING ELEVATION  
L 47+52 LT

ADJUST ELEVATION OF VALVE BOX  
ESSEX JUNCTION:  
STA L 47+72.0 LT  
STA L 47+75.0 LT  
STA L 50+72.0 LT

DETECTABLE WARNING SURFACE  
ESSEX JUNCTION:  
STA L 47+80.0 LT  
STA L 47+80.0 RT

PORTLAND CEMENT CONCRETE SIDEWALK, 5 INCH  
ESSEX JUNCTION:  
STA L 47+80.0 LT  
STA L 47+80.0 RT

REMOVAL OF EXISTING CURB

ESSEX JUNCTION:  
STA L 47+80.0 LT  
~~STA L 47+80.0 RT~~

CAST-IN-PLACE CONCRETE  
CURB, TYPE B

ESSEX JUNCTION:  
STA L 47+80.0 LT  
~~STA L 47+80.0 RT~~

SIGN LEGEND

R = REMOVE  
S = SALVAGE  
N = NEW  
RET = RETAIN  
B-B = BACK TO BACK  
EXISTING = EXISTING  
NEW = NEW  
R = RETURN TO VILLAGE  
O = OF ESSEX JUNCTION

NOT TO SCALE



PROJECT NAME: ESSEX JUNCTION  
PROJECT NUMBER: STP 2956(I)

FILE NAME: z14v25lbd.dgn  
PROJECT LEADER: D.GOZALKOWSKI  
DESIGNED BY: J. OLSEN  
PLAN SHEET 12

PLOT DATE: 4/19/2016  
DRAWN BY: A. KIRBY  
CHECKED BY: J. SHIELDS  
SHEET 39 OF 171