

**4 INCH WHITE LINE, LOW VOC CHLORINATED RUBBER PAINT AND TEMPORARY 4 INCH WHITE LINE, PAINT**  
 (ALL LINES WILL INCLUDE EDGE LINE BREAKS AND RADIUS FOR TOWN HIGHWAYS)  
 ESSEX JUNCTION:  
 STA PA 2+50.00 - STA PA 5+53.00 BIKE LANE LINE RT  
 STA PA 2+50.00 - STA PA 5+53.00 HATCH BUFFER RT  
 STA PA 2+50.00 - STA PA 6+00.00 HATCH BUFFER LT  
 STA PA 2+50.00 - STA PA 6+00.00 BIKE LANE LINE LT  
 STA PA 3+08.00 - STA PA 3+91.00 SIDEWALK DESIGNATION LINE LT  
 STA PA 3+21.00 - STA PA 3+78.00 SIDEWALK DESIGNATION LINE LT  
 STA PA 3+25.00 - STA PA 4+75.00 DOTTED LANE LINE RT  
 STA PA 4+75.00 - STA PA 6+25.00 SOLID LANE LINE RT  
 STA PA 6+45.87 SOLID LANE LINE LT, CASCADE STREET  
 STA PA 7+00.00 - STA PA 7+50.00 BIKE LANE LINE LT  
 STA PA 7+00.00 - STA PA 7+50.00 HATCH BUFFER LT

**6 INCH WHITE LINE, LOW VOC CHLORINATED RUBBER PAINT AND TEMPORARY 6 INCH WHITE LINE, PAINT**  
 (ALL LINES WILL INCLUDE EDGE LINE BREAKS AND RADIUS FOR TOWN HIGHWAYS)  
 ESSEX JUNCTION:  
 STA PA 2+50.00 - STA PA 7+50.00 BIKE LANE LINES LT & RT

**4 INCH YELLOW LINE, LOW VOC CHLORINATED RUBBER PAINT AND TEMPORARY 4 INCH YELLOW LINE, PAINT**  
 (ALL LINES WILL INCLUDE C/L LINE BREAKS FOR TOWN HIGHWAYS)  
 S = SOLID, D = DASHED  
 ESSEX JUNCTION: LT & RT  
 STA PA 2+50.00 - STA PA 3+25.00 S - S  
 STA PA 3+25.00 - STA PA 6+25.00 DOUBLE SOLID LT  
 STA PA 6+45.87 DOUBLE SOLID LT, CASCADE STREET  
 STA PA 6+75.00 - STA PA 7+50.00 DOUBLE SOLID MEDIAN LT/RT

**LETTER OR SYMBOL, LOW VOC CHLORINATED RUBBER PAINT**  
 ESSEX JUNCTION:  
 STA PA 4+79.00 C/L, ARROW (1 EA)  
 STA PA 5+50.00 C/L, "O,N,L,Y" (4 EA)  
 STA PA 5+91.00 LT, BIKE LANE LINE SYMBOL (1 EA)  
 STA PA 6+21.00 C/L, ARROW (1 EA)  
 STA PA 6+45.87 LT, CASCADE STREET, ARROW (1 EA)  
 STA PA 6+45.87 LT, CASCADE STREET, ARROW (1 EA)  
 STA PA 6+84.00 RT, BIKE LANE SYMBOL (1 EA)  
 STA PA 7+04.00 LT, BIKE LANE SYMBOL (1 EA)

**TEMPORARY LETTER OR SYMBOL, PAINT**  
 ESSEX JUNCTION:  
 STA PA 4+79.00 LT, ARROW (2 EA)  
 STA PA 5+91.00 LT, BIKE LANE LINE SYMBOL (2 EA)  
 STA PA 6+21.00 C/L, ARROW (2 EA)  
 STA PA 6+45.87 LT, CASCADE STREET ARROW (2 EA)  
 STA PA 6+45.87 LT, CASCADE STREET ARROW (2 EA)  
 STA PA 6+84.00 RT, BIKE LANE SYMBOL (2 EA)  
 STA PA 7+04.00 LT, BIKE LANE SYMBOL (2 EA)

**24 INCH STOP BAR, LOW VOC CHLORINATED RUBBER PAINT AND TEMPORARY 24 INCH STOP BAR, PAINT**  
 ESSEX JUNCTION:  
 STA PA 6+45.87 LT, CASCADE STREET  
**CROSSWALK MARKING, LOW VOC CHLORINATED RUBBER PAINT AND TEMPORARY CROSSWALK MARKING, PAINT**  
 ESSEX JUNCTION:  
 STA PA 6+45.87 LT, CASCADE STREET  
**8 INCH YELLOW LINE, LOW VOC CHLORINATED RUBBER PAINT**  
 ESSEX JUNCTION:  
 STA PA 6+75.00 - STA PA 7+50.00 HATCHED MEDIAN LT/RT

REMOVING SIGNS AS SHOWN - 6

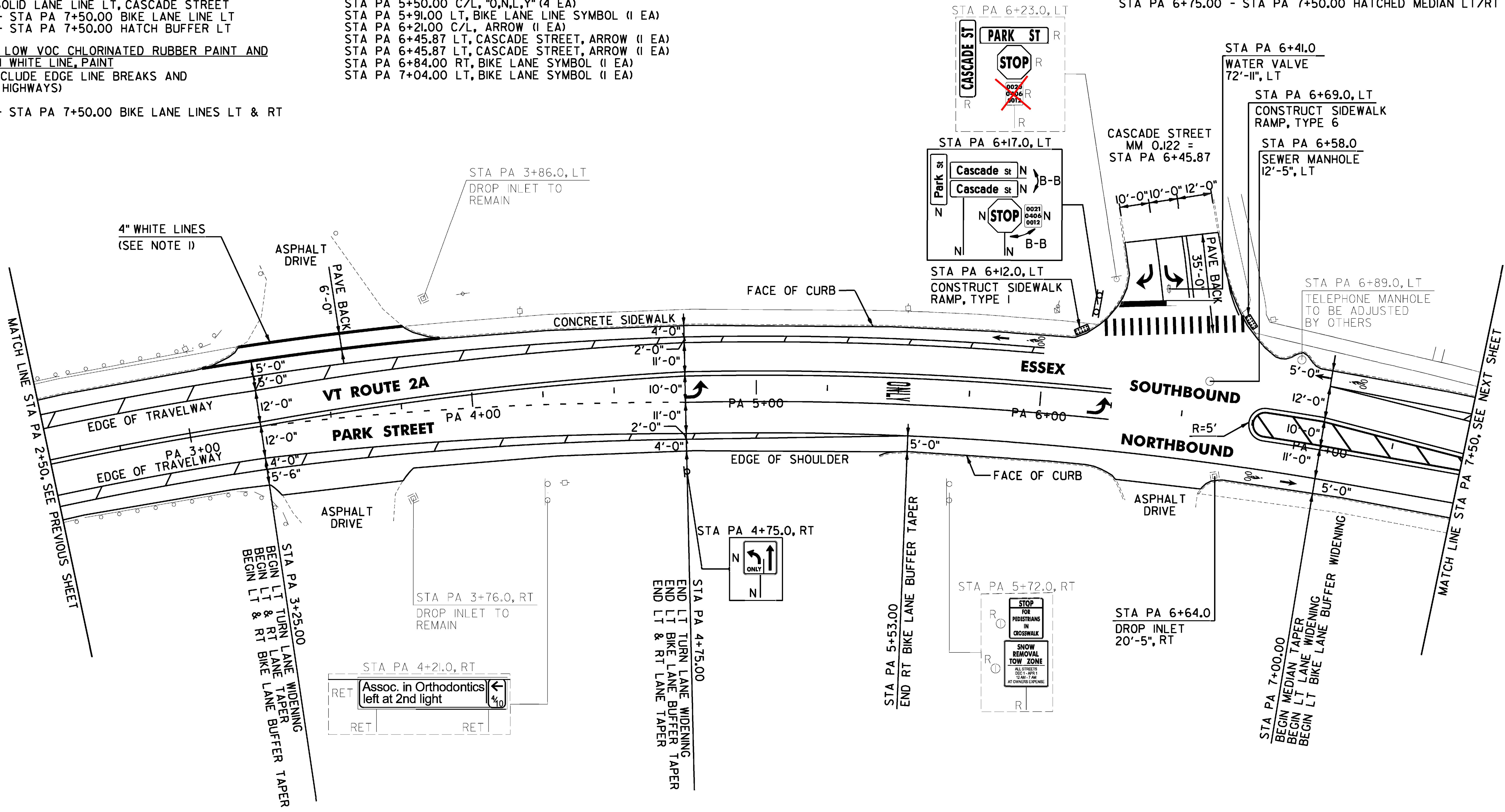

**REHAB. DROP INLETS, CATCH BASINS, OR MANHOLES, CLASS I, II, OR III**  
 ESSEX JUNCTION:  
 STA PA 6+64.0 RT **STA PA 6+58 LT**  
~~CHANGING ELEVATION OF SEWER MANHOLES~~  
~~ESSEX JUNCTION:~~  
~~STA PA 6+58.0 LT~~  
**ADJUST ELEVATION OF VALVE BOX**  
 ESSEX JUNCTION:  
 STA PA 6+41.0 LT

**PORTLAND CEMENT CONCRETE SIDEWALK, 5 INCH**  
 ESSEX JUNCTION:  
 STA PA 6+12.0 LT  
 STA PA 6+69.0 LT  
**DETECTABLE WARNING SURFACE**  
 ESSEX JUNCTION:  
 STA PA 6+12.0 LT  
 STA PA 6+69.0 LT

**REMOVAL OF EXISTING CURB**  
 ESSEX JUNCTION:  
 STA PA 6+12.0 LT  
 STA PA 6+69.0 LT  
**CAST-IN-PLACE CONCRETE CURB, TYPE B**  
 ESSEX JUNCTION:  
 STA PA 6+12.0 LT  
 STA PA 6+69.0 LT

**SIGN LEGEND**  
 R = REMOVE  
 S = SALVAGE  
 N = NEW  
 RET = RETAIN  
 B-B = BACK TO BACK  
 EXISTING =   
 NEW =   
 R = RETURN TO VILLAGE OF ESSEX JUNCTION

NOT TO SCALE

**NOTE:**  
 1. THE CONTRACTOR SHALL PROVIDE 4" WHITE LINES TO CONNECT THE SIDEWALKS ACROSS THE DRIVEWAY AND SEPARATE THE DRIVEWAY AND PEDESTRIAN WALKWAY.

PROJECT NAME: ESSEX JUNCTION	PLOT DATE: 4/19/2016
PROJECT NUMBER: STP 2956(I)	DRAWN BY: A. KIRBY
FILE NAME: z14v251bdr.dgn	DESIGNED BY: J. OLSEN
PROJECT LEADER: D.GOZALKOWSKI	CHECKED BY: J. SHIELDS
PLAN SHEET 2	SHEET 29 OF 171