

DURABLE 4 INCH WHITE LINE, TYPE A TAPE AND  
 TEMPORARY 4 INCH WHITE LINE, PAINT  
 (ALL LINES WILL INCLUDE EDGE LINE BREAKS AND  
 RADIUS FOR TOWN HIGHWAYS)  
 WINDSOR:  
 STA W 114+00.00 - STA W 119+50.00 EDGE LINE LT & RT

DURABLE 4 INCH YELLOW LINE, TYPE A TAPE AND  
 TEMPORARY 4 INCH YELLOW LINE, PAINT  
 (ALL LINES WILL INCLUDE C/L BREAKS FOR TOWN HIGHWAYS)  
 S=SOLID D=DASHED  
 WINDSOR:  
 STA W 114+00.00 - STA W 119+50.00 LT C RT  
 S - S

REMOVING SIGNS  
 AS SHOWN - 2

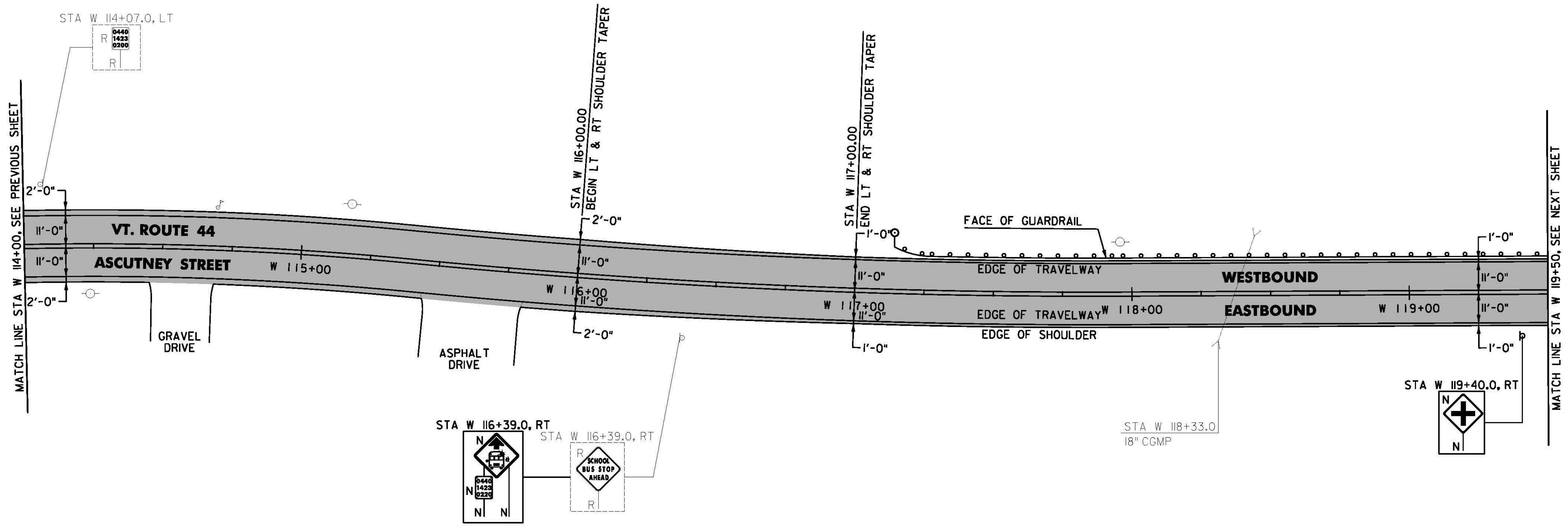
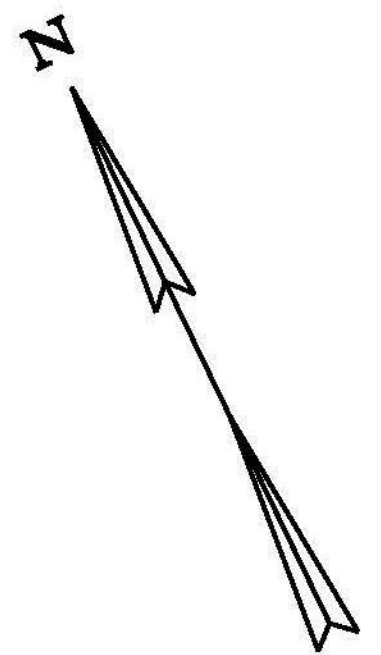

**STEEL BEAM GUARDRAIL, GALVANIZED W/8 FEET POSTS**  
 WINDSOR:  
 STA W 117+14.0 - STA W 119+50.0 LT

**ANCHOR FOR STEEL BEAM RAIL**  
 WINDSOR:  
 STA W 117+20.5 LT

**REMOVAL AND DISPOSAL OF GUARDRAIL**  
 WINDSOR:  
 STA W 117+20.0 - STA W 119+50.0 LT

**DELINEATOR WITH STEEL POST**  
 WINDSOR:  
 STA W 117+14.0 LT

**LEGEND**  
 [Grey Box] OVERLAY AREA

**SIGN LEGEND**  
 R = REMOVE  
 S = SALVAGE  
 N = NEW  
 RET = RETAIN  
 B-B = BACK TO BACK  
 EXISTING = \_\_\_\_\_  
 NEW = \_\_\_\_\_  
 R = RETURN TO TOWN  
 O OF WINDSOR

NOT TO SCALE

**WINDSOR  
 PROJECT  
 LAYOUT  
 SHEET #16**

PROJECT NAME: CHESTER-SPRINGFIELD-ROCKINGHAM-WINDSOR	PLOT DATE: 3/27/2015
PROJECT NUMBER: STP 295210	DRAWN BY: A. KIRBY
FILE NAME: z13c518bdr_seg04.dgn	CHECKED BY: J. SHIELDS
PROJECT LEADER: D. GOZALKOWSKI	SHEET 252 OF 309
DESIGNED BY: A. HAWKINS	