

DURABLE 4 INCH WHITE LINE, TYPE A TAPE AND TEMPORARY 4 INCH WHITE LINE, PAINT
 (ALL LINES WILL INCLUDE EDGE LINE BREAKS AND RADIUS FOR TOWN HIGHWAYS)
WINDSOR:
 STA W 190+75.00 - STA W 191+27.00 RT, PARKING SPACES
 STA W 190+75.00 - STA W 192+13.00 LT, PARKING SPACES 192+40
 STA W 191+71.00 - STA W 192+15.00 RT, NO PARKING EDGE LINE
 STA W 192+21.00 - STA W 193+11.00 LT, PARKING SPACES 192+45
 STA W 192+29.76 EDGE LINES RT, TH-34
 STA W 192+46.00 - STA W 193+23.00 RT, PARKING SPACES
 STA W 192+69.00 - STA W 193+76.00 DOTTED LANE LINE RT
 STA W 193+22.00 - STA W 193+96.00 LT, PARKING SPACES
 STA W 193+67.00 - STA W 194+58.00 RT, PARKING SPACES
 STA W 193+76.00 - STA W 194+45.00 SOLID LANE LINE RT
 STA W 194+06.00 - STA W 194+71.00 LT, PARKING SPACES
 STA W 195+09.60 EDGE LINES LT, TH-3
 STA W 195+45.00 - STA W 195+75.00 LT, PARKING SPACES
 STA W 195+52.00 - STA W 195+75.00 RT, PARKING SPACES

DURABLE 4 INCH YELLOW LINE, TYPE A TAPE AND TEMPORARY 4 INCH YELLOW LINE, PAINT
 (ALL LINES WILL INCLUDE C/L BREAKS FOR TOWN HIGHWAYS)
 S=SOLID D=DASHED
WINDSOR:
 STA W 190+75.00 - STA W 192+15.00 LT, C RT
 STA W 192+29.76 DOUBLE SOLID RT, TH-34
 STA W 192+50.00 - STA W 192+69.00 DOUBLE SOLID RT
 STA W 192+69.00 - STA W 194+47.00 DOUBLE SOLID LT
 STA W 195+09.60 DOUBLE SOLID LT, TH-3
 STA W 195+48.00 - STA W 195+75.00 DOUBLE SOLID MEDIAN LT/RT

DURABLE CROSSWALK MARKING, TYPE A TAPE AND TEMPORARY CROSSWALK MARKING, PAINT
WINDSOR:
 STA W 192+18.00 - LT/RT 192+42.00 LT/RT
 STA W 192+29.76 RT, TH-34
 STA W 194+64.00 - STA W 194+79.00 RT
 STA W 194+69.00 LT/RT
 STA W 195+09.60 LT, TH-3
 STA W 195+43.00 LT/RT

DURABLE 8 INCH YELLOW LINE, TYPE A TAPE
WINDSOR:
 STA W 195+48.00 - STA W 195+75.00 HATCHED MEDIAN LT/RT
DURABLE LETTER OR SYMBOL, TYPE D TAPE
WINDSOR:
 STA W 192+29.76 RT, TH-34 "S,T,O,P" (4 EA)
 STA W 193+80.00 CL, ARROW (1 EA)
 STA W 194+37.00 CL, ARROW (1 EA)
TEMPORARY LETTER OR SYMBOL, PAINT
WINDSOR:
 STA W 192+29.76 RT, TH-34 "S,T,O,P" (8 EA)
 STA W 193+80.00 CL, ARROW (2 EA)
 STA W 194+37.00 CL, ARROW (2 EA)

REMOVING SIGNS
 AS SHOWN - II
ERECTING SALVAGED SIGNS
 AS SHOWN - 3

DURABLE 24 INCH STOP BAR, TYPE A TAPE AND TEMPORARY 24 INCH STOP BAR, PAINT
WINDSOR:
 STA W 192+29.76 RT, TH-34
 STA W 194+46.00 LT/RT
 STA W 195+09.60 LT, TH-3
 STA W 195+55.00 LT

DURABLE 8 INCH WHITE LINE, TYPE A TAPE
WINDSOR:
 STA W 191+15.00 - STA W 191+27.00 RT, NO PARKING
 STA W 191+71.00 - STA W 192+15.00 RT, NO PARKING
 STA W 191+92.00 - STA W 192+13.00 LT, NO PARKING 192+18.00-192+38.00
 STA W 192+21.00 - STA W 192+41.00 LT, NO PARKING 192+46.00-192+66.00
 STA W 192+46.00 - STA W 192+90.00 RT, NO PARKING
 STA W 193+03.00 - STA W 193+11.00 LT, NO PARKING
 STA W 193+16.00 - STA W 193+23.00 RT, NO PARKING
 STA W 193+22.00 - STA W 193+94.00 LT, NO PARKING
 STA W 193+67.00 - STA W 193+78.00 RT, NO PARKING
 STA W 193+72.00 - STA W 193+96.00 LT, NO PARKING
 STA W 194+06.00 - STA W 194+13.00 LT, NO PARKING
 STA W 194+28.00 - STA W 194+58.00 RT, NO PARKING
 STA W 194+39.00 - STA W 194+71.00 LT, NO PARKING
 STA W 195+45.00 - STA W 195+75.00 LT, NO PARKING
 STA W 195+52.00 - STA W 195+72.00 RT, NO PARKING

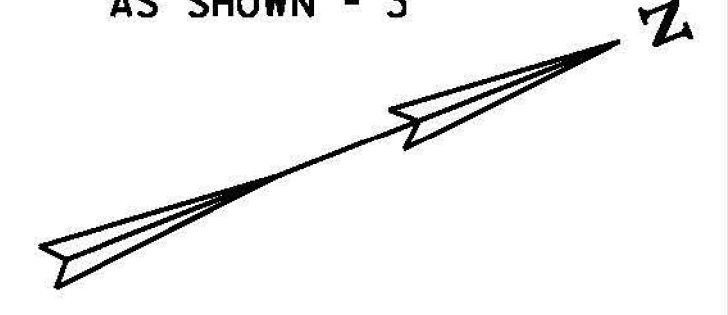
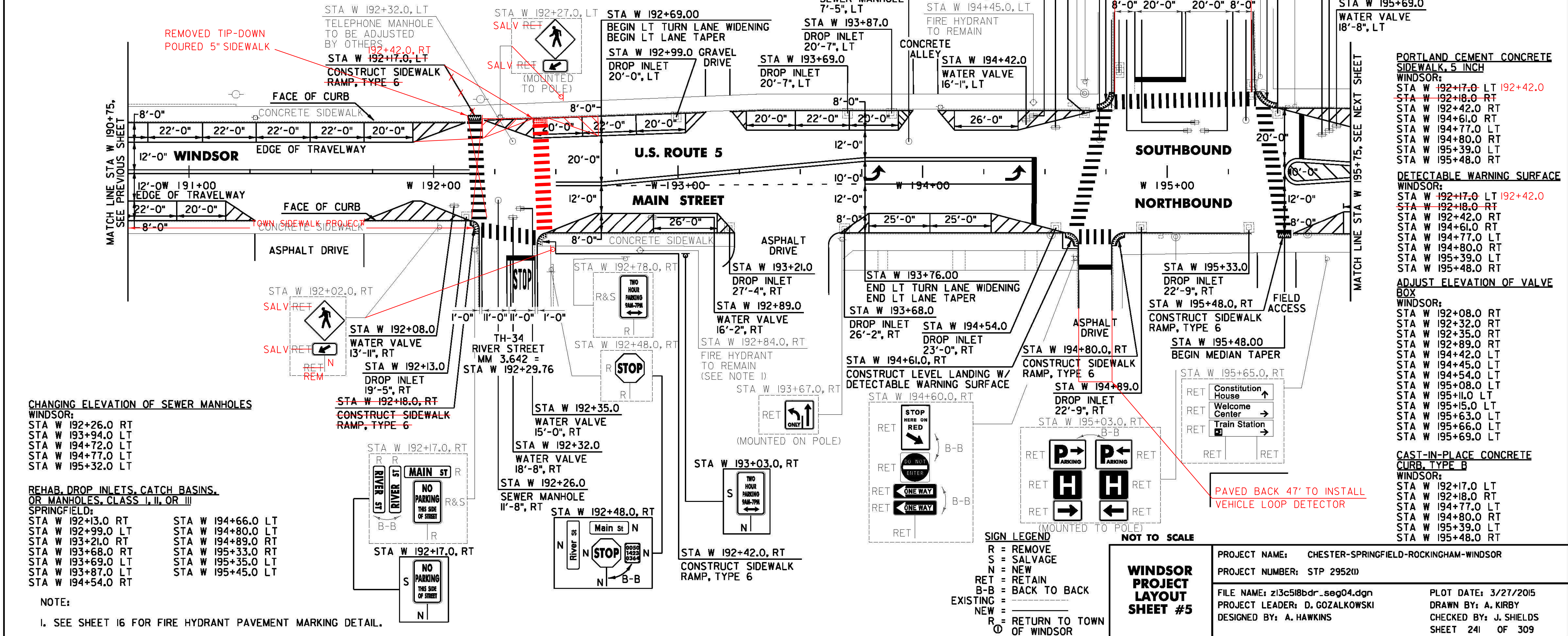

PAVED BACK 47' TO INSTALL VEHICLE LOOP DETECTOR

PORTLAND CEMENT CONCRETE SIDEWALK, 5 INCH
WINDSOR:
 STA W 192+17.0 LT 192+42.0
 STA W 192+18.0 RT
 STA W 192+42.0 RT
 STA W 194+61.0 RT
 STA W 194+77.0 LT
 STA W 194+80.0 RT
 STA W 195+39.0 LT
 STA W 195+48.0 RT

DETECTABLE WARNING SURFACE
WINDSOR:
 STA W 192+17.0 LT 192+42.0
 STA W 192+18.0 RT
 STA W 192+42.0 RT
 STA W 194+61.0 RT
 STA W 194+77.0 LT
 STA W 194+80.0 RT
 STA W 195+39.0 LT
 STA W 195+48.0 RT

ADJUST ELEVATION OF VALVE BOX
WINDSOR:
 STA W 192+08.0 RT
 STA W 192+32.0 RT
 STA W 192+35.0 RT
 STA W 192+89.0 RT
 STA W 194+42.0 LT
 STA W 194+45.0 LT
 STA W 194+54.0 LT
 STA W 195+08.0 LT
 STA W 195+11.0 LT
 STA W 195+15.0 LT
 STA W 195+63.0 LT
 STA W 195+66.0 LT
 STA W 195+69.0 LT

CAST-IN-PLACE CONCRETE CURB, TYPE B
WINDSOR:
 STA W 192+17.0 LT
 STA W 192+18.0 RT
 STA W 194+77.0 LT
 STA W 194+80.0 RT
 STA W 195+39.0 LT
 STA W 195+48.0 RT

WINDSOR PROJECT LAYOUT SHEET #5

PROJECT NAME: CHESTER-SPRINGFIELD-ROCKINGHAM-WINDSOR
 PROJECT NUMBER: STP 2952(I)
 FILE NAME: z13c518bdr_seg04.dgn
 PROJECT LEADER: D. GOZALKOWSKI
 DESIGNED BY: A. HAWKINS

PLOT DATE: 3/27/2015
 DRAWN BY: A. KIRBY
 CHECKED BY: J. SHIELDS
 SHEET 241 OF 309