

**DURABLE 4 INCH WHITE LINE, TYPE A TAPE AND TEMPORARY 4 INCH WHITE LINE, PAINT**  
 (ALL LINES WILL INCLUDE EDGE LINE BREAKS AND RADIUS FOR TOWN HIGHWAYS)  
 SPRINGFIELD:  
 STA S 331+50.00 - STA S 336+28.32 EDGE LINE LT & RT  
 STA S 331+50.00 - STA S 336+28.32 DASHED LANE LINE LT & RT  
 STA S 332+48.16 EDGE LINES RT, TH-I22

**DURABLE 4 INCH YELLOW LINE, TYPE A TAPE AND TEMPORARY 4 INCH YELLOW LINE, PAINT**  
 (ALL LINES WILL INCLUDE C/L LINE BREAKS FOR TOWN HIGHWAYS)  
 S = SOLID, D = DASHED  
 SPRINGFIELD:  
 STA S 331+50.00 - STA S 336+28.32 LT S - RT S  
 STA S 332+48.16 DOUBLE SOLID RT, TH-I22

**DURABLE 8 INCH WHITE LINE, TYPE A TAPE**  
 SPRINGFIELD:  
 STA S 334+03.0 - STA S 334+15.0 LT, FIRE HYDRANT, NO PARKING

**DURABLE 24 INCH STOP BAR, TYPE A TAPE AND TEMPORARY 24 INCH STOP BAR, PAINT**  
 SPRINGFIELD:  
 STA S 332+48.16 RT, TH-I22

**DURABLE LETTER OR SYMBOL, TYPE D TAPE**  
 SPRINGFIELD:  
 STA S 332+48.16 RT, TH-I22 "S,T,O,P (4 EA)

**TEMPORARY LETTER OR SYMBOL, PAINT**  
 SPRINGFIELD:  
 STA S 332+48.16 RT, TH-I22 "S,T,O,P (8 EA)

REMOVING SIGNS AS SHOWN - 6

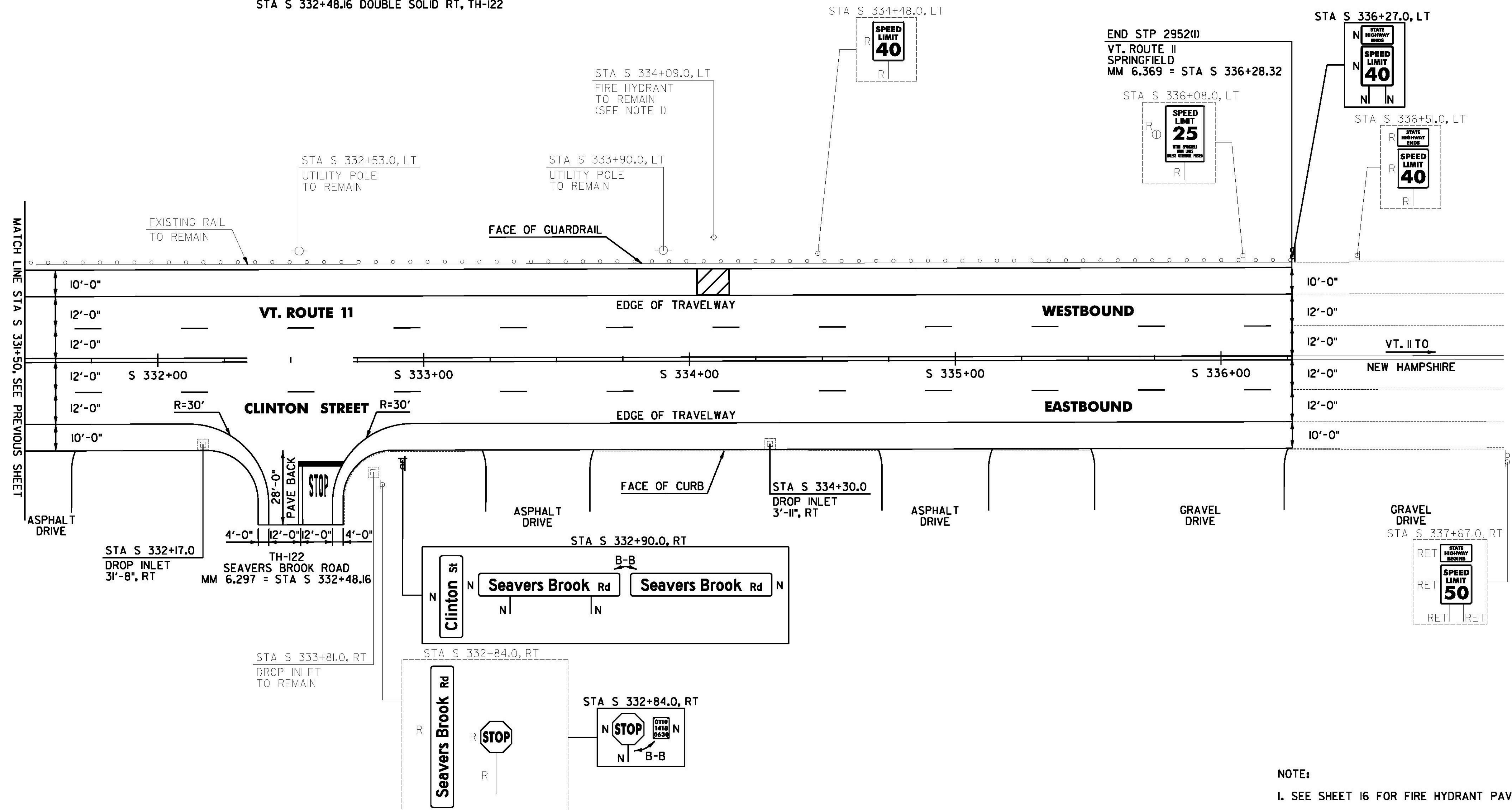

NOTE:  
 I. SEE SHEET 16 FOR FIRE HYDRANT PAVEMENT MARKING DETAIL.

**REMOVE AND REPLACE REFLECTOR UNIT**  
 SPRINGFIELD:

STA S 331+74.8 LT	STA S 334+24.8 LT
STA S 332+06.0 LT	STA S 334+56.0 LT
STA S 332+37.3 LT	STA S 334+87.3 LT
STA S 332+68.5 LT	STA S 335+18.5 LT
STA S 332+99.8 LT	STA S 335+49.8 LT
STA S 333+31.0 LT	STA S 335+81.0 LT
STA S 333+62.3 LT	STA S 336+12.3 LT
STA S 333+93.5 LT	

**SIGN LEGEND**

- R = REMOVE
- S = SALVAGE
- N = NEW
- RET = RETAIN
- B-B = BACK TO BACK
- EXISTING = \_\_\_\_\_
- NEW = \_\_\_\_\_
- ⊙ = RETURN TO TOWN OF SPRINGFIELD

**NOT TO SCALE**  
**SPRINGFIELD PROJECT LAYOUT SHEET #31**

PROJECT NAME: CHESTER-SPRINGFIELD-ROCKINGHAM-WINDSOR	PLOT DATE: 3/27/2015
PROJECT NUMBER: STP 2952(1)	DRAWN BY: A. KIRBY
FILE NAME: z13c518bdr_seg02.dgn	CHECKED BY: J. SHIELDS
DESIGNED BY: A. HAWKINS	SHEET 138 OF 309

**REHAB. DROP INLETS, CATCH BASINS, OR MANHOLES, CLASS I, II, OR III**  
 SPRINGFIELD:  
 STA S 332+17.0 RT  
 STA S 334+30.0 RT