

DURABLE 4 INCH WHITE LINE, TYPE A TAPE AND TEMPORARY 4 INCH WHITE LINE, PAINT
 (ALL LINES WILL INCLUDE EDGE LINE BREAKS AND RADIUS FOR TOWN HIGHWAYS)
 CHESTER:
 STA C 220+00.00 - STA C 225+40.32 EDGE LINE LT & RT
 STA C 220+86.24 EDGE LINES LT, TH-5I
 STA C 224+66.40 EDGE LINES LT, TH-5

DURABLE CROSSWALK MARKING, TYPE A TAPE AND TEMPORARY CROSSWALK MARKING, PAINT
 CHESTER:
 STA C 220+86.24 LT, TH-5I

DURABLE 4 INCH YELLOW LINE, TYPE A TAPE AND TEMPORARY 4 INCH YELLOW LINE, PAINT
 (ALL LINES WILL INCLUDE C/L LINE BREAKS FOR TOWN HIGHWAYS)
 S = SOLID, D = DASHED
 CHESTER:
 STA C 220+00.00 - STA C 225+40.32 LT S RT S
 STA C 220+86.24 DOUBLE SOLID LT, TH-5I
 STA C 224+66.40 DOUBLE SOLID LT, TH-5

DURABLE 24 INCH STOP BAR, TYPE A TAPE AND TEMPORARY 24 INCH STOP BAR, PAINT
 CHESTER:
 STA C 220+86.24 LT, TH-5I
 STA C 224+66.40 LT, TH-5

DURABLE LETTER OR SYMBOL, TYPE D TAPE
 CHESTER:
 STA C 220+86.24 LT, TH-5I "S,T,O,P" (4 EA)
 STA C 224+66.40 LT, TH-5 "S,T,O,P" (4 EA)

TEMPORARY LETTER OR SYMBOL, PAINT
 CHESTER:
 STA C 220+86.24 LT, TH-5I "S,T,O,P" (8 EA)
 STA C 224+66.40 LT, TH-5 "S,T,O,P" (8 EA)

REMOVING SIGNS
 AS SHOWN - 12

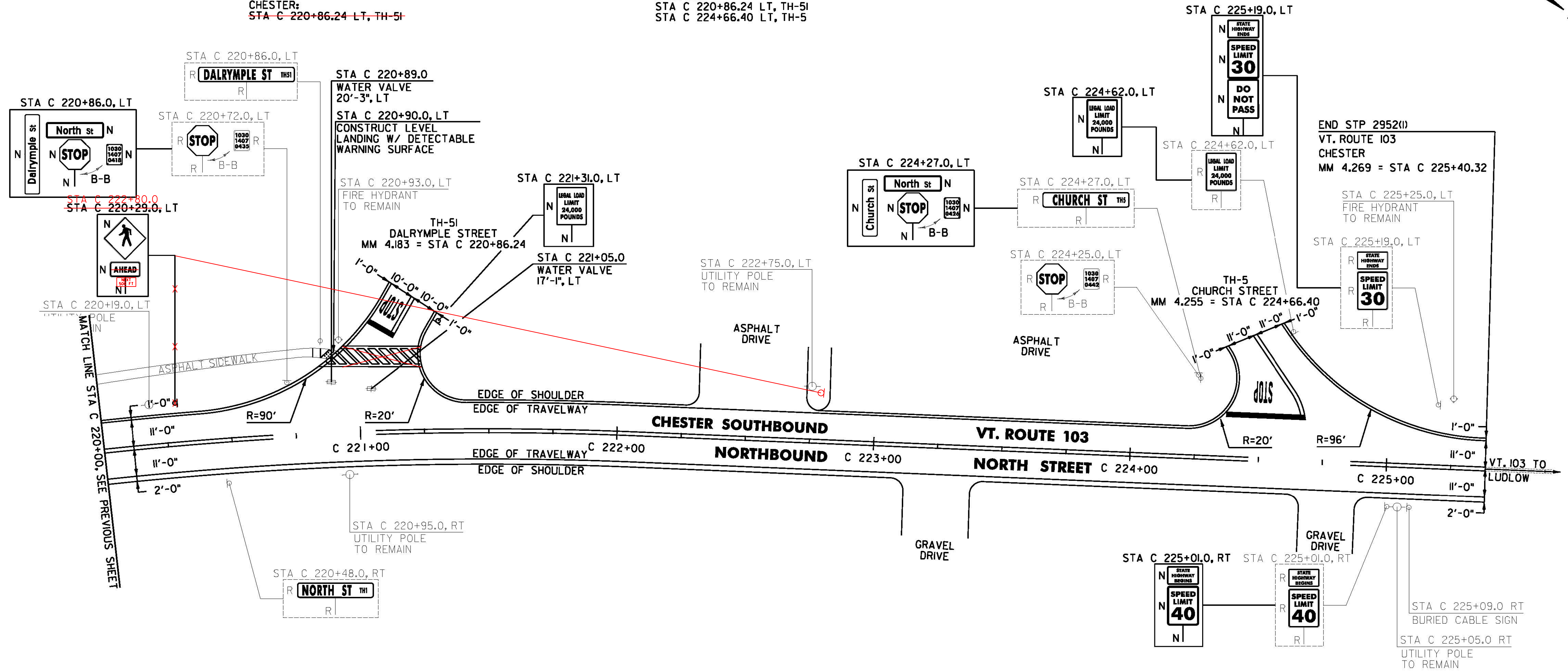

PORTLAND CEMENT CONCRETE SIDEWALK, 5 INCH
 CHESTER:
 STA C 220+90.0 LT
 STA C 221+26.0 LT

DETECTABLE WARNING SURFACE
 CHESTER:
 STA C 220+90.0 LT
 STA C 221+26.0 LT

ADJUST ELEVATION OF VALVE BOX
 CHESTER:
 STA C 220+89.0 LT
 STA C 221+05.0 LT

SIGN LEGEND
 R = REMOVE
 S = SALVAGE
 N = NEW
 RET = RETAIN
 B-B = BACK TO BACK
 EXISTING = _____
 NEW = _____
 ⊙ = RETURN TO TOWN OF CHESTER

NOT TO SCALE

CHESTER PROJECT LAYOUT SHEET #28	PROJECT NAME: CHESTER-SPRINGFIELD-ROCKINGHAM-WINDSOR
	PROJECT NUMBER: STP 2952(I)
	FILE NAME: z13c518bdr_seg01.dgn
	PLOT DATE: 3/27/2015
	DRAWN BY: A. KIRBY
	CHECKED BY: J. SHIELDS
	SHEET 58 OF 309