

DURABLE 4 INCH WHITE LINE, TYPE A TAPE AND TEMPORARY 4 INCH WHITE LINE, PAINT
 (ALL LINES WILL INCLUDE EDGE LINE BREAKS AND RADIUS FOR TOWN HIGHWAYS)
 CHESTER:
 STA C 175+25.00 - STA C 180+25.00 EDGE LINE LT & RT
 STA C 179+70.00 - STA C 180+25.00 SIDEWALK DESIGNATION LINE RT
 STA C 179+70.00 - STA C 180+25.00 SIDEWALK DESIGNATION LINE RT
 STA C 176+72.16 EDGE LINES LT, TH-90
 STA C 177+93.60 EDGE LINES RT, TH-98
 STA C 179+88.96 EDGE LINES RT, TH-70

DURABLE 4 INCH YELLOW LINE, TYPE A TAPE AND TEMPORARY 4 INCH YELLOW LINE, PAINT
 (ALL LINES WILL INCLUDE C/L LINE BREAKS FOR TOWN HIGHWAYS)
 S = SOLID, D = DASHED
 CHESTER:
 STA C 175+25.00 - STA C 180+25.00
 STA C 176+72.16 DOUBLE SOLID LT, TH-90
 STA C 177+93.60 DOUBLE SOLID RT, TH-98
 STA C 179+88.96 DOUBLE SOLID RT, TH-70

DURABLE LETTER OR SYMBOL, TYPE D TAPE
 CHESTER:
 STA C 176+72.16 LT, "S,T,O,P" (4 EA)
 STA C 177+93.60 RT, "S,T,O,P" (4 EA)
 STA C 179+88.96 RT, "S,T,O,P" (4 EA)
 STA C 177+60.00 LT "HANDICAP SYMBOL" 1EA
 TEMPORARY LETTER OR SYMBOL, PAINT
 CHESTER:
 STA C 176+72.16 LT, "S,T,O,P" (8 EA)
 STA C 177+93.60 RT, "S,T,O,P" (8 EA)
 STA C 179+88.96 RT, "S,T,O,P" (8 EA)

DURABLE 8 INCH WHITE LINE, TYPE A TAPE
 CHESTER:
 STA C 175+47.00 - STA C 175+59.00 LT, FIRE HYDRANT, NO PARKING
DURABLE 24 INCH STOP BAR, TYPE A TAPE AND TEMPORARY 24 INCH STOP BAR, PAINT
 CHESTER:
 STA C 176+72.16 LT, TH-90
 STA C 177+93.60 RT, TH-98
 STA C 179+88.96 RT, TH-70

REMOVING SIGNS AS SHOWN - 17

DURABLE CROSSWALK MARKING, TYPE A TAPE AND TEMPORARY CROSSWALK MARKING, PAINT
 CHESTER: 176+55.00
 STA C 176+43.00 LT/RT
 STA C 180+17.00 LT/RT

REHAB REINFORCED CONCRETE DROP INLET WITH CAST IRON GRATE
 STA C 178+2.0 LT, 28'-0", LT

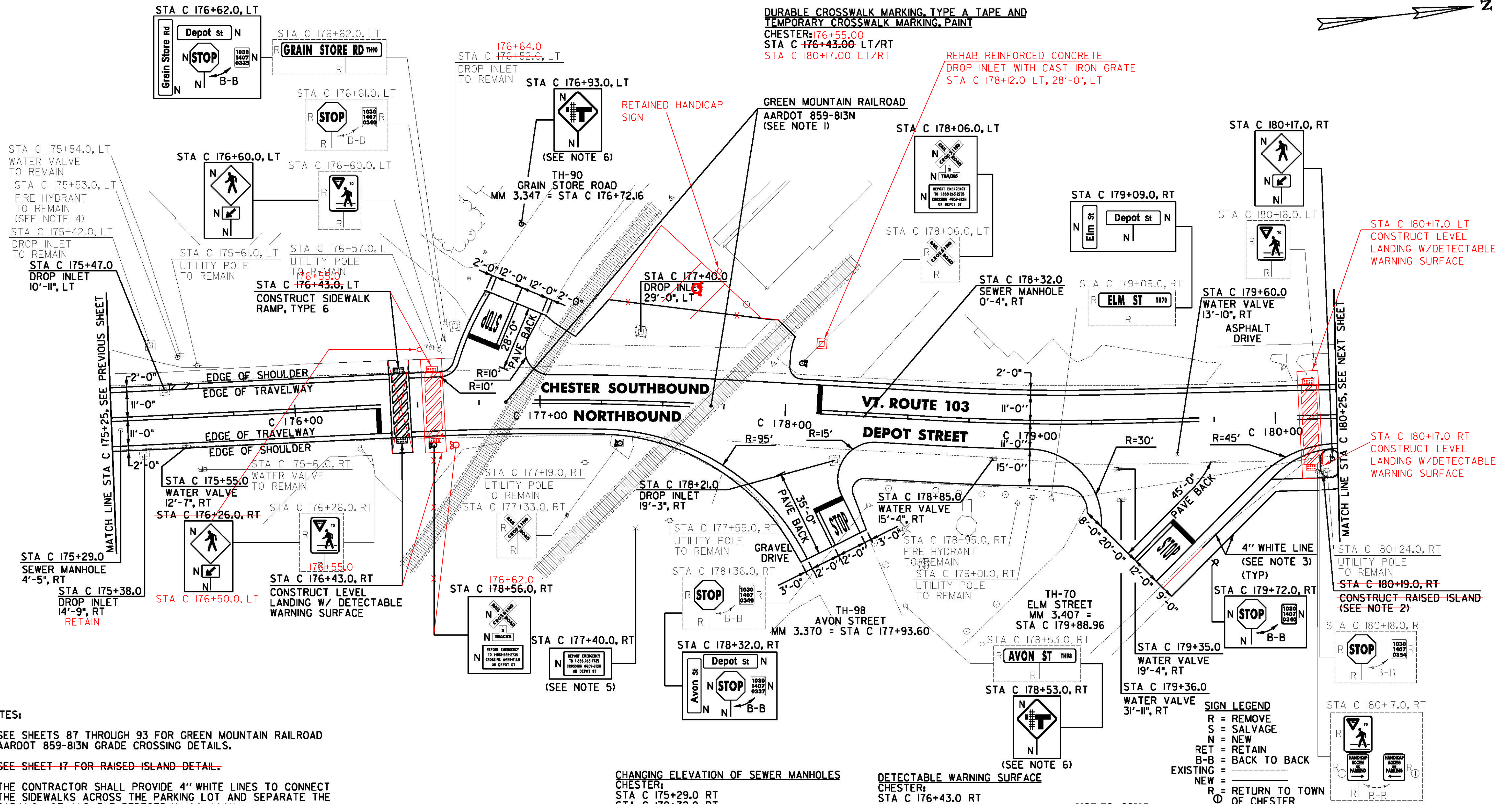

NOTES:

- SEE SHEETS 87 THROUGH 93 FOR GREEN MOUNTAIN RAILROAD AARDOT 859-813N GRADE CROSSING DETAILS.
- ~~SEE SHEET 17 FOR RAISED ISLAND DETAIL.~~
- THE CONTRACTOR SHALL PROVIDE 4" WHITE LINES TO CONNECT THE SIDEWALKS ACROSS THE PARKING LOT AND SEPARATE THE PARKING LOT AND THE PEDESTRIAN WALKWAY.
- SEE SHEET 16 FOR FIRE HYDRANT PAVEMENT MARKING DETAIL.
- SIGN SHALL BE MOUNTED ON THE SIDE OF THE RAILROAD SIGNAL CASE AS DIRECTED BY THE ENGINEER.
- SIGN SHALL BE INSTALLED 100 FT BACK FROM THE PROPOSED STOP BAR OR AS DIRECTED BY THE ENGINEER.

REHAB. DROP INLETS, CATCH BASINS, OR MANHOLES, CLASS I, II OR III
 CHESTER:
 STA C 175+38.0 RT
 STA C 175+47.0 LT
 STA C 177+40.0 LT
 STA C 178+21.0 RT
 STA C 178+12.0 LT

CHANGING ELEVATION OF SEWER MANHOLES
 CHESTER:
 STA C 175+29.0 RT
 STA C 178+32.0 RT

REMOVING AND RESETTING CURB
 CHESTER:
 STA C 176+43.0 LT

PORTLAND CEMENT CONCRETE SIDEWALK, 5 INCH
 CHESTER:
 STA C 176+43.0 RT 176+55.0
 STA C 176+43.0 LT 176+55.0
 STA C 180+17.0 LT
 STA C 180+17.0 RT

DETECTABLE WARNING SURFACE
 CHESTER:
 STA C 176+43.0 RT
 STA C 176+43.0 LT
 STA C 180+17.0 LT
 STA C 180+17.0 RT
ADJUST ELEVATION OF VALVE BOX
 CHESTER:
 STA C 175+55.0 RT
 STA C 178+85.0 RT
 STA C 179+35.0 RT
 STA C 179+36.0 RT
 STA C 179+60.0 RT

NOT TO SCALE

CHESTER PROJECT LAYOUT SHEET #19

SIGN LEGEND
 R = REMOVE
 S = SALVAGE
 N = NEW
 RET = RETAIN
 B-B = BACK TO BACK
 EXISTING =
 NEW =
 R = RETURN TO TOWN OF CHESTER

PROJECT NAME: CHESTER-SPRINGFIELD-ROCKINGHAM-WINDSOR
PROJECT NUMBER: STP 2952(1)
FILE NAME: z13c518bdr_seg01.dgn
PROJECT LEADER: D. GOZALKOWSKI
DESIGNED BY: A. HAWKINS
PLOT DATE: 3/27/2015
DRAWN BY: A. KIRBY
CHECKED BY: J. SHIELDS
SHEET 49 OF 309