

**DURABLE 4 INCH WHITE LINE, TYPE A TAPE AND TEMPORARY 4 INCH WHITE LINE, PAINT**  
 (ALL LINES WILL INCLUDE EDGE LINE BREAKS AND RADIUS FOR TOWN HIGHWAYS)  
 CHESTER:  
 STA C 260+25.00 - STA C 265+25.00 EDGE LINE RT  
 STA C 260+25.00 - STA C 261+31.00 EDGE LINE LT  
 STA C 261+09.60 EDGE LINES RT, TH-91  
 STA C 261+39.00 - STA C 265+25.00 EDGE LINE LT  
 STA C 263+01.00 - STA C 263+85.00 SIDEWALK DESIGNATION LINE LT  
 STA C 263+01.00 - STA C 263+85.00 SIDEWALK DESIGNATION LINE LT

**DURABLE 4 INCH YELLOW LINE, TYPE A TAPE AND TEMPORARY 4 INCH YELLOW LINE, PAINT**  
 (ALL LINES WILL INCLUDE C/L LINE BREAKS FOR TOWN HIGHWAYS)  
 S = SOLID, D = DASHED  
 CHESTER:  
 STA C 260+25.00 - STA C 265+25.00 LT & RT  
 STA C 261+09.60 DOUBLE SOLID RT, TH-91

**DURABLE 8 INCH WHITE LINE, TYPE A TAPE**  
 CHESTER:  
 STA C 260+79.00 - STA C 260+91.00 RT, FIRE HYDRANT, NO PARKING  
 STA C 261+11.00 - STA C 261+31.00 LT, NO PARKING  
 STA C 261+39.00 - STA C 261+59.00 LT, NO PARKING  
 STA C 264+90.00 - STA C 265+02.00 RT, FIRE HYDRANT, NO PARKING

**DURABLE 24 INCH STOP BAR, TYPE A TAPE AND TEMPORARY 24 INCH STOP BAR, PAINT**  
 CHESTER:  
 STA C 261+09.60 RT, TH-91

**DURABLE LETTER OR SYMBOL, TYPE D TAPE**  
 CHESTER:  
 STA C 260+46.00 RT, "S,C,H,O,O,L" (6 EA)  
 STA C 261+09.60 RT, TH-91 "S,T,O,P" (4 EA)

**TEMPORARY LETTER OR SYMBOL, PAINT**  
 CHESTER:  
 STA C 260+46.00 RT, "S,C,H,O,O,L" (12 EA)  
 STA C 261+09.60 RT, TH-91 "S,T,O,P" (8 EA)

REMOVING SIGNS AS SHOWN - 10

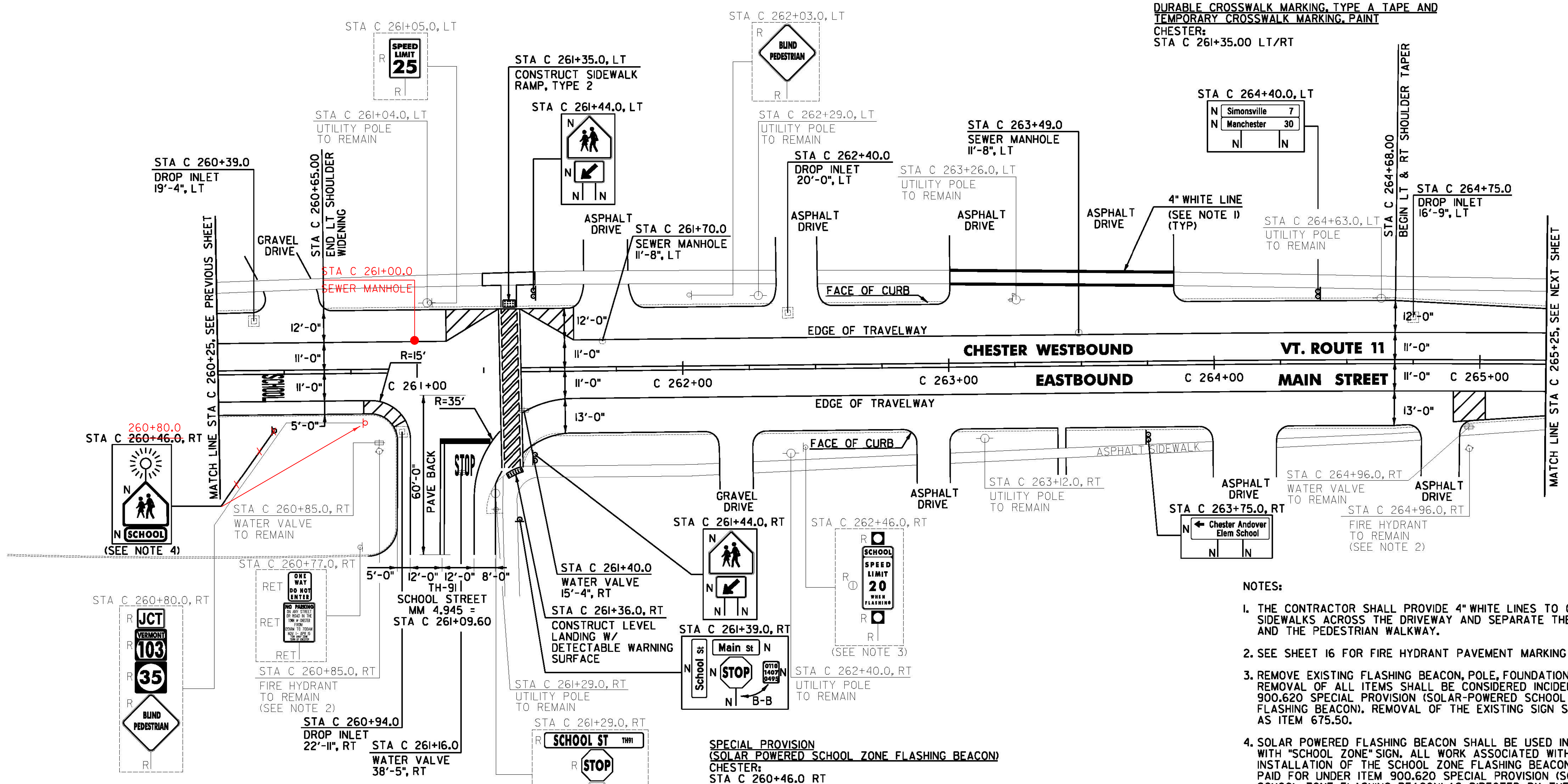
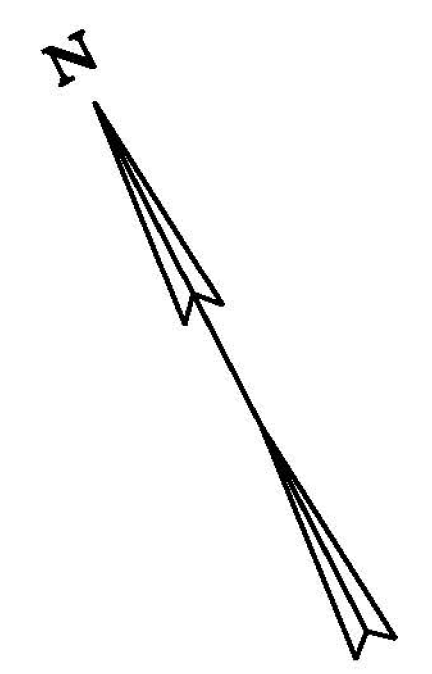

- NOTES:**
1. THE CONTRACTOR SHALL PROVIDE 4" WHITE LINES TO CONNECT THE SIDEWALKS ACROSS THE DRIVEWAY AND SEPARATE THE DRIVEWAY AND THE PEDESTRIAN WALKWAY.
  2. SEE SHEET 16 FOR FIRE HYDRANT PAVEMENT MARKING DETAIL.
  3. REMOVE EXISTING FLASHING BEACON, POLE, FOUNDATION AND WIRING. REMOVAL OF ALL ITEMS SHALL BE CONSIDERED INCIDENTAL TO ITEM 900.620 SPECIAL PROVISION (SOLAR-POWERED SCHOOL ZONE FLASHING BEACON). REMOVAL OF THE EXISTING SIGN SHALL BE PAID AS ITEM 675.50.
  4. SOLAR POWERED FLASHING BEACON SHALL BE USED IN CONJUNCTION WITH "SCHOOL ZONE" SIGN. ALL WORK ASSOCIATED WITH THE INSTALLATION OF THE SCHOOL ZONE FLASHING BEACON WILL BE PAID FOR UNDER ITEM 900.620 SPECIAL PROVISION (SOLAR-POWERED SCHOOL ZONE FLASHING BEACON) AS DIRECTED BY THE ENGINEER. SEE SHEET 96 FOR SOLAR SCHOOL FLASHING BEACON DETAILS.

**CHANGING ELEVATION OF DROP INLETS, CATCH BASINS, OR MANHOLES**  
 CHESTER:  
~~STA C 263+49.0 LT~~

**REHAB. DROP INLETS, CATCH BASINS, OR MANHOLES, CLASS I, II, OR III**  
 CHESTER:  
 STA C 260+39.0 LT  
 STA C 260+94.0 RT  
 STA C 262+40.0 LT  
 STA C 264+75.0 LT

**PORTLAND CEMENT CONCRETE SIDEWALK, 5 INCH**  
 CHESTER:  
 STA C 261+35.0 LT  
 STA C 261+36.0 RT

**DETECTABLE WARNING SURFACE**  
 CHESTER:  
 STA C 261+35.0 LT  
 STA C 261+36.0 RT

**SPECIAL PROVISION (SOLAR POWERED SCHOOL ZONE FLASHING BEACON)**  
 CHESTER:  
 STA C 260+46.0 RT

**ADJUST ELEVATION OF VALVE BOX**  
 CHESTER:  
 STA C 261+16.0 RT  
 STA C 261+40.0 RT

**CHANGING ELEVATION OF SEWER MANHOLES**  
 CHESTER:  
 STA C 261+00.0 LT  
 STA C 261+70.0 LT  
 STA C 263+49.0 LT

**REMOVING AND RESETTING CURB**  
 CHESTER:  
 STA C 261+35.0 LT

**SIGN LEGEND**  
 R = REMOVE  
 S = SALVAGE  
 N = NEW  
 RET = RETAIN  
 B-B = BACK TO BACK  
 EXISTING = \_\_\_\_\_  
 NEW = \_\_\_\_\_  
 R = RETURN TO TOWN OF CHESTER

**NOT TO SCALE**

**CHESTER PROJECT LAYOUT SHEET #7**

PROJECT NAME: CHESTER-SPRINGFIELD-ROCKINGHAM-WINDSOR	PLOT DATE: 3/27/2015
PROJECT NUMBER: STP 2952(1)	DRAWN BY: A. KIRBY
FILE NAME: z13c518bdr_seg01.dgn	CHECKED BY: J. SHIELDS
PROJECT LEADER: D. GOZALKOWSKI	SHEET 37 OF 309
DESIGNED BY: A. HAWKINS	