

DURABLE 4 INCH WHITE LINE, TYPE A TAPE AND TEMPORARY 4 INCH WHITE LINE, PAINT
 (ALL LINES WILL INCLUDE EDGE LINE BREAKS AND RADIUS FOR TOWN HIGHWAYS)
 CHESTER:
 STA C 230+68.32 - STA C 235+50.00 EDGE LINE LT & RT
 STA C 230+94.72 EDGE LINES LT, TH-43

DURABLE 4 INCH YELLOW LINE, TYPE A TAPE AND TEMPORARY 4 INCH YELLOW LINE, PAINT
 (ALL LINES WILL INCLUDE C/L LINE BREAKS FOR TOWN HIGHWAYS)
 S = SOLID, D = DASHED
 CHESTER:
 STA C 230+68.32 - STA C 235+50.00 LT & RT
 STA C 230+94.72 DOUBLE SOLID LT, TH-43

DURABLE 8 INCH WHITE LINE, TYPE A TAPE
 CHESTER:
 VT. ROUTE 11 APPROACH - STA C 230+76.00 RT, FIRE HYDRANT, NO PARKING

DURABLE 24 INCH STOP BAR, TYPE A TAPE AND TEMPORARY 24 INCH STOP BAR, PAINT
 CHESTER:
 STA C 230+94.72 LT, TH-43

DURABLE LETTER OR SYMBOL, TYPE D TAPE
 CHESTER:
 STA C 230+94.72 LT, TH-43 "S,T,O,P" (4 EA)

TEMPORARY LETTER OR SYMBOL, PAINT
 CHESTER:
 STA C 230+94.72 LT, TH-43 "S,T,O,P" (8 EA)

DURABLE CROSSWALK MARKING, TYPE A TAPE AND TEMPORARY CROSSWALK MARKING, PAINT
 CHESTER:
 STA C 230+94.72 LT, TH-43

REMOVAL OF EXISTING PAVEMENT MARKINGS
 CHESTER:
 STA C 230+94.72 LT, TH-43 "S,T,O,P" (58.3 SF)

REMOVING SIGNS AS SHOWN - II

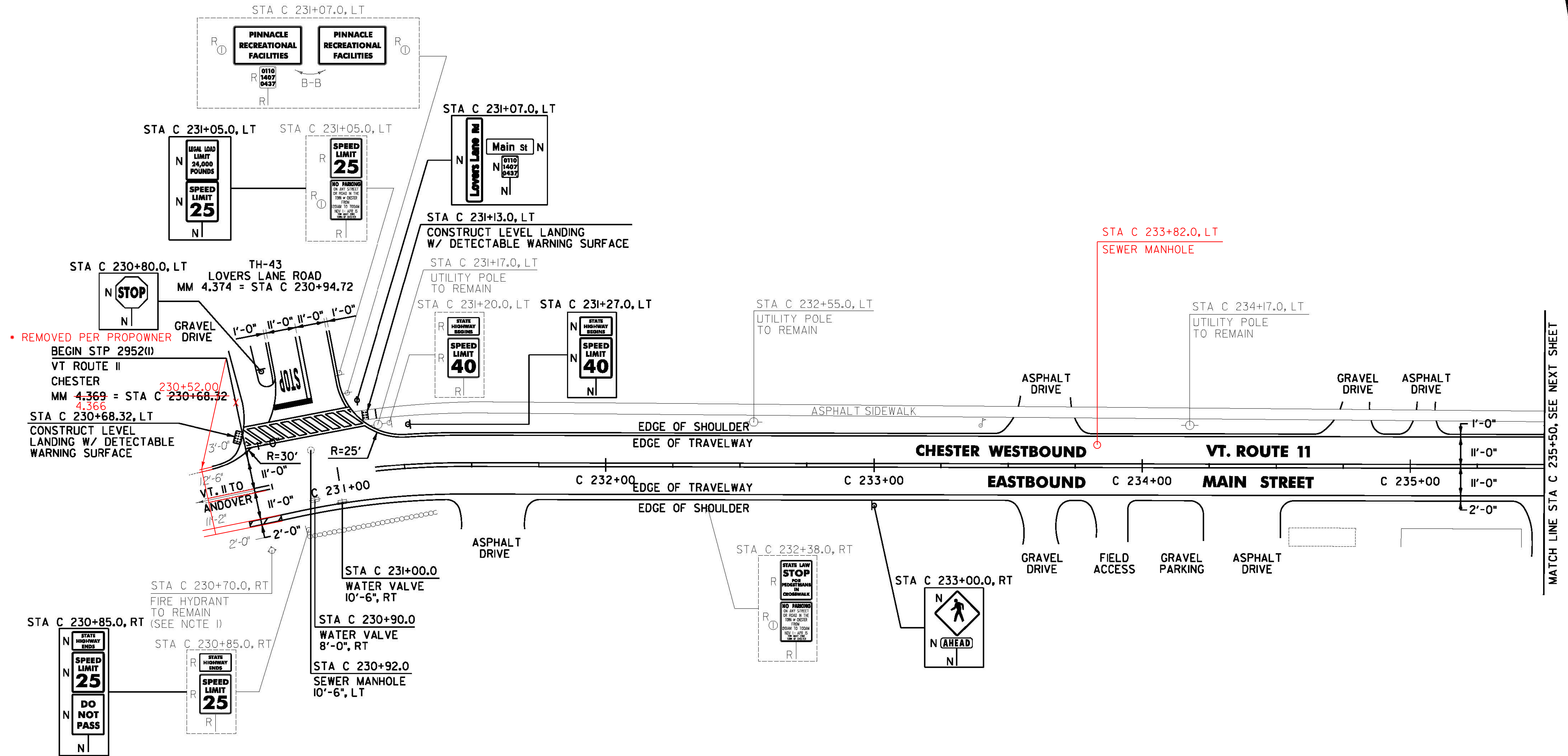
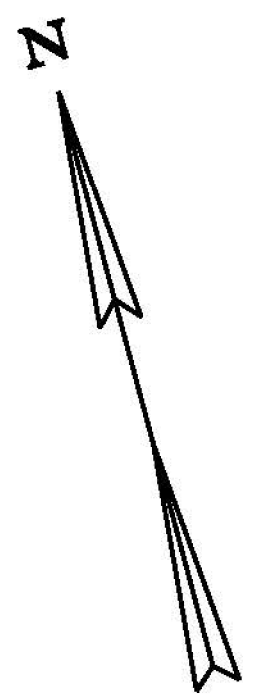

• REMOVED PER PROPOWNER
 BEGIN STP 2952(I)
 VT ROUTE 11
 CHESTER
 MM 4.369 = STA C 230+68.32
 4.366
 STA C 230+68.32, LT
 CONSTRUCT LEVEL LANDING W/ DETECTABLE WARNING SURFACE

CHANGING ELEVATION OF SEWER MANHOLES
 CHESTER:
 STA C 230+92.0 LT
 STA C 233+82.0, LT
PORTLAND CEMENT CONCRETE SIDEWALK, 5 INCH
 CHESTER:
 STA C 230+68.32 LT
 STA C 231+13.0 LT

DETECTABLE WARNING SURFACE
 CHESTER:
 STA C 230+68.32 LT
 STA C 231+13.0 LT

ADJUST ELEVATION OF VALVE BOX
 CHESTER:
 STA C 230+90.0 RT
 STA C 231+00.0 RT

SIGN LEGEND
 R = REMOVE
 S = SALVAGE
 N = NEW
 RET = RETAIN
 B-B = BACK TO BACK
 EXISTING = _____
 NEW = _____
 R = RETURN TO TOWN OF CHESTER

NOT TO SCALE
CHESTER PROJECT LAYOUT SHEET #1

NOTE:
 I. SEE SHEET 16 FOR FIRE HYDRANT PAVEMENT MARKING DETAIL.

PROJECT NAME: CHESTER-SPRINGFIELD-ROCKINGHAM-WINDSOR	PLOT DATE: 3/27/2015
PROJECT NUMBER: STP 2952(I)	DRAWN BY: A. KIRBY
FILE NAME: z13c518bdr_seg01.dgn	CHECKED BY: J. SHIELDS
DESIGNED BY: A. HAWKINS	SHEET 31 OF 309

MATCH LINE STA C 235+50, SEE NEXT SHEET