

GPS CONTROL POINTS

PT #1 HANDLY
 NORTH = 291658.0680
 EAST = 1644850.6590
 ELEV. = 427.520

GENERAL LOCATION - SPRINGFIELD, VT
 TO REACH FROM THE INTERSECTION OF VT ROUTES 11 AND 106 IN SPRINGFIELD
 GO SOUTHEAST ALONG VT ROUTE 11 FOR 0.5 MI (0.8 KM) TO A CONCRETE
 SPILLWAY CARRYING THE BLACK RIVER AND THE MARK ON THE RIGHT.
 THE STATION IS LOCATED 17.5 M (57.4 FT) WEST SOUTHWEST OF AND 2 M
 (6.6 FT) LOWER THAN THE SOUTHWEST EDGE OF PAVEMENT OF VT ROUTE 11,
 7.2 M (23.6 FT) SOUTHWEST OF POLE 5A, 0.9 M (3.0 FT) WEST SOUTHWEST
 OF THE NORTHWEST CORNER OF A SINGLE STORY BUILDING, AND 1.2 M
 (3.9 FT) EAST OF THE WEST EDGE OF THE CONCRETE SPILLWAY FOR THE BLACK
 RIVER.

PT #2 ONE ILL
 NORTH = 292646.1710
 EAST = 1643742.5130
 ELEV. = 450.260

GENERAL LOCATION - SPRINGFIELD, VT
 TO REACH FROM THE INTERSECTION OF VT ROUTES 11 AND 106 IN SPRINGFIELD
 GO SOUTHEAST ALONG VT ROUTE 11 FOR 0.25 MI (0.40 KM) TO THE MARK ON
 THE LEFT.
 OWNERSHIP - FRANCES W. ONEILL 108 VT RT 11 RIVER STREET, SPRINGFIELD,
 VT.
 THE STATION IS LOCATED 10.0 M (32.8 FT) NORTH NORTHEAST OF AND 1.0 M
 (3.3 FT) HIGHER THAN THE NORTHEAST EDGE OF PAVEMENT OF VT ROUTE 11,
 8.3 M (27.2 FT) EAST SOUTHEAST OF THE CENTERLINE OF A PAVED DRIVE,
 5.5 METERS (18.0 FT) SOUTH OF THE SOUTHWEST CORNER OF A 1 1/2 STORY
 HOUSE (108), AND 6.2 M (20.3 FT) WEST SOUTHWEST OF THE SOUTHEAST
 CORNER OF HOUSE 108.

TRAVERSE TIES

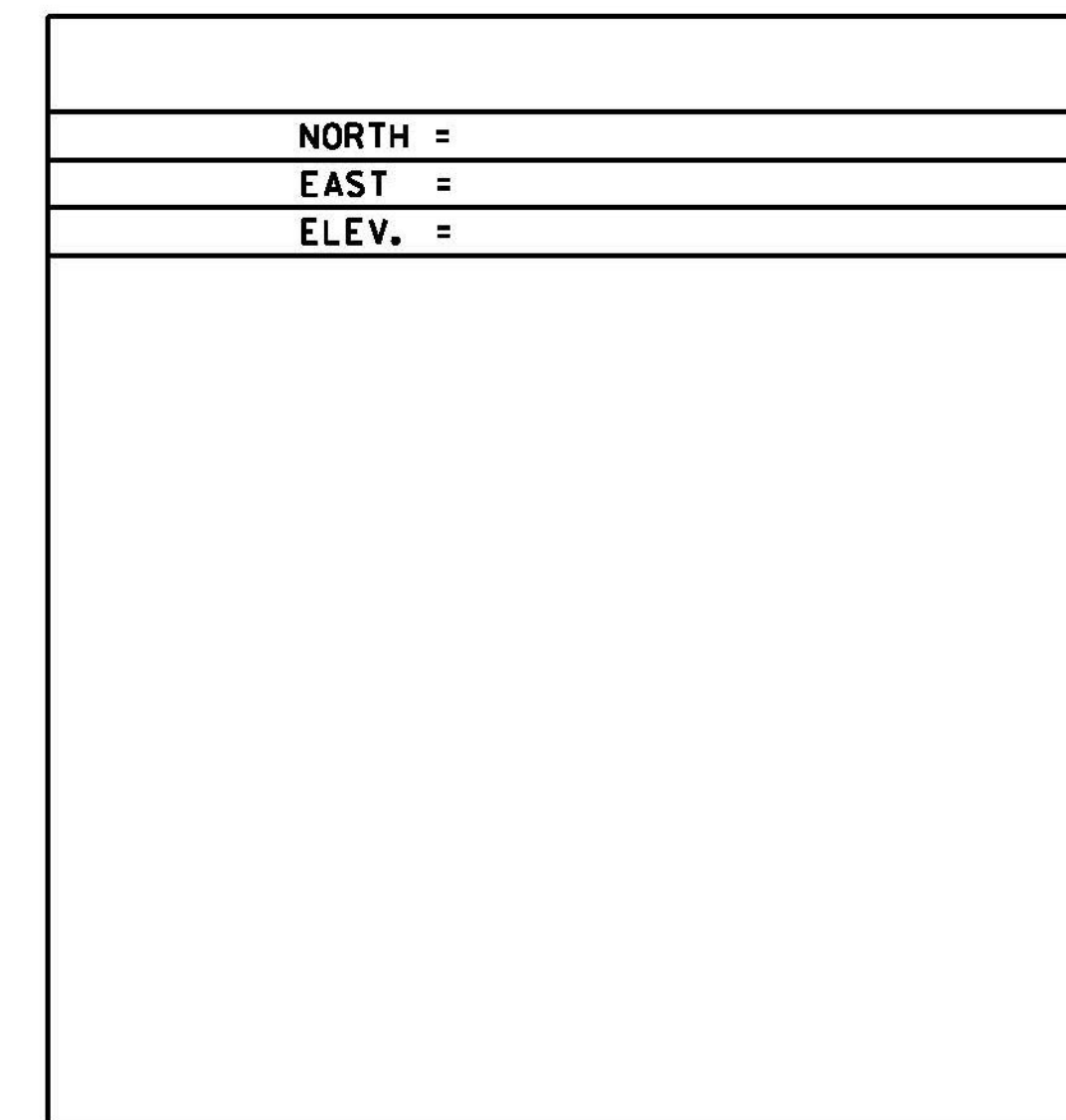
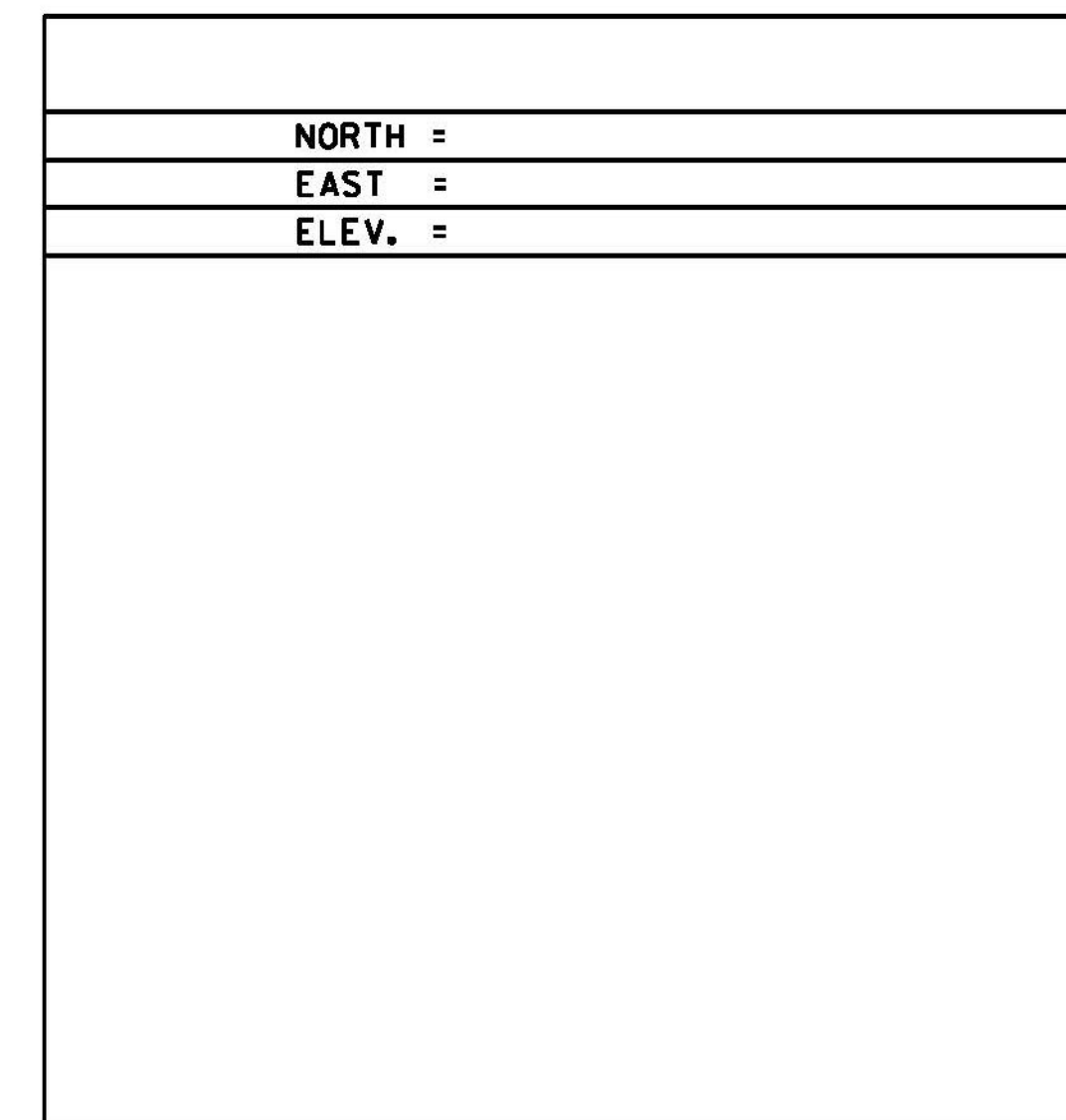
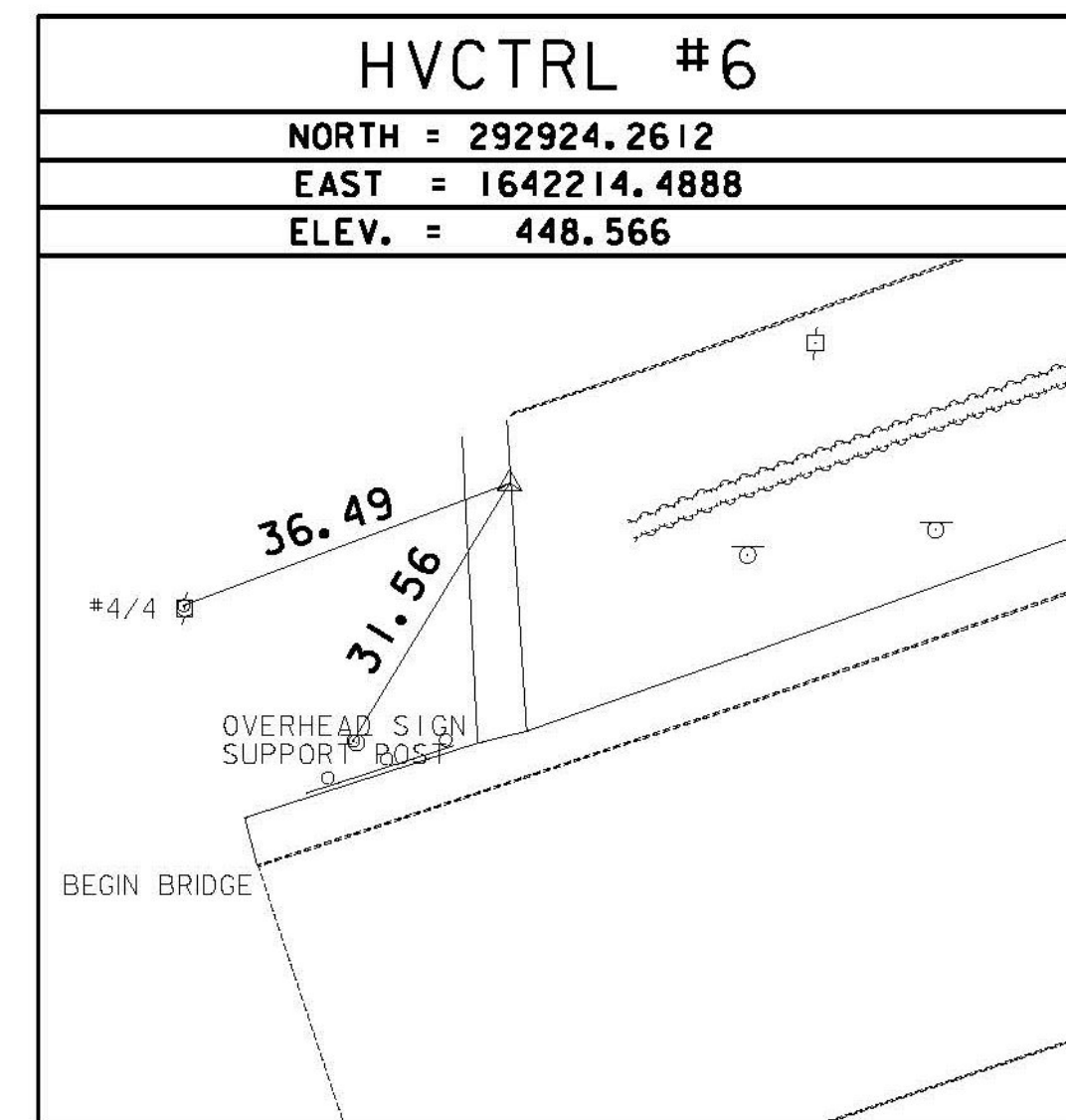
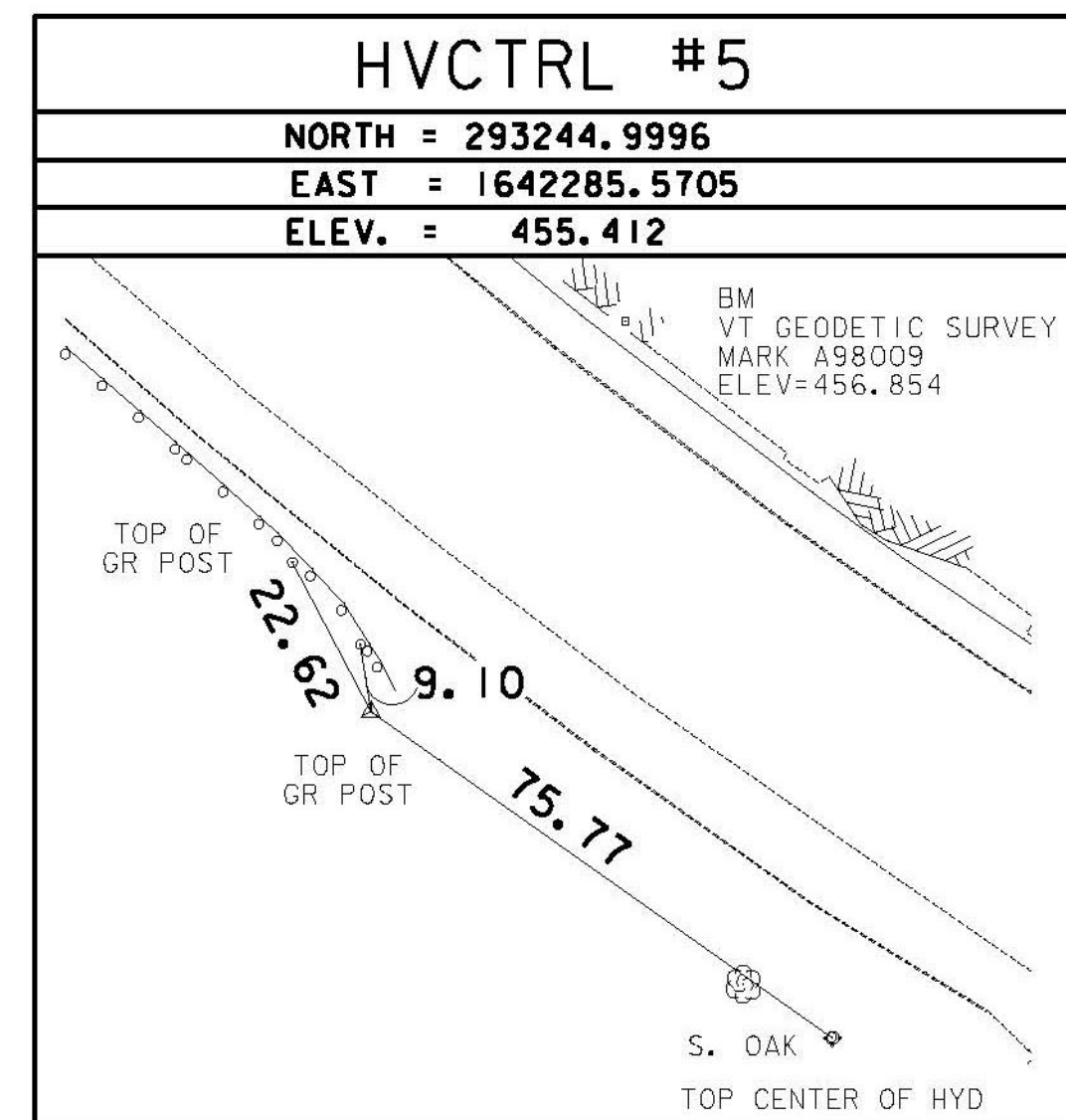
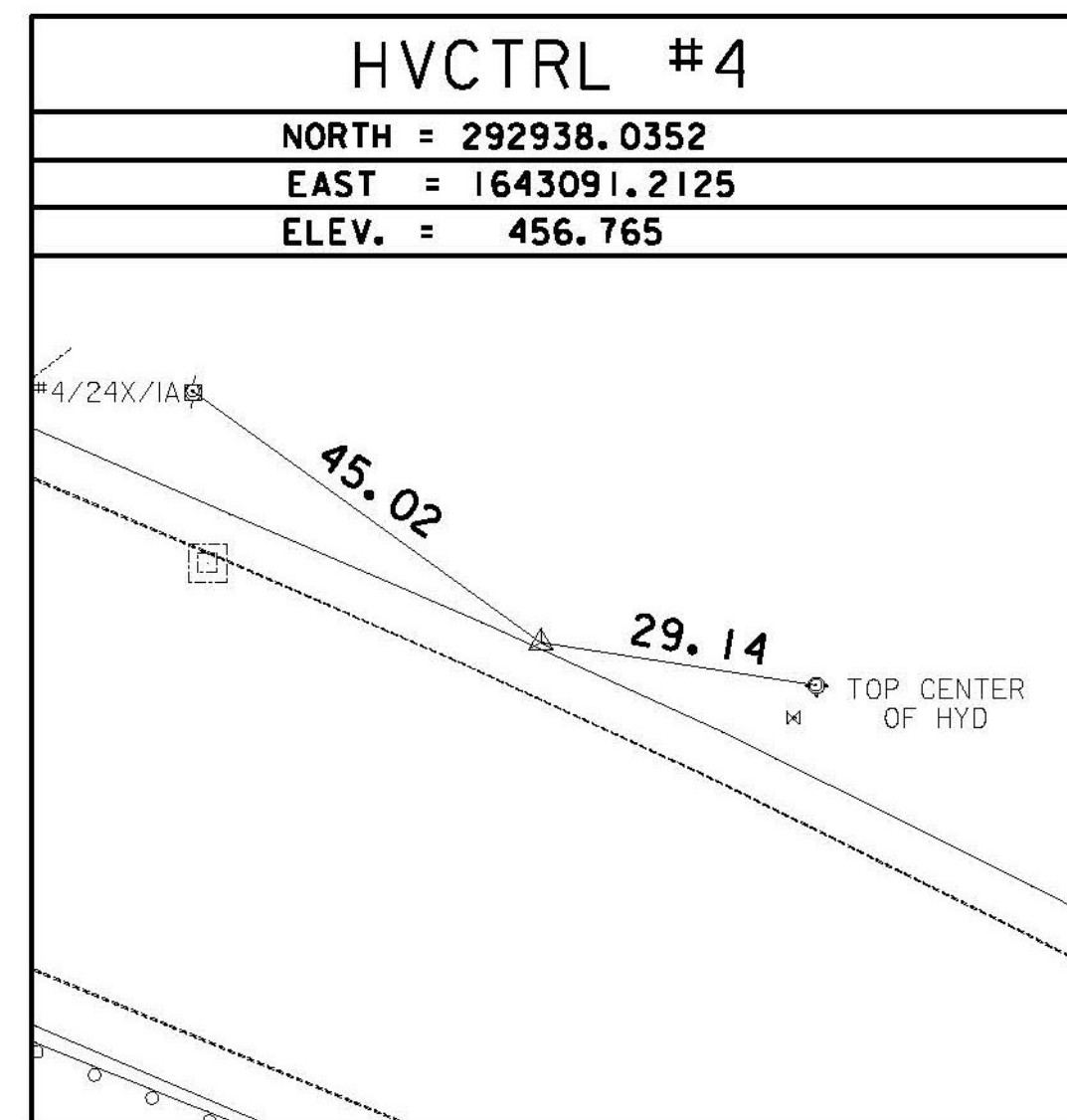

MAIN TRAVERSE COMPLETED 12/16/2013 BY R. GILMAN P.C. P. WINTERS. & C. CYR

ALIGNMENT TIES

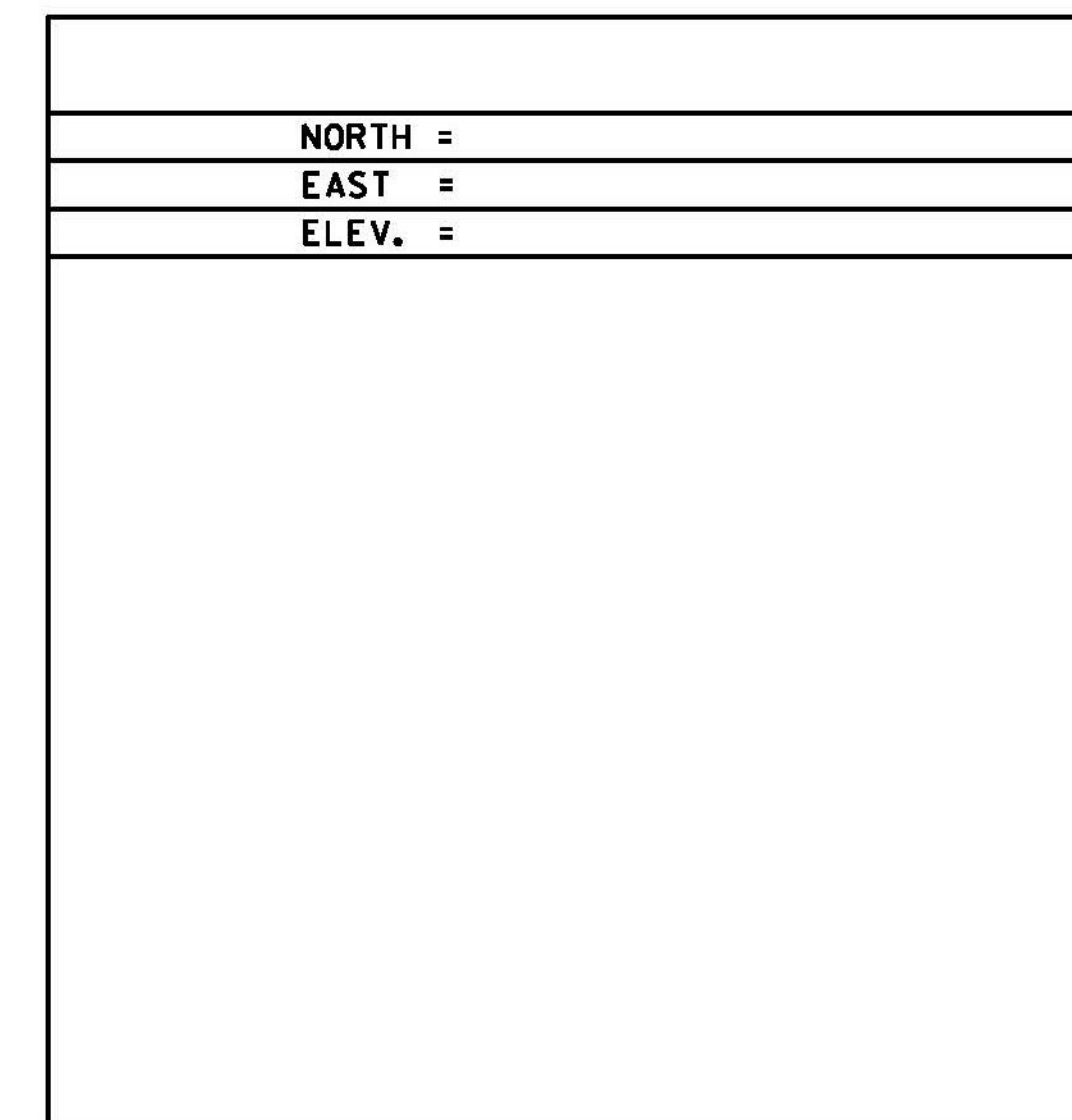
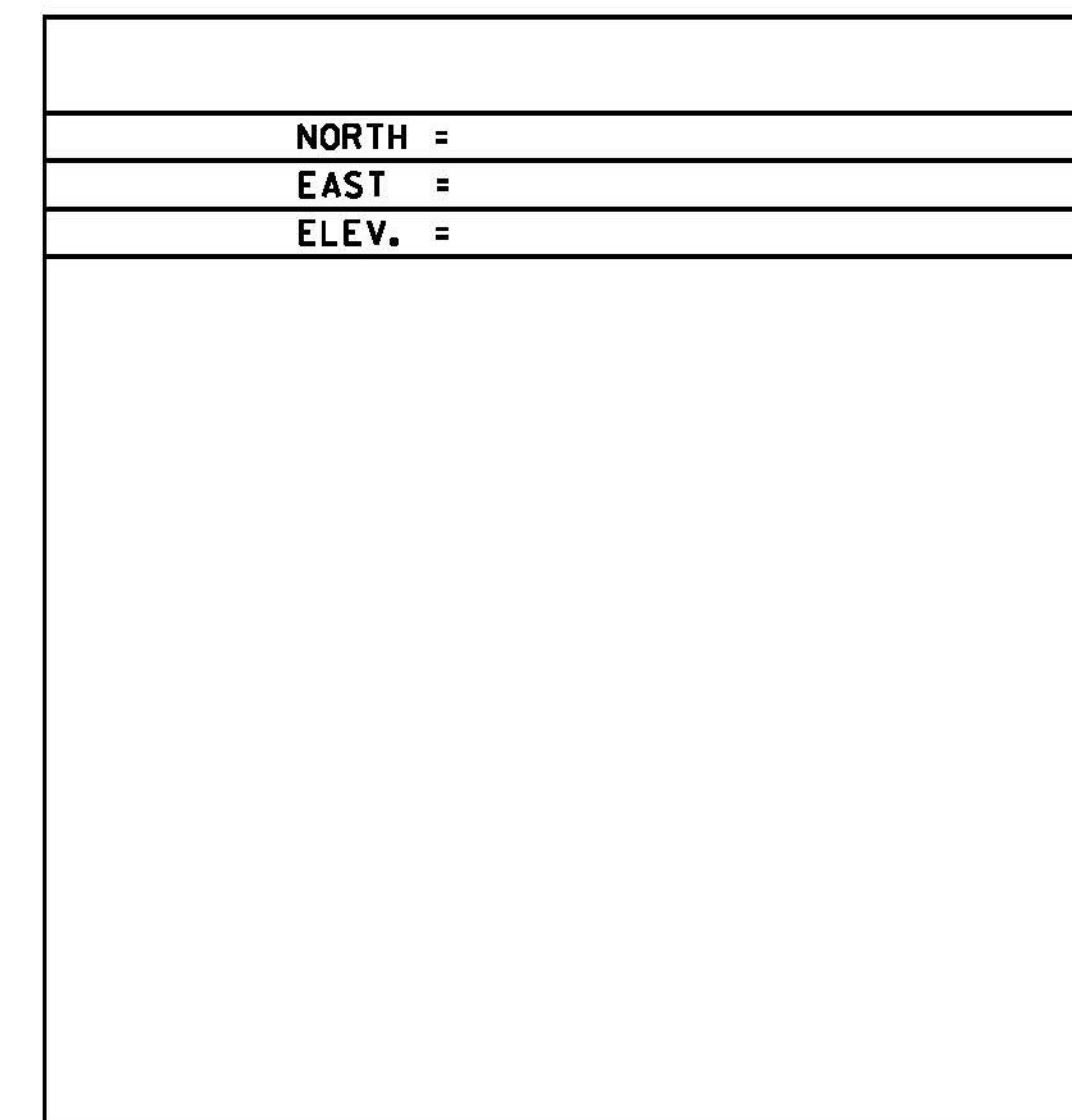
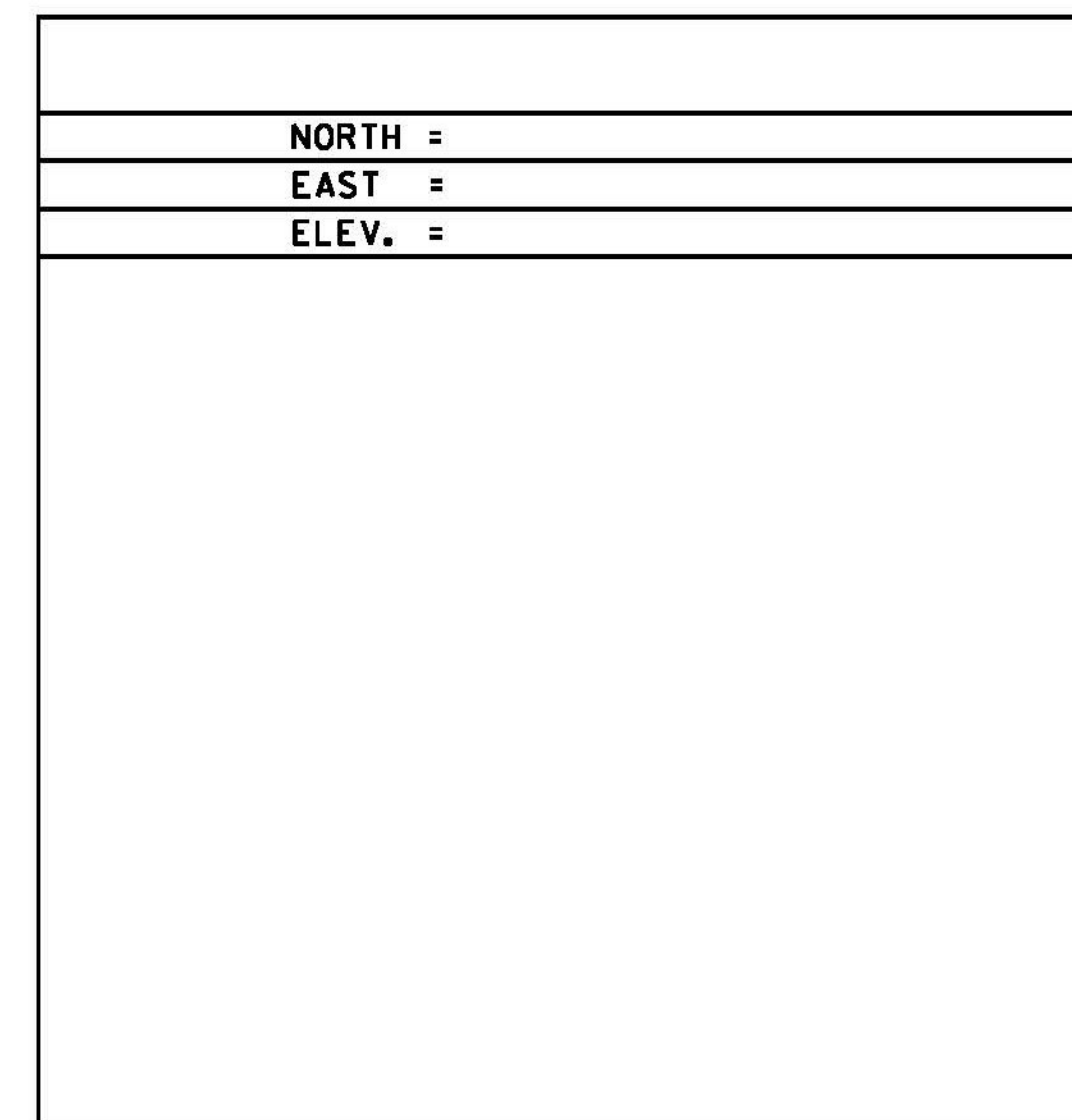
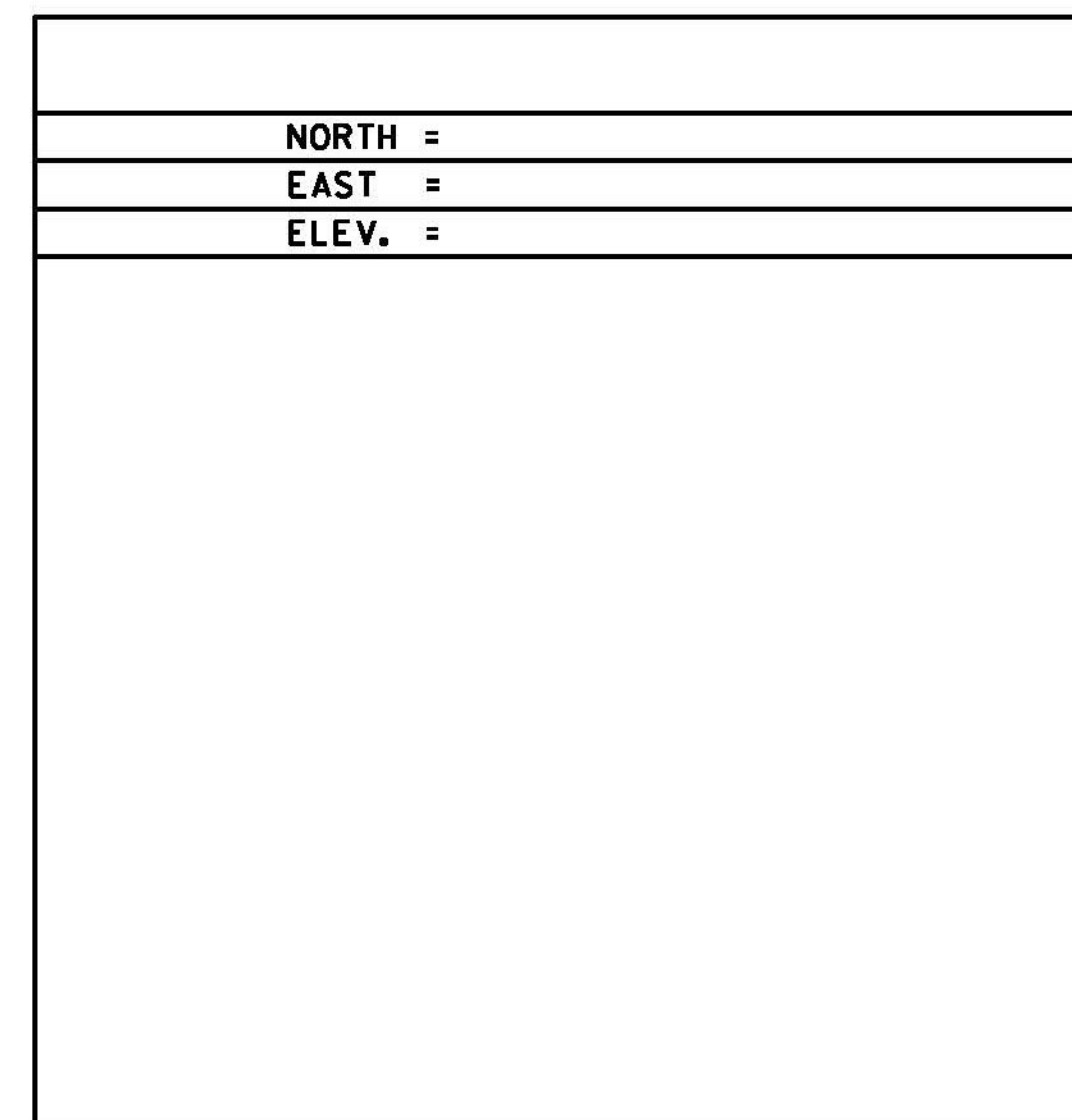
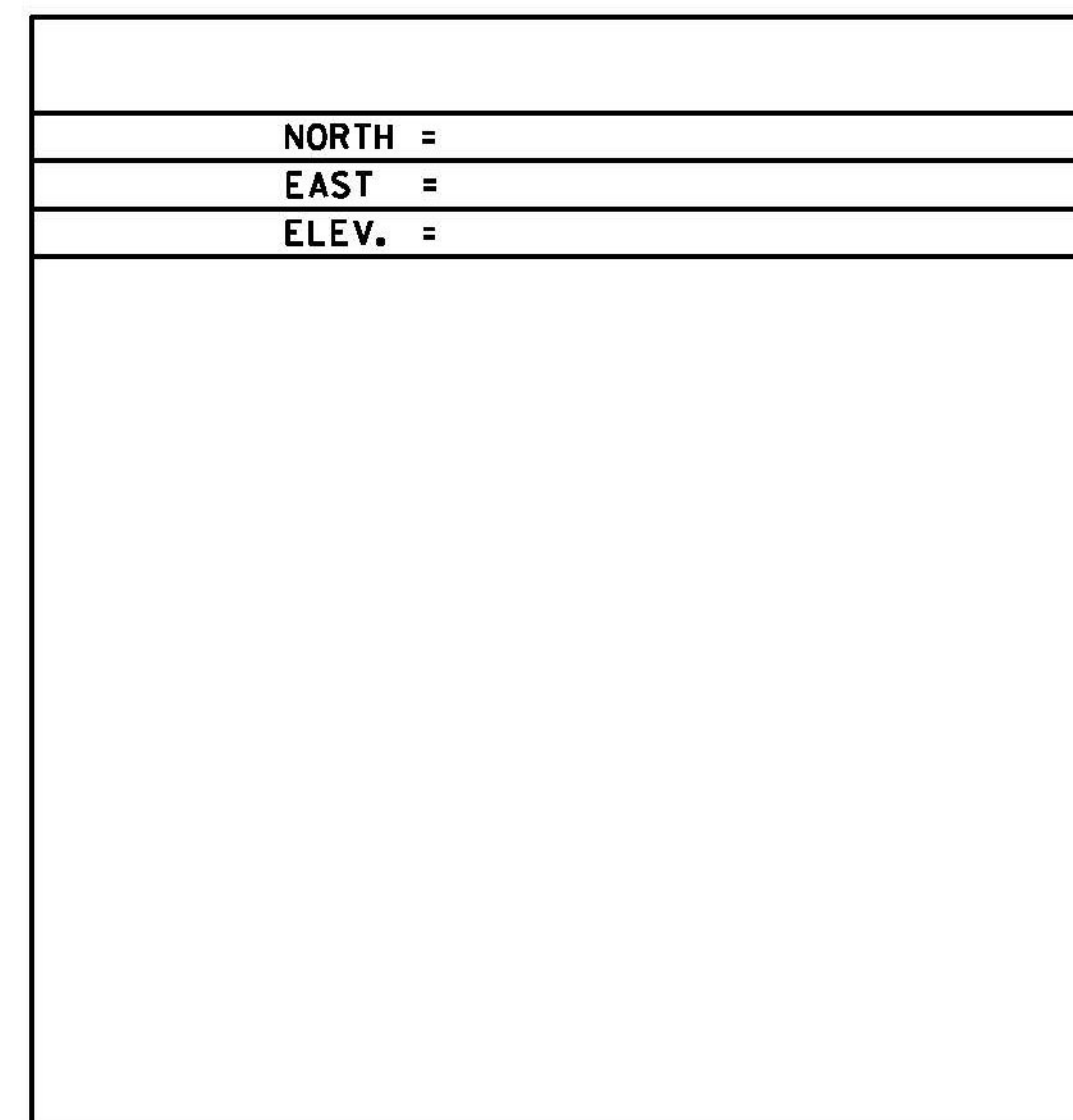

DATUM
 VERTICAL NAVD88
 HORIZONTAL NAD83(96)
 ADJUSTMENT COMPASS

NOT TO SCALE

TIE SHEET #1	PROJECT NAME: CHESTER-SPRINGFIELD-ROCKINGHAM-WINDSOR
	PROJECT NUMBER: STP 2952(1)
	FILE NAME: z13c518b1+01.dgn
DESIGNED BY: A. HAWKINS	PLOT DATE: 3/27/2015
CHECKED BY: J. SHIELDS	DRAWN BY: A. KIRBY
	SHEET 5 OF 309