

SOIL INFORMATION: TURNBRIDGE-LYMAN  
 COMPLEX, VERY ROCKY 15-35% SLOPES  
 K=0.20, HIGHLY ERODIBLE  
 HYDROLOGIC SOIL GROUP: C

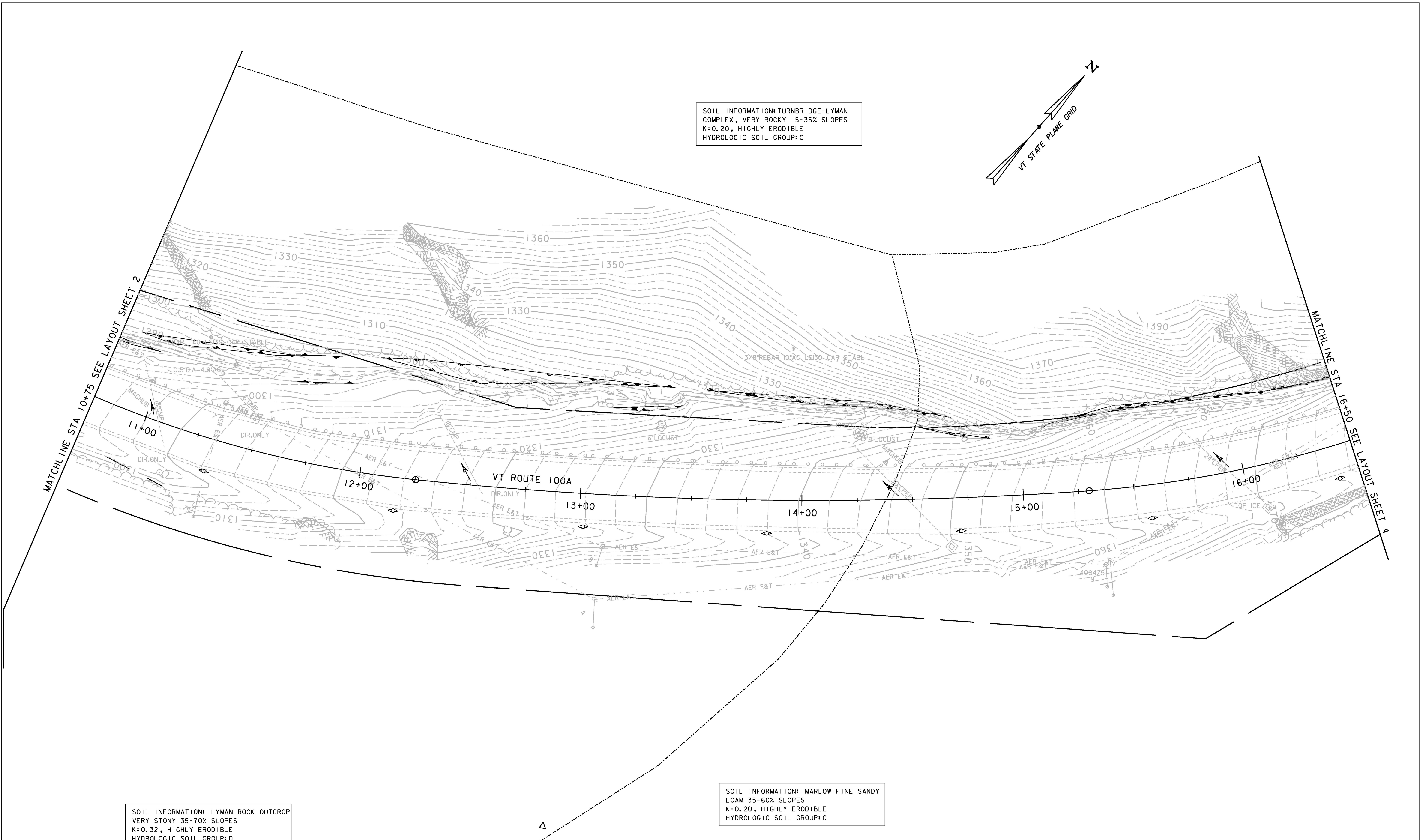

SOIL INFORMATION: LYMAN ROCK OUTCROP  
 VERY STONY 35-70% SLOPES  
 K=0.32, HIGHLY ERODIBLE  
 HYDROLOGIC SOIL GROUP: D

SOIL INFORMATION: MARLOW FINE SANDY  
 LOAM 35-60% SLOPES  
 K=0.20, HIGHLY ERODIBLE  
 HYDROLOGIC SOIL GROUP: C

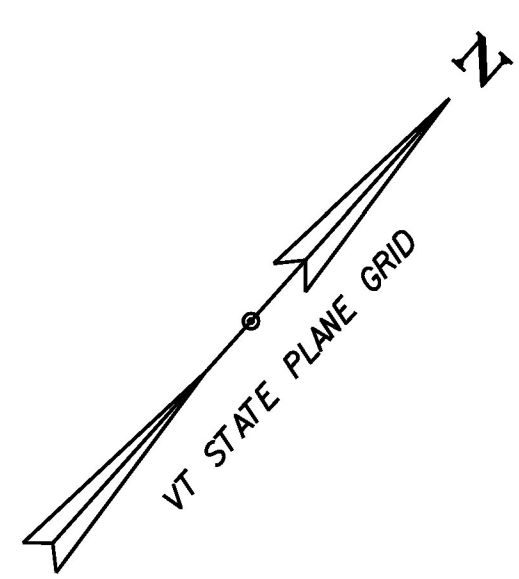

|                               |                        |
|-------------------------------|------------------------|
| PROJECT NAME: PLYMOUTH        | PLOT DATE: 5/17/2016   |
| PROJECT NUMBER: ER 0149(6)    | DRAWN BY: M. LOVETT    |
| FILE NAME: z13c318bdr_ero.dgn | CHECKED BY: B. COLBURN |
| PROJECT LEADER: J. SANTACRUCE | SHEET 37 OF 68         |
| DESIGNED BY: M. HASKINS       |                        |
| EPSC EXISTING LAYOUT SHEET 3  |                        |