

SOIL INFORMATION: TURNBRIDGE-LYMAN  
 COMPLEX, VERY ROCKY 15-35% SLOPES  
 K=0.20, HIGHLY ERODIBLE  
 HYDROLOGIC SOIL GROUP: D

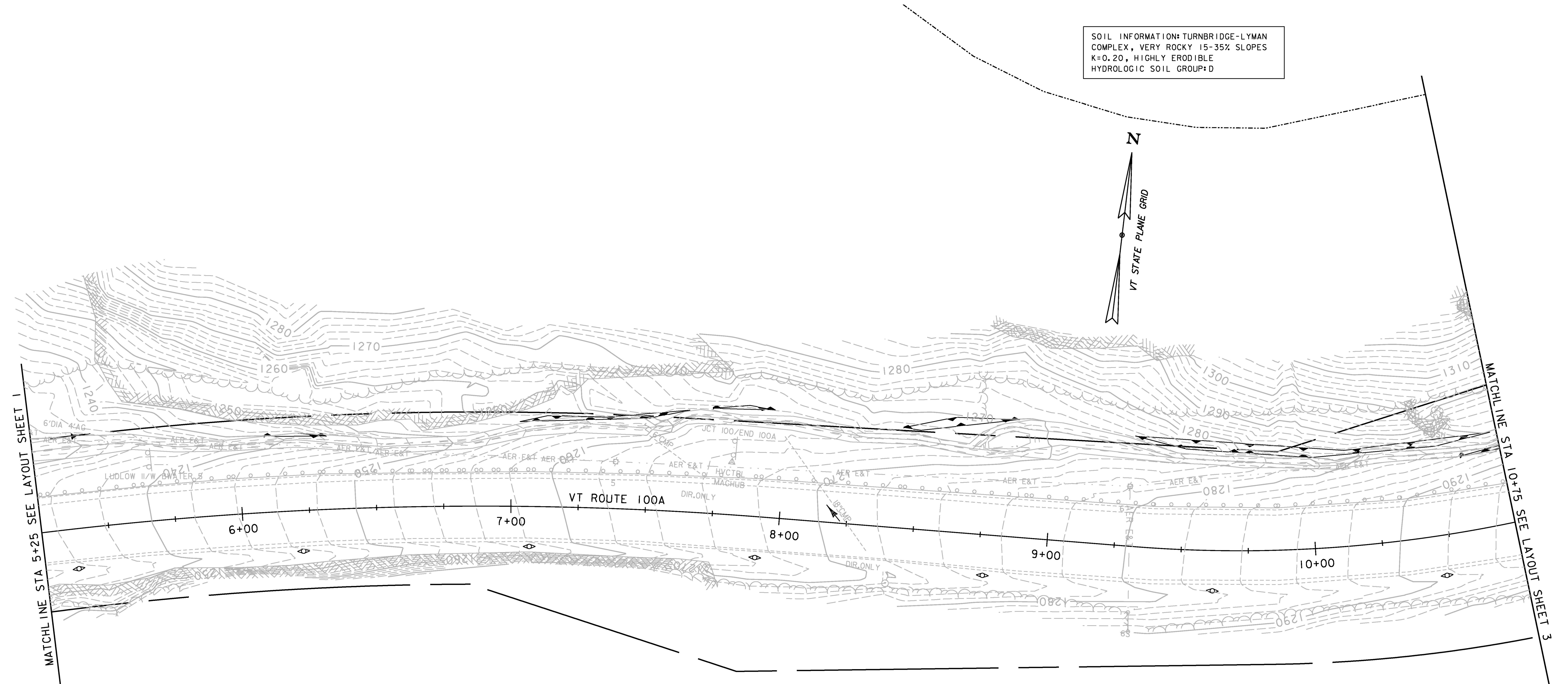
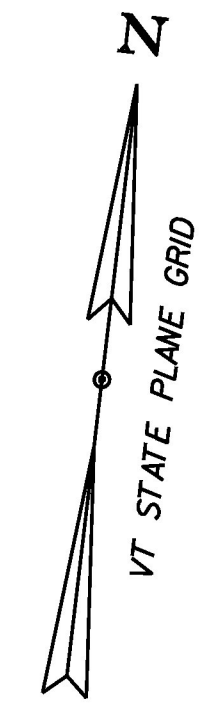

MATCHLINE STA 5+25 SEE LAYOUT SHEET 1

MATCHLINE STA 10+75 SEE LAYOUT SHEET 3

SOIL INFORMATION: LYMAN ROCK OUTCROP  
 VERY STONY 35-70% SLOPES  
 K=0.32, HIGHLY ERODIBLE  
 HYDROLOGIC SOIL GROUP: D



PROJECT NAME: PLYMOUTH	PLOT DATE: 5/17/2016
PROJECT NUMBER: ER 0149(6)	DRAWN BY: M. LOVETT
FILE NAME: z13c318bdr_ero.dgn	CHECKED BY: B. COLBURN
PROJECT LEADER: J.SANTACRUCE	SHEET 36 OF 68
DESIGNED BY: M. HASKINS	
EPSC EXISTING LAYOUT SHEET 2	