

TEMPORARY STONE CHECK DAM, TYPE I
 STA 5+25, RT TO STA 10+75, RT

EROSION LOG
 STA 5+25, LT TO STA 5+96, LT
 STA 9+58, RT TO STA 10+75, RT

PROJECT DEMARCATION FENCE
 STA 5+90, LT TO STA 7+00, LT
 STA 7+75, RT TO STA 10+75, RT

INLET PROTECTION DEVICE, TYPE I
 STA 8+41, RT

PREFABRICATED CHECK DAM
 STA 5+60.0, LT
 STA 10+25.0, LT

VT RTE 100A
 CURVE 2A
 $\Delta = 33^\circ 37' 02''$
 $D = 11^\circ 27' 33''$
 $R = 500.00'$
 $T = 151.04'$
 $L = 293.36'$
 $E = 22.32'$

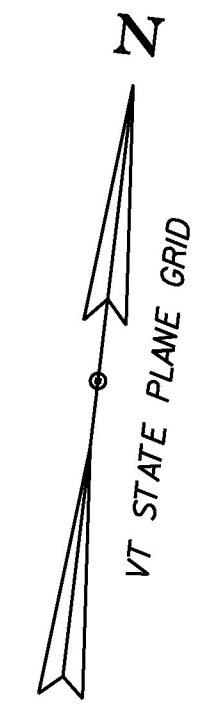

**BEGIN R.O.W. PROJECT
 PLYMOUTH - ER 0149(6)
 STA. 5+53, 44.35' LT**

1A
SWEETSER, RICHARD A. & CAROLE J.

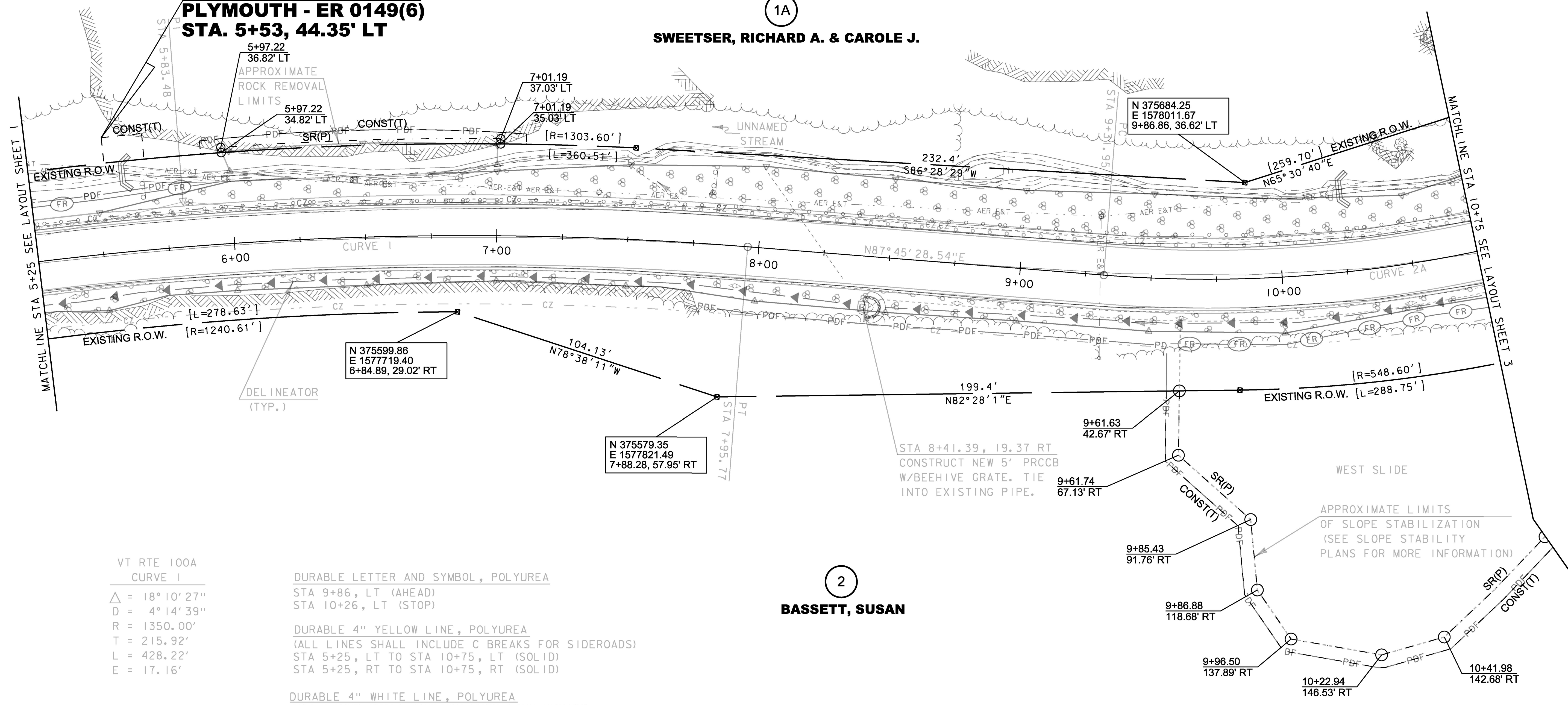

VT RTE 100A
 CURVE 1
 $\Delta = 18^\circ 10' 27''$
 $D = 4^\circ 14' 39''$
 $R = 1350.00'$
 $T = 215.92'$
 $L = 428.22'$
 $E = 17.16'$

DURABLE LETTER AND SYMBOL, POLYUREA
 STA 9+86, LT (AHEAD)
 STA 10+26, LT (STOP)

DURABLE 4" YELLOW LINE, POLYUREA
 (ALL LINES SHALL INCLUDE C BREAKS FOR SIDEROADS)
 STA 5+25, LT TO STA 10+75, LT (SOLID)
 STA 5+25, RT TO STA 10+75, RT (SOLID)

DURABLE 4" WHITE LINE, POLYUREA
 (ALL LINES SHALL INCLUDE EDGE LINE BREAKS AND RADII FOR SIDEROADS)
 STA 5+25, LT TO STA 10+75, LT (SOLID)
 STA 5+25, RT TO STA 10+75, RT (SOLID)

2
BASSETT, SUSAN

LINES SHOWN ON THIS PLAN AS EXISTING PROPERTY LINES P/L ARE BELIEVED TO BE ACCURATE BUT SHOULD NOT BE RELIED UPON FOR PURPOSES UNRELATED TO THE STATE OF VERMONT'S ACQUISITION OF LAND AND RIGHTS FOR THIS PROJECT.



FOR R.O.W. USE ONLY

PROJECT NAME: PLYMOUTH	PLOT DATE: 26-MAY-2015
PROJECT NUMBER: ER 0149(6)	DRAWN BY: A. EGIZI
FILE NAME: r13c318lay2.dgn	CHECKED BY: R. CLOUTIER
PROJECT LEADER: P. LIBBY	SHEET 19 OF 68
DESIGNED BY: McFARLAND JOHNSON	
R.O.W. LAYOUT SHEET 2 OF 4	