

GPS CONTROL POINTS

RUTLAND CORS ARP

PID DK4109  
 N = 403876.08  
 E = 1513436.17  
 ELLIP HEIGHT = 529.69

STATION IS A GPS CONTINUOUSLY OPERATING REFERENCE STATION. STATION IS THE ANTENNA REFERENCE POINT OF THE GPS ANTENNA. THE MONUMENT IS ATTACHED TO A FIVE STORY CONCRETE BUILDING WITH A 8 FT CONCRETE FOUNDATION. THIS PORTION OF THE BUILDING HOUSES THE STAIRWELL AND ELEVATOR SHAFT FOR A PARKING GARAGE. THE BUILDING WAS BUILT IN 1999. THE MAST IS A 1.75 INCH DIA GALV PIPE THAT IS 108 INCHES LONG. THE MAST IS FIELD WELDED TO THREE STEEL MOUNTING STRUTS. THE TOP STRUT IS ATTACHED TO THE CONCRETE BUILDING WITH TWO 1/2 INCH SS BOLTS SECURED LEAD ANCHORS. THE OTHER TWO STRUTS ARE ATTACHED WITH 2 THROUGH BOLTS THAT CONSIST OF 1/2 INCH SS THREADED RODS AND NUTS.

TRAVERSE TIES

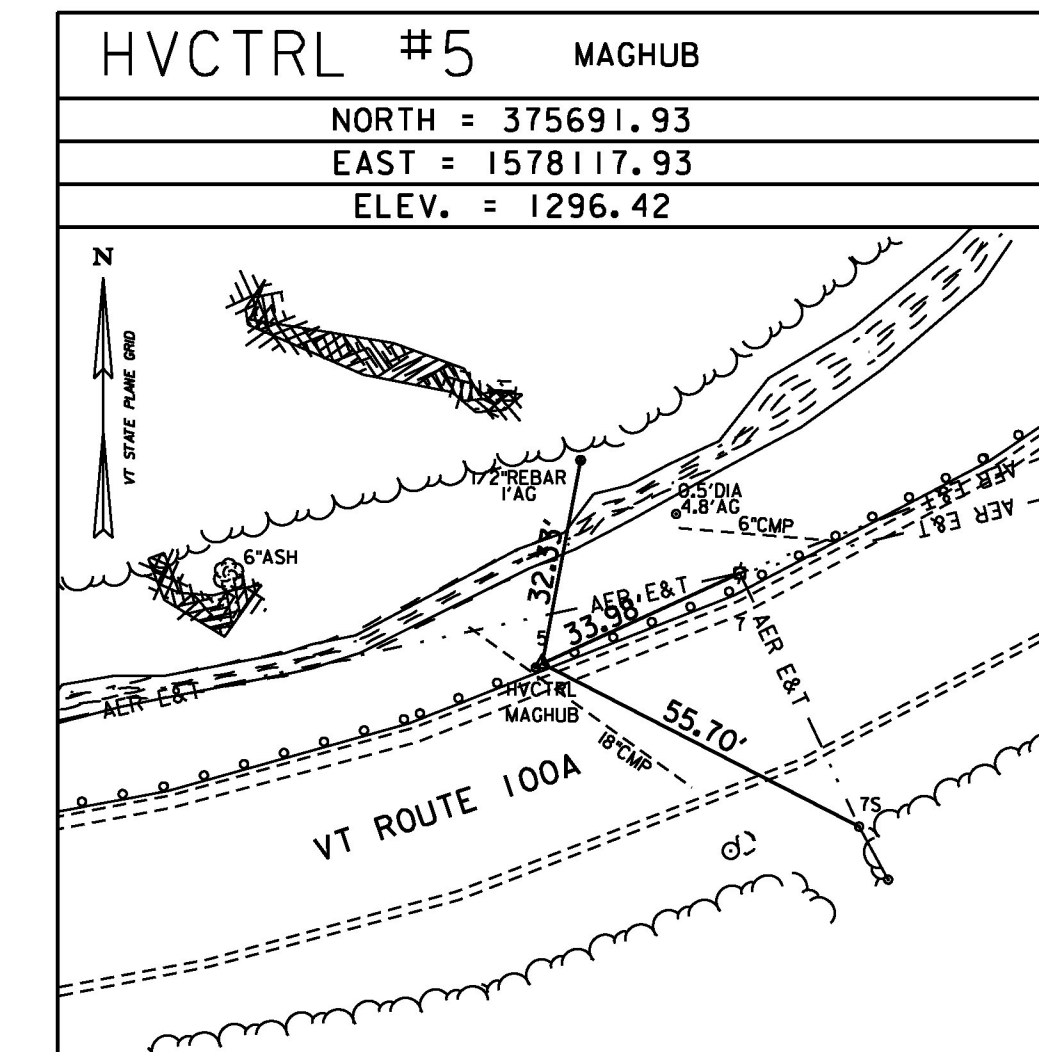
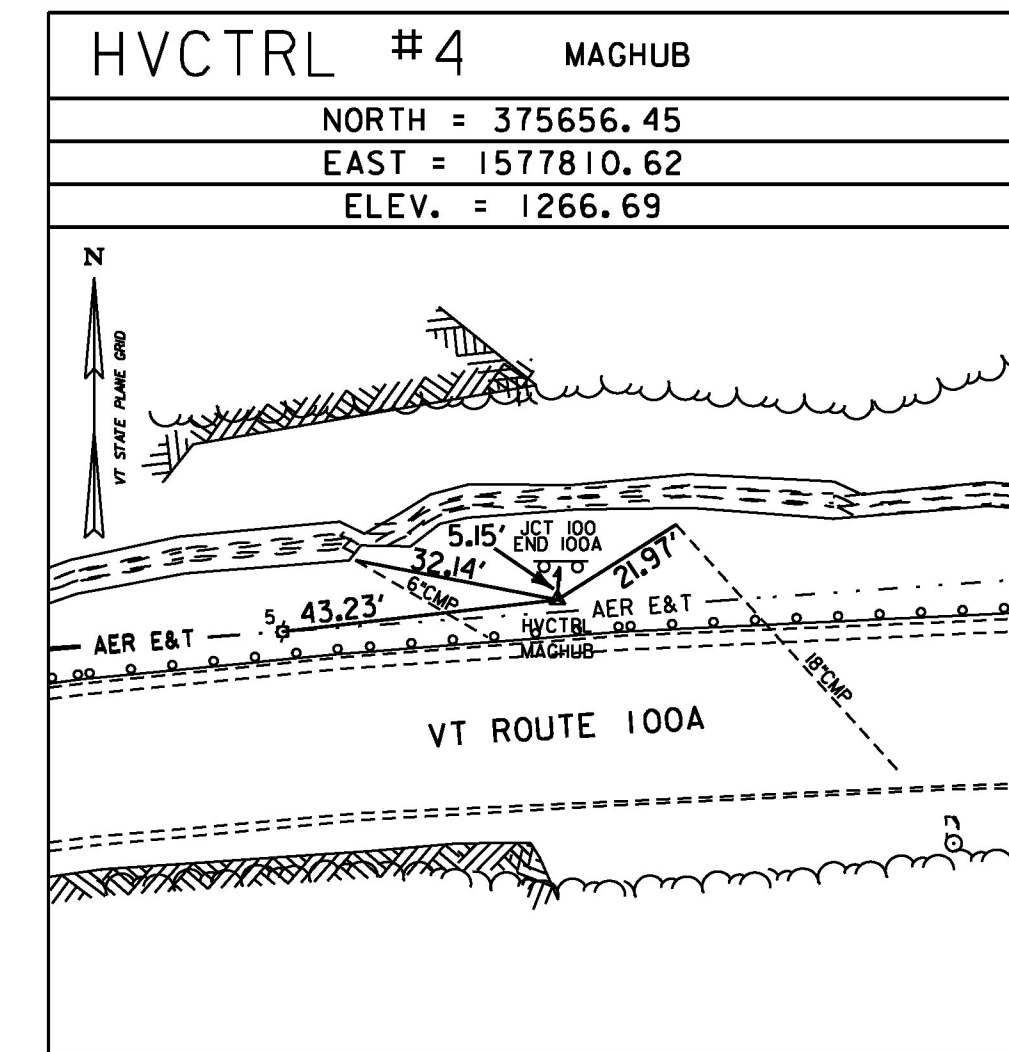
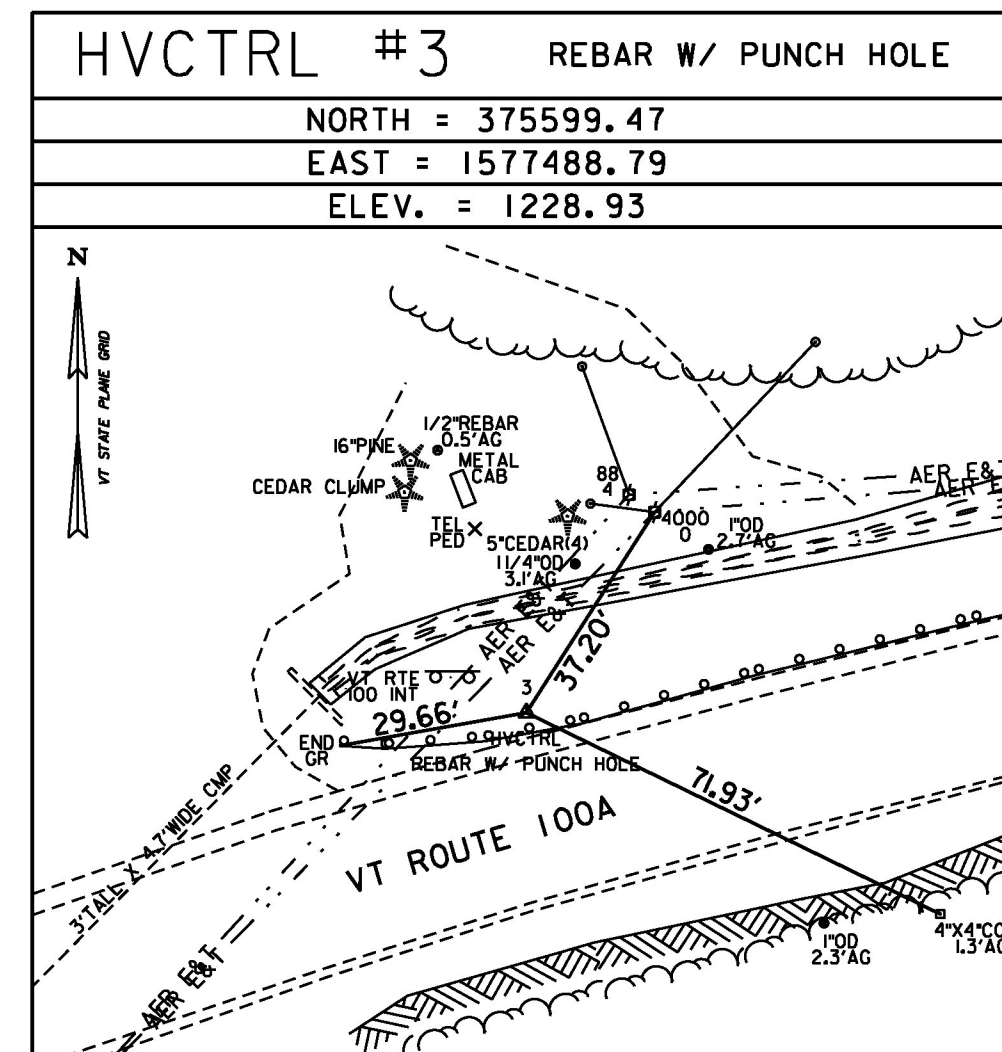
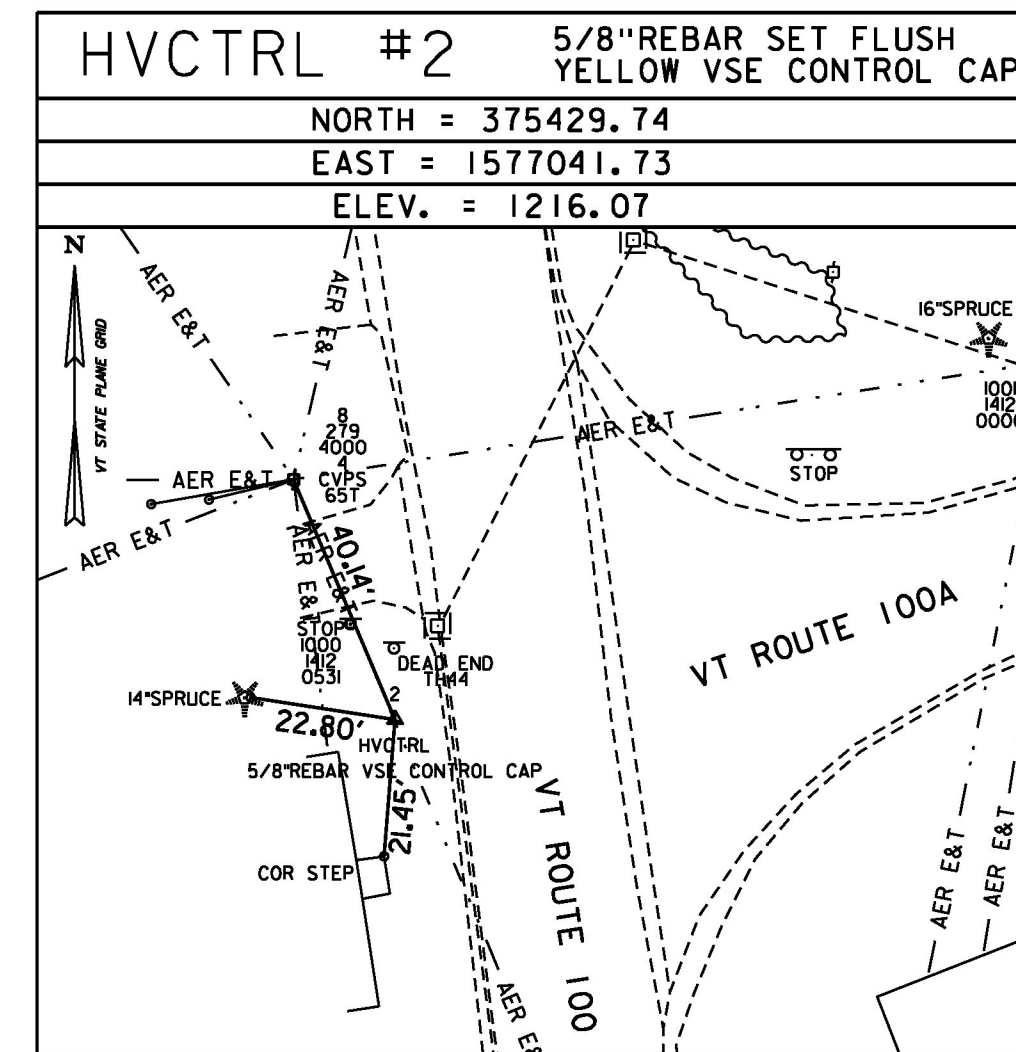
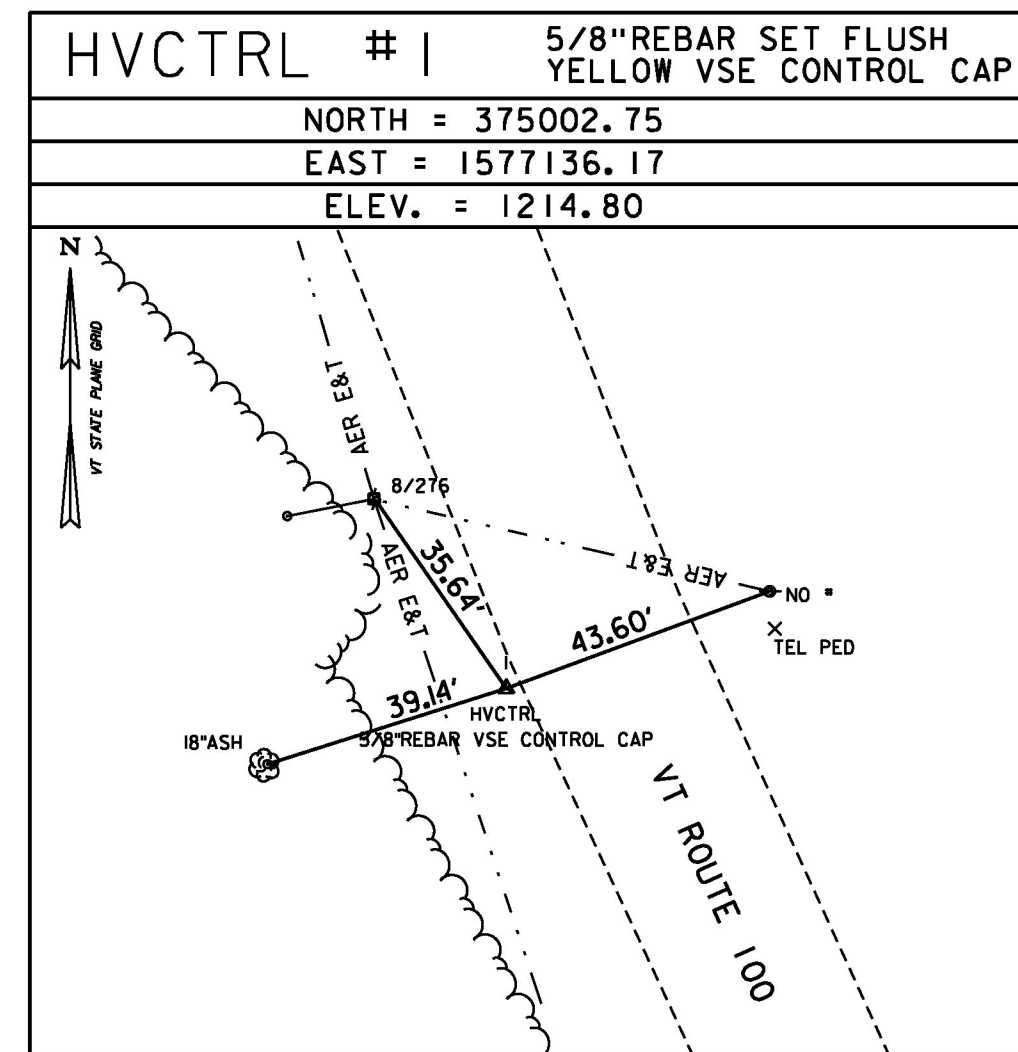

\* SURVEY COMPLETED: JANUARY 23, 2014 BY VSE, T. CATTANEO-PC, T. COMSTOCK

TRAVERSE TIES

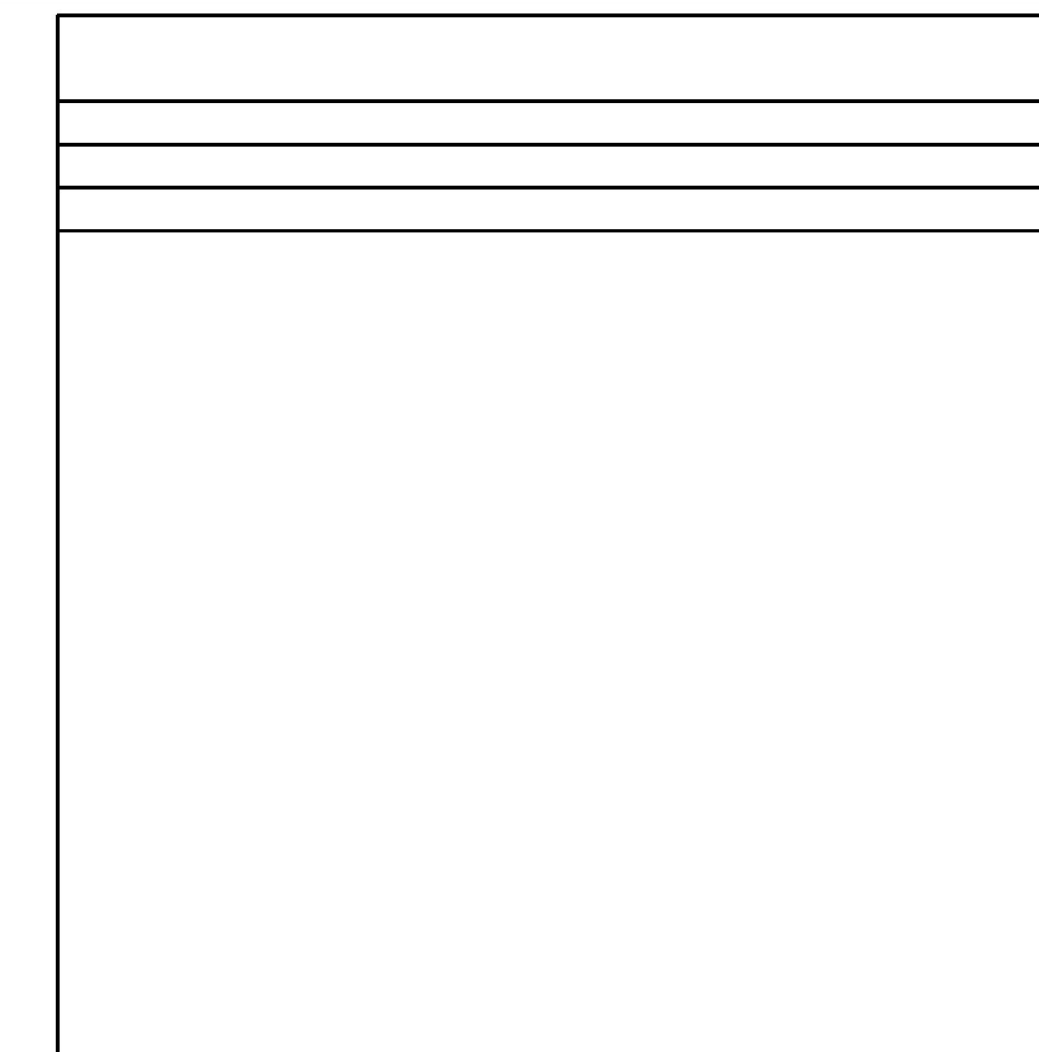
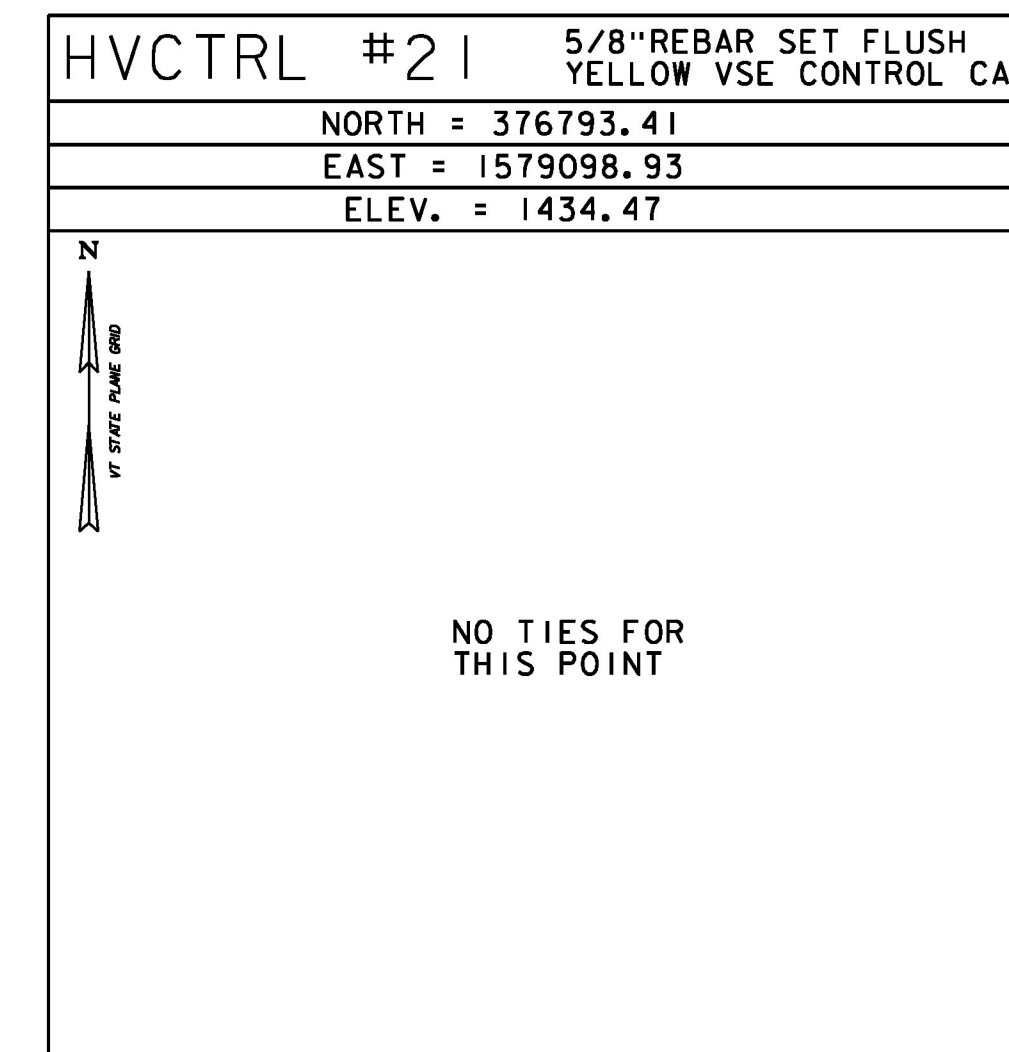
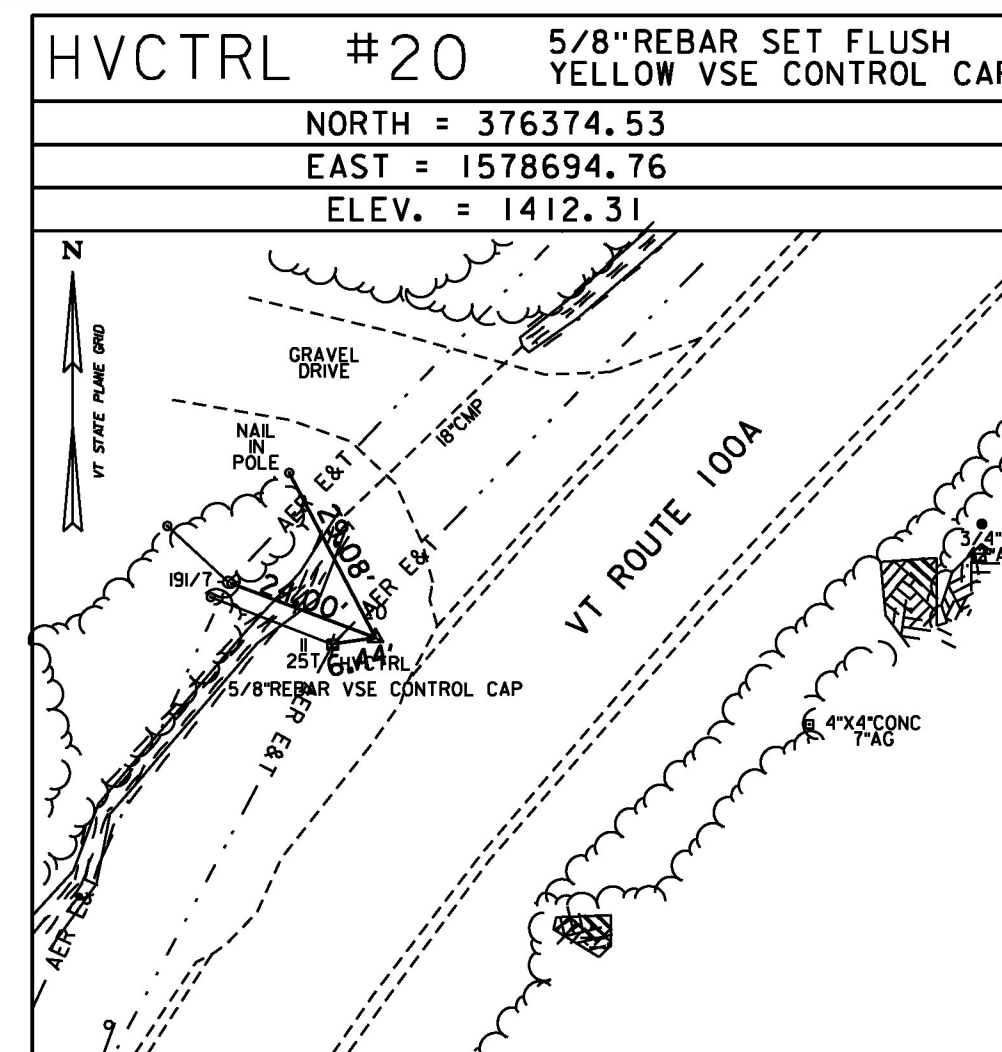
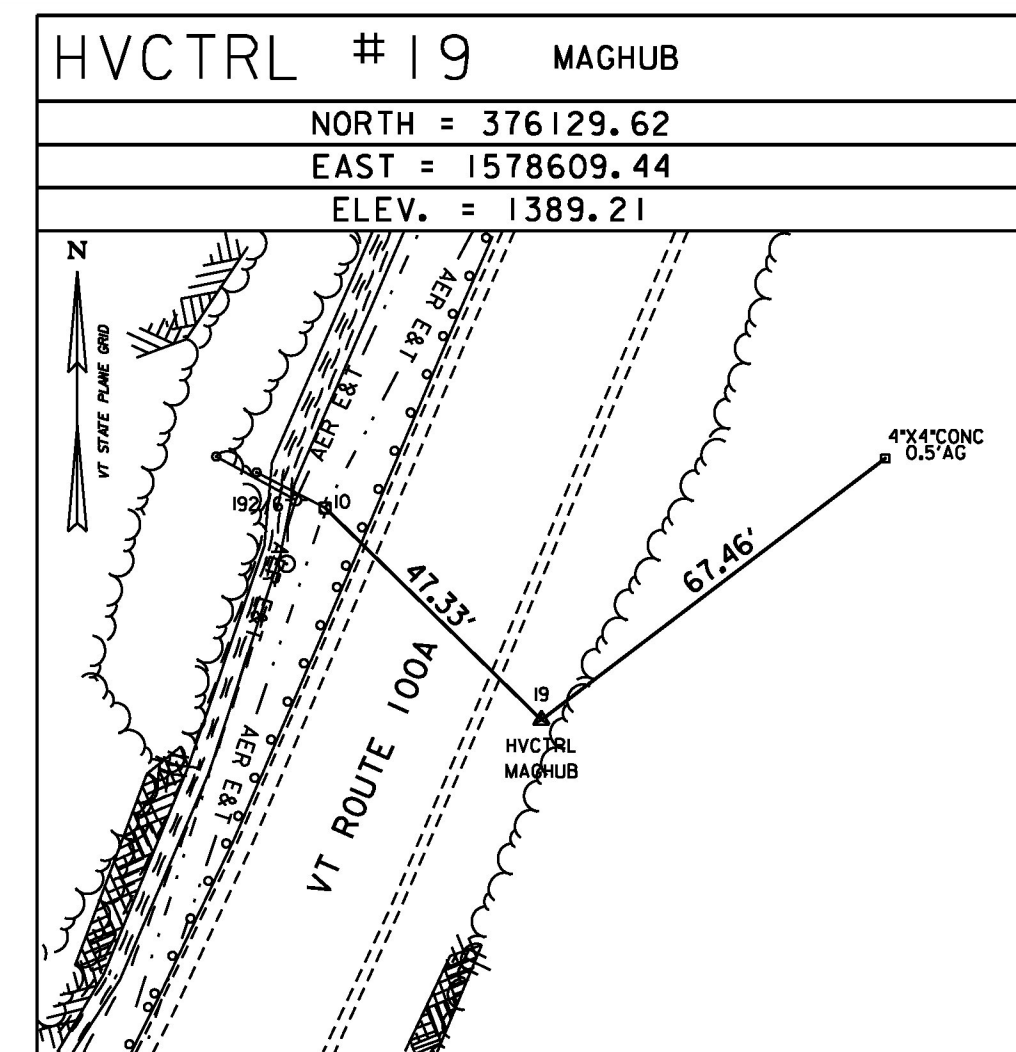
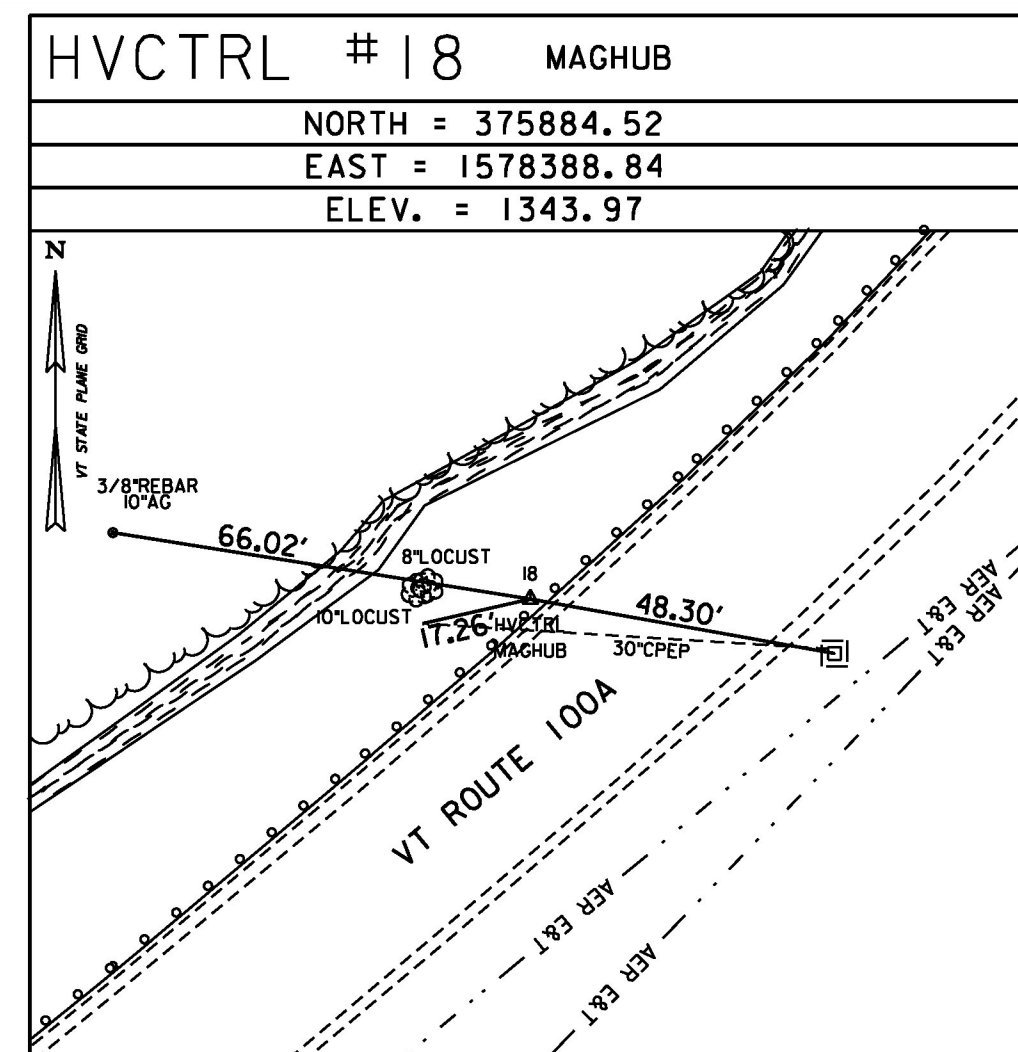

DATUM  
 VERTICAL NAVD 88(GEOD12A) FT  
 HORIZONTAL NAD 83(2011) SFT  
 ADJUSTMENT LSO

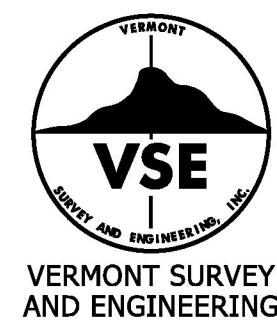

PROJECT NAME: PLYMOUTH	PLOT DATE: 5/17/2016
PROJECT NUMBER: ER 0149(6)	DRAWN BY: M. LOVETT
FILE NAME: z13c318+1.dgn	CHECKED BY: B. COLBURN
PROJECT LEADER: J. SANTACRUCE	SHEET 6 OF 68
DESIGNED BY: M. HASKINS	
TIE SHEET 1	