

MOOSILAUKEE VERY FINE, SANDY LOAM  
 0% - 3% SLOPES  
 LOW EROSION POTENTIAL  
 NO "K" VALUE REPORTED

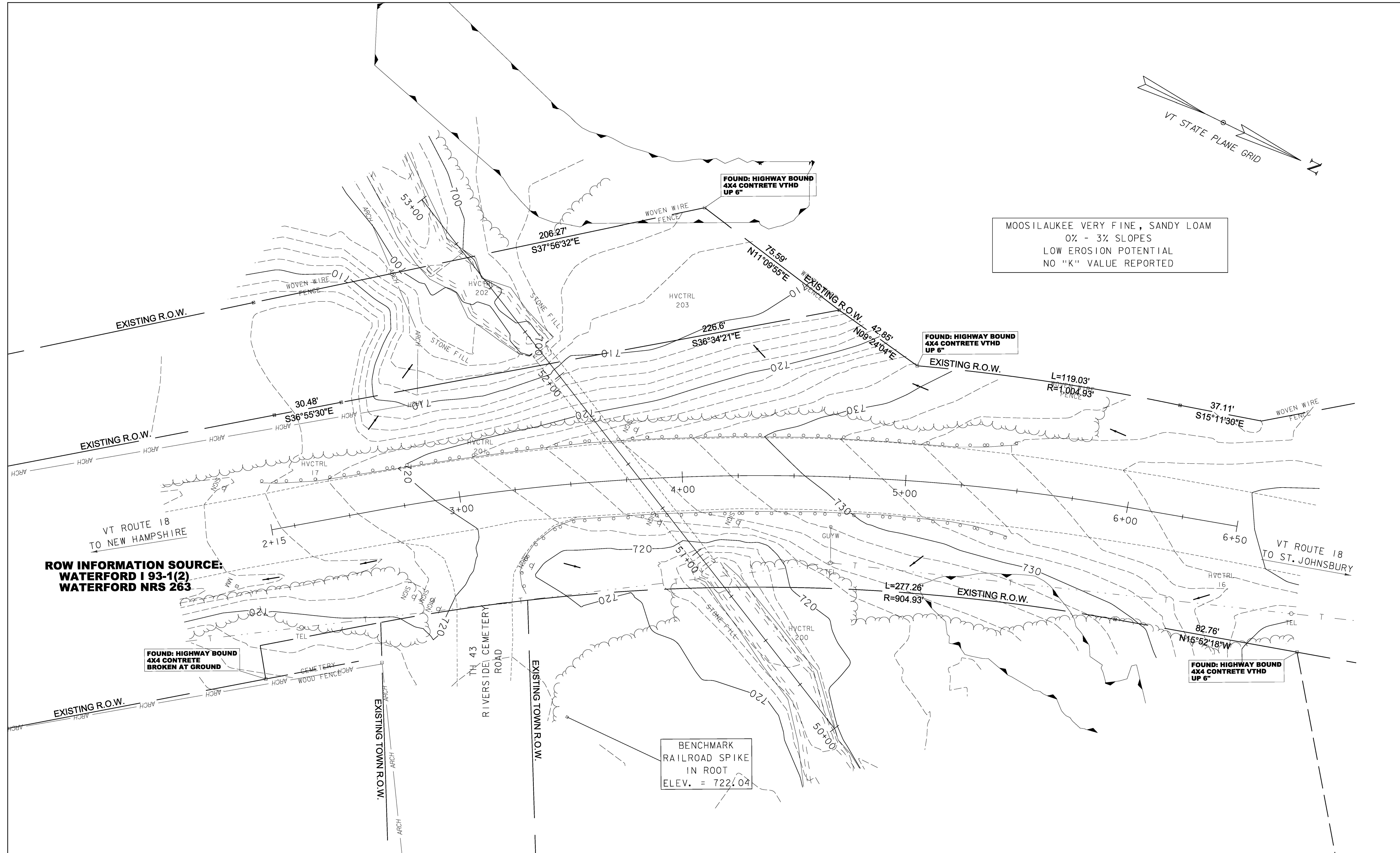

**ROW INFORMATION SOURCE:  
 WATERFORD I 93-1(2)  
 WATERFORD NRS 263**

**FOUND: HIGHWAY BOUND  
 4X4 CONCRETE  
 BROKEN AT GROUND**

**FOUND: HIGHWAY BOUND  
 4X4 CONCRETE VTHD  
 UP 6"**

**FOUND: HIGHWAY BOUND  
 4X4 CONCRETE VTHD  
 UP 6"**

**FOUND: HIGHWAY BOUND  
 4X4 CONCRETE VTHD  
 UP 6"**

BENCHMARK  
 RAILROAD SPIKE  
 IN ROOT  
 ELEV. = 722.04

EXISTING BRIDGE DATA  
 96" CGMPP, 122' LONG  
 50 SQ FT WATERWAY  
 BUILT 1981

SCALE 1" = 20'-0"  
 0 20



PROJECT NAME:	WATERFORD		
PROJECT NUMBER:	BF 0225(5)		
FILE NAME:	z15b051erobdr.dgn	PLOT DATE:	09/27/2017
PROJECT LEADER:	T. LEVINS	DRAWN BY:	B. WILLIAMS
DESIGNED BY:	B. WILLIAMS	CHECKED BY:	T. LEVINS
EXISTING CONDITIONS			SHEET 39 OF 63