

RELOCATE MAILBOX, SINGLE SUPPORT
STA. 209+22, LT

STONE FILL TYPE I & GRUBBING
MATERIAL (6")

STA. 207+44 TO 208+96, LT

STA. 205+25 TO 205+75, LT

DURABLE 4 INCH WHITE LINE (OPTION BID ITEM)
TEMPORARY 4 INCH WHITE LINE, PAINT
(ALL LINES SHALL INCLUDE EDGE LINE BREAKS
AND RADII FOR SIDE ROADS)
STA. 205+00 TO 210+00, SOLID LT & RT

DURABLE 4 INCH YELLOW LINE (OPTION BID ITEM)
TEMPORARY 4 INCH YELLOW LINE, PAINT
(ALL LINES SHALL INCLUDE CENTER LINE BREAKS
FOR SIDE ROADS)
STA. 205+00 TO 210+00, SOLID LT & RT

REMOVING SIGNS
AS SHOWN - 1

STEEL BEAM GUARDRAIL, GALVANIZED

~~STA. 207+33.0 TO 207+58.0, LT~~
~~STA. 209+20.5 TO 209+45.5, LT~~

STEEL BEAM GUARDRAIL,
GALVANIZED W/8 FEET POSTS

STA. 207+58.0 TO 209+20.5, LT

ANCHOR FOR STEEL BEAM RAIL

~~STA. 207+33.0, LT~~
~~STA. 209+45.5, LT~~

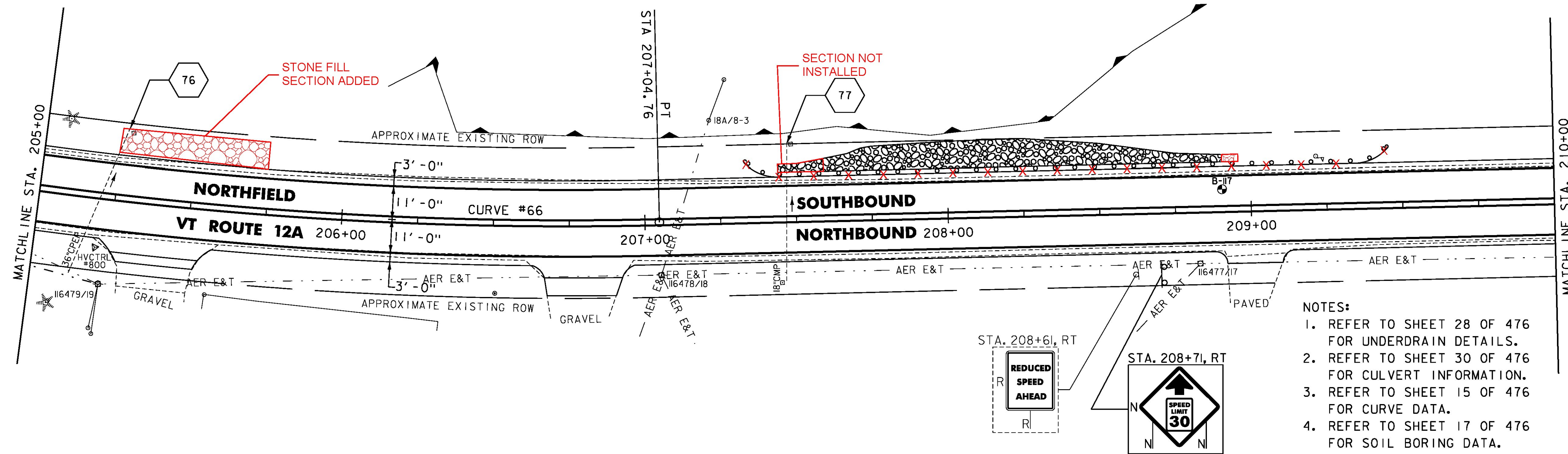
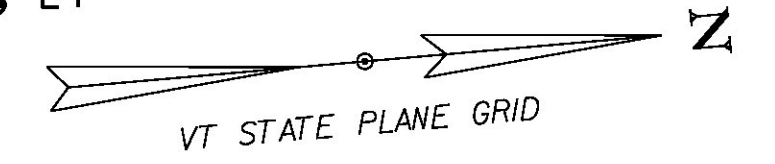

- NOTES:
1. REFER TO SHEET 28 OF 476 FOR UNDERDRAIN DETAILS.
 2. REFER TO SHEET 30 OF 476 FOR CULVERT INFORMATION.
 3. REFER TO SHEET 15 OF 476 FOR CURVE DATA.
 4. REFER TO SHEET 17 OF 476 FOR SOIL BORING DATA.

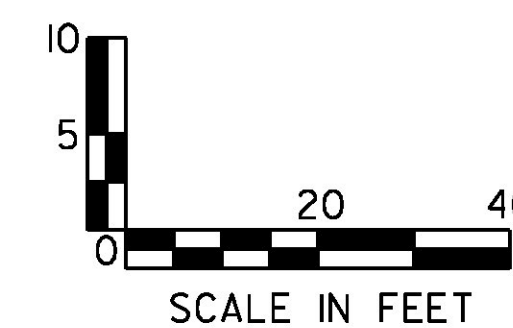
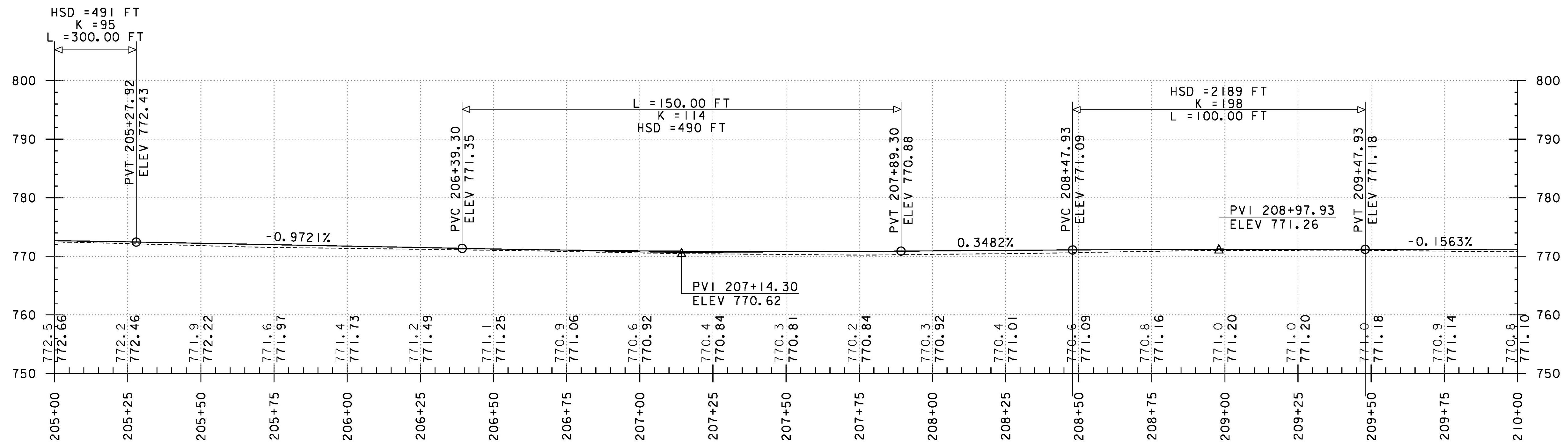

PROJECT NAME:	ROXBURY - NORTHFIELD
PROJECT NUMBER:	ER STP 0187(13)
FILE NAME:	z13cl84bdr.dgn
PROJECT LEADER:	M. FOISY
DESIGNED BY:	G. BURGMEIER
PLAN & PROFILE SHEET 101	
PLOT DATE:	5/25/2016
DRAWN BY:	G. BARRETT
CHECKED BY:	G. EDWARDS
SHEET	151 OF 476