

SOLID ROCK EXCAVATION  
 STA. 200+60 TO 201+20, RT  
 RELOCATE MAILBOX, SINGLE SUPPORT  
 STA. 204+36, LT  
 STA. 204+38, LT

DURABLE 4 INCH WHITE LINE (OPTION BID ITEM)  
 TEMPORARY 4 INCH WHITE LINE, PAINT  
 (ALL LINES SHALL INCLUDE EDGE LINE BREAKS  
 AND RADII FOR SIDE ROADS)  
 STA. 200+00 TO 205+00, SOLID LT & RT

DURABLE 4 INCH YELLOW LINE (OPTION BID ITEM)  
 TEMPORARY 4 INCH YELLOW LINE, PAINT  
 (ALL LINES SHALL INCLUDE CENTER LINE BREAKS  
 FOR SIDE ROADS)  
 STA. 200+00 TO 205+00, SOLID LT & RT

REMOVING SIGNS  
 AS SHOWN - 1

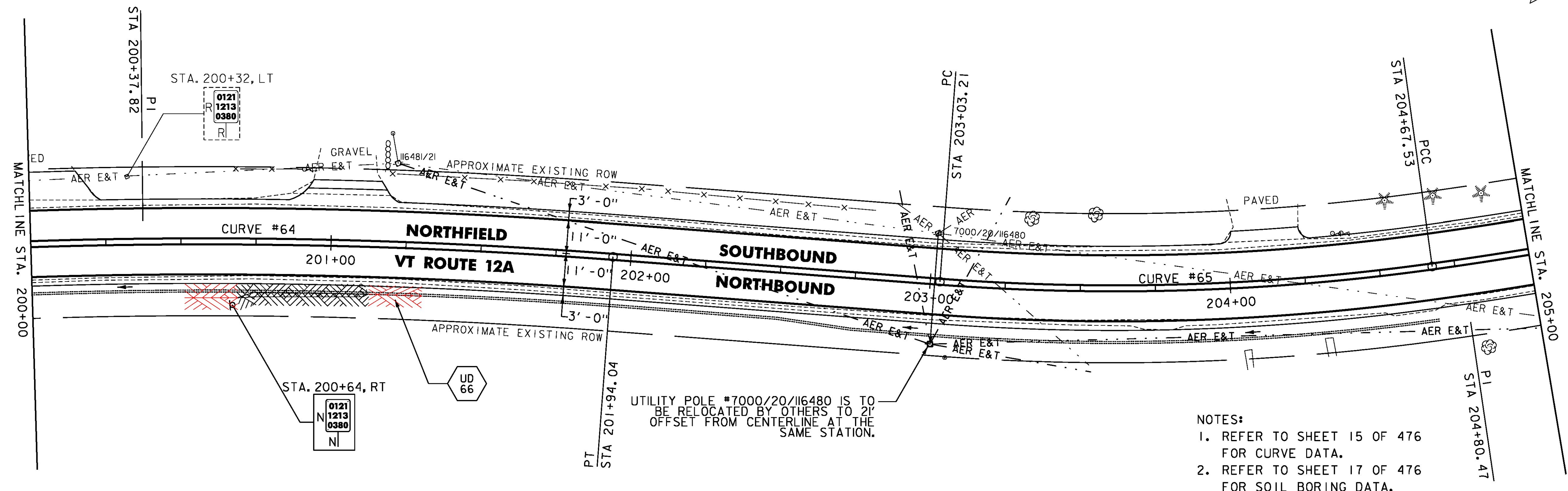
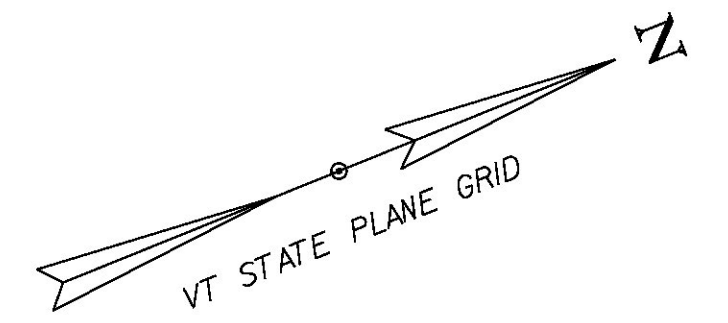

UTILITY POLE #7000/20/116480 IS TO BE RELOCATED BY OTHERS TO 21' OFFSET FROM CENTERLINE AT THE SAME STATION.

- NOTES:
- REFER TO SHEET 15 OF 476 FOR CURVE DATA.
  - REFER TO SHEET 17 OF 476 FOR SOIL BORING DATA.

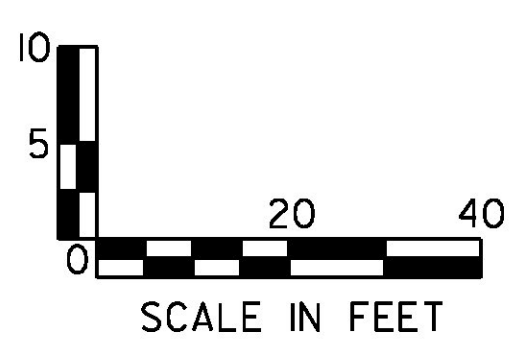
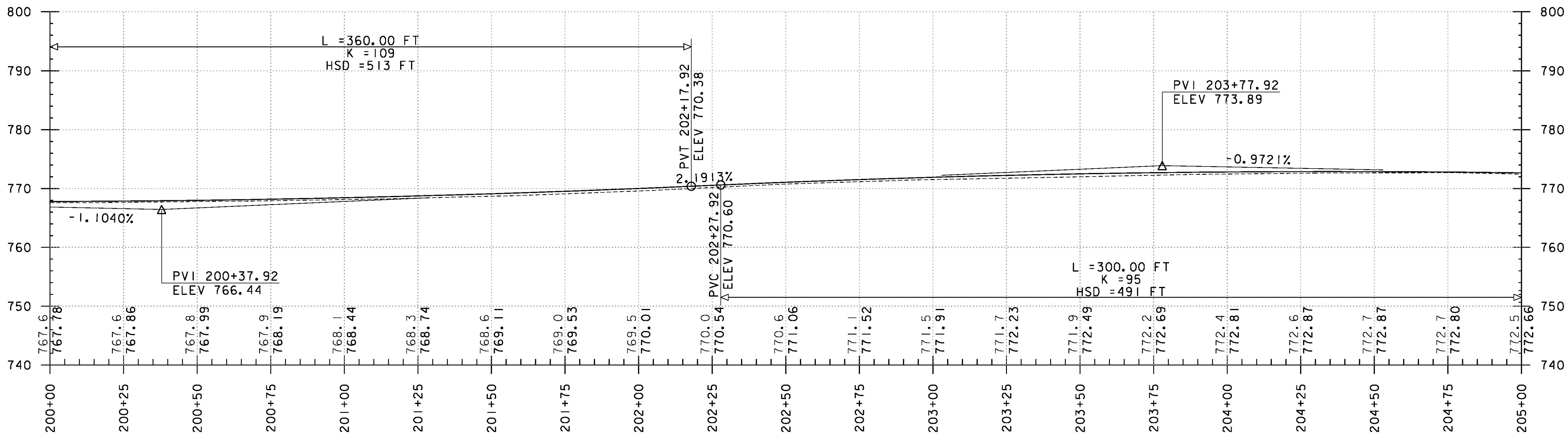

PROJECT NAME:	ROXBURY - NORTHFIELD
PROJECT NUMBER:	ER STP 0187(13)
FILE NAME:	z13cl84bdr.dgn
PROJECT LEADER:	M. FOISY
DESIGNED BY:	G. BURGMEIER
PLANNED & PROFILE SHEET 100	
PLOT DATE:	5/25/2016
DRAWN BY:	G. BARRETT
CHECKED BY:	G. EDWARDS
SHEET	150 OF 476

