

RELOCATE MAILBOX, SINGLE SUPPORT  
STA. 181+52, LT

STONE FILL TYPE I & GRUBBING  
MATERIAL (6")  
STA. 180+32 TO 180+75, LT  
181+99

DURABLE 4 INCH WHITE LINE (OPTION BID ITEM)  
TEMPORARY 4 INCH WHITE LINE, PAINT  
(ALL LINES SHALL INCLUDE EDGE LINE BREAKS  
AND RADII FOR SIDE ROADS)  
STA. 180+00 TO 185+00, SOLID LT & RT

DURABLE 4 INCH YELLOW LINE (OPTION BID ITEM)  
TEMPORARY 4 INCH YELLOW LINE, PAINT  
(ALL LINES SHALL INCLUDE CENTER LINE BREAKS  
FOR SIDE ROADS)  
STA. 180+00 TO 185+00, SOLID LT & RT

STEEL BEAM GUARDRAIL, GALVANIZED  
STA. 182+00.0 TO 182+25.0, LT

STEEL BEAM GUARDRAIL, GALVANIZED  
W/8 FEET POSTS  
STA. 182+25.0 TO 185+00.0, LT

ANCHOR FOR STEEL BEAM RAIL  
STA. 182+00.0, LT

REMOVAL AND DISPOSAL OF GUARDRAIL  
STA. 181+92 TO 184+24, LT

BARRIER FENCE  
STA. 183+70 TO 185+00, RT

EROSION LOG  
STA. 184+50 TO 185+00, RT

NOTES:  
1. REFER TO SHEET 28 OF 476  
FOR UNDERDRAIN DETAILS.  
2. REFER TO SHEET 30 OF 476  
FOR CULVERT INFORMATION.  
3. REFER TO SHEET 15 OF 476  
FOR CURVE DATA.

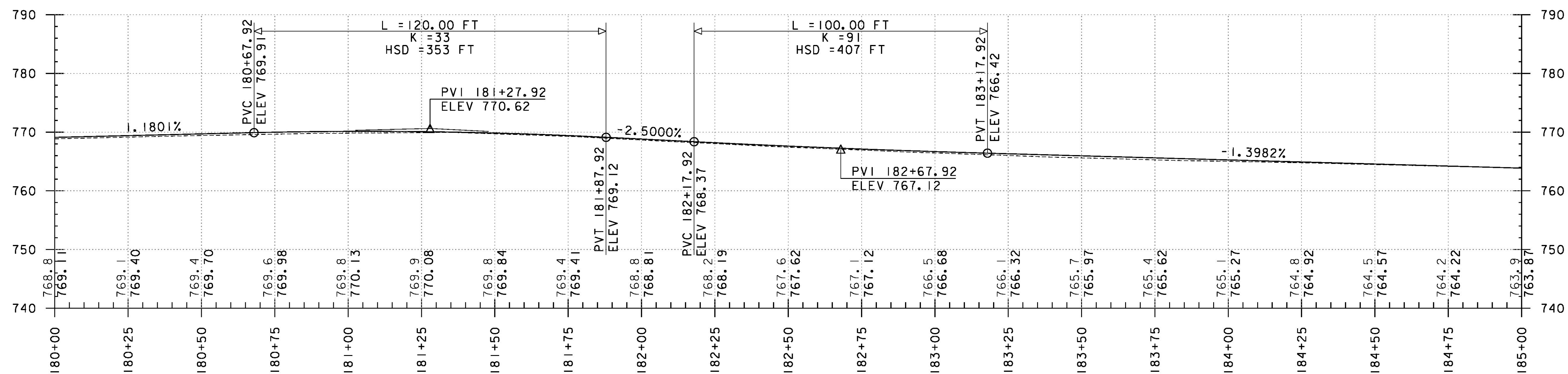
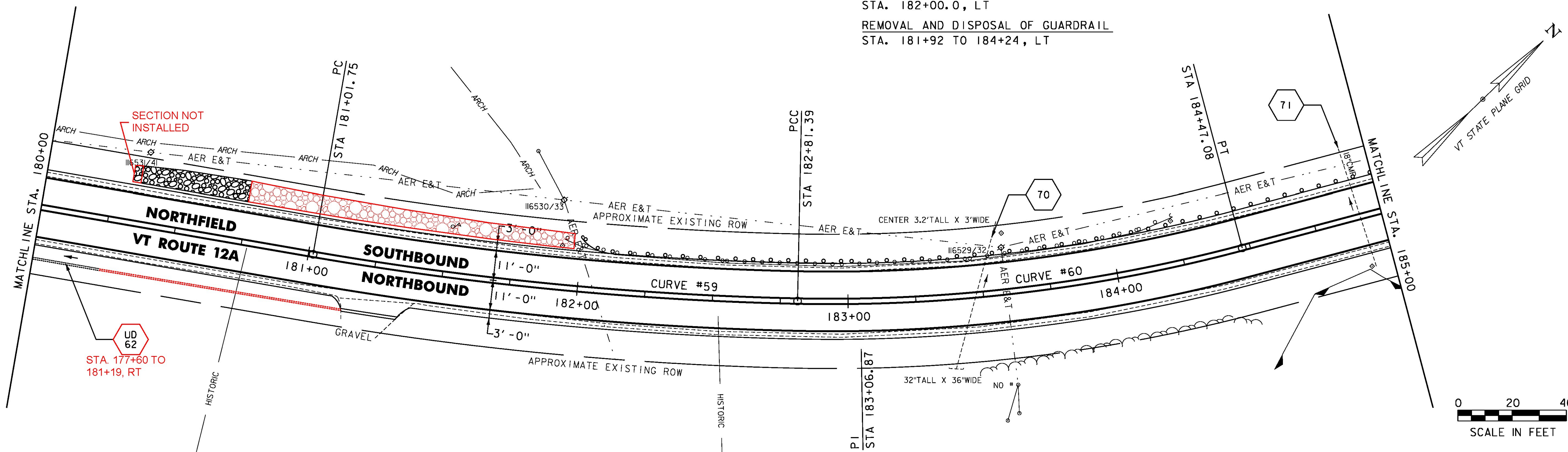

PROJECT NAME: ROXBURY - NORTHFIELD  
PROJECT NUMBER: ER STP 0187(13)

FILE NAME: z13cl84bdr.dgn  
PROJECT LEADER: M. FOISY  
DESIGNED BY: G. BURGMEIER  
PLAN & PROFILE SHEET 96

PLOT DATE: 5/25/2016  
DRAWN BY: G. BARRETT  
CHECKED BY: G. EDWARDS  
SHEET 146 OF 476

