

DURABLE 4 INCH WHITE LINE (OPTION BID ITEM)
 TEMPORARY 4 INCH WHITE LINE, PAINT
 (ALL LINES SHALL INCLUDE EDGE LINE BREAKS
 AND RADII FOR SIDE ROADS)
 STA. 120+00 TO 125+00, SOLID LT & RT

DURABLE 4 INCH YELLOW LINE (OPTION BID ITEM)
 TEMPORARY 4 INCH YELLOW LINE, PAINT
 (ALL LINES SHALL INCLUDE CENTER LINE BREAKS
 FOR SIDE ROADS)
 STA. 120+00 TO 125+00, SOLID LT & RT

REMOVING SIGNS
 AS SHOWN - 5
 MILLED RUMBLE STRIPS
 STA. 120+00 TO 124+00, C

STONE FILL, TYPE I &
 GRUBBING MATERIAL, 6"
 STA. 120+88 TO 122+18, LT

STONE FILL SECTION
 ADDED

THIS UD RUN
 WAS ELIMINATED

THIS SIGN
 WAS MOVED 200 FT
 NORTH TO AVOID
 PLACING SIGN
 IN TREES
 MOVED TO STA. 125+97, RT

- NOTES:
- REFER TO SHEET 28 OF 476 FOR UNDERDRAIN DETAILS.
 - REFER TO SHEET 17 OF 476 FOR SOIL BORING DATA.

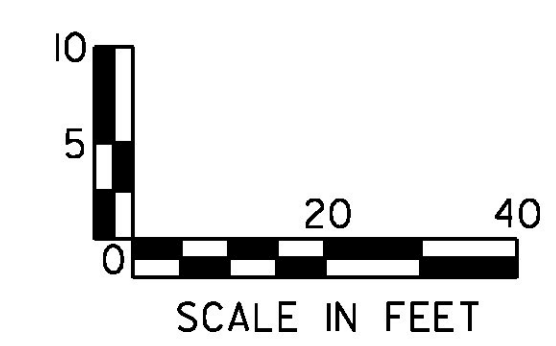
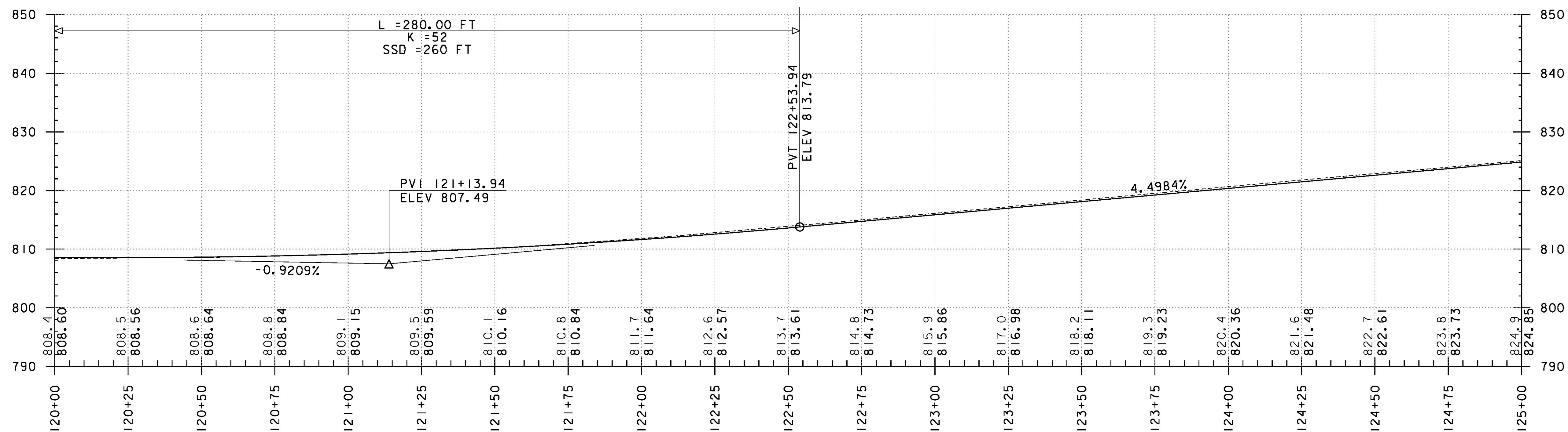
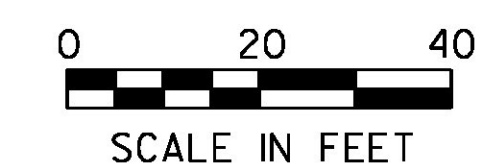
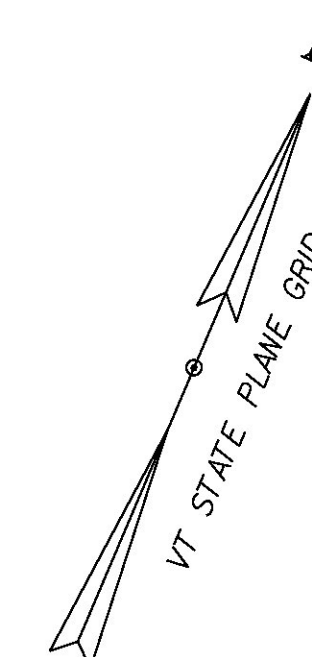
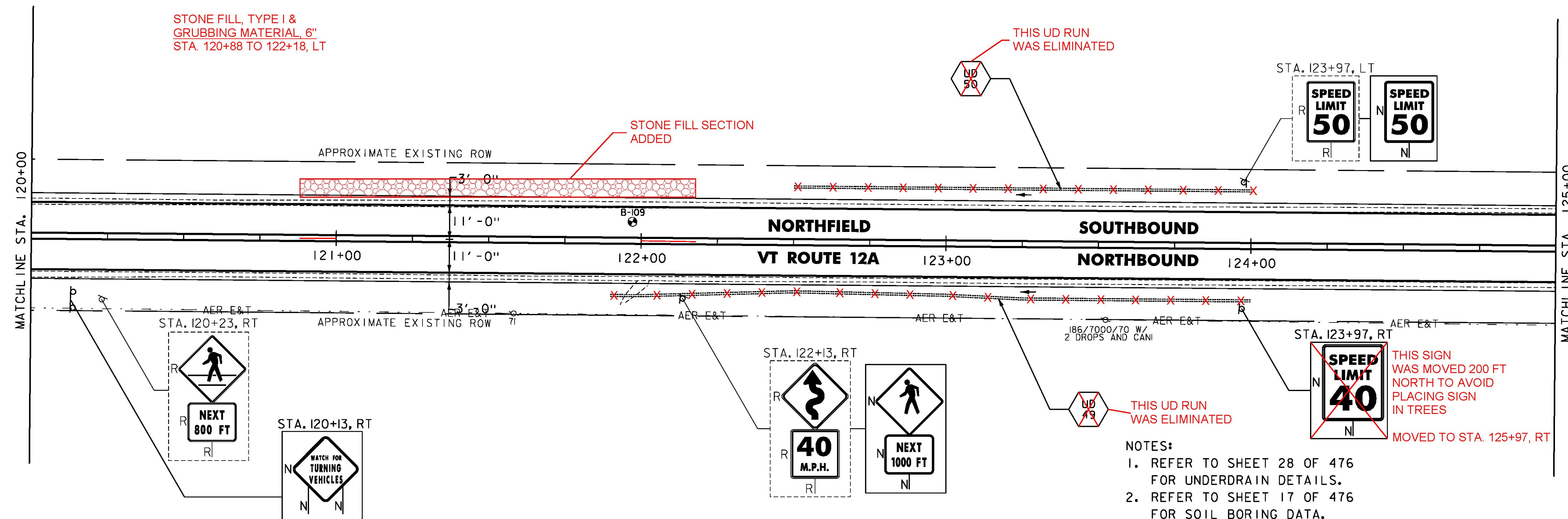

PROJECT NAME: ROXBURY - NORTHFIELD	
PROJECT NUMBER: ER STP 0187(13)	
FILE NAME: z13cl84bdr.dgn	PLOT DATE: 5/25/2016
PROJECT LEADER: M. FOISY	DRAWN BY: G. BARRETT
DESIGNED BY: G. BURGMEIER	CHECKED BY: G. EDWARDS
PLAN & PROFILE SHEET 84	SHEET 134 OF 476