

RELOCATE MAILBOX, SINGLE SUPPORT
STA. 87+80, LT

DURABLE 4 INCH WHITE LINE (OPTION BID ITEM)
TEMPORARY 4 INCH WHITE LINE, PAINT
(ALL LINES SHALL INCLUDE EDGE LINE BREAKS
AND RADII FOR SIDE ROADS)
STA. 85+00 TO 90+00, SOLID LT & RT

DURABLE 4 INCH YELLOW LINE (OPTION BID ITEM)
TEMPORARY 4 INCH YELLOW LINE, PAINT
(ALL LINES SHALL INCLUDE CENTER LINE BREAKS
FOR SIDE ROADS)
STA. 85+00 TO 90+00, SOLID LT & RT

BARRIER FENCE
STA. 89+85 TO 90+00, LT

MILLED RUMBLE STRIPS
STA. 88+50 TO 90+00, C

CLEANING CULV. PIPE, IN-PLACE
(0 TO 24IN., INCL.)
CULVERT #54, 73LF

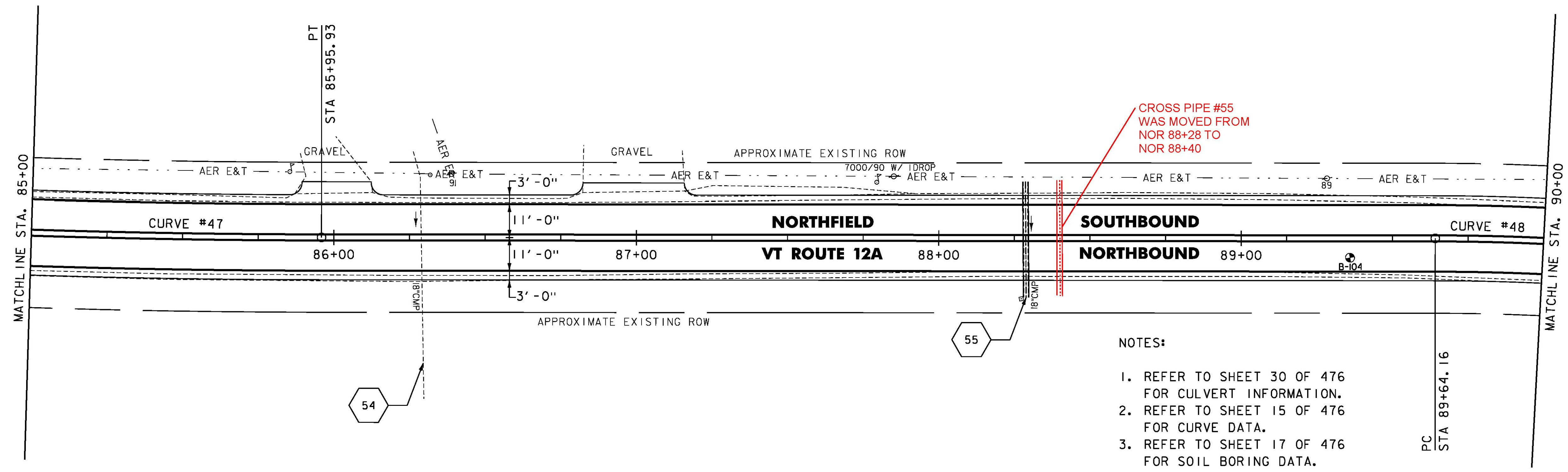

- NOTES:
1. REFER TO SHEET 30 OF 476 FOR CULVERT INFORMATION.
 2. REFER TO SHEET 15 OF 476 FOR CURVE DATA.
 3. REFER TO SHEET 17 OF 476 FOR SOIL BORING DATA.

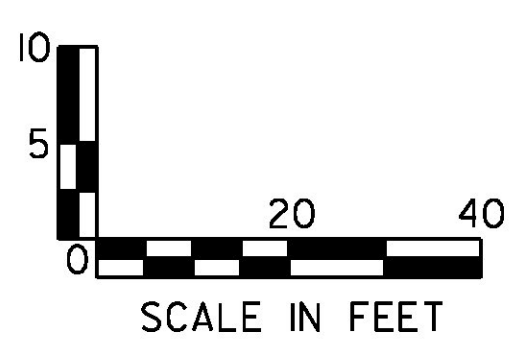
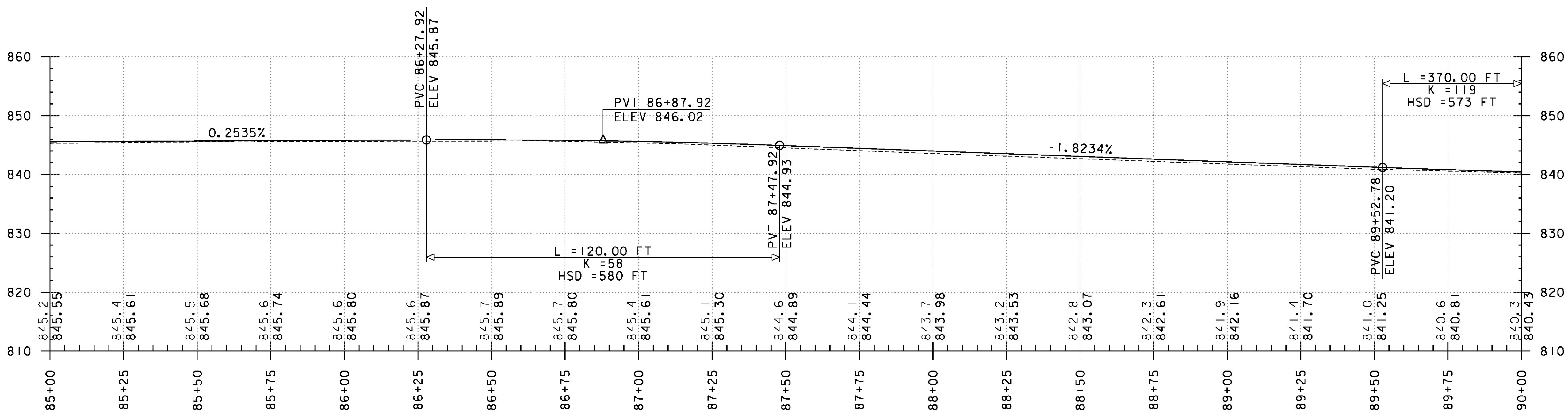
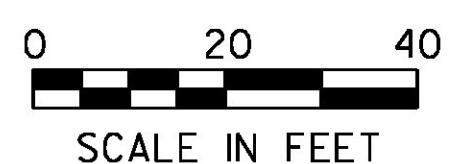

PROJECT NAME:	ROXBURY - NORTHFIELD
PROJECT NUMBER:	ER STP 0187(13)
FILE NAME:	z13ci84bdr.dgn
PROJECT LEADER:	M. FOISY
DESIGNED BY:	G. BURGMEIER
PLANNING & PROFILE SHEET 77	
PLOT DATE:	5/25/2016
DRAWN BY:	G. BARRETT
CHECKED BY:	G. EDWARDS
SHEET	127 OF 476

