

STONE FILL TYPE I & GRUBBING MATERIAL (6")
 STA. 76+21 TO 76+53, LT
~~STA. 77+40 TO 77+90, LT~~
 STA. 79+50 TO 80+00, RT

DURABLE 4 INCH WHITE LINE (OPTION BID ITEM)
 TEMPORARY 4 INCH WHITE LINE, PAINT
 (ALL LINES SHALL INCLUDE EDGE LINE BREAKS AND RADII FOR SIDE ROADS)
 STA. 75+00 TO 80+00, SOLID LT & RT

DURABLE 4 INCH YELLOW LINE (OPTION BID ITEM)
 TEMPORARY 4 INCH YELLOW LINE, PAINT
 (ALL LINES SHALL INCLUDE CENTER LINE BREAKS FOR SIDE ROADS)
 STA. 75+00 TO 80+00, SOLID LT & RT

STEEL BEAM GUARDRAIL, GALVANIZED
 STA. 75+00.0 TO 75+13.9, RT

STEEL BEAM GUARDRAIL, GALVANIZED W/8 FEET POSTS
 STA. 75+13.9 TO 80+00.0, RT

REMOVAL AND DISPOSAL OF GUARDRAIL
 STA. 75+01 TO 80+00, RT

REMOVING SIGNS
 AS SHOWN - 2

ANCHOR FOR STEEL BEAM GUARDRAIL
 STA. 75+02, RT

- NOTES:
- REFER TO SHEET 28 OF 476 FOR UNDERDRAIN DETAILS.
 - REFER TO SHEET 30 OF 476 FOR CULVERT INFORMATION.
 - REFER TO SHEET 15 OF 476 FOR CURVE DATA.
 - REFER TO SHEET 17 OF 476 FOR SOIL BORING DATA.

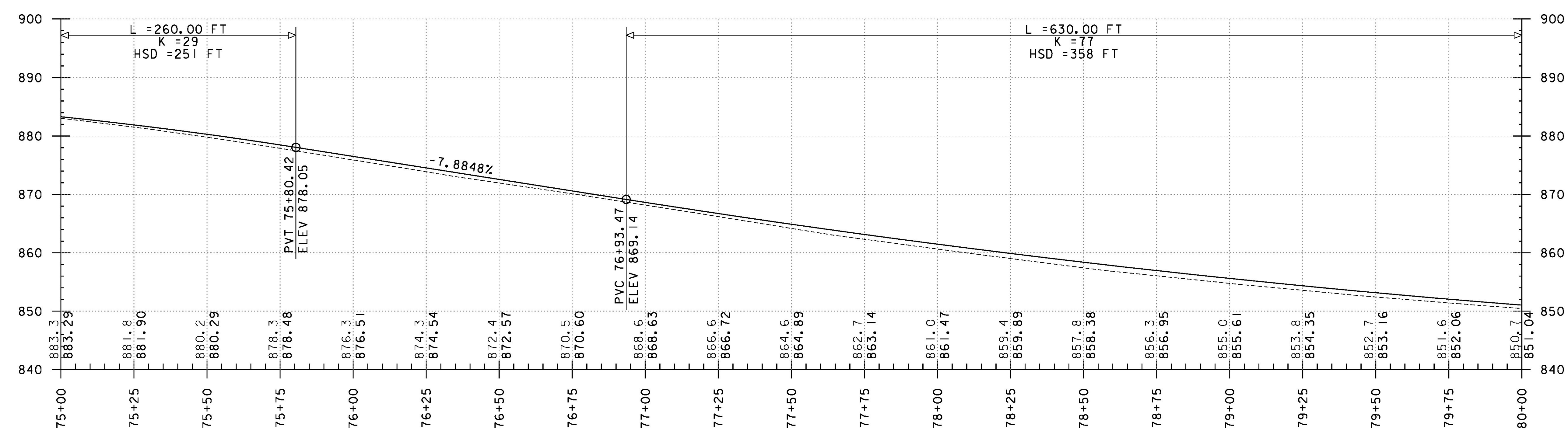
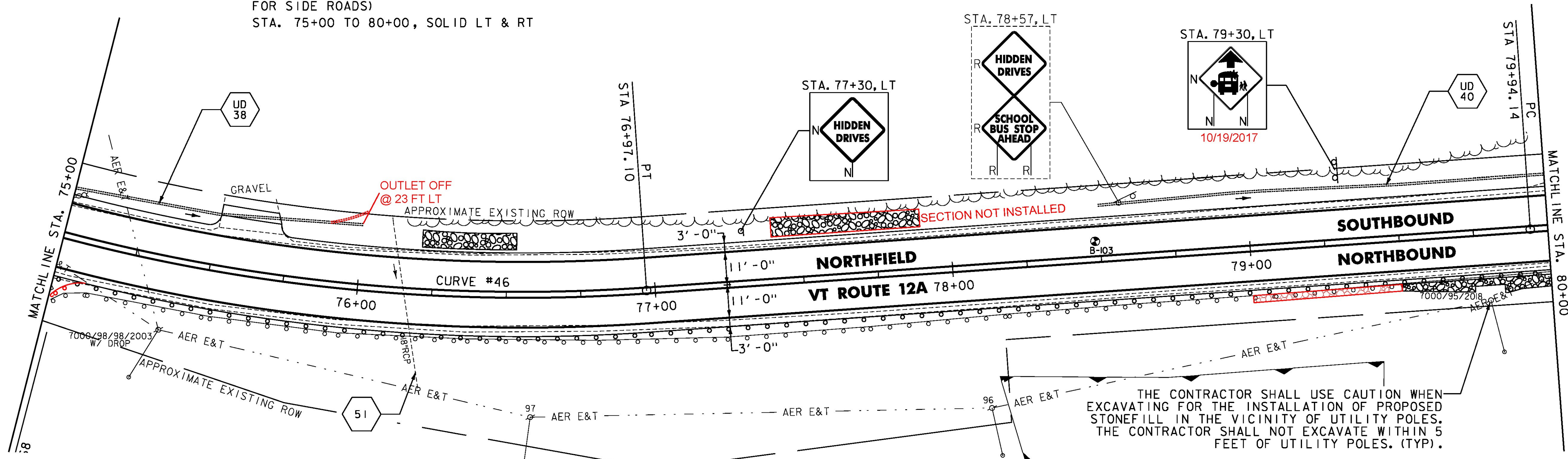

PROJECT NAME:	ROXBURY - NORTHFIELD
PROJECT NUMBER:	ER STP 0187(13)
FILE NAME:	z13cl84bdr.dgn
PROJECT LEADER:	M. FOISY
DESIGNED BY:	G. BURGMEIER
PLAN & PROFILE SHEET 75	
PLOT DATE:	5/25/2016
DRAWN BY:	G. BARRETT
CHECKED BY:	G. EDWARDS
SHEET	125 OF 476

