

SOLID ROCK EXCAVATION
STA. 51+40 TO 52+10, LT

STONE FILL TYPE I & GRUBBING MATERIAL (6")
STA. 50+00 TO 50+55, RT

DURABLE 4 INCH WHITE LINE (OPTION BID ITEM)
TEMPORARY 4 INCH WHITE LINE, PAINT
(ALL LINES SHALL INCLUDE EDGE LINE BREAKS AND RADII FOR SIDE ROADS)
STA. 50+00 TO 55+00, SOLID LT & RT

DURABLE 4 INCH YELLOW LINE (OPTION BID ITEM)
TEMPORARY 4 INCH YELLOW LINE, PAINT
(ALL LINES SHALL INCLUDE CENTER LINE BREAKS FOR SIDE ROADS)
STA. 50+00 TO 55+00, SOLID LT & RT

REMOVING SIGNS AS SHOWN - 1
MILLED RUMBLE STRIPS
STA. 50+00 TO 55+00, ϕ

CLEANING CULV. PIPE, IN-PLACE (0 TO 24IN., INCL.)
CULVERT #46, 69F

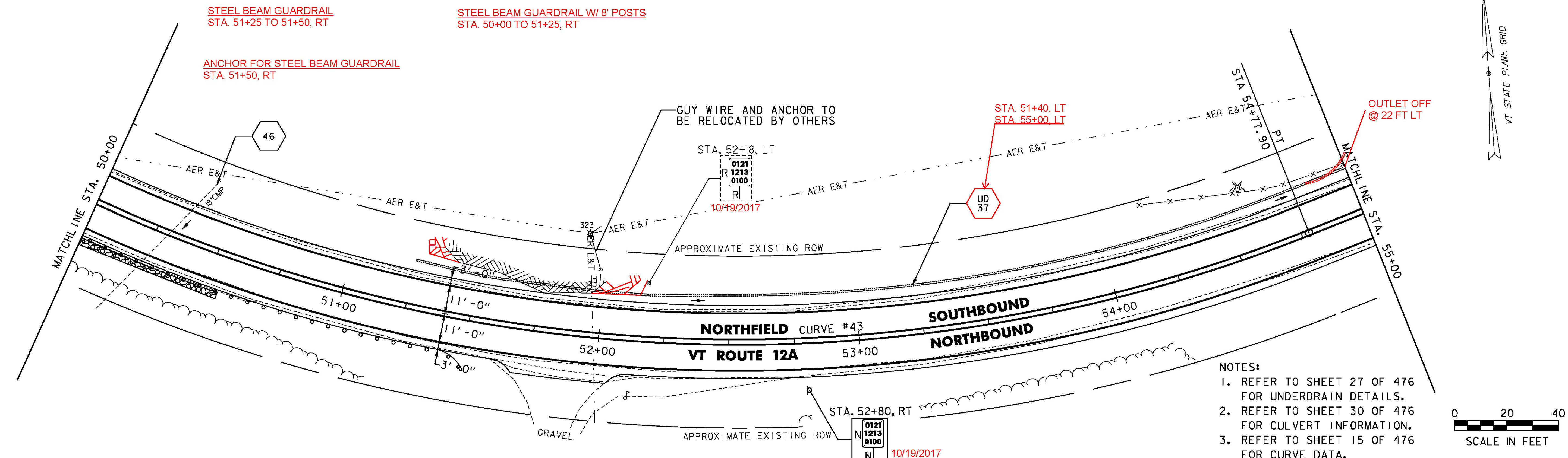

- NOTES:
- REFER TO SHEET 27 OF 476 FOR UNDERDRAIN DETAILS.
 - REFER TO SHEET 30 OF 476 FOR CULVERT INFORMATION.
 - REFER TO SHEET 15 OF 476 FOR CURVE DATA.

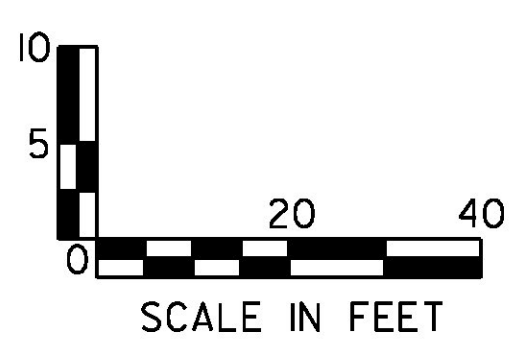
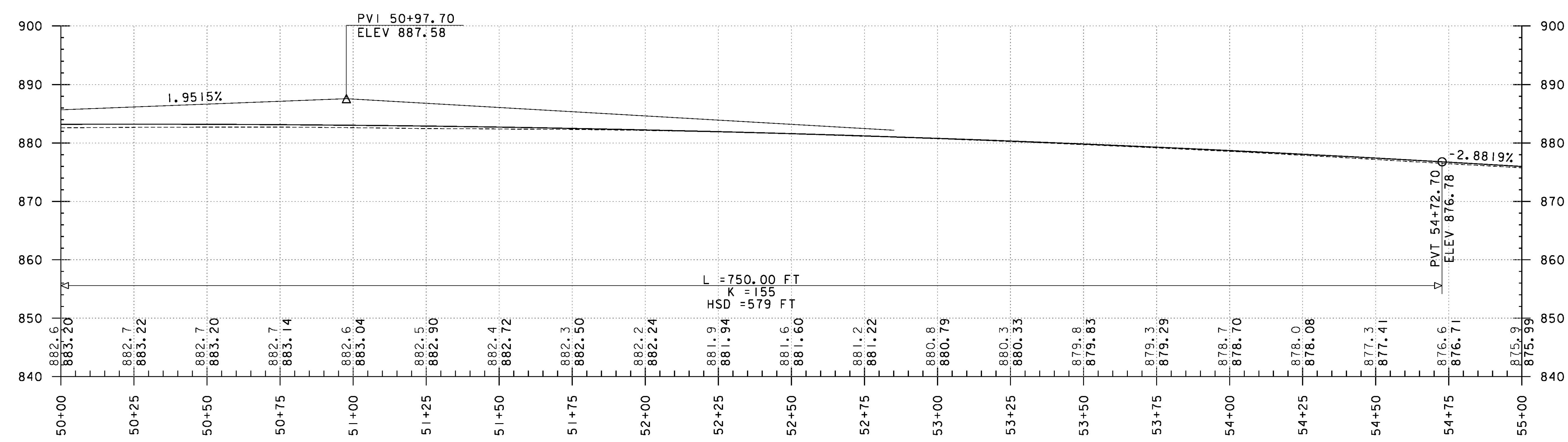
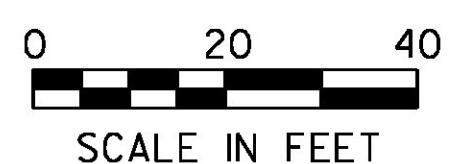

PROJECT NAME:	ROXBURY - NORTHFIELD
PROJECT NUMBER:	ER STP 0187(13)
FILE NAME:	z13cl84bdr.dgn
PROJECT LEADER:	M. FOISY
DESIGNED BY:	G. BURGMEIER
PLAN & PROFILE SHEET 70	
PLOT DATE:	5/25/2016
DRAWN BY:	G. BARRETT
CHECKED BY:	G. EDWARDS
SHEET	120 OF 476