

REHAB DIS, CBS, OR MHS, CLASS 1
 STA. 239+99, LT
 RELOCATE MAILBOX, SINGLE SUPPORT
 STA. 240+23, RT
 STA. 243+69, LT

STEEL BEAM GUARDRAIL, GALVANIZED
 STA. 238+50.0 TO 239+06.0, LT
 STA. 242+14.6 TO 243+14.6, LT
 STA. 243+92.2 TO 244+50.0, LT
 ANCHOR FOR STEEL BEAM RAIL
 STA. 239+06.0, LT
 STA. 242+14.6, LT
 STA. 243+14.6, LT
 STA. 243+92.2, LT

DURABLE 4 INCH WHITE LINE, THERMOPLASTIC
 DURABLE 4 INCH WHITE LINE, POLYUREA
 TEMPORARY 4 INCH WHITE LINE, PAINT
 (ALL LINES WILL INCLUDE EDGE LINE BREAKS
 AND RADII FOR SIDE ROADS)
 STA. 238+50 TO 244+50, SOLID LT & RT

DURABLE 4 INCH YELLOW LINE, THERMOPLASTIC
 DURABLE 4 INCH YELLOW LINE, POLYUREA
 TEMPORARY 4 INCH YELLOW LINE, PAINT
 (ALL LINES WILL INCLUDE Q BREAK
 FOR SIDE ROADS)
 STA. 238+50 TO 244+50, SOLID LT & RT

DURABLE 24 INCH STOP BAR, THERMOPLASTIC
 DURABLE 24 INCH STOP BAR, POLYUREA
 TEMPORARY 24 INCH STOP BAR, PAINT
 STA. 240+13, RT (NORTH RD) (10 LF)
 STA. 240+13, RT (NORTH RD) (10 LF)

GEOTEXTILE FOR SILT FENCE
 STA. 244+00 TO 244+50, LT
 REMOVING SIGNS
 AS SHOWN - 10
 ERECTING SALVAGED SIGNS
 AS SHOWN - 3

PRIOR TO CONSTRUCTION
 ADJACENT TO THIS POLE,
 CONTRACTOR SHALL CONTACT
 BEN BEMIS AT GMP
 (802-234-5740) FOR
 COORDINATION. GMP TO HOLD
 POLE DURING CONSTRUCTION.

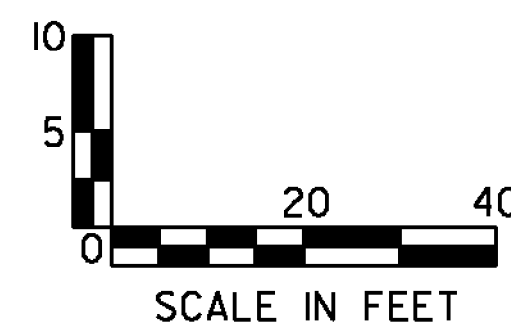
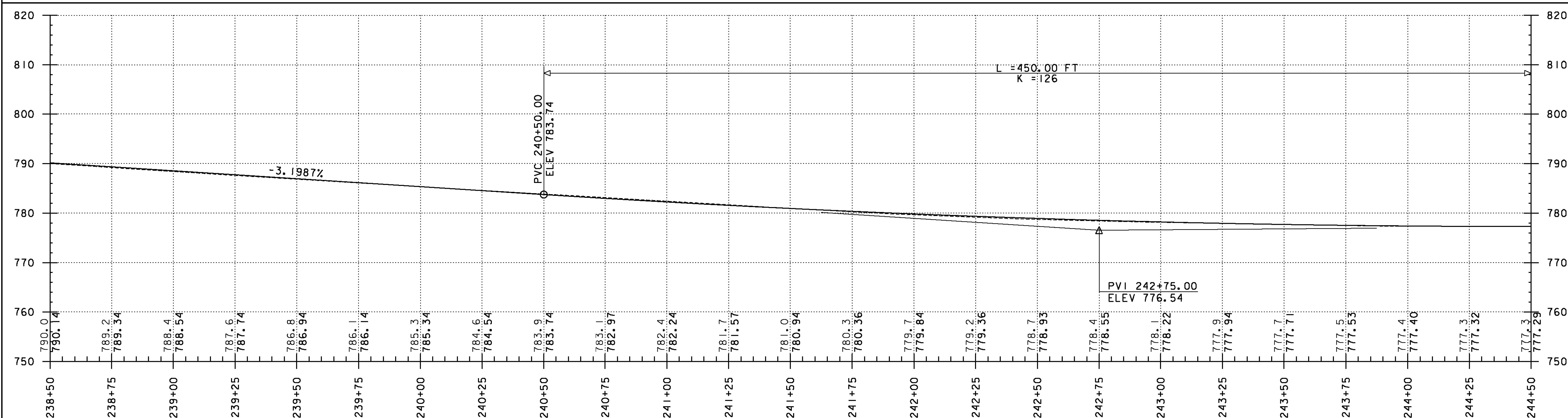
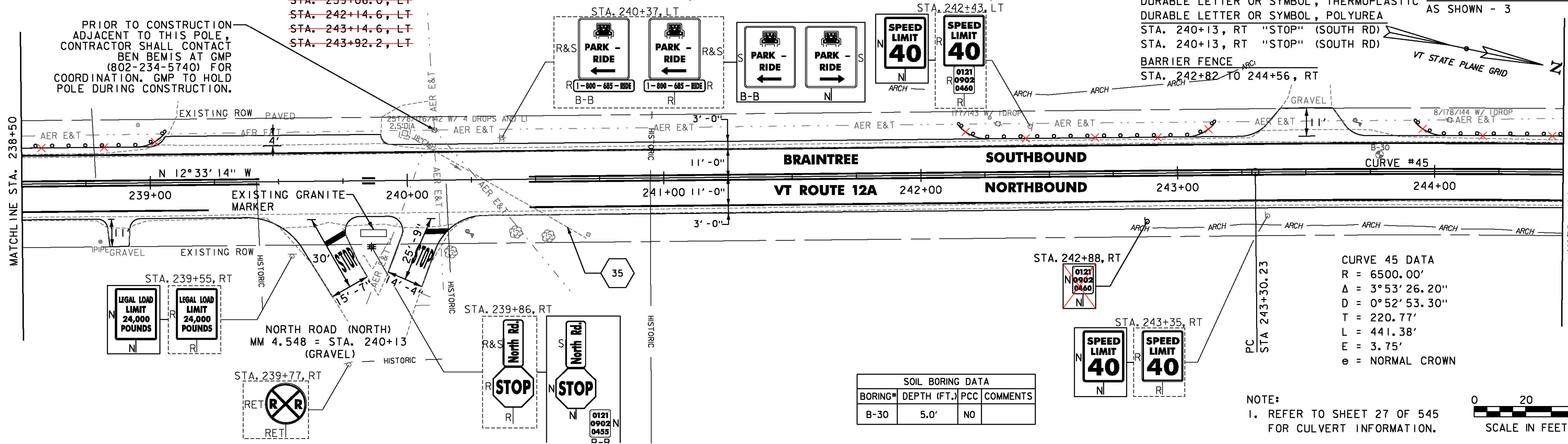

PROJECT NAME: RANDOLPH-ROXBURY
 PROJECT NUMBER: ER STP 0187(III)
 FILE NAME: z13cl82bdr.dgn
 PROJECT LEADER: M. FOISY
 DESIGNED BY: I. MAYNARD
 PLAN & PROFILE SHEET 58
 PLOT DATE: 11/17/2014
 DRAWN BY: G. BURGMEIER
 CHECKED BY: M. FOISY
 SHEET 99 OF 545