

RELOCATE MAILBOX, SINGLE SUPPORT
 STA. 209+08, LT
 ANCHOR FOR STEEL BEAM RAIL
 STA. 209+03.07, LT
 REMOVE AND RESET GUARDRAIL
 STA. 206+15.57 TO 209+03.07, LT
 STA. 206+16.74 TO 210+00, RT

CONNECT RESET GUARDRAIL TO
 EXISTING GUARDRAIL @ STA
 206+15.57, LT

DURABLE 4 INCH YELLOW LINE, THERMOPLASTIC
 DURABLE 4 INCH YELLOW LINE, POLYUREA
 TEMPORARY 4 INCH YELLOW LINE, PAINT
 STA. 206+18.40 TO 210+00, SOLID LT & RT

BARRIER FENCE
 STA. 209+78 TO 210+00, LT
 GEOTEXTILE FOR SILT FENCE
 STA. 206+18 TO 210+00, RT
 REMOVING SIGNS
 AS SHOWN - I

ERECTING SALVAGED SIGNS
 AS SHOWN - I

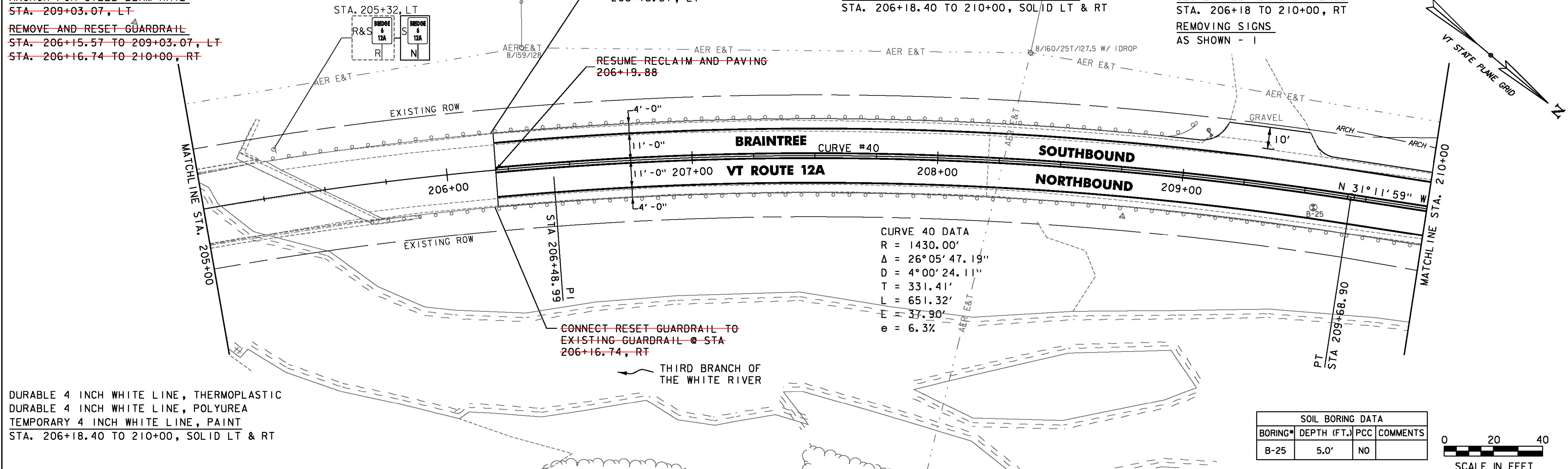

DURABLE 4 INCH WHITE LINE, THERMOPLASTIC
 DURABLE 4 INCH WHITE LINE, POLYUREA
 TEMPORARY 4 INCH WHITE LINE, PAINT
 STA. 206+18.40 TO 210+00, SOLID LT & RT

CURVE 40 DATA
 R = 1430.00'
 Δ = 26° 05' 47.19"
 D = 4° 00' 24.11"
 T = 331.41'
 L = 651.32'
 E = 37.90'
 e = 6.3%

SOIL BORING DATA			
BORING#	DEPTH (FT.)	PCC	COMMENTS
B-25	5.0'	NO	

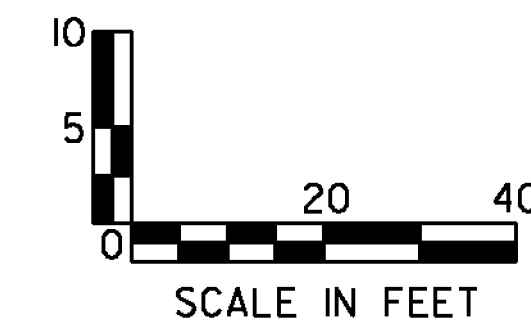
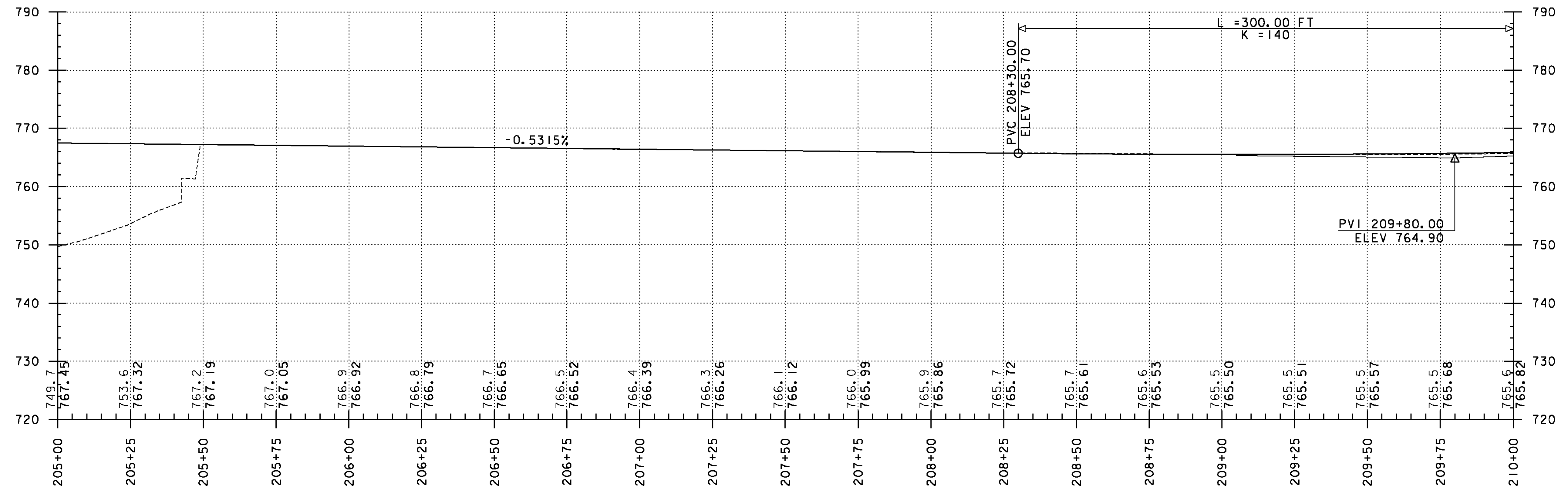
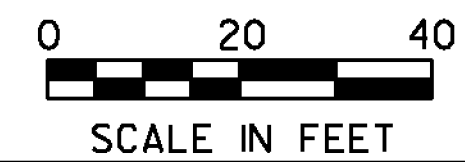

PROJECT NAME: RANDOLPH-ROXBURY
 PROJECT NUMBER: ER STP 0187(II)
 FILE NAME: z13cl82bdr.dgn
 PROJECT LEADER: M. FOISY
 DESIGNED BY: I. MAYNARD
 PLAN & PROFILE SHEET 51
 PLOT DATE: 11/17/2014
 DRAWN BY: G. BURGMEIER
 CHECKED BY: M. FOISY
 SHEET 92 OF 545