

~~STEEL BEAM GUARDRAIL, GALVANIZED~~  
~~STA. 200+93.74 TO 201+18.74, LT~~

~~STEEL BEAM GUARDRAIL, GALVANIZED W/ 8 FEET POSTS~~  
~~STA. 201+18.74 TO 202+68.74, LT~~  
~~(CONNECT TO EXISTING GUARDRAIL)~~

REMOVE AND RESET GUARDRAIL  
 STA. 202+68.74 TO 203+93.74, LT  
~~STA. 200+93 TO 201+18, LT~~  
 REMOVAL AND DISPOSAL OF GUARDRAIL  
 STA. 200+90 TO 202+68.7, LT  
 STA. 201+75.0 TO 203+14.0, RT

DURABLE 4 INCH WHITE LINE, THERMOPLASTIC  
 DURABLE 4 INCH WHITE LINE, POLYUREA  
 TEMPORARY 4 INCH WHITE LINE, PAINT  
 STA. 200+00 TO 203+01.60, SOLID LT & RT

DURABLE 4 INCH YELLOW LINE, THERMOPLASTIC  
 DURABLE 4 INCH YELLOW LINE, POLYUREA  
 TEMPORARY 4 INCH YELLOW LINE, PAINT  
 STA. 200+00 TO 201+16, DASHED LT, SOLID RT  
 STA. 201+16 TO 203+01.60, SOLID LT & RT

REMOVING SIGNS  
 AS SHOWN - 1  
 ERECTING SALVAGED SIGNS  
 AS SHOWN - 1

ANCHOR FOR STEEL BEAM RAIL  
 STA. 200+93.7, LT

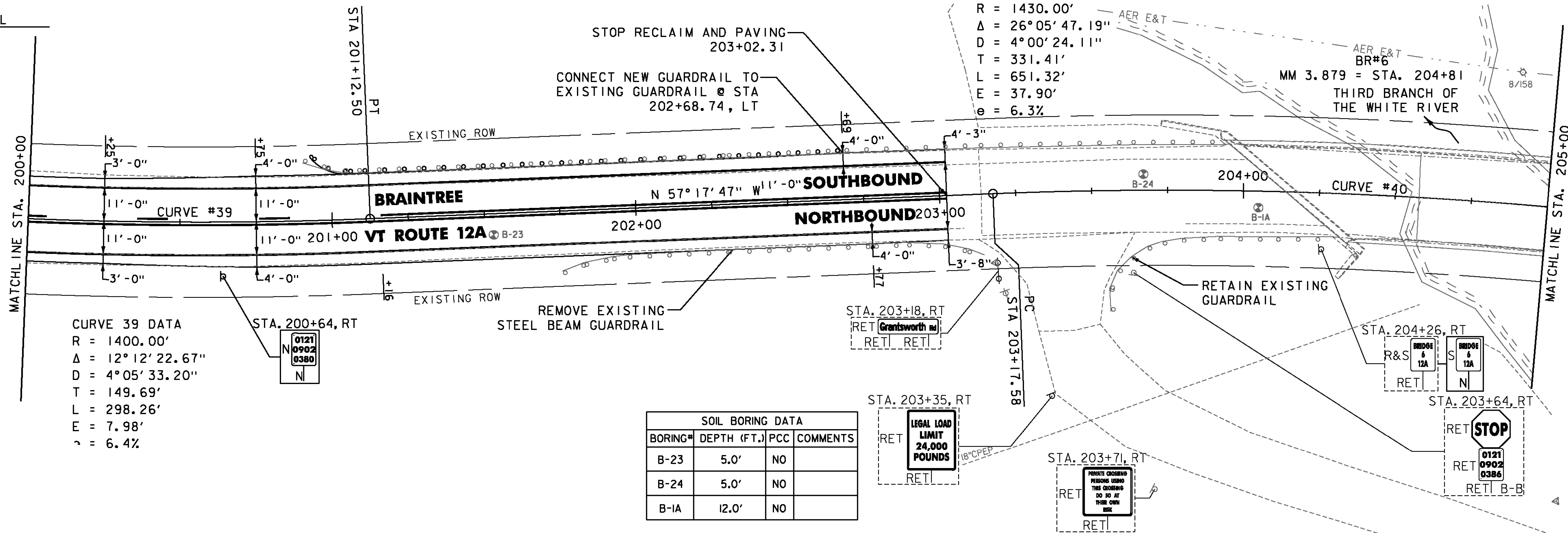

CURVE 39 DATA  
 R = 1400.00'  
 $\Delta = 12^\circ 12' 22.67''$   
 D =  $4^\circ 05' 33.20''$   
 T = 149.69'  
 L = 298.26'  
 E = 7.98'  
 $e = 6.4\%$

STA. 200+64, RT

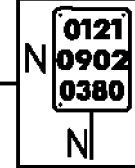

SOIL BORING DATA			
BORING#	DEPTH (FT.)	PCC	COMMENTS
B-23	5.0'	NO	
B-24	5.0'	NO	
B-1A	12.0'	NO	

STA. 203+35, RT

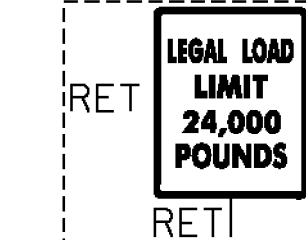

STA. 203+71, RT

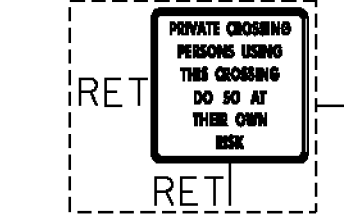

STA. 203+64, RT

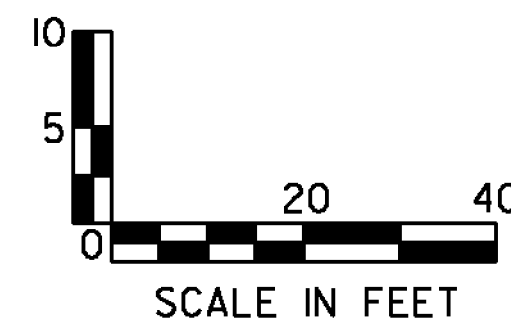
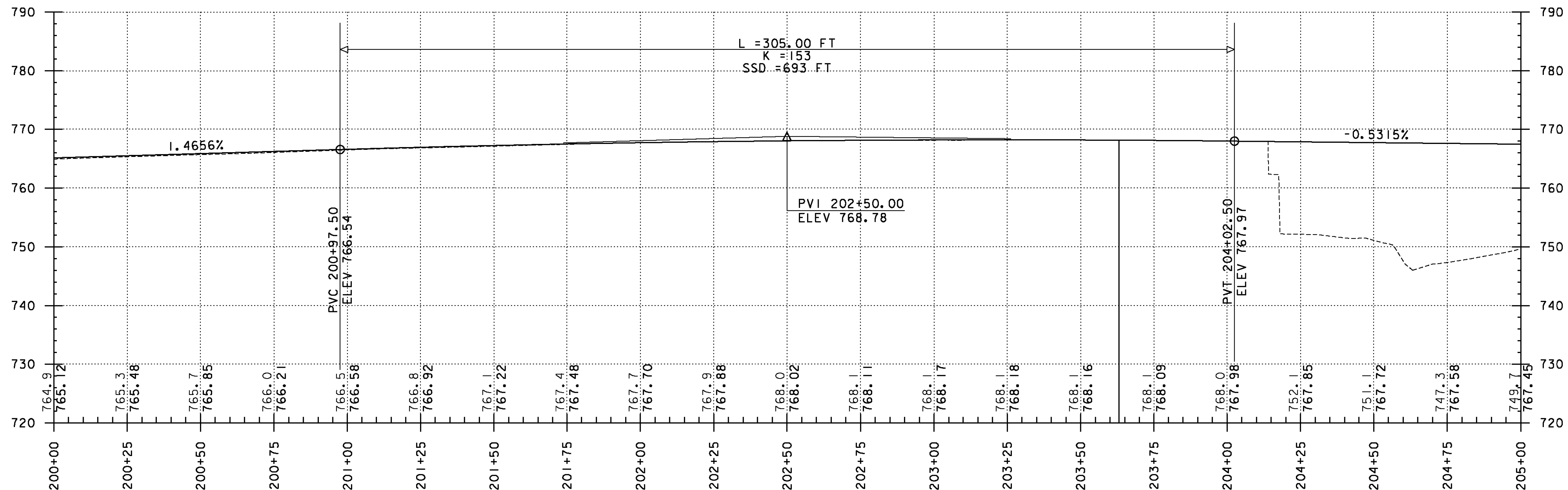
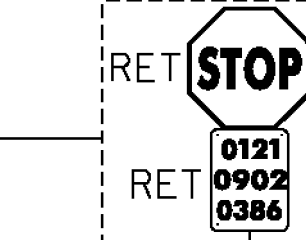

PROJECT NAME: RANDOLPH-ROXBURY  
 PROJECT NUMBER: ER STP 0187(II)  
 FILE NAME: z13cl82bdr.dgn  
 PROJECT LEADER: M. FOISY  
 DESIGNED BY: I. MAYNARD  
 PLAN & PROFILE SHEET 50  
 PLOT DATE: 11/17/2014  
 DRAWN BY: G. BURGMEIER  
 CHECKED BY: M. FOISY  
 SHEET 91 OF 545

