

UNDERDRAIN FLUSHING BASIN
 STA. 145+25, RT STA. 145+22, RT
 STONE FILL TYPE I, GEOTEXTILE UNDER STONE FILL
 & GRUBBING MATERIAL
 STA. 147+93 TO 149+15, LT STA. 148+50 TO 148+00, LT
 STA. 149+40 TO 149+69, LT STA. 149+40 TO 150+20, LT

STEEL BEAM GUARDRAIL, GALVANIZED
 STA. 145+15.4 TO 145+40.4, RT
 STA. 146+62.9 TO 146+75.4, LT
 STA. 147+52.9 TO 148+40.4, RT
 STA. 149+00.4 TO 149+25.4, LT
 STA. 145+77.9 TO 146+77.9, RT
 STA. 147+52.9 TO 148+04.9, RT

STEEL BEAM GUARDRAIL, GALVANIZED W/ 8 FEET POSTS
 STA. 145+40.4 TO 146+77.9, RT
 STA. 147+50.4 TO 149+00.4, LT
 STA. 147+50.4 TO 148+89.4, LT
 SEE SHEETS 12 & 13
 FOR BR#5 GUARDRAIL
 DETAILS

HD STEEL BEAM GUARDRAIL, GALVANIZED W/ 8 FEET POSTS
 STA. 146+75.4 TO 147+00.4, LT
 STA. 147+25.4 TO 147+50.4, LT
 STA. 146+77.9 TO 147+02.9, RT
 STA. 147+27.9 TO 147+52.9, RT

CURVE 33 DATA
 R = 4400.00'
 $\Delta = 11^\circ 19' 53.92''$
 $D = 1^\circ 18' 07.84''$
 T = 436.53'
 L = 870.21'
 E = 21.60'
 e = 2.0%

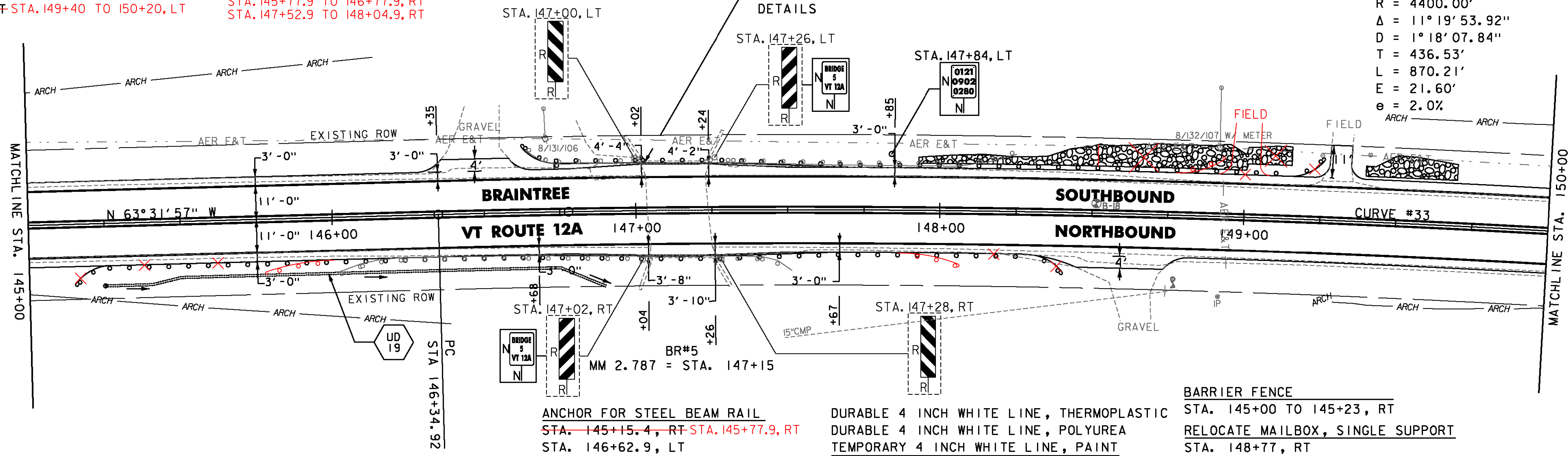
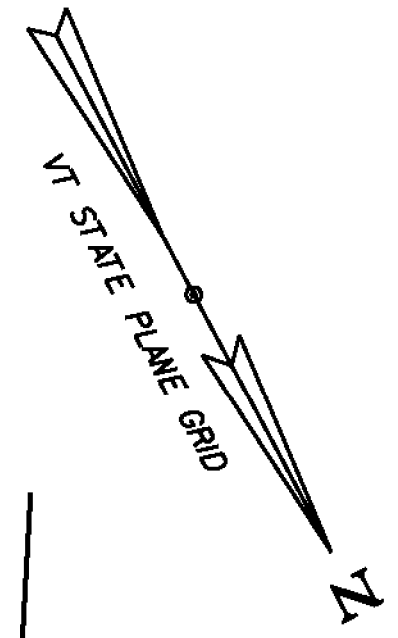

SOIL BORING DATA			
BORING#	DEPTH (FT.)	PCC	COMMENTS
B-18	5.0'	NO	

UD 19
 STA. 145+22, RT TO 146+89, RT
 CONSTRUCT 6 INCH UNDERDRAIN PIPE,
 SEE SHEET 8 FOR DETAIL AND
 ASSOCIATED QUANTITIES.

ANCHOR FOR STEEL BEAM RAIL
 STA. 145+15.4, RT STA. 145+77.9, RT
 STA. 146+62.9, LT
 STA. 148+40.4, RT STA. 148+04.9, RT
 STA. 149+25.4, LT STA. 148+89.4, LT
 REMOVAL AND DISPOSAL OF GUARDRAIL
 STA. 146+64 TO 148+25, LT
 STA. 146+02 TO 147+51, RT

DURABLE 4 INCH WHITE LINE, THERMOPLASTIC
 DURABLE 4 INCH WHITE LINE, POLYUREA
 TEMPORARY 4 INCH WHITE LINE, PAINT
 STA. 145+00 TO 150+00, SOLID LT & RT
 DURABLE 4 INCH YELLOW LINE, THERMOPLASTIC
 DURABLE 4 INCH YELLOW LINE, POLYUREA
 TEMPORARY 4 INCH YELLOW LINE, PAINT
 STA. 145+00 TO 150+00, SOLID LT & RT

BARRIER FENCE
 STA. 145+00 TO 145+23, RT
 RELOCATE MAILBOX, SINGLE SUPPORT
 STA. 148+77, RT
 GEOTEXTILE FOR SILT FENCE
 STA. 148+50 TO 149+25, LT
 STA. 149+40 TO 149+75, LT
 REMOVING SIGNS
 AS SHOWN - 4

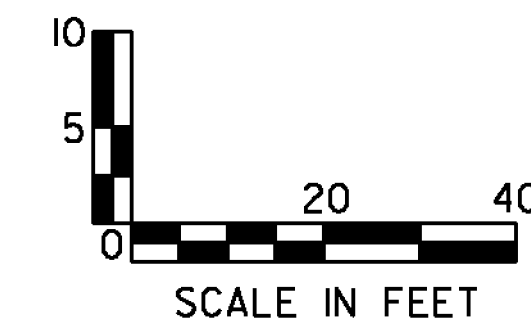
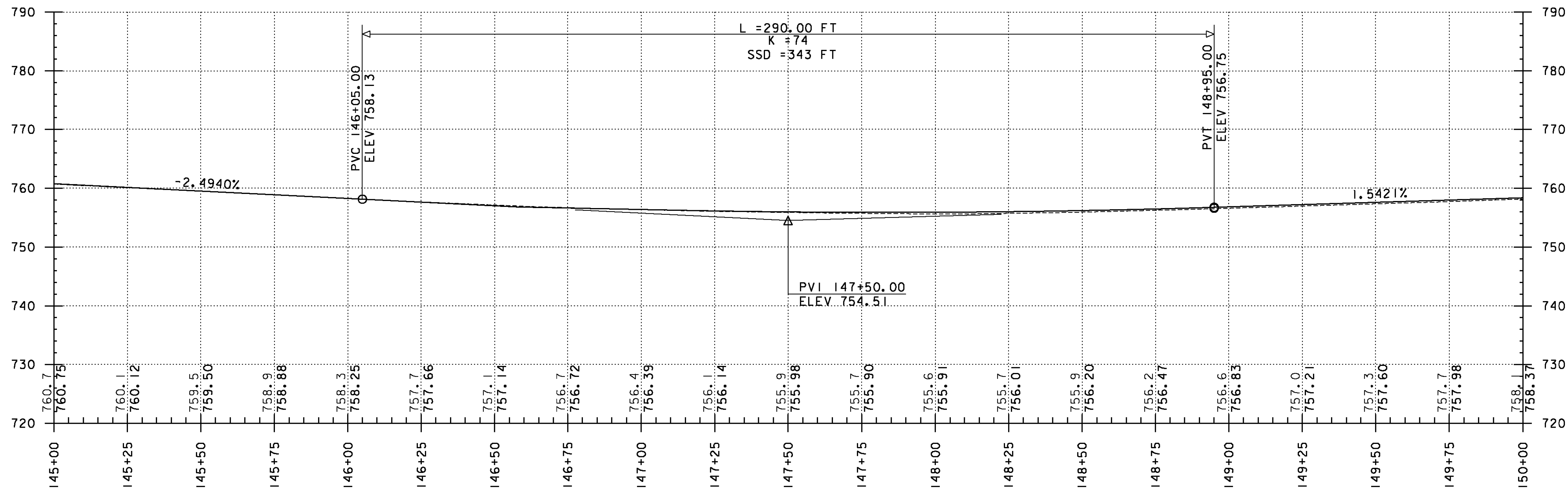
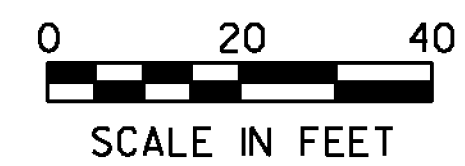

PROJECT NAME: RANDOLPH-ROXBURY
 PROJECT NUMBER: ER STP 0187(III)
 FILE NAME: z13cl82bdr.dgn
 PROJECT LEADER: M. FOISY
 DESIGNED BY: I. MAYNARD
 PLAN & PROFILE SHEET 39
 PLOT DATE: 11/17/2014
 DRAWN BY: G. BURGMEIER
 CHECKED BY: M. FOISY
 SHEET 80 OF 545