

UNDERDRAIN FLUSHING BASIN

STA. 108+43, RT

STEEL BEAM GUARDRAIL, GALVANIZED

STA. 106+55.0 TO 106+80.0, LT

STEEL BEAM GUARDRAIL, GALVANIZED W/ 8 FEET POSTS

STA. 106+80.0 TO 110+00.0, LT

ANCHOR FOR STEEL BEAM RAIL

STA. 106+55.0, LT

REMOVAL AND DISPOSAL OF GUARDRAIL

STA. 107+48 TO 110+00, LT

DURABLE 4 INCH WHITE LINE, THERMOPLASTIC

DURABLE 4 INCH WHITE LINE, POLYUREA

TEMPORARY 4 INCH WHITE LINE, PAINT

STA. 105+00 TO 110+00, SOLID LT & RT

DURABLE 4 INCH YELLOW LINE, THERMOPLASTIC

DURABLE 4 INCH YELLOW LINE, POLYUREA

TEMPORARY 4 INCH YELLOW LINE, PAINT

STA. 105+00 TO 110+00, SOLID LT & RT

BARRIER FENCE

STA. 105+00 TO 106+75, LT

GEOTEXTILE FOR SILT FENCE

STA. 106+00 TO 106+50, RT

EROSION LOG

STA. 109+00 TO 110+00, RT

REMOVING SIGNS

AS SHOWN - 1

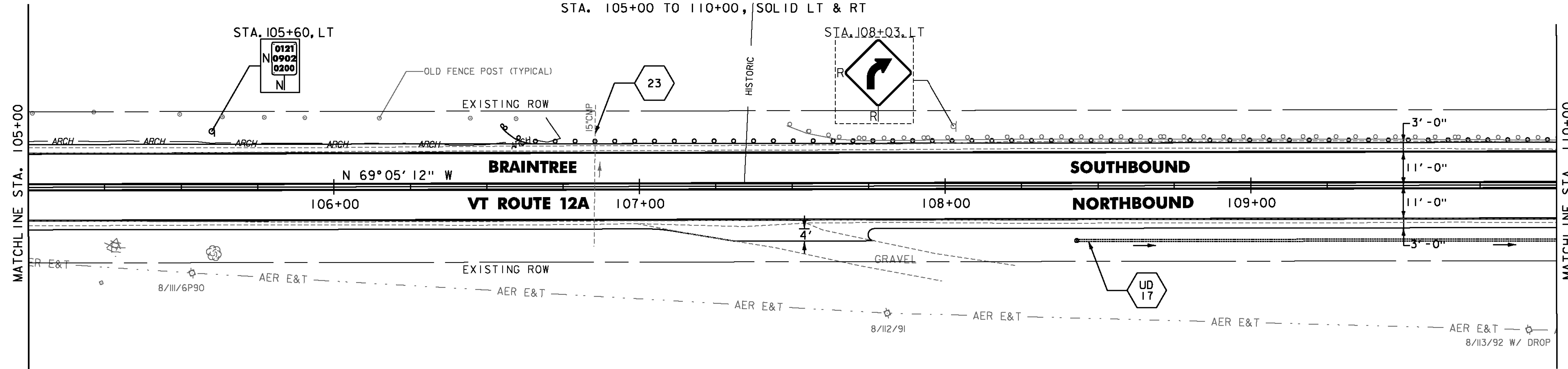

UD 17 STA 108+43, RT TO 110+93, RT
 CONSTRUCT 6 INCH UNDERDRAIN PIPE,
 SEE SHEET 8 FOR DETAIL AND
 ASSOCIATED QUANTITIES.

NOTE:
 1. REFER TO SHEET 27 OF 545
 FOR CULVERT INFORMATION.

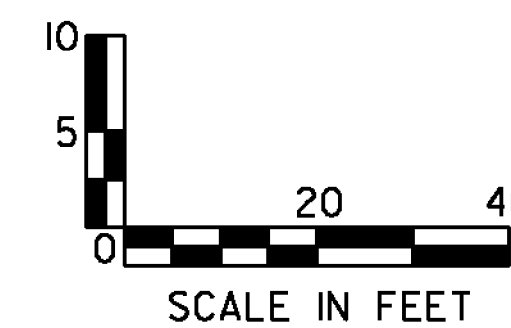
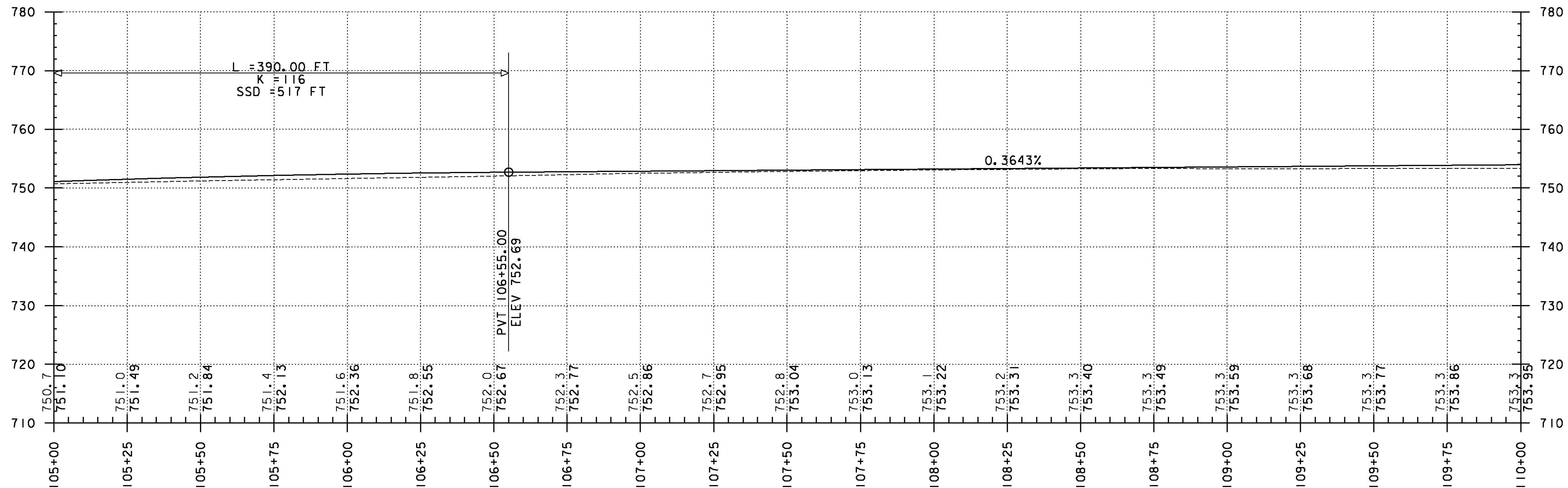
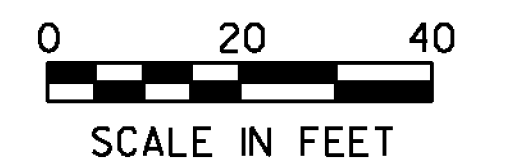

PROJECT NAME: RANDOLPH-ROXBURY
 PROJECT NUMBER: ER STP 0187(II)

FILE NAME: z13cl82bdr.dgn
 PROJECT LEADER: M. FOISY
 DESIGNED BY: I. MAYNARD
PLAN & PROFILE SHEET 31

PLOT DATE: 11/17/2014
 DRAWN BY: G. BURGMEIER
 CHECKED BY: M. FOISY
 SHEET 72 OF 545