

SOLID ROCK EXCAVATION

STA. 10+05 TO 11+10, RT STA. 10+08 TO 11+05, RT

UNDERDRAIN FLUSHING BASIN

STA. 11+75, RT STA. 11+60, RT

STA. 12+25, LT

STONE FILL TYPE I, GEOTEXTILE UNDER STONE FILL

& GRUBBING MATERIAL

STA. 11+09 TO 11+22, RT

STA. 13+47 TO 14+50, LT

RELOCATE MAILBOX, SINGLE SUPPORT

STA. 10+09, LT

STA. 11+76, LT

STEEL BEAM GUARDRAIL, GALVANIZED

STA. 12+11.0 TO 12+36.0, LT

STEEL BEAM GUARDRAIL, GALVANIZED

W/ 8 FEET POSTS

STA. 12+36.0 TO 15+00.0, LT

ANCHOR FOR STEEL BEAM RAIL

STA. 12+11.0, LT

REMOVAL AND DISPOSAL OF GUARDRAIL

STA. 12+19 TO 15+00, LT

DURABLE 4 INCH WHITE LINE, THERMOPLASTIC

DURABLE 4 INCH WHITE LINE, POLYUREA

TEMPORARY 4 INCH WHITE LINE, PAINT

STA. 10+00 TO 15+00, SOLID LT & RT

DURABLE 4 INCH YELLOW LINE, THERMOPLASTIC

DURABLE 4 INCH YELLOW LINE, POLYUREA

TEMPORARY 4 INCH YELLOW LINE, PAINT

STA. 10+00 TO 15+00, SOLID LT & RT

GEOTEXTILE FOR SILT FENCE

STA. 13+50 TO 14+50, LT

EROSION LOG

STA. 10+00 TO 15+00, RT

STA. 12+00 TO 13+00, LT

REMOVING SIGNS

AS SHOWN - 1

CURVE 14 DATA  
 R = 900.00'  
 $\Delta = 28^\circ 19' 58.68''$   
 $D = 6^\circ 21' 58.31''$   
 T = 227.17'  
 L = 445.05'  
 E = 28.23'  
 $e = 3.9\%$

CURVE 15 DATA  
 R = 1650.00'  
 $\Delta = 25^\circ 24' 57.36''$   
 $D = 3^\circ 28' 20.90''$   
 T = 372.08'  
 L = 731.93'  
 E = 41.43'  
 $e = 6.0\%$

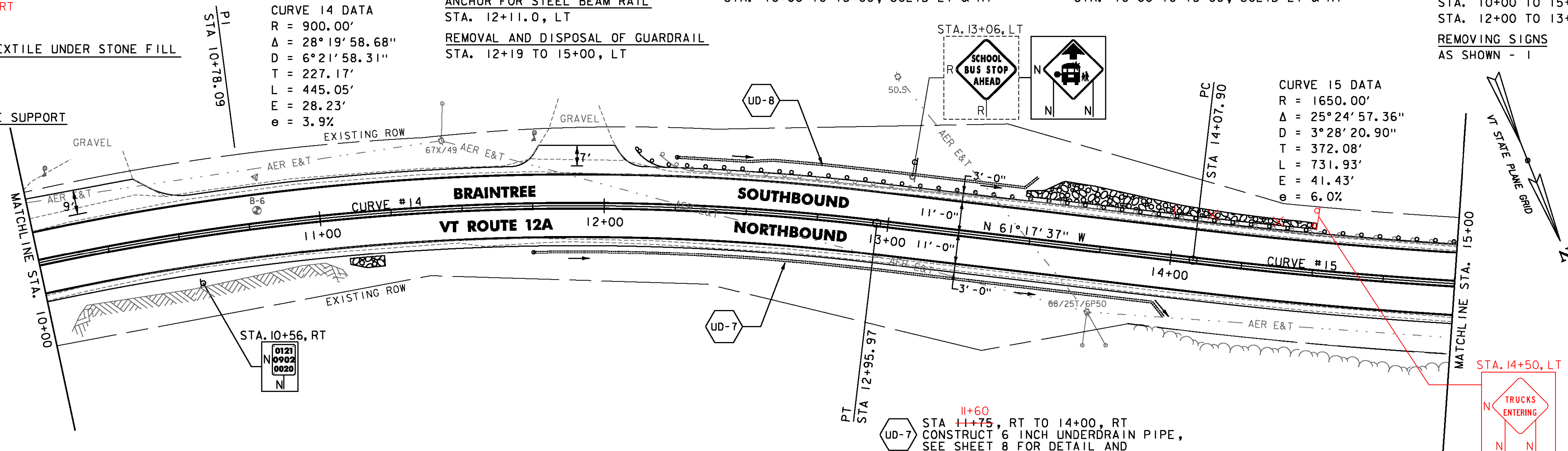

SOIL BORING DATA			
BORING#	DEPTH (FT.)	PCC	COMMENTS
B-6	5.0'	NO	

UD-7 STA 11+75, RT TO 14+00, RT  
 CONSTRUCT 6 INCH UNDERDRAIN PIPE,  
 SEE SHEET 8 FOR DETAIL AND  
 ASSOCIATED QUANTITIES.

UD-8 STA 12+25, LT TO 13+50, LT  
 CONSTRUCT 6 INCH UNDERDRAIN PIPE,  
 SEE SHEET 8 FOR DETAIL AND  
 ASSOCIATED QUANTITIES.

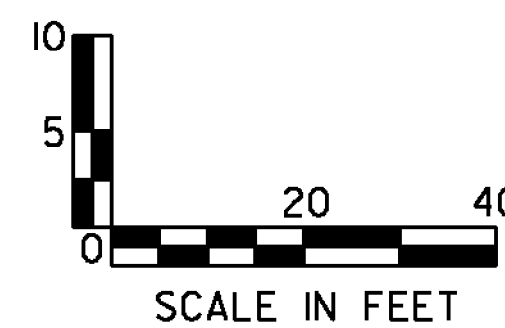
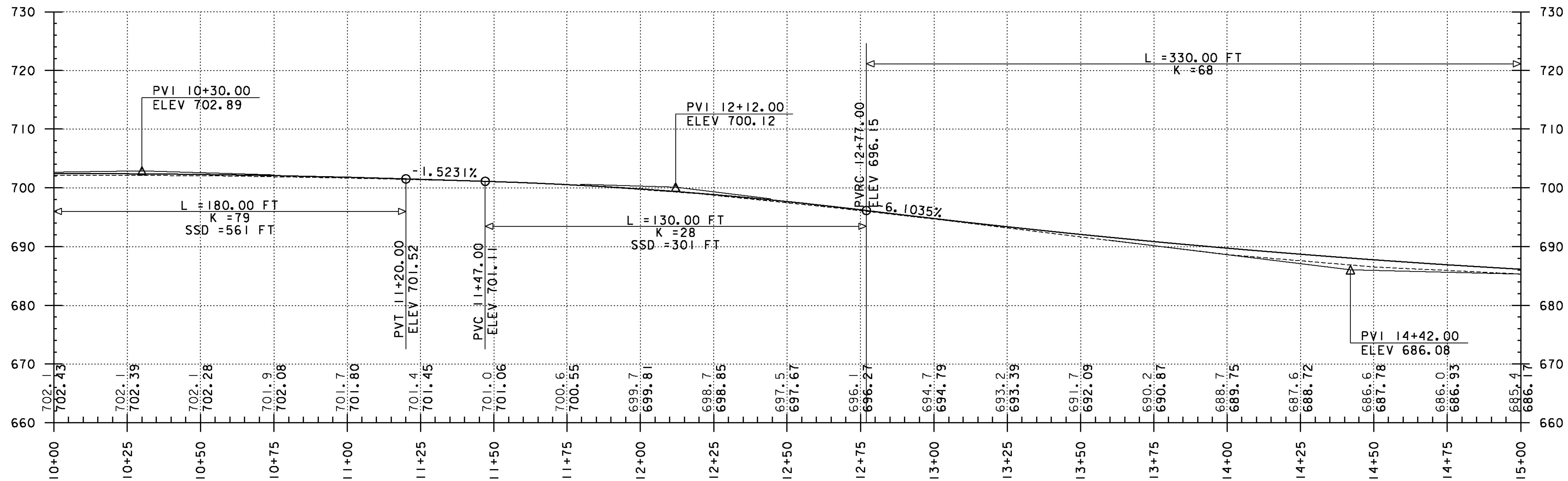
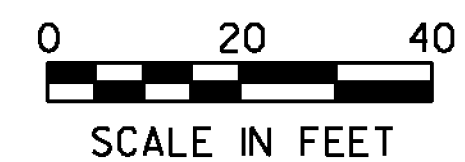

PROJECT NAME: RANDOLPH-ROXBURY  
 PROJECT NUMBER: ER STP 0187(III)

FILE NAME: z13cl82bdr.dgn  
 PROJECT LEADER: M. FOISY  
 DESIGNED BY: I. MAYNARD  
**PLAN & PROFILE SHEET 12**

PLOT DATE: 11/17/2014  
 DRAWN BY: G. BURGMEIER  
 CHECKED BY: M. FOISY  
 SHEET 53 OF 545