

UNDERDRAIN FLUSHING BASIN

STA. 31+25, RT  
STA. 33+75, RT  
33+85

STEEL BEAM GUARDRAIL, GALVANIZED W/ 8 FEET POSTS

STA. 29+50.0 TO 35+00.0, LT

DURABLE 4 INCH WHITE LINE, THERMOPLASTIC

DURABLE 4 INCH WHITE LINE, POLYUREA  
TEMPORARY 4 INCH WHITE LINE, PAINT  
STA. 29+50 TO 35+00, SOLID LT & RT

DURABLE 4 INCH YELLOW LINE, THERMOPLASTIC

DURABLE 4 INCH YELLOW LINE, POLYUREA  
TEMPORARY 4 INCH YELLOW LINE, PAINT  
STA. 29+50 TO 35+00, SOLID LT & RT

EROSION LOG

STA. 29+50 TO 35+00, RT  
REMOVING SIGNS  
AS SHOWN - 2

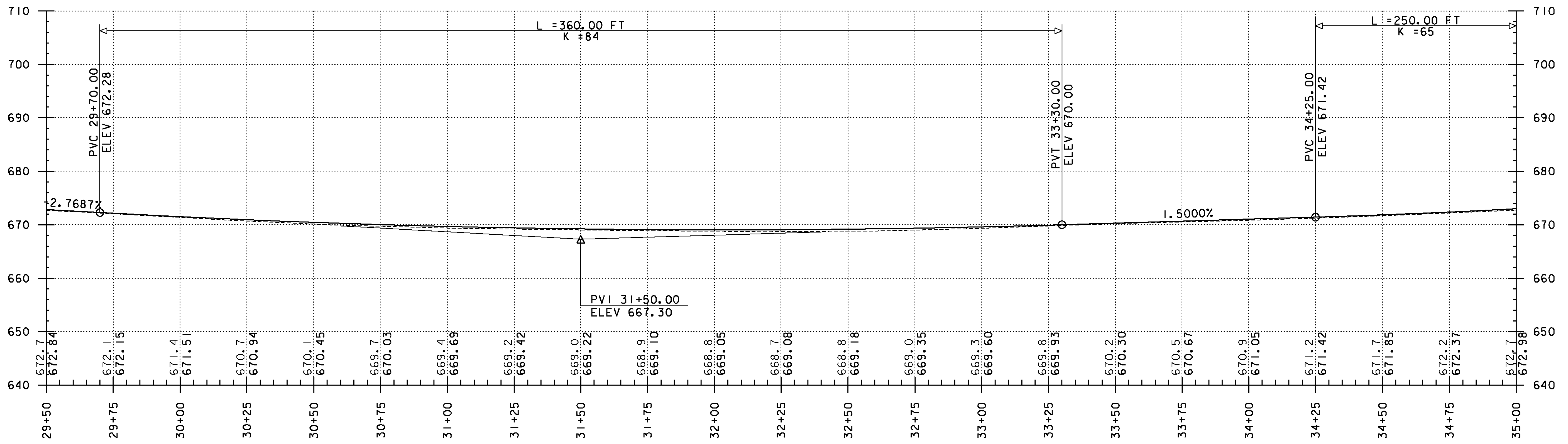
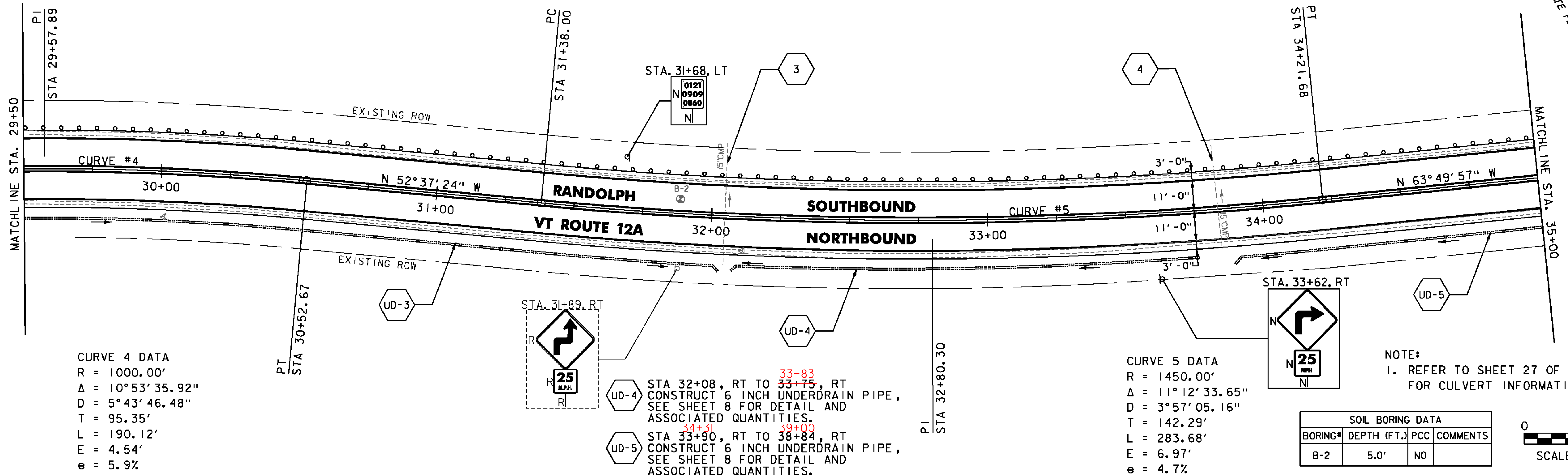
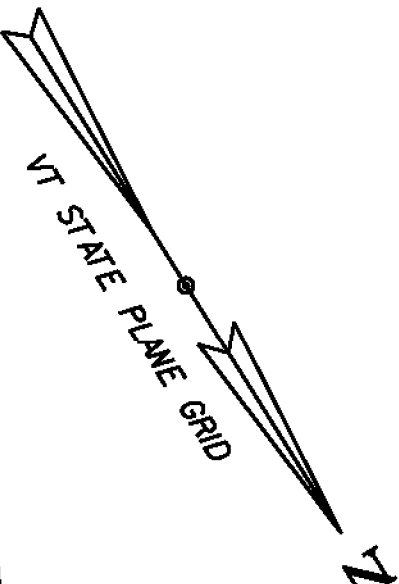

PROJECT NAME: RANDOLPH-ROXBURY  
 PROJECT NUMBER: ER STP 0187(II)

FILE NAME: z13cl82bdr.dgn  
 PROJECT LEADER: M. FOISY  
 DESIGNED BY: I. MAYNARD  
**PLAN & PROFILE SHEET 3**

PLOT DATE: 11/17/2014  
 DRAWN BY: G. BURGMEIER  
 CHECKED BY: M. FOISY  
 SHEET 44 OF 545

