

**MOBILE ACRES RAILROAD CROSSING #247-582S DETAIL  
BRAINTREE STA. 36+85, LT**

DURABLE RAILROAD CROSSING SYMBOL, THERMOPLASTIC  
DURABLE RAILROAD CROSSING SYMBOL, POLYUREA  
TEMPORARY RAILROAD CROSSING SYMBOL, PAINT

MOBILE ACRES STA. 11+17, RT  
MOBILE ACRES STA. 14+06, LT

REMOVING SIGNS  
AS SHOWN - 2

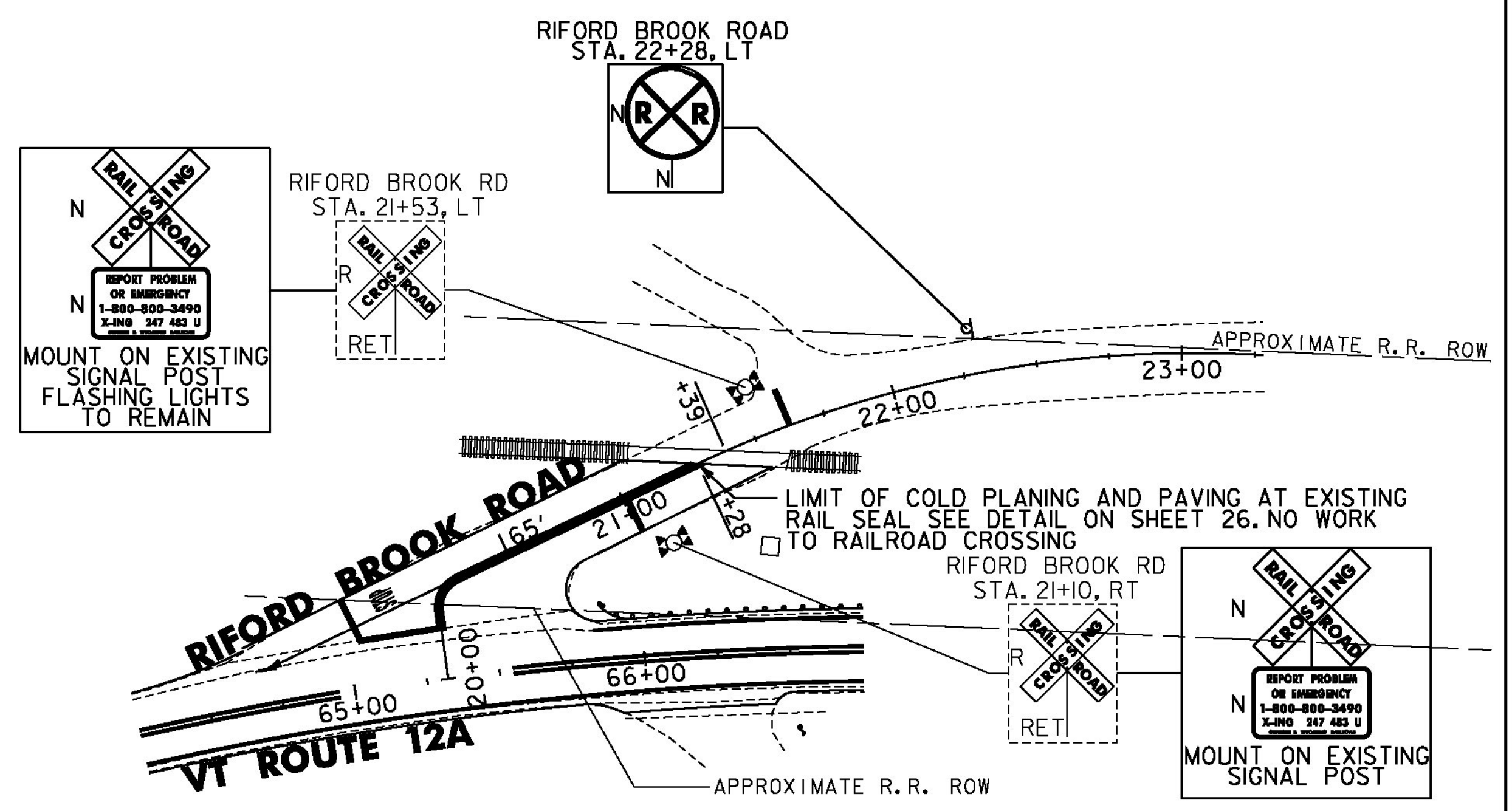
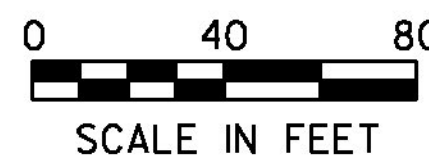

**RIFORD BROOK ROAD RAILROAD CROSSING #247-483U DETAIL  
BRAINTREE STA. 65+15, LT**

DURABLE 24 INCH STOP BAR, THERMOPLASTIC  
DURABLE 24 INCH STOP BAR, POLYUREA  
TEMPORARY 24 INCH STOP BAR, PAINT

RIFORD BROOK ROAD STA. 21+03, RT (12 LF)  
RIFORD BROOK ROAD STA. 21+63, LT (13 LF)

REMOVING SIGNS  
AS SHOWN - 2

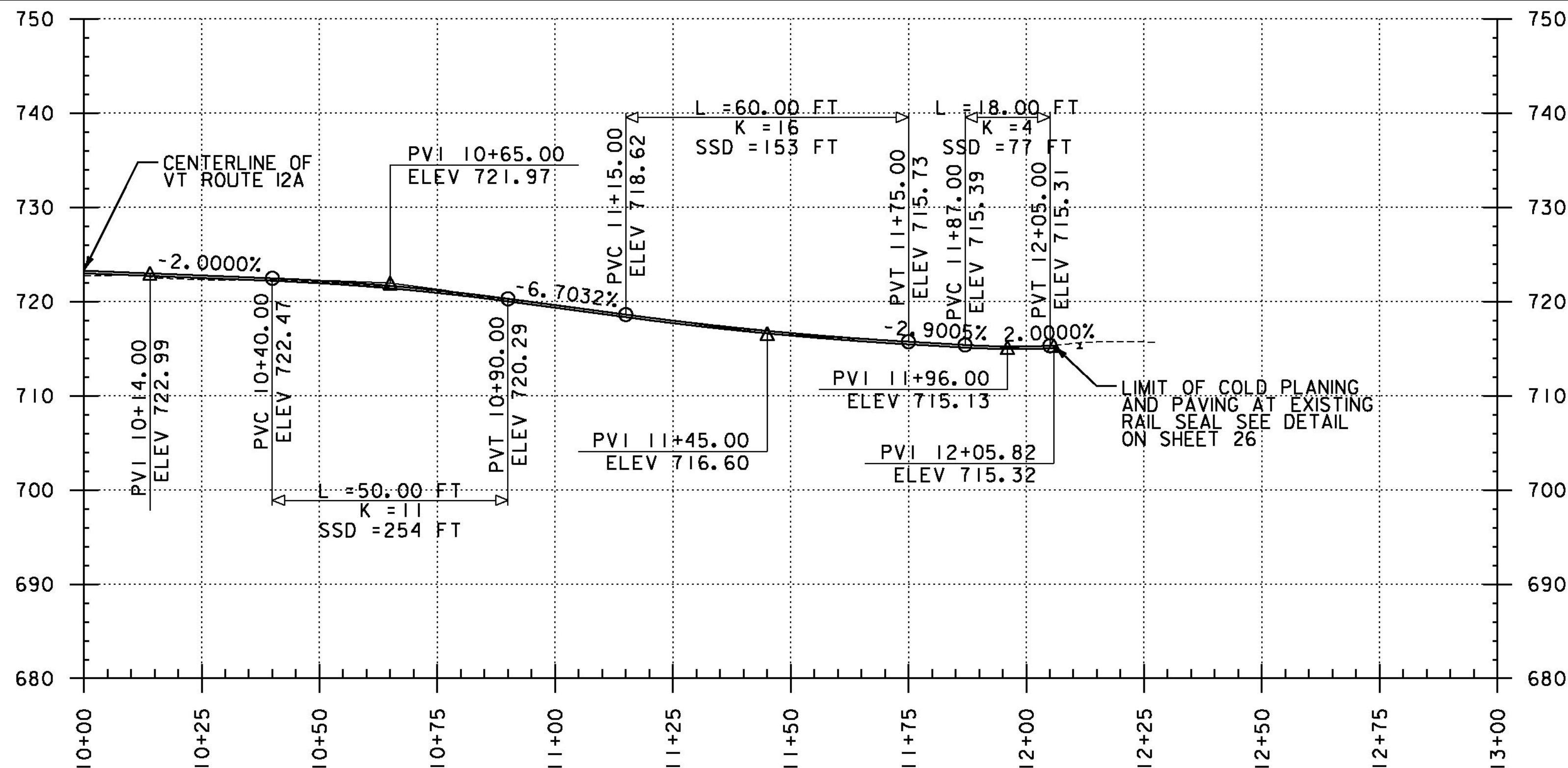
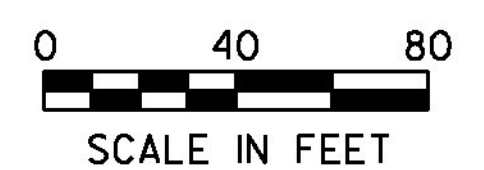

**MOBILE ACRES PROFILE**

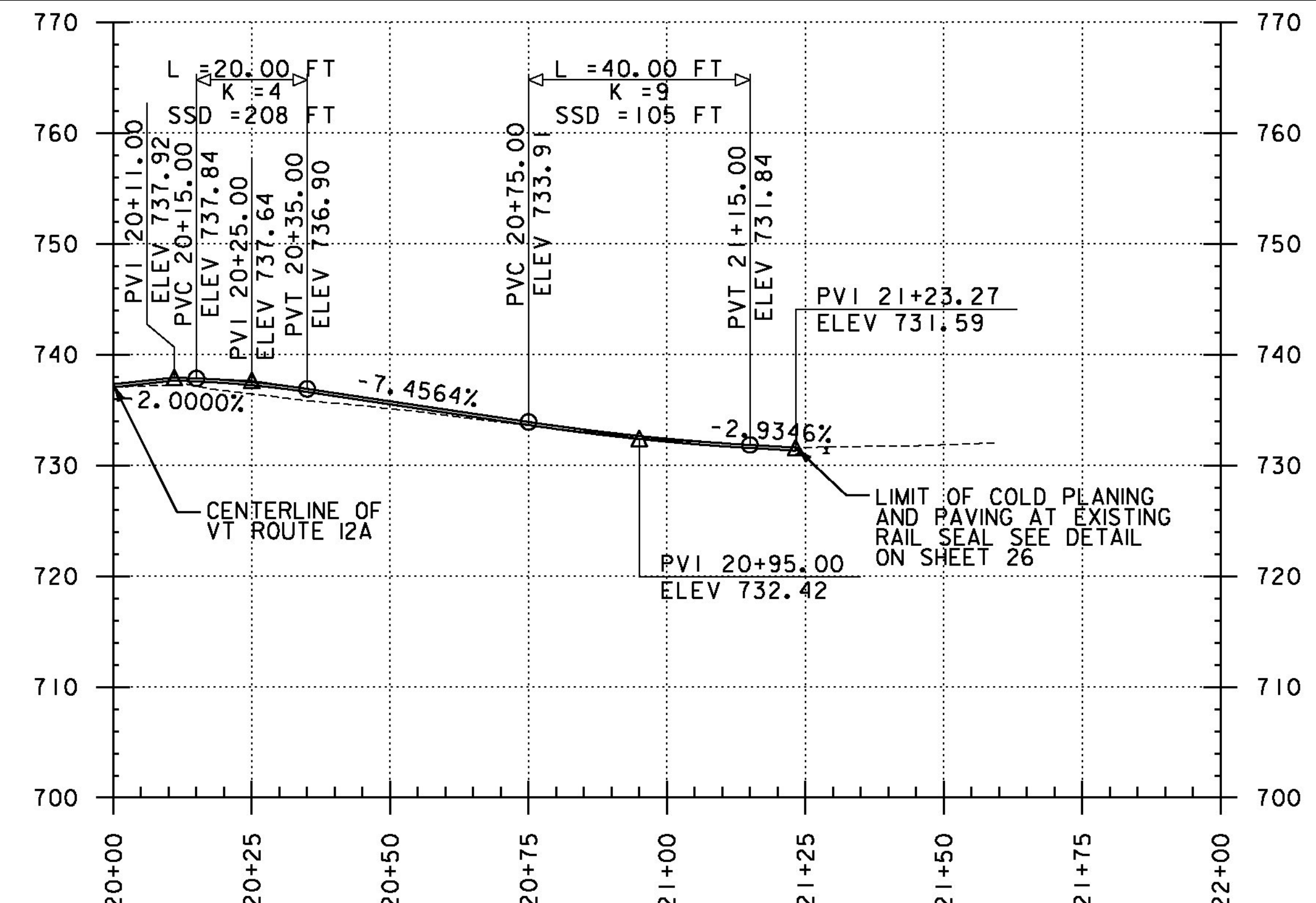
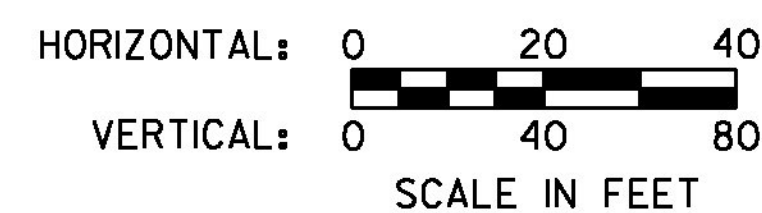

**RIFORD BROOK ROAD PROFILE**

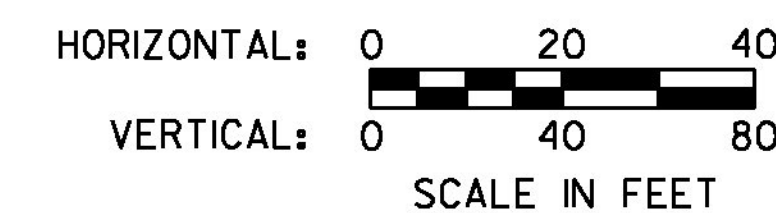

PROJECT NAME: RANDOLPH-ROXBURY	
PROJECT NUMBER: ER STP 0187(II)	
FILE NAME: z13c182frm.dgn	PLOT DATE: 11/17/2014
PROJECT LEADER: M. FOISY	DRAWN BY: I. MAYNARD
DESIGNED BY: I. MAYNARD	CHECKED BY: M. FOISY
<b>RAILROAD CROSSING DETAIL SHEET 2</b>	
SHEET 24 OF 545	

