

DETAIL FOR PIPE PLACEMENT AT END TREATMENT LOCATION

BRAINTREE
 STA. 40+60, RT
 STA. 229+16, LT
GRANVILLE
 STA. 12+00, RT

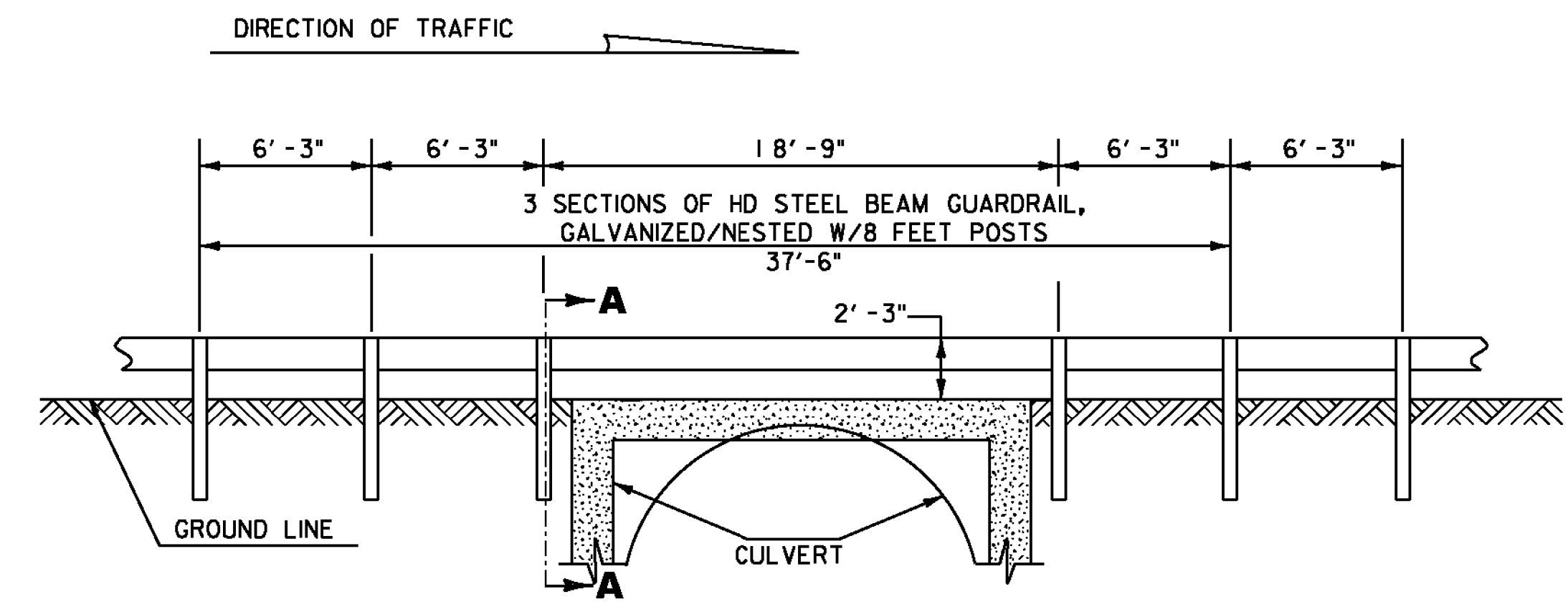
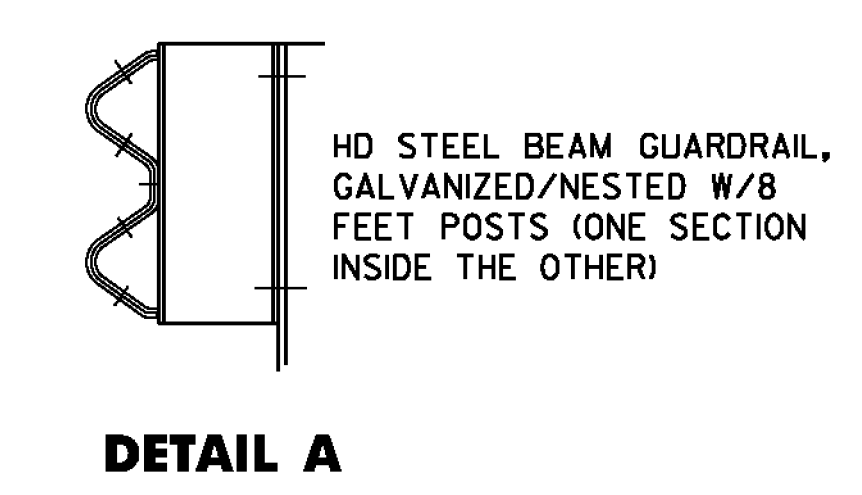

DETAIL OF STEEL BEAM GUARDRAIL AT LARGE CULVERTS

VT ROUTE 12A BRAINTREE STA. 89+19.09 (BRIDGE #3)

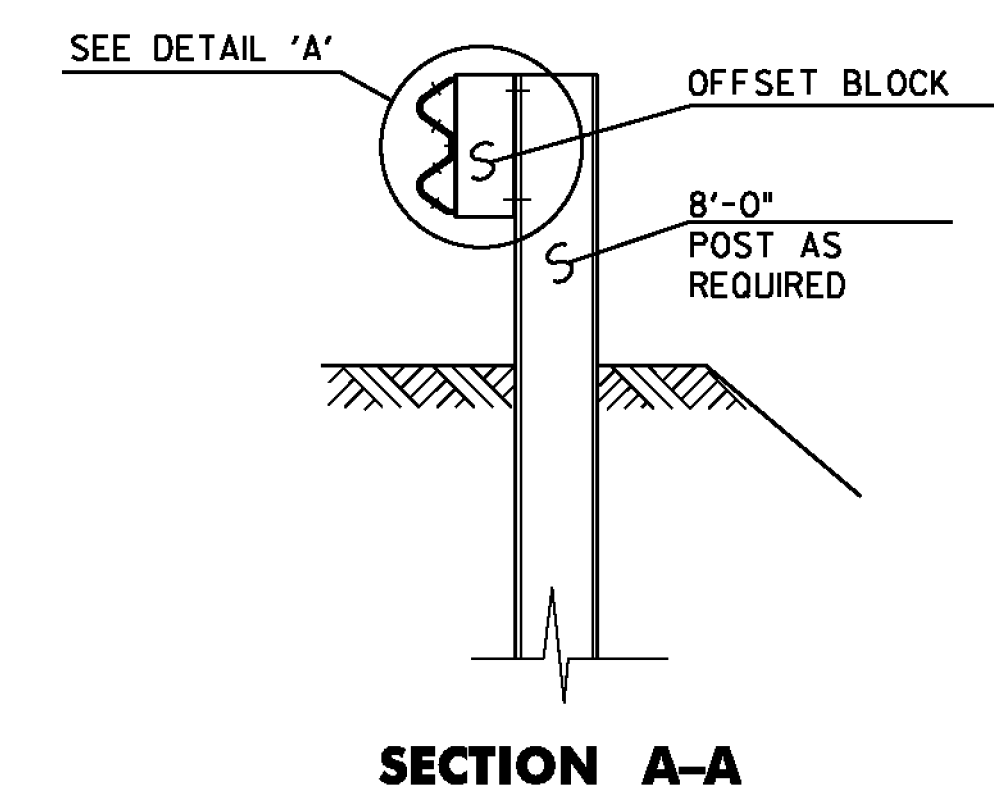

NOTES

1. SEE STANDARDS G-1 & G-ID FOR STEEL BEAM GUARDRAIL DETAILS
2. THIS WORK SHALL BE PAID UNDER ITEM 621.217 HD STEEL BEAM GUARDRAIL, GALVANIZED/NESTED W/8 FEET POSTS AT A PAY FACTOR OF 1.0.
3. THIS DETAIL TO BE USED AS INDICATED ON THE ITEM DETAIL SUMMARY SHEETS OR AS DIRECTED BY THE ENGINEER.

PROJECT NAME: RANDOLPH-ROXBURY	PLOT DATE: 11/17/2014
PROJECT NUMBER: ER STP 0187(II)	DRAWN BY: I. MAYNARD
FILE NAME: z13gl82frm.dgn	CHECKED BY: M. FOISY
PROJECT LEADER: M. FOISY	DESIGNED BY: I. MAYNARD
GUARDRAIL DETAIL SHEET 1	SHEET II OF 545

