

STATE OF VERMONT AGENCY OF TRANSPORTATION



PROPOSED IMPROVEMENT

TOWNS OF RANDOLPH, BRAINTREE, GRANVILLE & ROXBURY COUNTIES OF ORANGE, ADDISON & WASHINGTON VT ROUTE 12A (MAJOR COLLECTOR)

PROJECT LOCATION : BEGINNING IN THE TOWN OF RANDOLPH ON VT ROUTE 12A AT STA. 20+53.92 (MM 0.389) AND CONTINUING NORTHERLY THROUGH THE TOWNS OF BRAINTREE AND GRANVILLE ALONG VT ROUTE 12A AND ENDING AT STA. 35+32.32 (MM 0.669) IN THE TOWN OF ROXBURY.

PROJECT DESCRIPTION : WORK TO BE PERFORMED UNDER THIS PROJECT INCLUDES COLD PLANING, RECLAIMING AND RESURFACING OF THE EXISTING HIGHWAY WITH A RECLAIMED STABILIZED BASE, COLD MIXED RECYCLED PAVEMENT, INTERMEDIATE AND WEARING COURSE, CORRECTING SUPERELEVATION DEFICIENCIES, NEW PAVEMENT MARKINGS, GUARDRAIL, SIGNS, RAILROAD CROSSING IMPROVEMENTS, CULVERT AND DRAINAGE UPGRADES AND OTHER HIGHWAY RELATED ITEMS.

TOWN OF RANDOLPH	LENGTH (FEET)	LENGTH (MILES)	TOWN OF GRANVILLE	LENGTH (FEET)	LENGTH (MILES)
VT ROUTE 12A			VT ROUTE 12A		
STA. 20+53.92 TO STA. 67+13.42	4,659.50	0.882	STA. 0+00.00 TO STA. 88+48.34	8,848.34	1.676
MM 0.389 TO MM 1.271			MM 0.000 TO MM 1.676		
TOWN OF BRAINTREE			TOWN OF ROXBURY		
VT ROUTE 12A			VT ROUTE 12A		
STA. 0+00.00 TO STA. 378+97.72	37,897.72	7.178	STA. 0+00.00 TO STA. 35+32.32	3,532.32	0.669
MM 0.000 TO MM 7.178			MM 0.000 TO MM 0.669		
			TOTAL LENGTH OF PROJECT:	54,937.88	10.405
			TOTAL LENGTH OF ROADWAY:	54,937.88	10.405

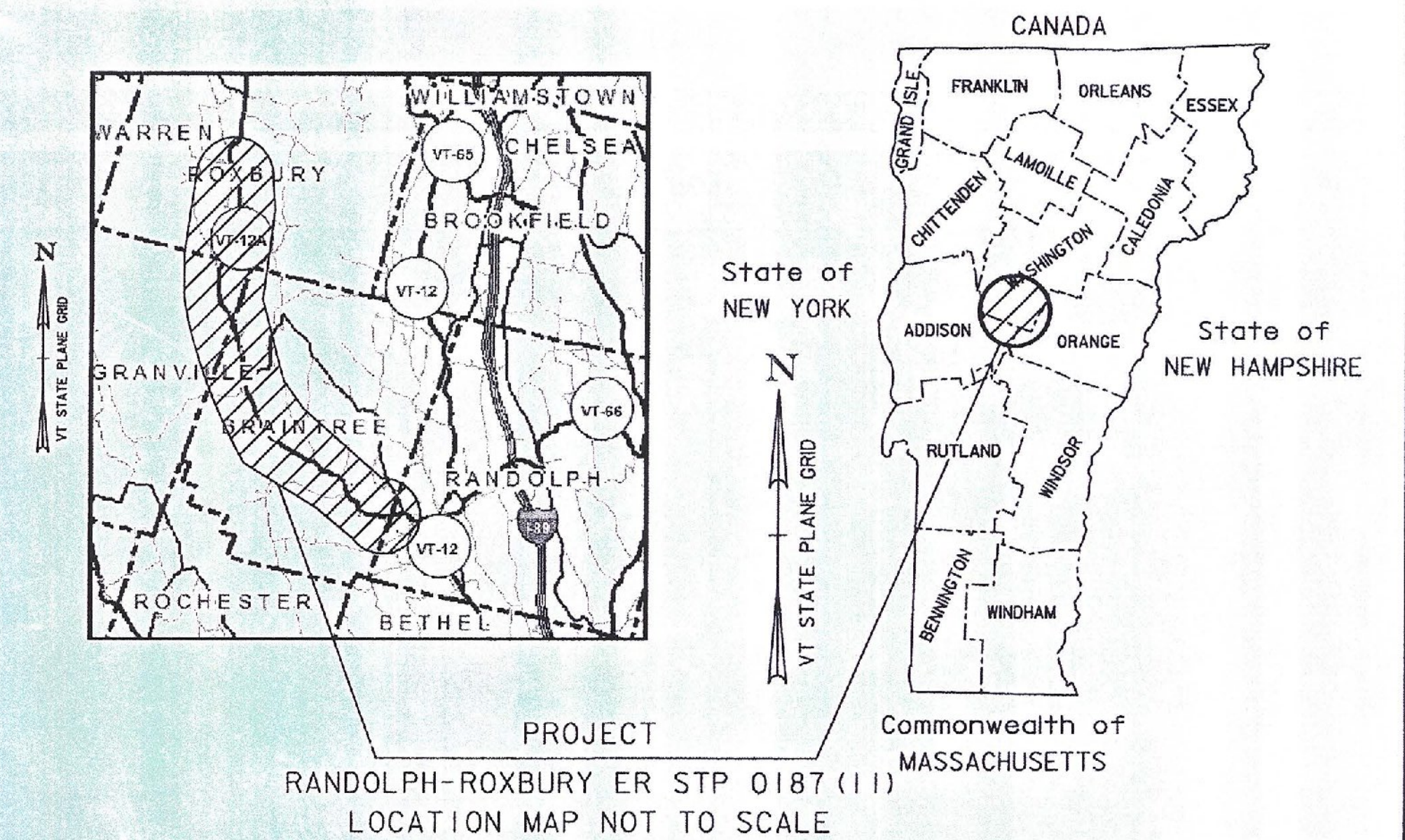

PROJECT
RANDOLPH-ROXBURY ER STP 0187 (11)
LOCATION MAP NOT TO SCALE

RECORD PLANS	
CONTRACTOR:	KUBRICKY CONSTRUCTION CORP. - GLENS FALLS, NY
RESIDENT ENGINEER:	CHRIS BARKER
CONSTRUCTION BEGAN:	APRIL 13, 2015
CONSTRUCTION COMPLETE:	OCTOBER 28, 2015
RECORD PLANS BY:	CHRIS BARKER & AARON JAMES
I HEREBY CERTIFY THAT ALL THE CONSTRUCTION REQUIRED BY THIS SET OF DRAWINGS HAS BEEN ACCOMPLISHED AS INDICATED HEREIN.	
BY:	<i>Chris Barker</i> RESIDENT ENGINEER
DATE:	01/10/17
NOTE: Any further information concerning final quantities, amounts or other details relative to this project may be found at Central Files in the electronic archives.	

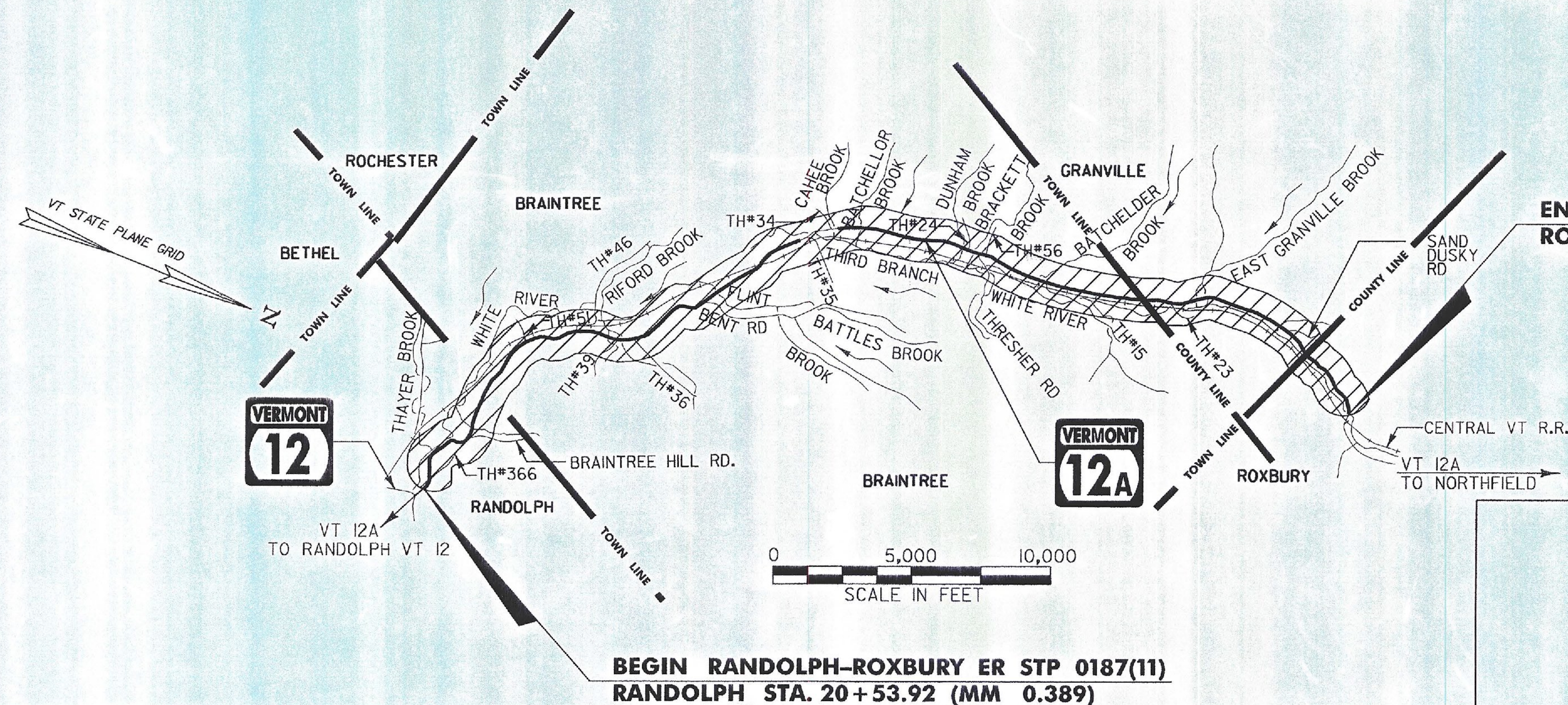

CONSTRUCTION IS TO BE CARRIED ON IN ACCORDANCE WITH THESE PLANS AND THE STANDARD SPECIFICATIONS FOR CONSTRUCTION DATED 2011, AS APPROVED BY THE FEDERAL HIGHWAY ADMINISTRATION ON JULY 20, 2011 FOR USE ON THIS PROJECT, INCLUDING ALL SUBSEQUENT REVISIONS AND SUCH REVISED SPECIFICATIONS AND SPECIAL PROVISIONS AS ARE INCORPORATED IN THESE PLANS.

QUALITY ASSURANCE PROGRAM : LEVEL 2
SURVEYED BY : VERMONT SURVEY & ENGINEERING
SURVEYED DATE : 2012
DATUM
VERTICAL NAVD 88 FT
HORIZONTAL NAD 83(2011)sFT
LSQ

END RANDOLPH-ROXBURY ER STP 0187(11)
ROXBURY STA. 35+32.32 (MM 0.669)

BEGIN RANDOLPH-ROXBURY ER STP 0187(11)
RANDOLPH STA. 20+53.92 (MM 0.389)

Stantec
Stantec Consulting Services Inc.
55 Green Mountain Drive
South Burlington VT U.S.A. 05403
Phone: (802) 864-0223
Fax: (802) 864-0165
www.stantec.com

DIRECTOR OF PROJECT DELIVERY	APPROVED <i>[Signature]</i> DATE 11/18/2014
PROJECT MANAGER : PAUL T. LIBBY	
PROJECT NAME : RANDOLPH-ROXBURY	
PROJECT NUMBER : ER STP 0187 (11)	
SHEET 1 OF 545 SHEETS	