

DURABLE 4 INCH WHITE LINE (OPTION ITEM) AND TEMPORARY 4 INCH WHITE LINE, PAINT (ALL LINES WILL INCLUDE EDGE LINE BREAKS AND RADIUS FOR TOWN HIGHWAYS)  
 ROCHESTER:  
 STA R 282+00.00 - STA R 288+00.00 LT & RT

DURABLE 4 INCH YELLOW LINE, (OPTION ITEM) AND TEMPORARY 4 INCH YELLOW LINE, PAINT (ALL LINES WILL INCLUDE C/L BREAKS FOR TOWN HIGHWAYS) S = SOLID, D = DASHED  
 ROCHESTER:  
 STA R 282+00.00 - STA R 282+48.00 LT S - S  
 STA R 282+48.00 - STA R 288+00.00 S - D

REMOVING SIGNS AS SHOWN - 1

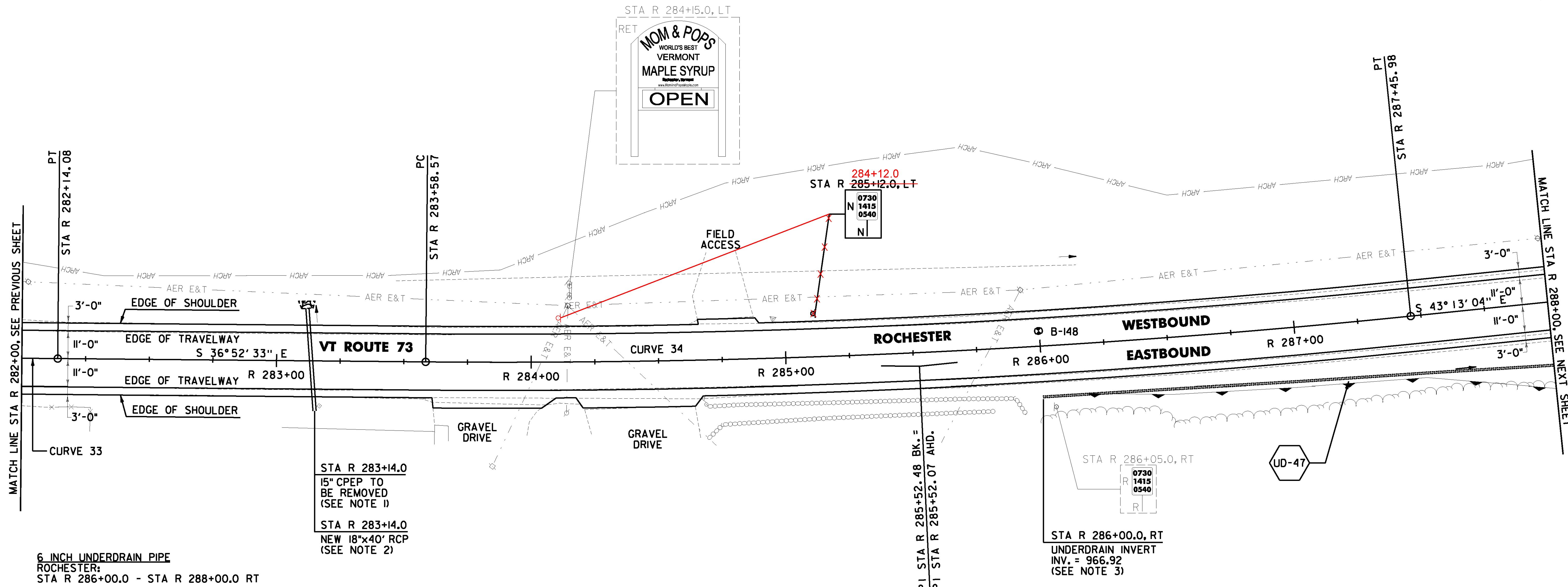
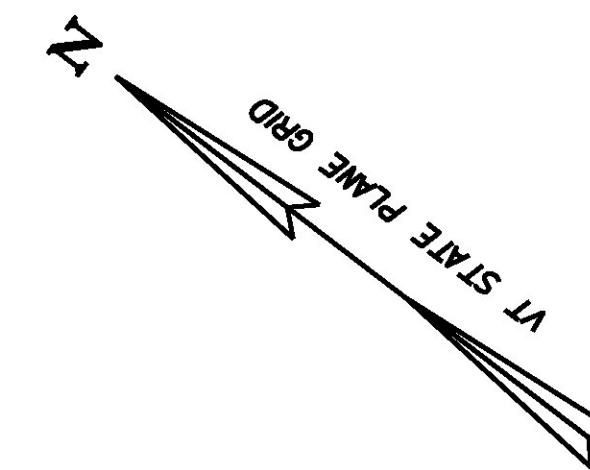

6 INCH UNDERDRAIN PIPE  
 ROCHESTER:  
 STA R 286+00.0 - STA R 288+00.0 RT

PROJECT DEMARCATION FENCE  
 ROCHESTER:  
~~STA R 282+00.0 - STA R 284+66.0 LT~~  
~~STA R 282+00.0 - STA R 283+62.0 RT~~  
~~STA R 284+04.0 - STA R 284+20.0 RT~~  
~~STA R 284+64.0 - STA R 288+00.0 RT~~ R 286+00.0 - R 288+00.0  
~~STA R 284+88.0 - STA R 288+00.0 LT~~

BARRIER FENCE  
 ROCHESTER:  
~~STA R 282+00.0 - STA R 284+66.0 LT~~  
~~STA R 284+88.0 - STA R 288+00.0 LT~~  
~~STA R 285+17.0 - STA R 288+00.0 RT~~



STONE FILL, TYPE II  
 ROCHESTER:  
 STA R 283+14.0 LT

SOIL BORING DATA			
BORING #	DEPTH (FT.)	PCC	COMMENTS
B-148	5.0	NO	

**CURVE 33**  
 $\Delta = 4^{\circ}27'33''$  LT  
 $D = 1^{\circ}38'13''$   
 $R = 3500.00'$   
 $T = 136.27'$   
 $L = 272.40'$   
 $E = 2.65'$   
 $e = 0.034$  FT/FT

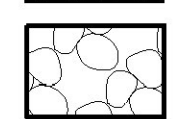
**CURVE 34**  
 $\Delta = 6^{\circ}20'32''$  LT  
 $D = 1^{\circ}38'13''$   
 $R = 3500.00'$   
 $T = 193.91'$   
 $L = 387.42'$   
 $E = 5.37'$   
 $e = 0.034$  FT/FT

**LEGEND**  
 ITEM 613.11  
 STONE FILL, TYPE II

**SIGN LEGEND**  
 R = REMOVE  
 S = SALVAGE  
 N = NEW  
 RET = RETAIN  
 B-B = BACK TO BACK  
 EXISTING =   
 NEW =   
 R = RETURN TO TOWN OF ROCHESTER

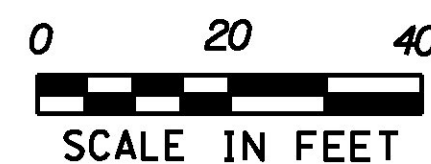

**NOTES:**

- THE CONTRACTOR SHALL PERFORM ALL EXCAVATION REQUIRED TO REMOVE THE EXISTING PIPE AND INSTALL THE PROPOSED PIPE UNDER ITEM 204.20 TRENCH EXCAVATION OF EARTH AS DIRECTED BY THE ENGINEER.
- SEE SHEET 24 FOR CULVERT ROADWAY CROSSING DETAIL.
- SEE SHEETS 26 & 27 FOR UNDERDRAIN DETAILS.

PROJECT NAME: ROCHESTER  
 PROJECT NUMBER: ER STP 0162(21)

FILE NAME: z13cl76bdr.dgn  
 PROJECT LEADER: D. GOZALKOWSKI  
 DESIGNED BY: J. OLSEN  
 PROJECT LAYOUT SHEET #50

PLOT DATE: 1/11/2017  
 DRAWN BY: J. HEALD  
 CHECKED BY: J. SHIELDS  
 SHEET 82 OF 360