

DURABLE 4 INCH WHITE LINE (OPTION ITEM) AND TEMPORARY 4 INCH WHITE LINE, PAINT
 (ALL LINES WILL INCLUDE EDGE LINE BREAKS AND RADIUS FOR TOWN HIGHWAYS)
 ROCHESTER:
 STA R 258+00.00 - STA R 259+25.00 LT
 STA R 258+00.00 - STA R 264+00.00 RT
 STA R 259+25.00 - STA R 260+00.00 DOTTED EDGE LINE LT
 STA R 260+00.00 - STA R 264+00.00 LT

DURABLE LETTER OR SYMBOL, (OPTION ITEM)
 ROCHESTER:
 STA R 263+19.25 LT, ARROW (1EA)
 STA R 263+35.00 LT, "S,L,O,W" (4 EA)

TEMPORARY LETTER OR SYMBOL, PAINT
 ROCHESTER:
 STA R 263+19.25 LT, ARROW (2 EA)
 STA R 263+35.00 LT, "S,L,O,W" (8 EA)

DURABLE 4 INCH YELLOW LINE, (OPTION ITEM) AND TEMPORARY 4 INCH YELLOW LINE, PAINT
 (ALL LINES WILL INCLUDE C/L BREAKS FOR TOWN HIGHWAYS) S = SOLID, D = DASHED
 ROCHESTER:
 STA R 258+00.00 - STA R 264+00.00 S - S
 LT C RT S - S

DURABLE 24 INCH STOP BAR, (OPTION ITEM) AND 24 INCH STOP BAR, PAINT
 ROCHESTER:
 STA R 263+09.00 LT
 STA R 263+42.50 LT

PROJECT DEMARCATION FENCE
 ROCHESTER:
~~STA R 258+00.0 - STA R 258+73.0 LT~~
~~STA R 258+00.0 - STA R 261+42.0 RT~~
~~STA R 258+95.0 - STA R 259+42.0 LT~~
~~STA R 259+50.0 - STA R 260+95.0 LT~~
~~STA R 261+31.0 - STA R 263+27.0 RT~~
~~STA R 261+32.0 - STA R 261+58.0 LT~~
~~STA R 261+74.0 - STA R 262+02.0 LT~~
~~STA R 262+21.0 - STA R 262+65.0 LT~~
~~STA R 262+95.0 - STA R 264+00.0 LT~~
~~STA R 263+54.0 - STA R 264+00.0 RT~~

BARRIER FENCE
 ROCHESTER:
~~STA R 258+00.0 - STA R 258+73.0 LT~~
~~STA R 258+00.0 - STA R 261+42.0 RT~~
~~STA R 258+95.0 - STA R 259+42.0 LT~~
~~STA R 259+50.0 - STA R 260+95.0 LT~~
~~STA R 261+31.0 - STA R 263+27.0 RT~~
~~STA R 261+32.0 - STA R 261+58.0 LT~~
~~STA R 261+74.0 - STA R 262+02.0 LT~~
~~STA R 262+21.0 - STA R 262+65.0 LT~~
~~STA R 262+95.0 - STA R 264+00.0 LT~~
~~STA R 263+54.0 - STA R 264+00.0 RT~~

REMOVING SIGNS AS SHOWN - I

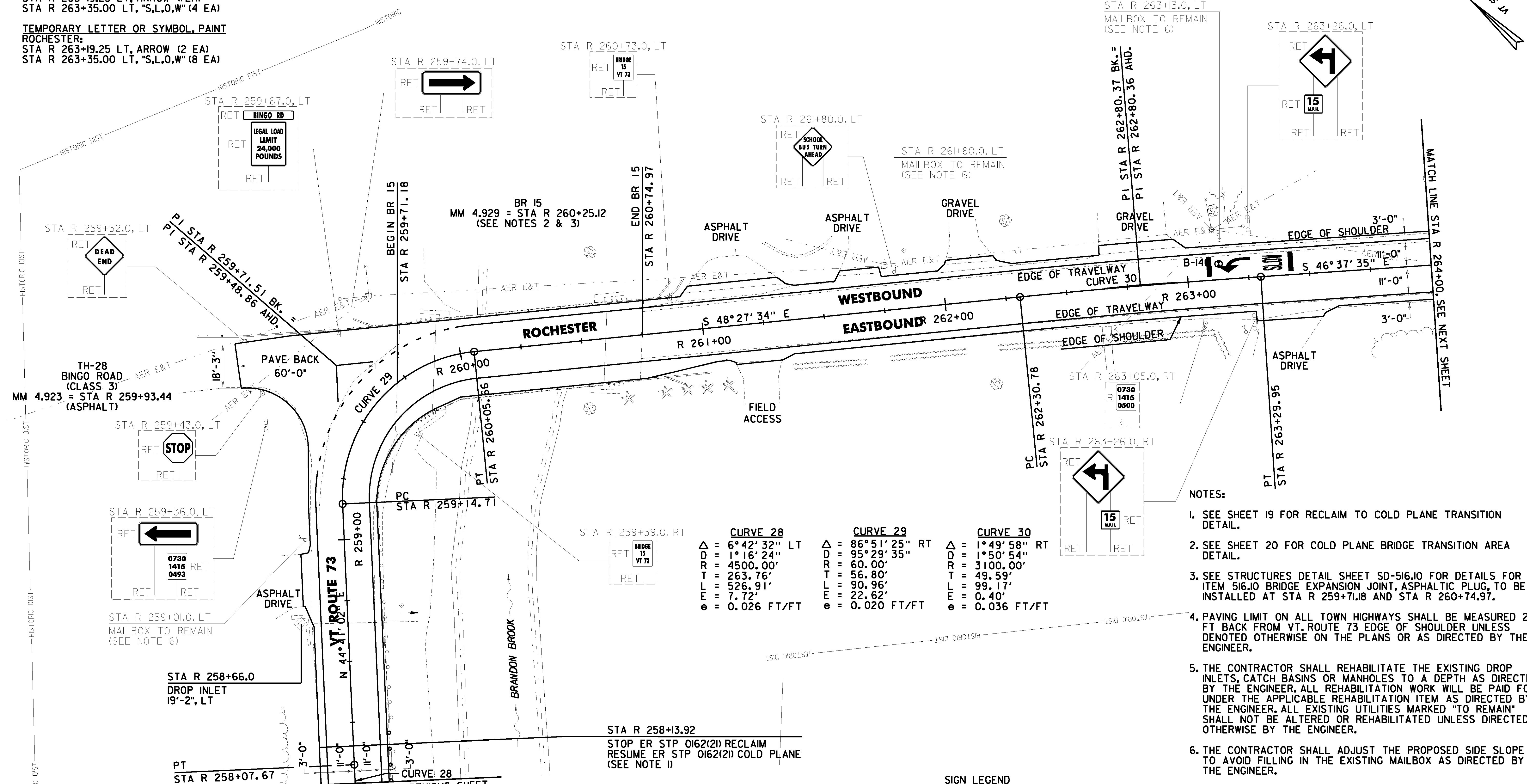
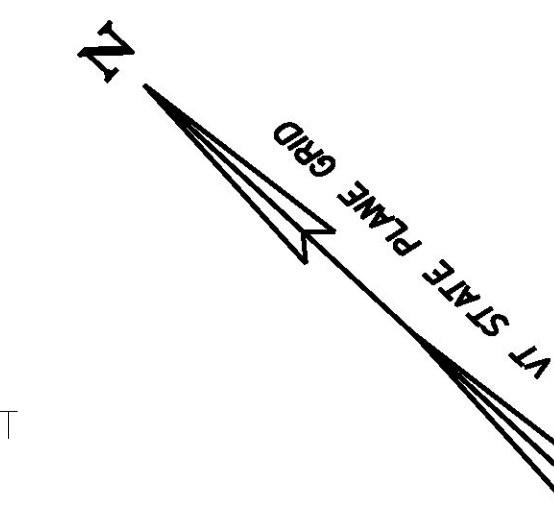

CURVE 28	CURVE 29	CURVE 30
Δ = 6° 42' 32" LT	Δ = 86° 51' 25" RT	Δ = 1° 49' 58" RT
D = 1° 16' 24"	D = 95° 29' 35"	D = 1° 50' 54"
R = 4500.00'	R = 60.00'	R = 3100.00'
T = 263.76'	T = 56.80'	T = 49.59'
L = 526.91'	L = 90.96'	L = 99.17'
E = 7.72'	E = 22.62'	E = 0.40'
e = 0.026 FT/FT	e = 0.020 FT/FT	e = 0.036 FT/FT

- NOTES:**
- SEE SHEET 19 FOR RECLAIM TO COLD PLANE TRANSITION DETAIL.
 - SEE SHEET 20 FOR COLD PLANE BRIDGE TRANSITION AREA DETAIL.
 - SEE STRUCTURES DETAIL SHEET SD-516.10 FOR DETAILS FOR ITEM 516.10 BRIDGE EXPANSION JOINT, ASPHALTIC PLUG, TO BE INSTALLED AT STA R 259+71.18 AND STA R 260+74.97.
 - PAVING LIMIT ON ALL TOWN HIGHWAYS SHALL BE MEASURED 25 FT BACK FROM VT. ROUTE 73 EDGE OF SHOULDER UNLESS DENOTED OTHERWISE ON THE PLANS OR AS DIRECTED BY THE ENGINEER.
 - THE CONTRACTOR SHALL REHABILITATE THE EXISTING DROP INLETS, CATCH BASINS OR MANHOLES TO A DEPTH AS DIRECTED BY THE ENGINEER. ALL REHABILITATION WORK WILL BE PAID FOR UNDER THE APPLICABLE REHABILITATION ITEM AS DIRECTED BY THE ENGINEER. ALL EXISTING UTILITIES MARKED "TO REMAIN" SHALL NOT BE ALTERED OR REHABILITATED UNLESS DIRECTED OTHERWISE BY THE ENGINEER.
 - THE CONTRACTOR SHALL ADJUST THE PROPOSED SIDE SLOPE TO AVOID FILLING IN THE EXISTING MAILBOX AS DIRECTED BY THE ENGINEER.

SIGN LEGEND
 R = REMOVE
 S = SALVAGE
 N = NEW
 RET = RETAIN
 B-B = BACK TO BACK
 EXISTING = _____
 NEW = _____
 R = RETURN TO TOWN OF ROCHESTER

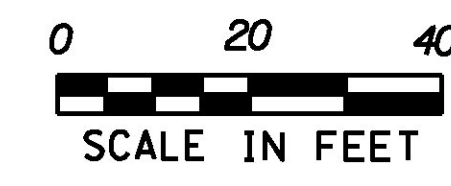

SOIL BORING DATA			
BORING #	DEPTH (FT.)	PCC	COMMENTS
B-146	3.0	NO	

STEEL BEAM GUARDRAIL, GALVANIZED W/ 8 FEET POSTS
 ROCHESTER:
 STA R 258+00.0 - STA R 258+38.5 RT

REMOVAL AND DISPOSAL OF GUARDRAIL
 ROCHESTER:
 STA R 258+00.0 - STA R 258+38.5 RT

REHAB DROP INLETS, CATCH BASINS OR MANHOLES CLASS I, II OR III (SEE NOTE 5)
 ROCHESTER:
 STA R 258+66.0, LT

PROJECT NAME: ROCHESTER
PROJECT NUMBER: ER STP 0162(21)

FILE NAME: z13cl76bdr.dgn **PLOT DATE:** 1/11/2017
PROJECT LEADER: D. GOZALKOWSKI **DRAWN BY:** J. HEALD
DESIGNED BY: J. OLSEN **CHECKED BY:** J. SHIELDS
PROJECT LAYOUT SHEET #46 **SHEET 78 OF 360**