

DURABLE 4 INCH WHITE LINE (OPTION ITEM) AND TEMPORARY 4 INCH WHITE LINE PAINT (ALL LINES WILL INCLUDE EDGE LINE BREAKS AND RADIUS FOR TOWN HIGHWAYS)
 ROCHESTER:
 STA R 92+00.00 - STA R 98+00.00 LT & RT

DURABLE 4 INCH YELLOW LINE (OPTION ITEM) AND TEMPORARY 4 INCH YELLOW LINE PAINT (ALL LINES WILL INCLUDE C/L BREAKS FOR TOWN HIGHWAYS) S = SOLID, D = DASHED
 ROCHESTER:
 STA R 92+00.00 - STA R 94+25.00 LT S
 STA R 94+25.00 - STA R 98+00.00 LT S

REMOVING SIGNS AS SHOWN - 1

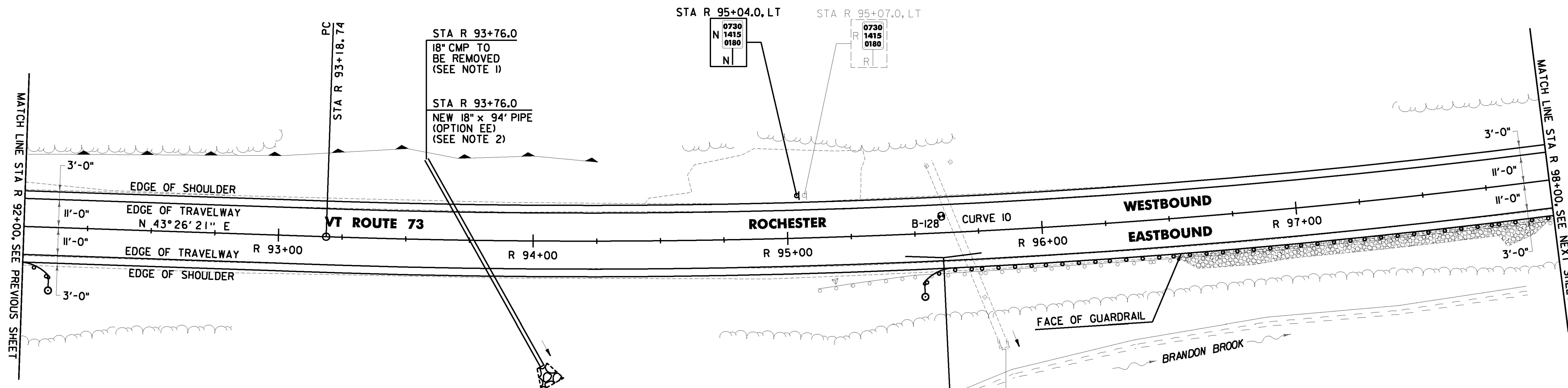
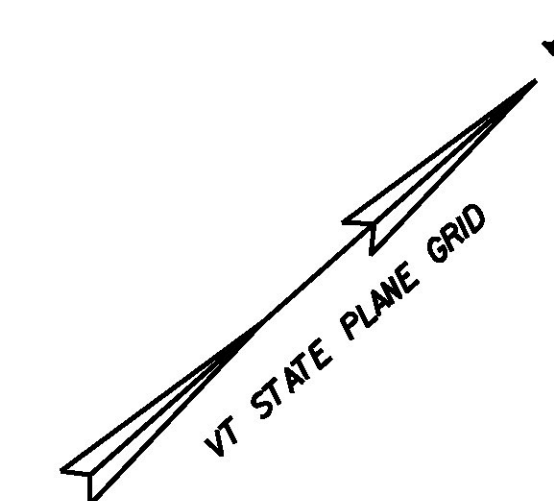

- STONE FILL, TYPE I**
 ROCHESTER:
 STA R 96+50.0 - STA R 98+00.0 RT
- STONE FILL, TYPE II**
 ROCHESTER:
 STA R 94+05.0 RT
- GRUBBING MATERIAL (6")**
 ROCHESTER:
 STA R 96+50.0 - STA R 98+00.0 RT
- STEEL BEAM GUARDRAIL, GALVANIZED W/ 8 FEET POSTS**
 ROCHESTER:
 STA R 92+00.0 - STA R 92+10.5 RT
- ANCHOR FOR STEEL BEAM RAIL**
 ROCHESTER:
 STA R 92+02.3 RT
 STA R 95+59.0 RT

- PROJECT DEMARCATION FENCE**
 ROCHESTER:
~~STA R 92+00.0 - STA R 98+00.0 LT & RT~~
- BARRIER FENCE**
 ROCHESTER:
 STA R 92+00.0 - STA R 95+25.0 LT
- GEOTEXTILE FOR SILT FENCE**
 ROCHESTER:
 STA R 96+50.0 - STA R 98+00.0 RT
- STEEL BEAM GUARDRAIL, GALVANIZED**
 ROCHESTER:
 STA R 95+50.5 - STA R 98+00.0 RT
- REMOVAL AND DISPOSAL OF GUARDRAIL**
 ROCHESTER:
 STA R 95+11.0 - STA R 98+00.0 RT
- DELINEATOR WITH STEEL POST**
 ROCHESTER:
 STA R 92+10.8 RT
 STA R 95+50.5 RT

SOIL BORING DATA			
BORING #	DEPTH (FT.)	PCC	COMMENTS
B-128	5.0	NO	AUGER GRINDING 2.5'-5.0'

CURVE 10
 $\Delta = 9^{\circ} 14' 46''$ LT
 $D = 1^{\circ} 54' 35''$
 $R = 3000.00'$
 $T = 242.59'$
 $L = 484.12'$
 $E = 9.79'$
 $e = 0.038$ FT/FT

LEGEND

- ITEM 613.I0 STONE FILL, TYPE I
- ITEM 613.II STONE FILL, TYPE II

- SIGN LEGEND**
- R = REMOVE
 - S = SALVAGE
 - N = NEW
 - RET = RETAIN
 - B-B = BACK TO BACK
 - EXISTING = - - - - -
 - NEW = _____
 - R = RETURN TO TOWN OF ROCHESTER

0 20 40
 SCALE IN FEET

- NOTES:**
- THE CONTRACTOR SHALL PERFORM ALL EXCAVATION REQUIRED TO REMOVE THE EXISTING PIPE AND INSTALL THE PROPOSED PIPE UNDER ITEM 204.20 TRENCH EXCAVATION OF EARTH AS DIRECTED BY THE ENGINEER.
 - SEE SHEET 24 FOR CULVERT ROADWAY CROSSING DETAIL.

PROJECT NAME: ROCHESTER
 PROJECT NUMBER: ER STP 0162(21)
 FILE NAME: z13cl76bdr.dgn
 PROJECT LEADER: D. GOZALKOWSKI
 DESIGNED BY: J. OLSEN
 PROJECT LAYOUT SHEET #17

PLOT DATE: 1/11/2017
 DRAWN BY: J. HEALD
 CHECKED BY: J. SHIELDS
 SHEET 49 OF 360