

DURABLE 4 INCH WHITE LINE (OPTION ITEM) AND TEMPORARY 4 INCH WHITE LINE, PAINT (ALL LINES WILL INCLUDE EDGE LINE BREAKS AND RADIUS FOR TOWN HIGHWAYS)
 ROCHESTER:
 STA R 2+00.00 - STA R 8+00.00 LT & RT

DURABLE 4 INCH YELLOW LINE (OPTION ITEM) AND TEMPORARY 4 INCH YELLOW LINE, PAINT (ALL LINES WILL INCLUDE C/L BREAKS FOR TOWN HIGHWAYS) S = SOLID, D = DASHED
 ROCHESTER:
 STA R 2+00.00 - STA R 8+00.00 LT Q RT S - S

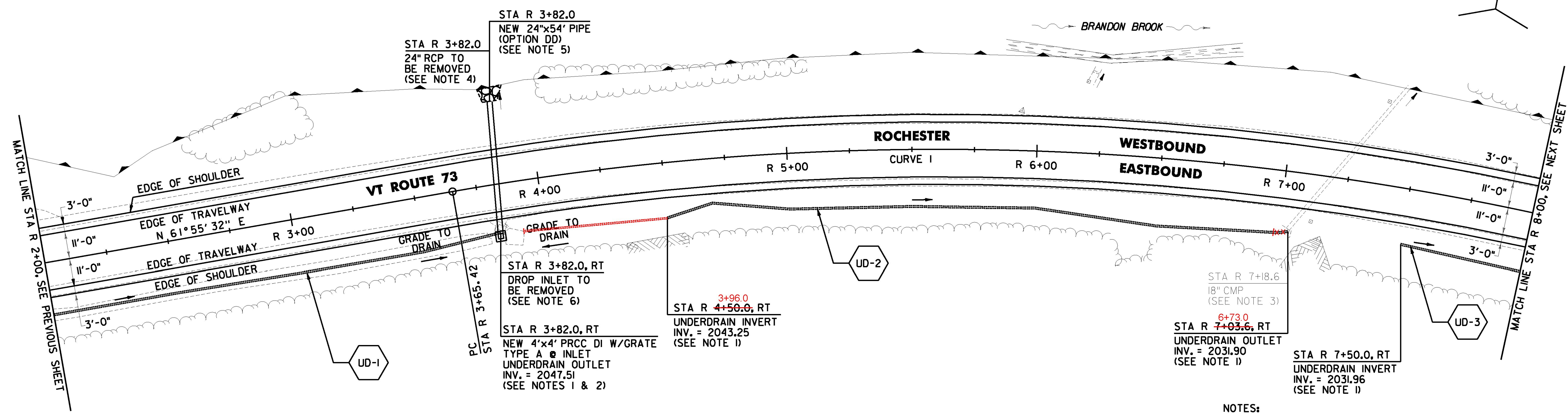
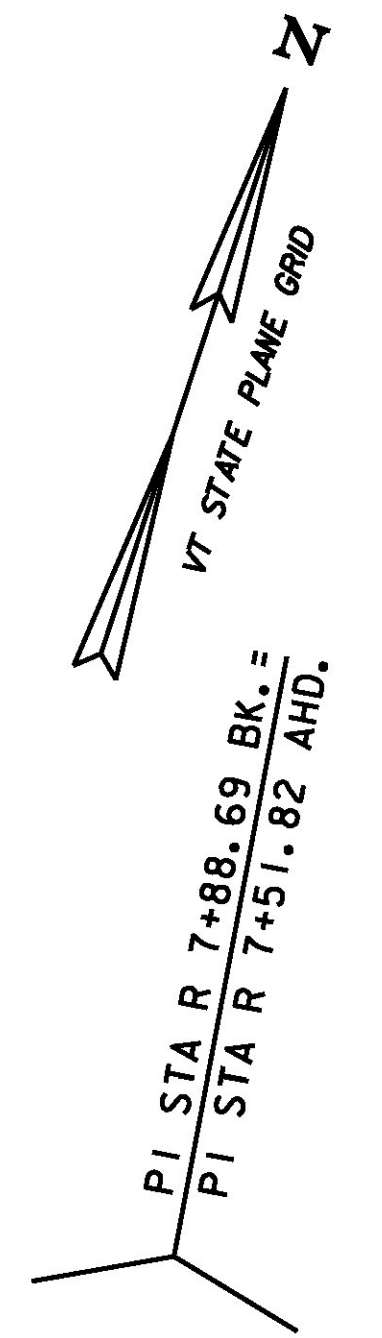

6 INCH UNDERDRAIN PIPE
 ROCHESTER:
 STA R 2+00.0 - STA R 3+82.0 RT
 STA R 4+50.0 - STA R 7+03.6 RT
 STA R 7+50.0 - STA R 8+00.0 RT

PROJECT DEMARCATION FENCE
 ROCHESTER:
~~STA R 2+00.0 - STA R 8+00.0 LT & RT~~

BARRIER FENCE
 ROCHESTER:
 STA R 2+00.0 - STA R 8+00.0 LT

STONE FILL, TYPE II
 ROCHESTER:
 STA R 3+82.0 LT

CURVE I
 $\Delta = 41^\circ 14' 11''$ RT
 $D = 5^\circ 05' 35''$
 $R = 1125.00'$
 $T = 423.27'$
 $L = 809.67'$
 $E = 76.99'$
 $e = 0.072$ FT/FT

LEGEND
 ITEM 613.11
 STONE FILL, TYPE II

SIGN LEGEND
 R = REMOVE
 S = SALVAGE
 N = NEW
 RET = RETAIN
 B-B = BACK TO BACK
 EXISTING =
 NEW =
 R = RETURN TO TOWN OF ROCHESTER

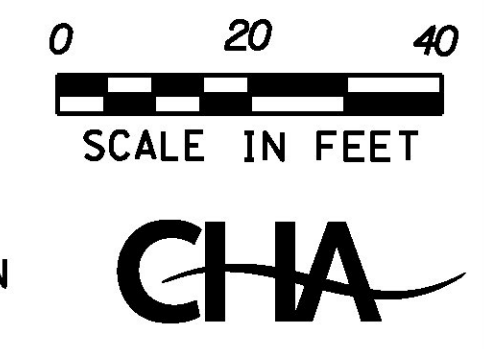

- NOTES:**
- SEE SHEETS 26 & 27 FOR UNDERDRAIN DETAILS.
 - THE CONTRACTOR SHALL ADJUST THE PROPOSED SIDE SLOPE IN ORDER TO PLACE DROP INLET IN PROPOSED LOCATION AS DIRECTED BY THE ENGINEER.
 - THE CONTRACTOR SHALL ADJUST THE PROPOSED SIDE SLOPE TO AVOID FILLING IN THE EXISTING PIPE AS DIRECTED BY THE ENGINEER.
 - THE CONTRACTOR SHALL PERFORM ALL EXCAVATION REQUIRED TO REMOVE THE EXISTING PIPE AND INSTALL THE PROPOSED PIPE UNDER ITEM 204.20 TRENCH EXCAVATION OF EARTH AS DIRECTED BY THE ENGINEER.
 - SEE SHEET 24 FOR CULVERT ROADWAY CROSSING DETAIL.
 - THE CONTRACTOR SHALL FIELD VERIFY THE INVERT OF EXISTING PIPE PRIOR TO ORDERING PROPOSED DRAINAGE STRUCTURE.

PROJECT NAME: ROCHESTER
 PROJECT NUMBER: ER STP 0162(21)

FILE NAME: z13cl76bdr.dgn
 PROJECT LEADER: D. GOZALKOWSKI
 DESIGNED BY: J. OLSEN
 PROJECT LAYOUT SHEET #2

PLOT DATE: 1/11/2017
 DRAWN BY: J. HEALD
 CHECKED BY: J. SHIELDS
 SHEET 34 OF 360