

TRAFFIC SIGNS, TYPE A (BRIDGE NUMBER PLAQUE)  
 STA. 125+22.0 RT  
 STA. 125+63.0 LT  
 SQUARE TUBE SIGN POST AND ANCHOR  
 STA. 125+22.0 RT  
 STA. 125+63.0 LT

PRECAST CONCRETE STRUCTURE (NORTH WALL)  
 STA. 125+39.8 LT - 125+59.8 LT  
 PRECAST CONCRETE STRUCTURE (SOUTH WALL)  
 STA. 125+14.4 RT - 125+46.8 RT

SPECIAL PROVISION (TRENCHLESS PIPE WITH CEMENT MORTAR LINING) (72" DIAMETER)  
 STA. 125+33.30 RT - 125+49.38 LT

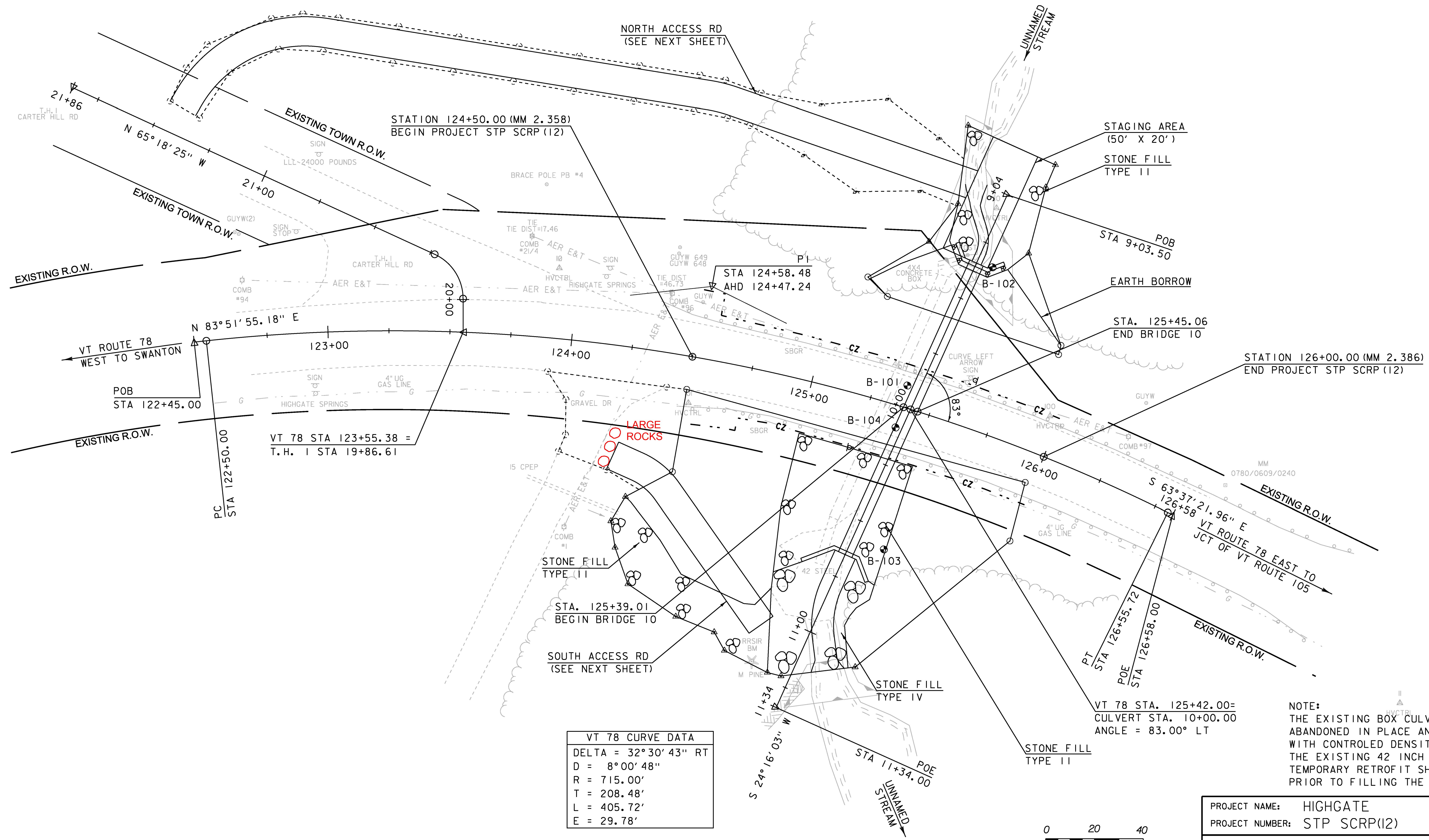
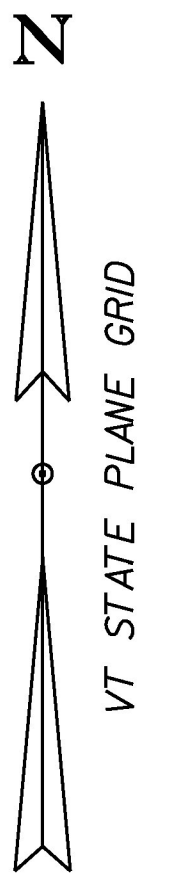

VT 78 STA 123+55.38 =  
 T.H. I STA 19+86.61

VT 78 CURVE DATA	
DELTA	= 32° 30' 43" RT
D	= 8° 00' 48"
R	= 715.00'
T	= 208.48'
L	= 405.72'
E	= 29.78'



NOTE:  
 THE EXISTING BOX CULVERT SHALL BE ABANDONED IN PLACE AND SHALL BE FILLED WITH CONTROLLED DENSITY (FLOWABLE) FILL. THE EXISTING 42 INCH PIPE USED AS A TEMPORARY RETROFIT SHALL BE REMOVED PRIOR TO FILLING THE BOX CULVERT.

PROJECT NAME:	HIGHGATE
PROJECT NUMBER:	STP SCRPI(2)
FILE NAME:	d13ci34bdr.dgn
PROJECT LEADER:	B. MARTIN
DESIGNED BY:	A. KEMPTON
PLAN SHEET	
PLOT DATE:	14-OCT-2016
DRAWN BY:	A. KEMPTON
CHECKED BY:	M. GAMELIN
SHEET	17 OF 40