

MATCH LINE STA 268+75.00

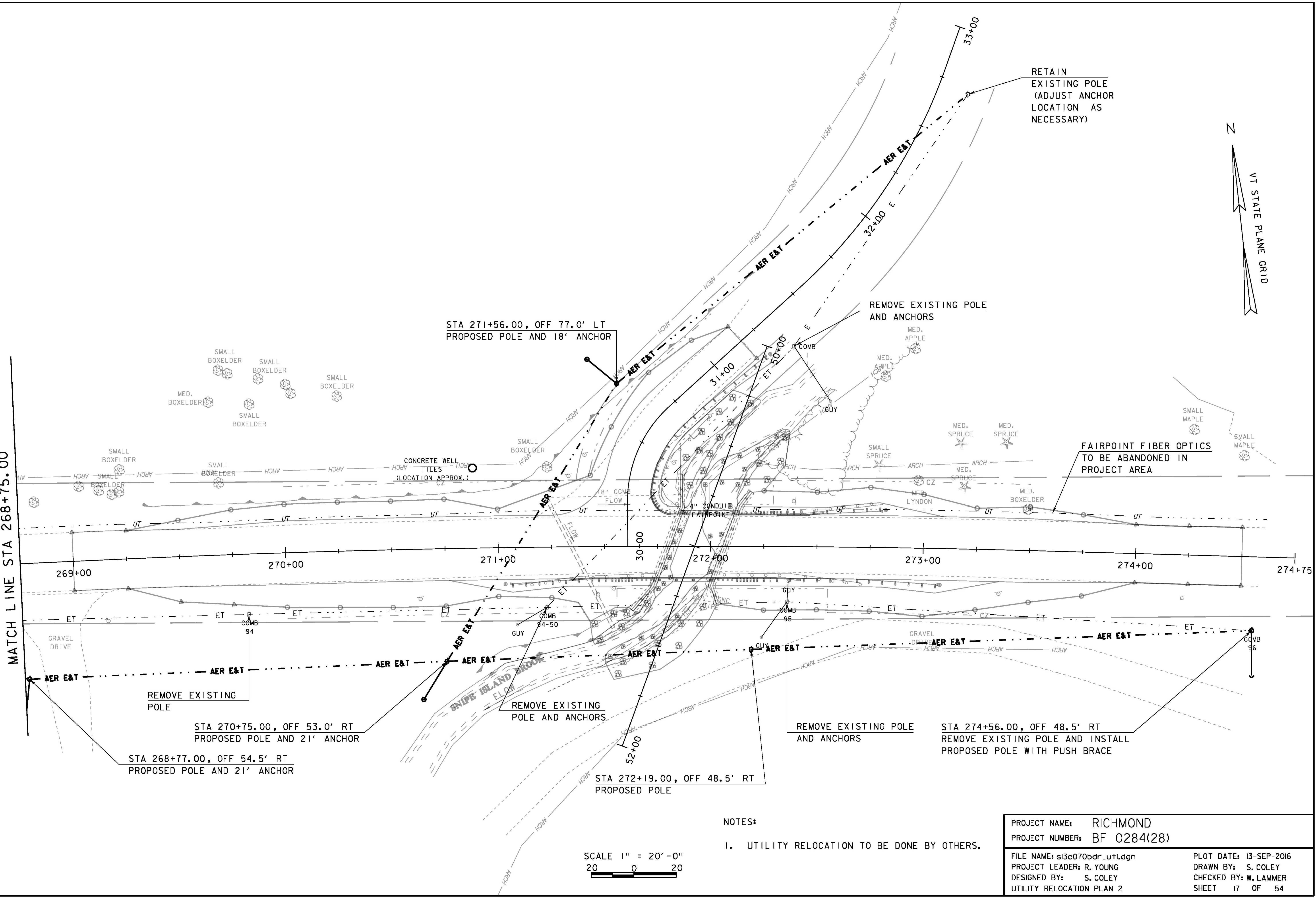

STA 271+56.00, OFF 77.0' LT  
PROPOSED POLE AND 18' ANCHOR

REMOVE EXISTING POLE  
AND ANCHORS

RETAIN  
EXISTING POLE  
(ADJUST ANCHOR  
LOCATION AS  
NECESSARY)

FAIRPOINT FIBER OPTICS  
TO BE ABANDONED IN  
PROJECT AREA

REMOVE EXISTING  
POLE

STA 270+75.00, OFF 53.0' RT  
PROPOSED POLE AND 21' ANCHOR

STA 268+77.00, OFF 54.5' RT  
PROPOSED POLE AND 21' ANCHOR

REMOVE EXISTING  
POLE AND ANCHORS

STA 272+19.00, OFF 48.5' RT  
PROPOSED POLE

REMOVE EXISTING POLE  
AND ANCHORS

STA 274+56.00, OFF 48.5' RT  
REMOVE EXISTING POLE AND INSTALL  
PROPOSED POLE WITH PUSH BRACE

NOTES:

- 1. UTILITY RELOCATION TO BE DONE BY OTHERS.

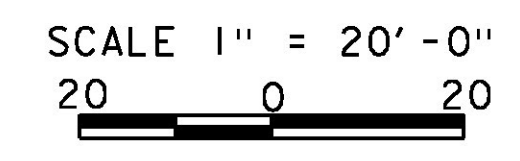

PROJECT NAME: RICHMOND	PLOT DATE: 13-SEP-2016
PROJECT NUMBER: BF 0284(28)	DRAWN BY: S. COLEY
FILE NAME: s13c070bdr.utl.dgn	CHECKED BY: W. LAMMER
PROJECT LEADER: R. YOUNG	SHEET 17 OF 54
DESIGNED BY: S. COLEY	
UTILITY RELOCATION PLAN 2	