

1 PLAN VIEW IN FORM  
W-W1  
3/4" = 1'-0"

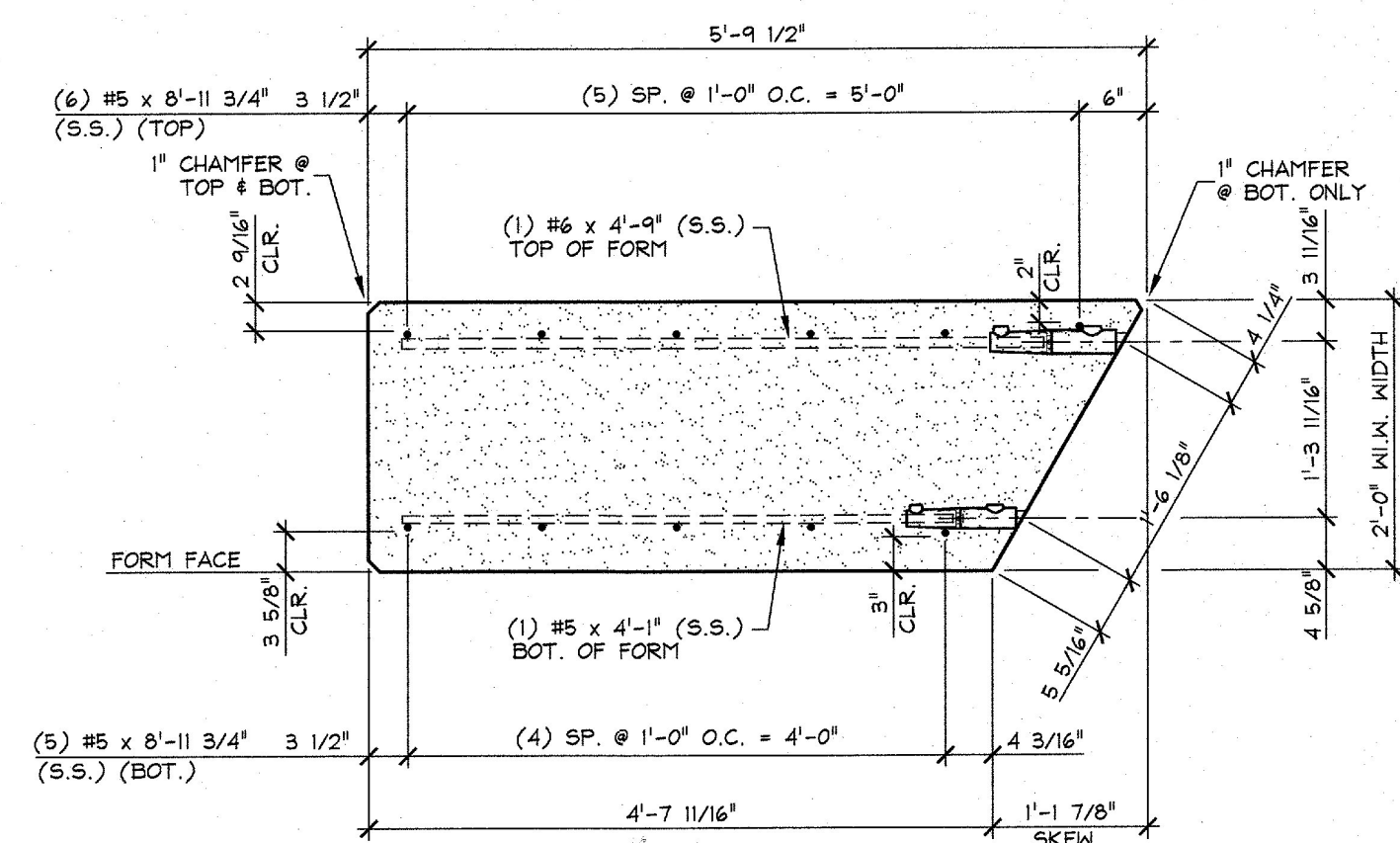

3 BOTTOM ELEVATION  
W-W1  
3/4" = 1'-0"

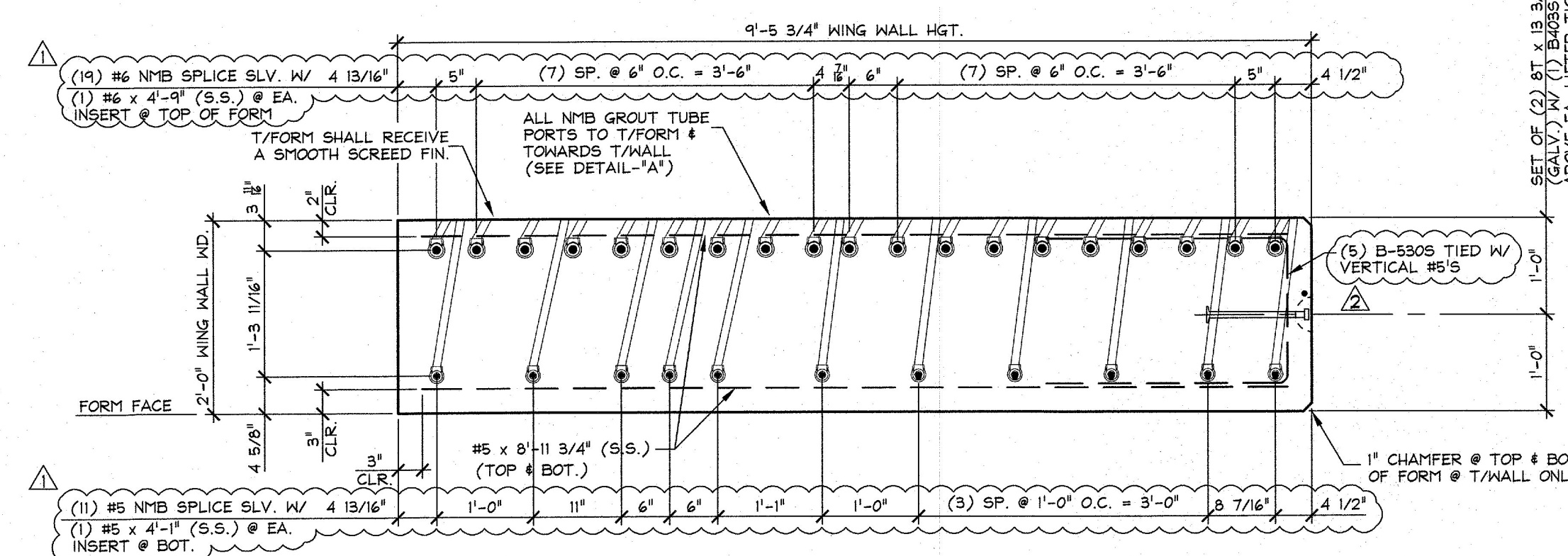

4 BOTTOM ELEVATION  
W-W1  
3/4" = 1'-0"

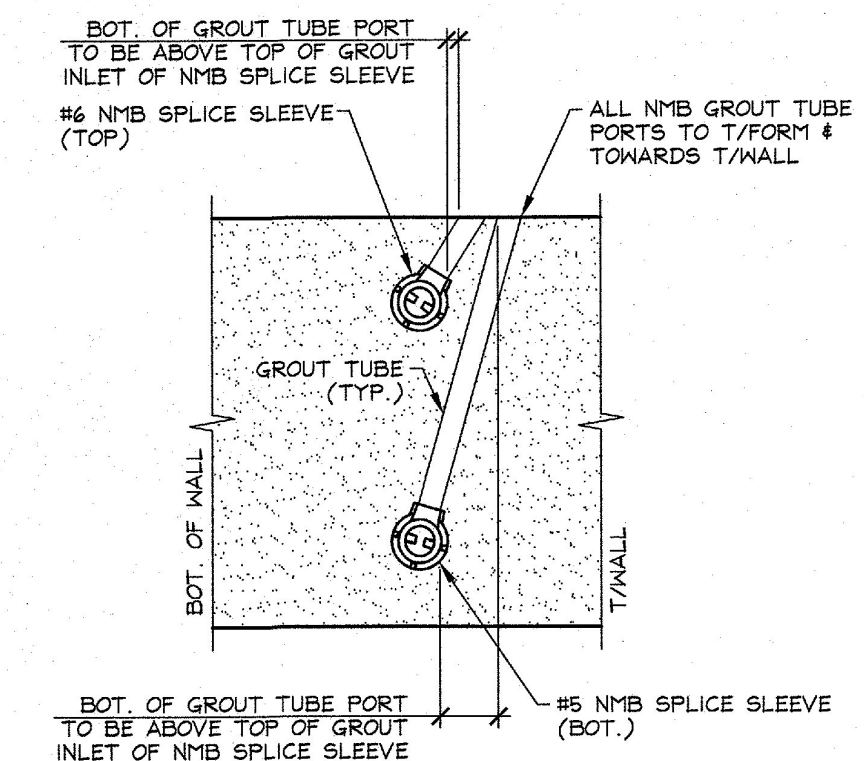

DETAIL - "A"  
N.T.S.

SHOP NOTE:  
28-DAY STRENGTH = 5,000 PSI  
HANDLING STRENGTH = 3,500 PSI  
MIX #445MSCC

MATERIAL LIST / WINGWALL			
ITEM	MARK	DESCRIPTION	QTY.
1		#6 NMB SPLICE SLEEVE (GALV.)	19
2		#5 NMB SPLICE SLEEVE (GALV.)	11
3	B-5305	#5 BENT BAR (STAINLESS STEEL)	5
4	B-4035	#4 BENT BAR (STAINLESS STEEL)	2
5			
6		#6 x 4'-9" (S.S.)	19
7		#5 x 4'-1" (S.S.)	11
8		#5 x 8'-11 3/4" (S.S.)	11
9			
10			
11			
12		8T x 13 3/8" SHIFT LIFT (GALV.)	2
13		4T x 7 1/8" SHIFT LIFT (GALV.)	4
14			
15			

Vermont Agency of Transportation  
**RECEIVED**  
CK'D BY \_\_\_\_\_ OK'D BY G. ROY  
March 14, 2017  
RESUBMIT NO Approved  
BY C. CARLSON DATE 03/15/2017

APPROVAL STAMP:  
3/14/17 REVISED AS PER ENGINEERS COMM. T.D.  
2/24/17 REVISED AS PER ENGINEERS COMM. T.D.

J.P. CARRARA & SONS INC.  
Precast & Prestress Manufacturer  
2404 OAK ST., WOODSBURY, VERMONT 05793 Phone: (802)388-6361 Fax: (802)388-9010  
STATE OF VERMONT AGENCY OF TRANSPORTATION  
COUNTY OF ORANGE  
TOWN OF BRADFORD  
VT 255B (RURAL MAJOR COLLECTOR)  
BRIDGE NO.: 1 PROJECT NO.: BF 0191 (29)  
A.L. ST. ONGE  
CONTRACTOR  
MONTGOMERY, VERMONT  
DATE: DEC. 21, 2016  
SCALE: NOTED  
CHKD: DFTM: T.D.  
JOB NO: 23506-016  
PRECAST WING WALL DETAILS  
DWG. NO: W-W1