

CONSTRUCTION APPROACH SIGNING SHEET

LEGEND

- CONSTRUCTION SIGN ASSEMBLY I.D.
- SIGN
- BACK TO BACK SIGN, SINGLE POST
- PCMS PORTABLE CHANGEABLE MESSAGE SIGN

LIST OF TOWN/STATE HIGHWAYS FOR CONSTRUCTION SIGNS

TOWN/STATE HIGHWAY NAME	1	2	3	4	PCMS
BEGIN PROJECT US ROUTE 4	2	2	1		1
MISSION FARM ROAD (TH 38)	1			1	
JOHNSON ROAD (TH 39)	2			2	
WAROAWELL ROAD (TH 17)	1			1	
HADLEY ROAD (TH 111)	1			1	
VERMONT ROUTE. 100	1	2			1
STANDISH ROAD (TH 41)	1			1	
MOUNTAINSIDE ROAD (TH 34)	2			2	
BRIDGEWATER HILL ROAD (TH 23)	1			1	
PEARSON ROAD (TH 68)	1			1	
ROGERS ROAD (TH 32)	1			1	
BRIDGEWATER CENTER ROAD (TH 11)	1			1	
VERMONT RTE. 100A	1	2			1
UPPER ROAD (TH 37)	1			1	
PRIOR ROAD (TH 54)	1			1	
ROBINSON ROAD (TH 57)	1			1	

TOWN/STATE HIGHWAY NAME	1	2	3	4	PCMS
GOLD COAST ROAD (TH 26)	1			1	
NORTH BRIDGEWATER ROAD (TH 2)	1			1	
WOLLEN MILL ROAD (TH 46)	2			2	
ECHO LEDGE ROAD (TH 13)	1			1	
LIBERTY FARM ROAD (TH 28)	1			1	
LINCOLN COVERED BRIDGE (TH 35)	1			1	
WESTERODALE ROAD (TH 16)	1			1	
CABOT ROAD (TH 86)	1			1	
WYMAN LANE (TH 29)	1			1	
COX DISTRICT ROAD (TH 23)	1			1	
SENIOR LANE (TH 114)	2			2	
BARBERRY HILL ROAD (TH 30)	1			1	
MILL ROAD (TH 50)	1			1	
PROSPER ROAD (TH 3)	1			1	
ROSE HILL (TH 31)	2			2	
END PROJECT US ROUTE 4	2	2	1		1
PROJECT TOTAL	39	8	2	33	4

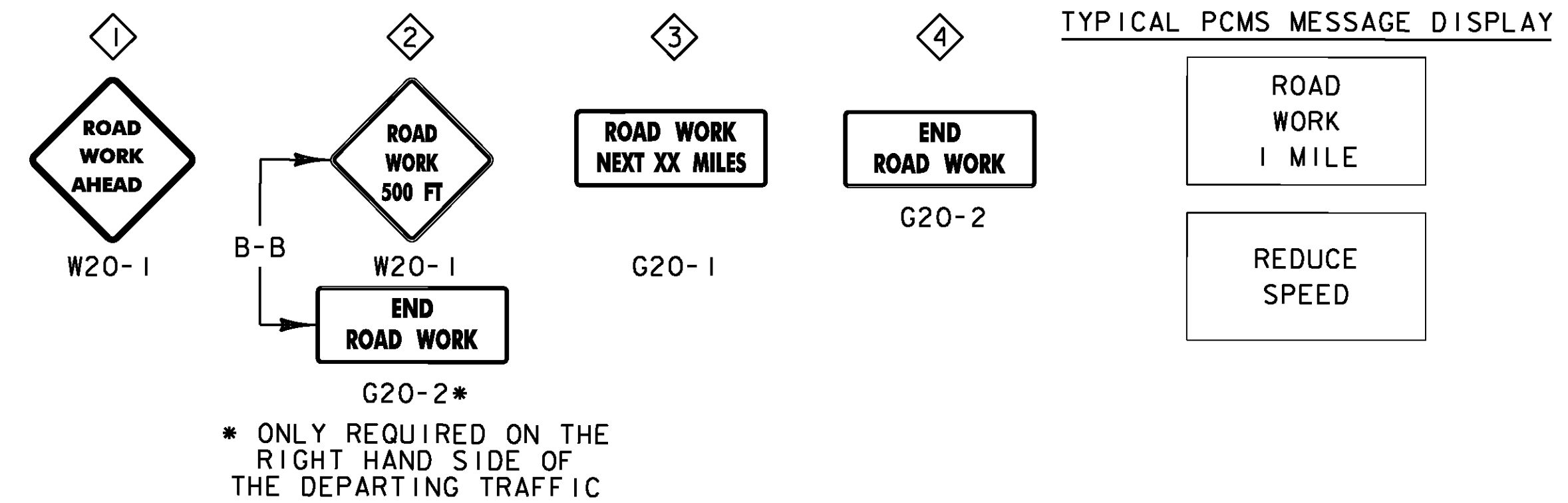

PROJECT NAME: KILLINGTON-WOODSTOCK	
PROJECT NUMBER: ER NH 020-2(38)	
FILE NAME: z13bi92+mpl.dgn	PLOT DATE: 3/7/2016
PROJECT LEADER: E. ATKINS	DRAWN BY: I. KHALID
DESIGNED BY: T. BIGELOW	CHECKED BY: E. ATKINS
CONSTRUCTION APPROACH SIGNING SHEET	SHEET 145 OF 146